



FOR ADDISON USE ONLY

Permit Number: W-1311

Location: 4550 Excel

**APPLICATION**

**Right of Way Work Permit - PUBLIC UTILITY/CTP**

(For Public Utility/CTP - Street Cut/Excavation/Lane Closure)

**PLEASE PRINT LEGIBLY**

Date of application: 1-17-18

Facility Owner Company: Charter Spectrum Company Phone #: 214-319-4865

Utility/CTP Representative: Kevin Casey Cell Phone #: \_\_\_\_\_

General Contractor: Bridgepoint Communications Company Phone #: \_\_\_\_\_

Site Supervisor Name: Chris null 24 hour phone #: 469-643-6859

Work Site Address and Location: 4550 Excel pkwy

Purpose and general description of work: placing new service by underground bore.

Proposed Start Work Date: 1-24-18 Estimated Completion Date: 2-22-18

Pavement Cut?  Yes  No Directional Bore/Boring?  Yes  No

Excavation?  Yes  No Lane Closure?  Yes  No Other: \_\_\_\_\_ ?  Yes  No

Chris null Applicant's Printed Name [Signature] Signature Construction Supervisor Position with Company

Applicant's Email: bpdalloc@gmail.com Applicant's Phone Number: 469-643-6859

Steve Holt Direct Supervisor's Printed Name \_\_\_\_\_ Phone Number \_\_\_\_\_ Bridgepoint Communications Company Name

FOR ADDISON USE ONLY

Received By: Nicole S. Entered?  Yes  No Received Date: 1-22-18

Approved By: [Signature] Inspector: JE Issue Date: 1-24-18

Plans Submitted?  Yes  No  N/A Traffic Control Plan Submitted?  Yes  No  N/A Expiration Date: 2/17/18

Insurance Provided?  Yes  No  On File Performance/Maintenance Bond?  Yes  No  On File  N/A

Fee Paid: NA Receipt#: CTP Date: 1-26-18 Processed By: Nicole S.

Picked Up By: Chris Company: Bridgepoint Date & Time: 1-26-18 10:00AM

TOWN OF ADDISON INFRASTRUCTURE AND DEVELOPMENT SERVICES  
 DEPARTMENT ATTN: RIGHT OF WAY PERMIT - DAVE WILDE 972-450-2847  
 16801 WESTGROVE RD. ADDISON, TX 75001-9010  
 PHONE: 972-450-2871 FAX: 972-450-2837

RIGHT OF WAY, EXCAVATION &  
LANE CLOSURE PERMIT

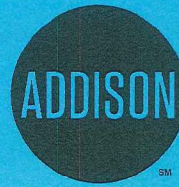

INFRASTRUCTURE &  
DEVELOPMENT SERVICES

16801 WESTGROVE DRIVE  
ADDISON, TEXAS 75001  
972.450.2871

**W-1311**

PERMIT NUMBER

**1/24/18**

START DATE

**2/22/18 BRIDGEPOINT SPECTRUM**

EST. COMPLETION DATE

CONTRACTOR

FOR

**4550 EXCEL PKWY**

LOCATION (ADDRESS)

**EASEMENT AT REAR OF PROPERTY**

LOCATION (ACTUAL)

**PLACE NEW SERVICE BY UNDERGROUND BORE**

TYPE OF WORK

THIS CARD MUST BE DISPLAYED ON THE JOB SITE AT ALL TIMES.

# Spectrum

## CHARTER 4550 EXCEL PKWY ADDISON, TEXAS

VICINITY MAP

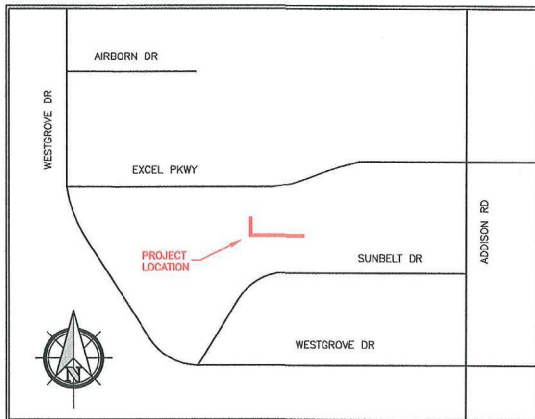

### GENERAL PROJECT NOTES

1. ALL CONSTRUCTION WORK WITHIN THE PUBLIC RIGHT-OF-WAY SHALL BE DONE IN ACCORDANCE WITH THE ORDINANCES AND REGULATIONS OF THE MUNICIPALITY IN WHICH THE WORK IS TO BE PERFORMED.
2. EXISTING UTILITY LOCATIONS SHOWN ARE TAKEN FROM AVAILABLE RECORDS AND MAY NOT BE ALL INCLUSIVE. UTILITY LOCATIONS ARE GENERALLY SCHEMATIC IN NATURE AND MAY NOT ACCURATELY REFLECT THE SIZE AND LOCATION OF EACH PARTICULAR UTILITY. THE CONSTRUCTION CONTRACTOR SHALL ASSUME RESPONSIBILITY FOR ACTUAL LINE LOCATES IN THE FIELD AND THE PROTECTION OF ALL EXISTING FACILITIES WHETHER SHOWN OR NOT. THE CONSTRUCTION CONTRACTOR SHALL ALSO ASSUME RESPONSIBILITY FOR REPAIRS TO ANY EXISTING FACILITY DAMAGED AS A DIRECT RESULT OF THE CONSTRUCTION ACTIVITIES WHETHER THE FACILITY IS SHOWN ON THE DRAWINGS OR NOT.
3. THE CONSTRUCTION CONTRACTOR SHALL BE RESPONSIBLE FOR CONTACTING ALL DEPARTMENTS WITHIN THE MUNICIPALITY AND THE UTILITY COMPANIES AT LEAST TWO WORKING DAYS PRIOR TO THE COMMENCEMENT OF WORK.

CALL BEFORE YOU DIG  
811

IT'S THE LAW

4. IT SHALL BE THE RESPONSIBILITY OF THE CONSTRUCTION CONTRACTOR TO: A) PREVENT DAMAGE TO PRIVATE AND PUBLIC PROPERTY. B) RESTORE ALL AREAS EFFECTED BY THE CONSTRUCTION TO ORIGINAL OR BETTER CONDITION.
5. BARRICADING AND TRAFFIC CONTROL SHALL BE THE RESPONSIBILITY OF THE CONSTRUCTION CONTRACTOR AND SHALL CONFORM TO THE "TEXAS MANUAL ON UNIFORM TRAFFIC CONTROL DEVICES". TRAFFIC FLOW AND ACCESS SHALL BE MAINTAINED DURING ALL PHASES OF CONSTRUCTION. THE CONSTRUCTION CONTRACTOR IS RESPONSIBLE FOR PROVIDING TRAFFIC SAFETY MEASURES FOR WORK ON THE PROJECT. THE WORK SITE SHALL BE SUITABLY LIT AND BARRICADED AT NIGHT.
6. THE CONSTRUCTION CONTRACTOR SHALL ABIDE BY ALL APPLICABLE FEDERAL, STATE AND LOCAL LAWS GOVERNING EXCAVATION. THE CONSTRUCTION CONTRACTOR SHALL PROVIDE ALL TRENCH SAFETY SYSTEMS THAT COMPLY WITH ALL LAWS GOVERNING EXCAVATION. THE CONSTRUCTION CONTRACTOR SHALL BE SOLELY RESPONSIBLE FOR ALL ASPECTS OF WORK RELATED TO EXCAVATION.
7. ALL CONCRETE USED IN ANY ROADWAY SHALL BE IN COMPLIANCE WITH THE SPECIFIED CLASSES OF CONCRETE IN THE STANDARD SPECIFICATIONS 5.8 "PORTLAND CEMENT CONCRETE PAVEMENT" AND 7.4.5 "QUALITY OF CONCRETE" AS AMENDED BY THE ADDENDUM TO THE NORTH CENTRAL TEXAS STANDARD SPECIFICATIONS FOR PUBLIC WORKS CONSTRUCTION - 2004. ALL OTHER CONCRETE SHALL BE CLASS A CONCRETE.
8. ALL REINFORCING STEEL AND DOWEL BARS IN PAVEMENT SHALL BE SUPPORTED AND MAINTAINED AT THE CORRECT CLEARANCES BY THE USE OF BAR CHAINS OR OTHER APPROVED SUPPORT.
9. ALL CONDUIT MUST BE PLACED WITH A MINIMUM 42" OF COVER, UNLESS OTHERWISE SPECIFIED.
10. ALL BACKFILLING WILL BE MECHANICALLY TAMPED IN LIFTS TO A DENSITY OF 95% PROCTOR. THE REQUIRED DENSITY WILL BE OBTAINED BY USING TAMPERS, RAMMERS OR ROLLING EQUIPMENT. LIFTS MAY VARY ACCORDING TO THE TYPE OF EQUIPMENT USED TO OBTAIN THE REQUIRED DENSITY. SAND AND DEBRIS FREE MATERIAL WILL BE USED FOR BACKFILL.

DFWT CONTACT: DAVID HATTON 972.670.2113

PREPARED BY: DFW TELECOM, INC.

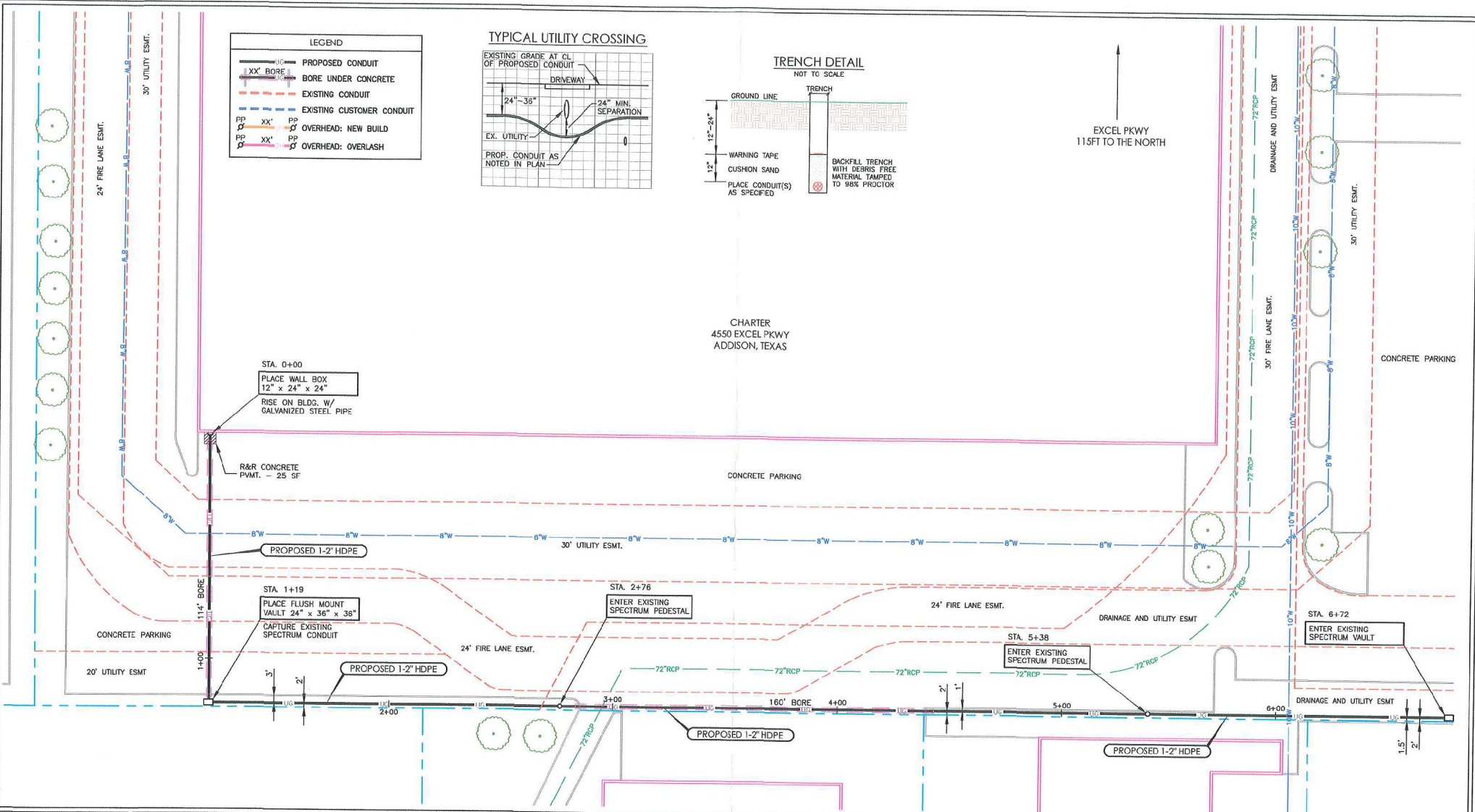

PREPARED BY:  
  
 DFW CONTACT:  
 DAVID HATTON 972.670.2113

ESTIMATED SHEET TOTALS			
DESCRIPTION	QUANTITY	DESCRIPTION	QUANTITY
TRENCH & PLACE CONDUIT	398'	PLACE FLUSH MOUNT VAULT	1
BORE & PLACE CONDUIT	274'	PLACE PEDESTAL	
BORE & PLACE STEEL CASING		PLACE FLUSH DROP BUCKET	
PULL THROUGH EXISTING CONDUIT		PLACE POWER SUPPLY	
R & R CONCRETE SIDEWALK (SF)		PLACE WALL BOX & RISER	1
R & R CONCRETE PAVEMENT (SF)	25'	PLACE U-GUARD RISER	
OVERHEAD: OVERLASH		OVERHEAD: NEW BUILD	

NORTH



SHEET  
 1 OF 1

PROJECT: CHARTER

ADDRESS: 4550 EXCEL PKWY  
 CITY, STATE: ADDISON, TEXAS

HORIZONTAL SCALE 1" = 40'	VERTICAL SCALE 1" = 10'	JOB NUMBER: 1559836	DATE: 12-15-2016
------------------------------	----------------------------	------------------------	---------------------

