



FOR ADDISON USE ONLY
 Permit Number: W-1300
 Location: 1400 Ledgemont

APPLICATION

Right of Way Work Permit - PUBLIC UTILITY/CTP
 (For Public Utility/CTP - Street Cut/Excavation/Lane Closure)

PLEASE PRINT LEGIBLY

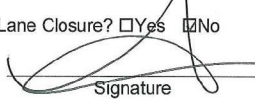
Date of application: 1-16-18
 Facility Owner Company: Spectrum Company Phone #: 214-935-8747
 Utility/CTP Representative: Lyle Bradley Cell Phone #: 214-846-5286
 General Contractor: STC Utility Services Company Phone #: 214-295-5422
 Site Supervisor Name: Chris Twidwell 24 hour phone #: 214-283-4706
 Work Site Address and Location: 16400 Ledgemont Dr. Bldg 7&8
 Purpose and general description of work: Directional bore and place new CATV conduit to replace damaged cable
 Proposed Start Work Date: 1-23-18 Estimated Completion Date: 2-23-18
 Pavement Cut? Yes No Directional Bore/Boring? Yes No
 Excavation? Yes No Lane Closure? Yes No Other: _____? Yes No
Melissa Gonzalez  Project Coordinator
 Applicant's Printed Name Signature Position with Company
 Applicant's Email: melissa.gonzalez@stcutility.com Applicant's Phone Number: 817-683-0478
Chris Twidwell 214-283-4706 STC Utility Services
 Direct Supervisor's Printed Name Phone Number Company Name

FOR ADDISON USE ONLY

Received By: Melissa S. Entered? Yes Received Date: 1-16-18
 Approved By: David Wilde Inspector: JF Issue Date: 1/18/18
 Plans Submitted? Yes No N/A Traffic Control Plan Submitted? Yes No N/A Expiration Date: 2/1/18
 Insurance Provided? Yes No On File Performance/Maintenance Bond? Yes No On File N/A
 Fee Paid: N/A Receipt#: CTP Date: 1-18-18 Processed By: Melissa S.
 Picked Up By: Setn Company: STC Date & Time: 10:12 AM

TOWN OF ADDISON INFRASTRUCTURE AND DEVELOPMENT SERVICES
 DEPARTMENT ATTN.: RIGHT OF WAY PERMIT - DAVE WILDE 972-450-2847
 16801 WESTGROVE RD. ADDISON, TX 75001-9010
 PHONE: 972-450-2871 FAX: 972-450-2837



FOR ADDISON USE ONLY
 Permit Number: W-1350
 Location: 16400 Ledgecrest

APPLICATION

Right of Way Work Permit –PUBLIC UTILITY/CTP

(For Public Utility/CTP - Street Cut/Excavation/Lane Closure)

Sub-Contractor List

PLEASE PRINT LEGIBLY

General Contractor's Name: STC Utiliy General Contractor's Phone #: 214-295-5422

Sub-Contractor #1 Company Name: _____ Address: _____

Print Sub-Contractor's Name: _____ Sub-Contractor Phone #: _____

Print Site Supervisor's Name: _____ Supervisor's Phone #: _____

Insurance Provided? Yes No On File

Sub-Contractor #2 Company Name: _____ Address: _____

Print Sub-Contractor's Name: _____ Sub-Contractor Phone #: _____

Print Supervisor's Name: _____ Supervisor's Phone #: _____

Insurance Provided? Yes No On File

Sub-Contractor #3 Company Name: _____ Address: _____

Print Sub-Contractor's Name: _____ Sub-Contractor Phone #: _____

Print Supervisor's Name: _____ Supervisor's Phone #: _____

Insurance Provided? Yes No On File

RIGHT OF WAY, EXCAVATION &
LANE CLOSURE PERMIT

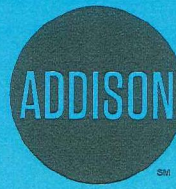

INFRASTRUCTURE &
DEVELOPMENT SERVICES

16801 WESTGROVE DRIVE
ADDISON, TEXAS 75001
972.450.2871

W-1300

PERMIT NUMBER

1/23/18

START DATE

2/23/18

EST. COMPLETION DATE

STC UTILITY

CONTRACTOR

SPECTRUM

FOR

16400 LEDGEMONT

LOCATION (ADDRESS)

FROM PEDESTAL TO PEDESTAL AT BLDG 7&8

LOCATION (ACTUAL)

REPLACE DAMAGED CABLE

TYPE OF WORK

THIS CARD MUST BE DISPLAYED ON THE JOB SITE AT ALL TIMES.

Spectrum

RMO - 86064
16400 LEDGEMONT LN
ADDISON, TEXAS

VICINITY MAP

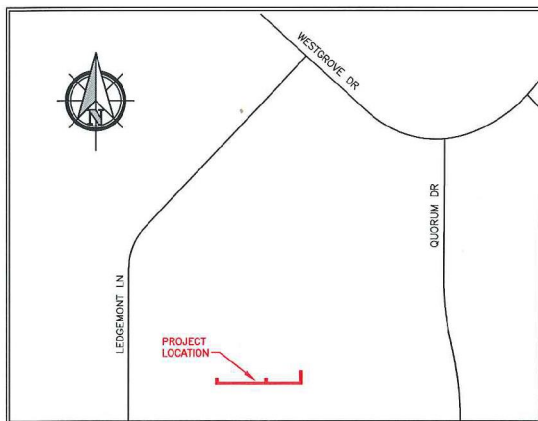

GENERAL PROJECT NOTES

1. ALL CONSTRUCTION WORK WITHIN THE PUBLIC RIGHT-OF-WAY SHALL BE DONE IN ACCORDANCE WITH THE ORDINANCES AND REGULATIONS OF THE MUNICIPALITY IN WHICH THE WORK IS TO BE PERFORMED.
2. EXISTING UTILITY LOCATIONS SHOWN ARE TAKEN FROM AVAILABLE RECORDS AND MAY NOT BE ALL INCLUSIVE. UTILITY LOCATIONS ARE GENERALLY SCHEMATIC IN NATURE AND MAY NOT ACCURATELY REFLECT THE SIZE AND LOCATION OF EACH PARTICULAR UTILITY. THE CONSTRUCTION CONTRACTOR SHALL ASSUME RESPONSIBILITY FOR ACTUAL LINE LOCATES IN THE FIELD AND THE PROTECTION OF ALL EXISTING FACILITIES WHETHER SHOWN OR NOT. THE CONSTRUCTION CONTRACTOR SHALL ALSO ASSUME RESPONSIBILITY FOR REPAIRS TO ANY EXISTING FACILITY DAMAGED AS A DIRECT RESULT OF THE CONSTRUCTION ACTIVITIES WHETHER THE FACILITY IS SHOWN ON THE DRAWINGS OR NOT.
3. THE CONSTRUCTION CONTRACTOR SHALL BE RESPONSIBLE FOR CONTACTING ALL DEPARTMENTS WITHIN THE MUNICIPALITY AND THE UTILITY COMPANIES AT LEAST TWO WORKING DAYS PRIOR TO THE COMMENCEMENT OF WORK.

CALL BEFORE YOU DIG

811

IT'S THE LAW

4. IT SHALL BE THE RESPONSIBILITY OF THE CONSTRUCTION CONTRACTOR TO: A) PREVENT DAMAGE TO PRIVATE AND PUBLIC PROPERTY. B) RESTORE ALL AREAS EFFECTED BY THE CONSTRUCTION TO ORIGINAL OR BETTER CONDITION.
5. BARRICADING AND TRAFFIC CONTROL SHALL BE THE RESPONSIBILITY OF THE CONSTRUCTION CONTRACTOR AND SHALL CONFORM TO THE "TEXAS MANUAL ON UNIFORM TRAFFIC CONTROL DEVICES". TRAFFIC FLOW AND ACCESS SHALL BE MAINTAINED DURING ALL PHASES OF CONSTRUCTION. THE CONSTRUCTION CONTRACTOR IS RESPONSIBLE FOR PROVIDING TRAFFIC SAFETY MEASURES FOR WORK ON THE PROJECT. THE WORK SITE SHALL BE SUITABLY LIT AND BARRICADED AT NIGHT.
6. THE CONSTRUCTION CONTRACTOR SHALL ABIDE BY ALL APPLICABLE FEDERAL, STATE AND LOCAL LAWS GOVERNING EXCAVATION. THE CONSTRUCTION CONTRACTOR SHALL PROVIDE ALL TRENCH SAFETY SYSTEMS THAT COMPLY WITH ALL LAWS GOVERNING EXCAVATION. THE CONSTRUCTION CONTRACTOR SHALL BE SOLELY RESPONSIBLE FOR ALL ASPECTS OF WORK RELATED TO EXCAVATION.
7. ALL CONCRETE USED IN ANY ROADWAY SHALL BE IN COMPLIANCE WITH THE SPECIFIED CLASSES OF CONCRETE IN THE STANDARD SPECIFICATIONS 5.8 "PORTLAND CEMENT CONCRETE PAVEMENT" AND 7.4.5 "QUALITY OF CONCRETE" AS AMENDED BY THE ADDENDUM TO THE NORTH CENTRAL TEXAS STANDARD SPECIFICATIONS FOR PUBLIC WORKS CONSTRUCTION - 2004. ALL OTHER CONCRETE SHALL BE CLASS A CONCRETE.
8. ALL REINFORCING STEEL AND DOWEL BARS IN PAVEMENT SHALL BE SUPPORTED AND MAINTAINED AT THE CORRECT CLEARANCES BY THE USE OF BAR CHAINS OR OTHER APPROVED SUPPORT.
9. ALL CONDUIT MUST BE PLACED WITH A MINIMUM 42" OF COVER, UNLESS OTHERWISE SPECIFIED.
10. ALL BACKFILLING WILL BE MECHANICALLY TAMPED IN LIFTS TO A DENSITY OF 95% PROCTOR. THE REQUIRED DENSITY WILL BE OBTAINED BY USING TAMPERS, RAMMERS OR ROLLING EQUIPMENT. LIFTS MAY VARY ACCORDING TO THE TYPE OF EQUIPMENT USED TO OBTAIN THE REQUIRED DENSITY. SAND AND DEBRIS FREE MATERIAL WILL BE USED FOR BACKFILL.

DFWT CONTACT: DAVID HATTON 972.670.2113

PREPARED BY: DFW TELECOM, INC.

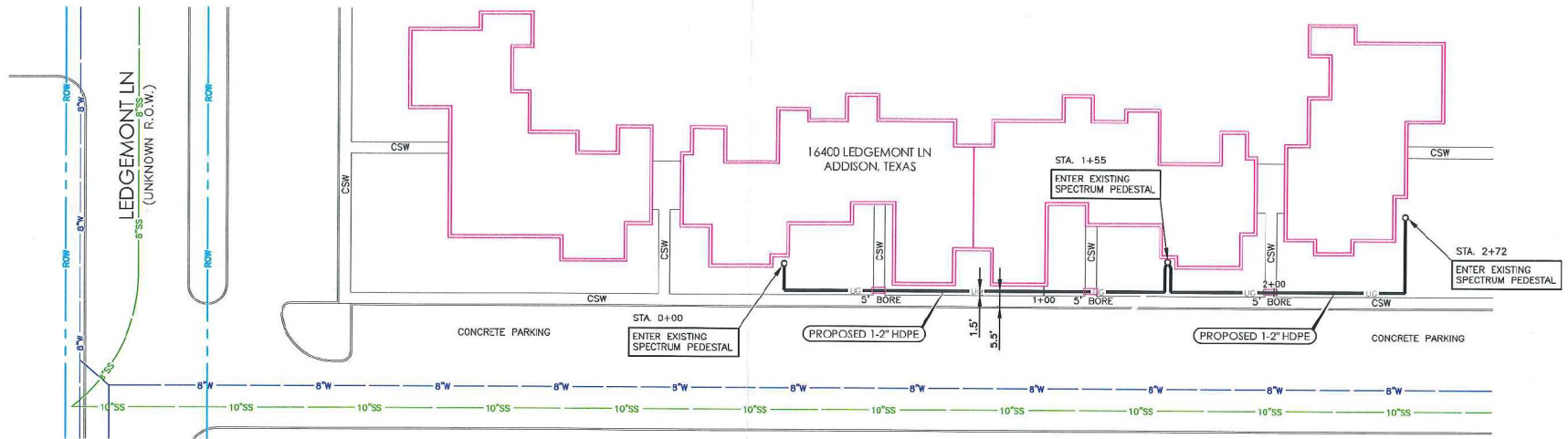

LEGEND

— UC —	PROPOSED CONDUIT
— XX' BORE —	BORE UNDER CONCRETE
— — —	EXISTING CONDUIT
— — —	EXISTING CUSTOMER CONDUIT
PP XX' PP	OVERHEAD: NEW BUILD
PP XX' PP	OVERHEAD: OVERLASH

TYPICAL UTILITY CROSSING

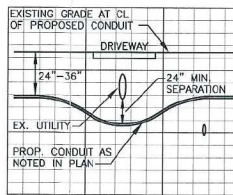

TRENCH DETAIL
NOT TO SCALE

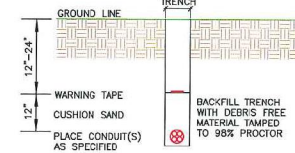

PREPARED BY:



DFWT CONTACT:
DAVID HATTON 972.670.2113

ESTIMATED SHEET TOTALS

DESCRIPTION	QUANTITY	DESCRIPTION	QUANTITY
TRENCH & PLACE CONDUIT	257'	PLACE FLUSH MOUNT VAULT	
BORE & PLACE CONDUIT	15'	PLACE PEDESTAL	
BORE & PLACE STEEL CASING		PLACE FLUSH DROP BUCKET	
PULL THROUGH EXISTING CONDUIT		PLACE POWER SUPPLY	
R & R CONCRETE SIDEWALK (SF)		PLACE WALL BOX & RISER	
R & R CONCRETE PAVEMENT (SF)		PLACE U-GUARD RISER	
OVERHEAD: OVERLASH		OVERHEAD: NEW BUILD	

NORTH



1 SHEET OF 1

PROJECT: **SPAN REPLACEMENT**
(REPLACE EXIST. CATV DUE TO DAMAGE)

ADDRESS: 16400 LEDGEMONT LN
CITY, STATE: ADDISON, TEXAS

HORIZONTAL SCALE
1" = 40'

VERTICAL SCALE
1" = 10'

JOB NUMBER:
86064

DATE:
01-08-2018

