



FOR ADDISON USE ONLY
 Permit Number: W-1320
 Location: 3761 WOODSHADOW

APPLICATION

Right of Way Work Permit - PUBLIC UTILITY/CTP

(For Public Utility/CTP - Street Cut/Excavation/Lane Closure)

PLEASE PRINT LEGIBLY

Date of application: 1-31-18
 Facility Owner Company: Spectrum Company Phone #: 214-935-8747
 Utility/CTP Representative: Lyle Bradley Cell Phone #: 214-846-5286
 General Contractor: STC Utility Services Company Phone #: 214-295-5422
 Site Supervisor Name: Chris Twidwell 24 hour phone #: 214-283-4706
 Work Site Address and Location: 3761 Woodshadow Ln

Purpose and general description of work: Directional bore and place new CATV conduit to replace damaged cable

Proposed Start Work Date: 2-5-18 Estimated Completion Date: 3-5-18

Pavement Cut? Yes No Directional Bore/Boring? Yes No

Excavation? Yes No Lane Closure? Yes No Other: _____ ? Yes No

Melissa Gonzalez  Project Coordinator
 Applicant's Printed Name Signature Position with Company

Applicant's Email: melissa.gonzalez@stcutility.com Applicant's Phone Number: 817-683-0478

Chris Twidwell 214-283-4706 STC Utility Services
 Direct Supervisor's Printed Name Phone Number Company Name

FOR ADDISON USE ONLY

Received By: Melnes Entered? Yes Received Date: 2-1-18

Approved By: Dave Wilde Inspector: JE Issue Date: 2/2/18

Plans Submitted? Yes No N/A Traffic Control Plan Submitted? Yes No N/A Expiration Date: 7/10/18

Insurance Provided? Yes No On File Performance/Maintenance Bond? Yes No On File N/A

Fee Paid: NA Receipt#: CTP Date: 2-5-18 Processed By: Melnes

Picked Up By: Seth Company: STC Date & Time: 10:17 AM
2-5-18

TOWN OF ADDISON INFRASTRUCTURE AND DEVELOPMENT SERVICES
 DEPARTMENT ATTN.: RIGHT OF WAY PERMIT - DAVE WILDE 972-450-2847
 16801 WESTGROVE RD. ADDISON, TX 75001-9010
 PHONE: 972-450-2871 FAX: 972-450-2837



FOR ADDISON USE ONLY
 Permit Number: W-1320
 Location: 3761 Woodshades

APPLICATION

Right of Way Work Permit –PUBLIC UTILITY/CTP
 (For Public Utility/CTP - Street Cut/Excavation/Lane Closure)

Sub-Contractor List

PLEASE PRINT LEGIBLY

General Contractor's Name: STC Utiliy General Contractor's Phone #: 214-295-5422

Sub-Contractor #1 Company Name: _____ Address: _____

Print Sub-Contractor's Name: _____ Sub-Contractor Phone #: _____

Print Site Supervisor's Name: _____ Supervisor's Phone #: _____

Insurance Provided? Yes No On File

Sub-Contractor #2 Company Name: _____ Address: _____

Print Sub-Contractor's Name: _____ Sub-Contractor Phone #: _____

Print Supervisor's Name: _____ Supervisor's Phone #: _____

Insurance Provided? Yes No On File

Sub-Contractor #3 Company Name: _____ Address: _____

Print Sub-Contractor's Name: _____ Sub-Contractor Phone #: _____

Print Supervisor's Name: _____ Supervisor's Phone #: _____

Insurance Provided? Yes No On File

RIGHT OF WAY, EXCAVATION &
LANE CLOSURE PERMIT

W-1320

PERMIT NUMBER

2/05/18

START DATE

3/05/18

EST. COMPLETION DATE

**INFRASTRUCTURE &
DEVELOPMENT SERVICES**



16801 WESTGROVE DRIVE
ADDISON, TEXAS 75001
972.450.2871

FOR

STC UTILITY SPECTRUM

CONTRACTOR

3761 WOODSHADOW LN

LOCATION (ADDRESS)

FROM PED @ 3757 WOODSHADOW TO PED @ 3773 MEADOWCREEK

LOCATION (ACTUAL)

REPLACE DAMAGED CABLE

TYPE OF WORK

THIS CARD MUST BE DISPLAYED ON THE JOB SITE AT ALL TIMES

Spectrum

RMO - 86762
LES LACS AVE &
BEAU PARK LN
ADDISON, TEXAS

VICINITY MAP

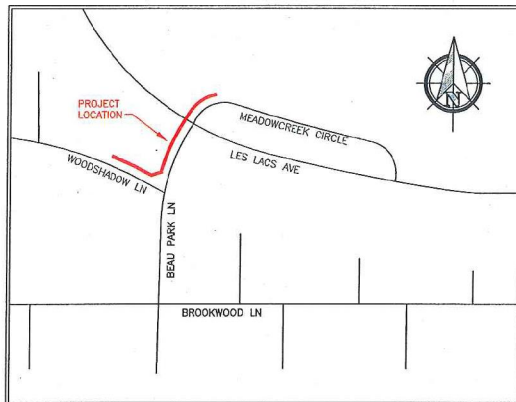

RMO NUMBERS INCLUDED:

- 86761

GENERAL PROJECT NOTES

1. ALL CONSTRUCTION WORK WITHIN THE PUBLIC RIGHT-OF-WAY SHALL BE DONE IN ACCORDANCE WITH THE ORDINANCES AND REGULATIONS OF THE MUNICIPALITY IN WHICH THE WORK IS TO BE PERFORMED.
2. EXISTING UTILITY LOCATIONS SHOWN ARE TAKEN FROM AVAILABLE RECORDS AND MAY NOT BE ALL INCLUSIVE. UTILITY LOCATIONS ARE GENERALLY SCHEMATIC IN NATURE AND MAY NOT ACCURATELY REFLECT THE SIZE AND LOCATION OF EACH PARTICULAR UTILITY. THE CONSTRUCTION CONTRACTOR SHALL ASSUME RESPONSIBILITY FOR ACTUAL LINE LOCATES IN THE FIELD AND THE PROTECTION OF ALL EXISTING FACILITIES WHETHER SHOWN OR NOT. THE CONSTRUCTION CONTRACTOR SHALL ALSO ASSUME RESPONSIBILITY FOR REPAIRS TO ANY EXISTING FACILITY DAMAGED AS A DIRECT RESULT OF THE CONSTRUCTION ACTIVITIES WHETHER THE FACILITY IS SHOWN ON THE DRAWINGS OR NOT.
3. THE CONSTRUCTION CONTRACTOR SHALL BE RESPONSIBLE FOR CONTACTING ALL DEPARTMENTS WITHIN THE MUNICIPALITY AND THE UTILITY COMPANIES AT LEAST TWO WORKING DAYS PRIOR TO THE COMMENCEMENT OF WORK.

CALL BEFORE YOU DIG

811

IT'S THE LAW

4. IT SHALL BE THE RESPONSIBILITY OF THE CONSTRUCTION CONTRACTOR TO: A) PREVENT DAMAGE TO PRIVATE AND PUBLIC PROPERTY. B) RESTORE ALL AREAS EFFECTED BY THE CONSTRUCTION TO ORIGINAL OR BETTER CONDITION.
5. BARRICADING AND TRAFFIC CONTROL SHALL BE THE RESPONSIBILITY OF THE CONSTRUCTION CONTRACTOR AND SHALL CONFORM TO THE "TEXAS MANUAL ON UNIFORM TRAFFIC CONTROL DEVICES". TRAFFIC FLOW AND ACCESS SHALL BE MAINTAINED DURING ALL PHASES OF CONSTRUCTION. THE CONSTRUCTION CONTRACTOR IS RESPONSIBLE FOR PROVIDING TRAFFIC SAFETY MEASURES FOR WORK ON THE PROJECT. THE WORK SITE SHALL BE SUITABLY LIT AND BARRICADED AT NIGHT.
6. THE CONSTRUCTION CONTRACTOR SHALL ABIDE BY ALL APPLICABLE FEDERAL, STATE AND LOCAL LAWS GOVERNING EXCAVATION. THE CONSTRUCTION CONTRACTOR SHALL PROVIDE ALL TRENCH SAFETY SYSTEMS THAT COMPLY WITH ALL LAWS GOVERNING EXCAVATION. THE CONSTRUCTION CONTRACTOR SHALL BE SOLELY RESPONSIBLE FOR ALL ASPECTS OF WORK RELATED TO EXCAVATION.
7. ALL CONCRETE USED IN ANY ROADWAY SHALL BE IN COMPLIANCE WITH THE SPECIFIED CLASSES OF CONCRETE IN THE STANDARD SPECIFICATIONS 5.8 "PORTLAND CEMENT CONCRETE PAVEMENT" AND 7.4.5 "QUALITY OF CONCRETE" AS AMENDED BY THE ADDENDUM TO THE NORTH CENTRAL TEXAS STANDARD SPECIFICATIONS FOR PUBLIC WORKS CONSTRUCTION - 2004. ALL OTHER CONCRETE SHALL BE CLASS A CONCRETE.
8. ALL REINFORCING STEEL AND DOWEL BARS IN PAVEMENT SHALL BE SUPPORTED AND MAINTAINED AT THE CORRECT CLEARANCES BY THE USE OF BAR CHAINS OR OTHER APPROVED SUPPORT.
9. ALL CONDUIT MUST BE PLACED WITH A MINIMUM 42" OF COVER, UNLESS OTHERWISE SPECIFIED.
10. ALL BACKFILLING WILL BE MECHANICALLY TAMPED IN LIFTS TO A DENSITY OF 95% PROCTOR. THE REQUIRED DENSITY WILL BE OBTAINED BY USING TAMPERS, RAMMERS OR ROLLING EQUIPMENT. LIFTS MAY VARY ACCORDING TO THE TYPE OF EQUIPMENT USED TO OBTAIN THE REQUIRED DENSITY. SAND AND DEBRIS FREE MATERIAL WILL BE USED FOR BACKFILL.

DFWT CONTACT: DAVID HATTON 972.670.2113

PREPARED BY: DFW TELECOM, INC.

LEGEND	
	PROPOSED CONDUIT
	BORE UNDER CONCRETE
	EXISTING CONDUIT
	EXISTING CUSTOMER CONDUIT
	OVERHEAD: NEW BUILD
	OVERHEAD: OVERLASH

TYPICAL UTILITY CROSSING

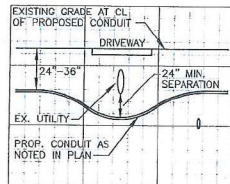

TRENCH DETAIL
NOT TO SCALE

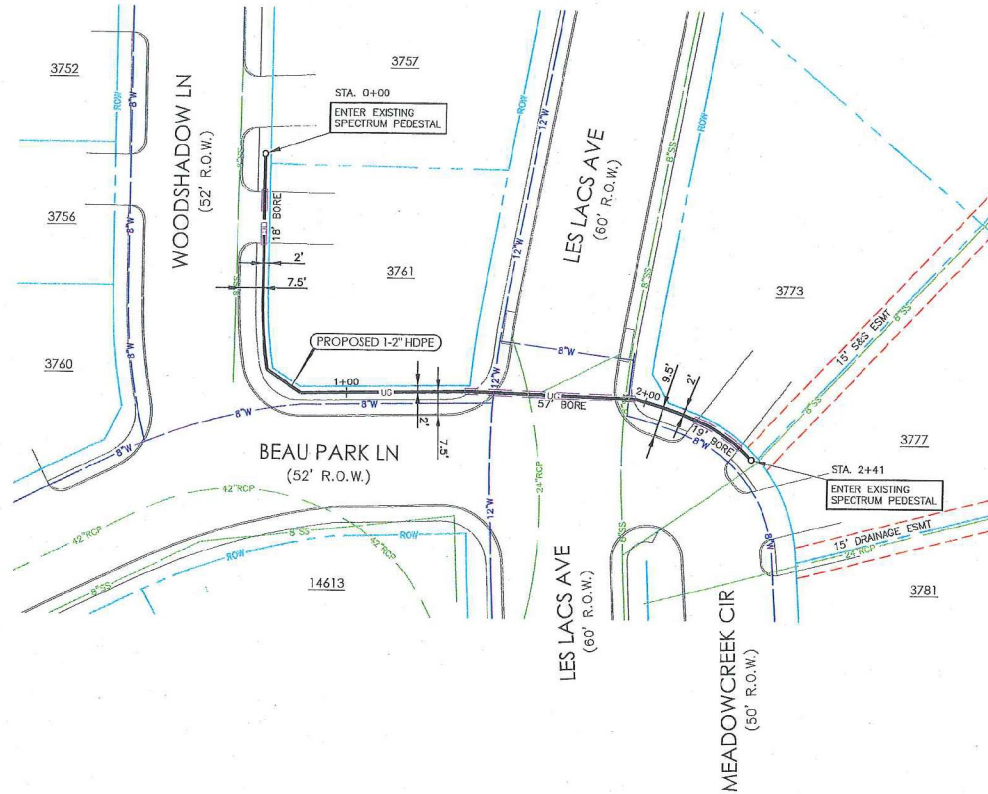
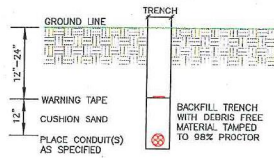

PREPARED BY:



DFWT CONTACT: DAVID HATTON 972.670.2113

ESTIMATED SHEET TOTALS

DESCRIPTION	QUANTITY	DESCRIPTION	QUANTITY
TRENCH & PLACE CONDUIT	147'	PLACE FLUSH MOUNT VAULT	
BORE & PLACE CONDUIT	94'	PLACE PEDESTAL	
BORE & PLACE STEEL CASING		PLACE FLUSH DROP BUCKET	
PULL THROUGH EXISTING CONDUIT		PLACE POWER SUPPLY	
R & R CONCRETE SIDEWALK (SF)		PLACE WALL BOX & RISER	
R & R CONCRETE PAVEMENT (SF)		PLACE U-GUARD RISER	
OVERHEAD: OVERLASH		OVERHEAD: NEW BUILD	

NORTH



SHEET 1 OF 1

PROJECT: SPAN REPLACEMENT
(REPLACE EXIST. CATV DUE TO DAMAGE)

ADDRESS: LES LACS AVE & BEAU PARK LN
CITY, STATE: ADDISON, TEXAS

HORIZONTAL SCALE 1" = 40'	VERTICAL SCALE 1" = 10'	JOB NUMBER: 86762	DATE: 1/24/2017
------------------------------	----------------------------	----------------------	--------------------

