



FOR ADDISON USE ONLY
 Permit Number: W-1357
 Location: 14621 Inwood Rd.

APPLICATION

Right of Way Work Permit - PUBLIC UTILITY/CTP

(For Public Utility/CTP - Street Cut/Excavation/Lane Closure)

PLEASE PRINT LEGIBLY

Date of application: 3/29/18

Facility Owner Company: Level 3 Communications Company Phone #: 214-764-2517

Utility/CTP Representative: Robert Ulbik Cell Phone #: 214-287-8353

General Contractor: Texstar Enterprises Company Phone #: 214-366-7878

Site Supervisor Name: Eric McCol 24 hour phone #: 972-672-2229

Work Site Address and Location: Landmark Place and 14621 Inwood Rd

Purpose and general description of work: Bore and place conduit and fiber to serve Tuesday Morning Corporate.

Proposed Start Work Date: 04/04/18 Estimated Completion Date: 05/04/18

Pavement Cut? Yes No Directional Bore/Boring? Yes No

Excavation? Yes No Lane Closure? Yes No Other: _____ ? Yes No

Robert Ulbik Robert Ulbik OSP Engineer
 Applicant's Printed Name Signature Position with Company

Applicant's Email: Robert.Ulbik@centurylink.com Applicant's Phone Number: 214-287-8353

Tom Jensen 214-764-2517 Century Link
 Direct Supervisor's Printed Name Phone Number Company Name

FOR ADDISON USE ONLY

Received By: Unico S. Entered? Yes No Received Date: 3-29-18

Approved By: Dave Wilde Inspector: JE Issue Date: 3/29/18

Plans Submitted? Yes No N/A Traffic Control Plan Submitted? Yes No N/A Expiration Date: 4/13/18

Insurance Provided? Yes No On File Performance/Maintenance Bond? Yes No On File N/A

Fee Paid: NA Receipt#: CTP Date: 4-4-18 Processed By: BT

Picked Up By: Joe Hoschar Company: One Global Telecom Date & Time: 2:43 PM

TOWN OF ADDISON INFRASTRUCTURE AND DEVELOPMENT SERVICES
 DEPARTMENT ATTN.: RIGHT OF WAY PERMIT - DAVE WILDE 972-450-2847
 16801 WESTGROVE RD. ADDISON, TX 75001-9010
 PHONE: 972-450-2871 FAX: 972-450-2837



FOR ADDISON USE ONLY
Permit Number: W-1357
Location: 14621 Inwood Rd.

APPLICATION

Right of Way Work Permit -PUBLIC UTILITY/CTP
(For Public Utility/CTP - Street Cut/Excavation/Lane Closure)

Sub-Contractor List

PLEASE PRINT LEGIBLY

General Contractor's Name: Texstar Enterprises General Contractor's Phone #: 214-366-7878

Sub-Contractor #1 Company Name: No Subs Address: _____

Print Sub-Contractor's Name: _____ Sub-Contractor Phone #: _____

Print Site Supervisor's Name: _____ Supervisor's Phone #: _____

Insurance Provided? Yes No On File

Sub-Contractor #2 Company Name: _____ Address: _____

Print Sub-Contractor's Name: _____ Sub-Contractor Phone #: _____

Print Supervisor's Name: _____ Supervisor's Phone #: _____

Insurance Provided? Yes No On File

Sub-Contractor #3 Company Name: _____ Address: _____

Print Sub-Contractor's Name: _____ Sub-Contractor Phone #: _____

Print Supervisor's Name: _____ Supervisor's Phone #: _____

Insurance Provided? Yes No On File

RIGHT OF WAY, EXCAVATION &
LANE CLOSURE PERMIT

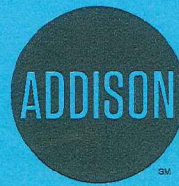

INFRASTRUCTURE &
DEVELOPMENT SERVICES

16801 WESTGROVE DRIVE
ADDISON, TEXAS 75001
972.450.2871

W-1357

PERMIT NUMBER

4/04/18

START DATE

5/04/18

EST. COMPLETION DATE

TEXSTAR ENTERPRISES

CONTRACTOR

LEVEL3

FOR

14621 INWOOD RD

LOCATION (ADDRESS)

FROM 14800 LANDMARK BLVD, ACROSS INWOOD TO ADDRESS

LOCATION (ACTUAL)

INSTALL CABLE FACILITIES FOR SERVICE TO ADDRESS

TYPE OF WORK

THIS CARD MUST BE DISPLAYED ON THE JOB SITE AT ALL TIMES.

LOCATION: 14621 INWOOD RD., ADDISON, TX 75001
 PROJECT NAME: TUESDAY MORNING CORP. HEADQUARTERS
 CLLI: ADSOTX02, NETBUILD: N382845

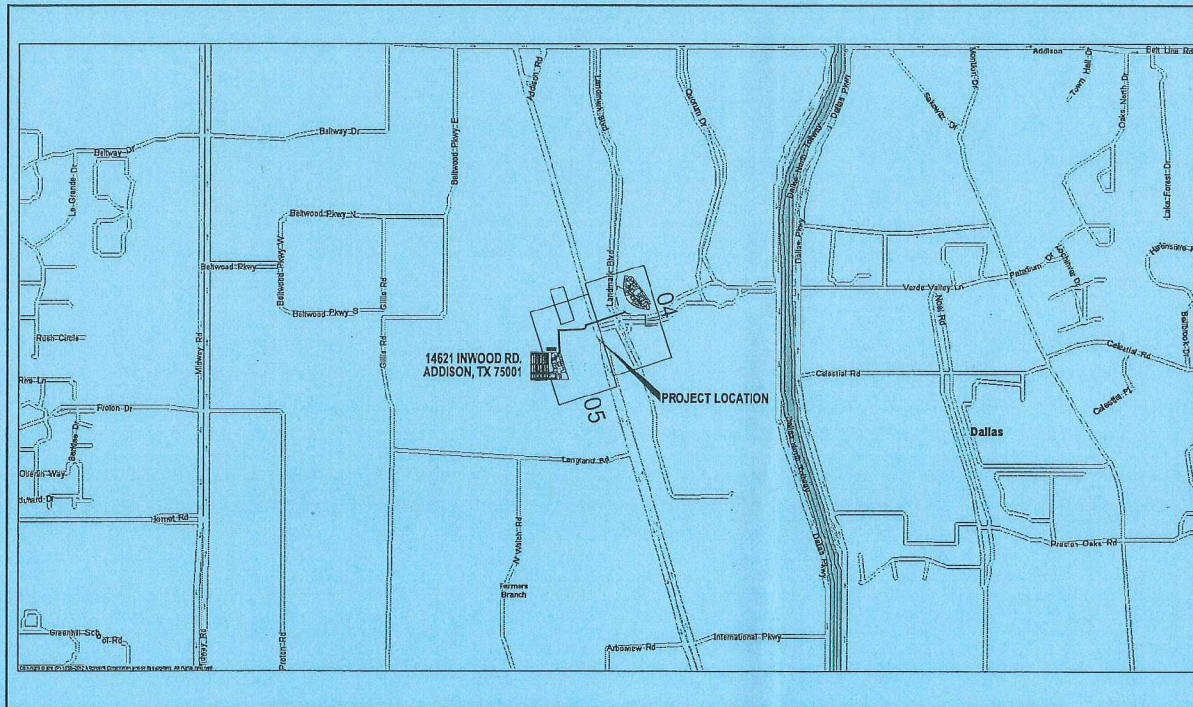

SITE LOCATION
 MAPSCO PAGE: 77 E3

CONTACTS

LEVEL3 COMMUNICATIONS
 PLANT MANAGER:
 1860 N. STEMMONS FRWY.
 SUITE 600
 DALLAS, TX. 75207
 DON HURLA
 OFFICE: (214) 764-2517
 CELL: (214) 770-6379

OSP ENGINEER:
 ROBERT ULBIK
 (214) 287-8353

CONSTRUCTION CONTRACTOR:

ENGINEERING CONTRACTOR:
 GXT LTD
 1130 E. ARAPAHO RD., SUITE 625
 RICHARDSON, TX 75081
 PROJECT ENGINEER:
 JOHN BERKA
 OFFICE: (469) 385-5163
 CELL: (214) 929-1850

CLIENT:
 TUESDAY MORNING CORP. HQ.
 PROPERTY MANAGEMENT:
 RUSSELL MILLWEA
 940-597-1802

TOWN OF ADDISON
 16901 WEST GROVE DR.
 ADDISON TX 75001
 DAVE WILDE
 (872) 392-2847

UTILITIES:
 TEXAS ONE CALL SYSTEM
 1-800-245-4545

SITE INDEX

- 01 - COVER SHEET/SITE LOCATION
- 02 - LEGEND & SYMBOLS
- 03 - GENERAL NOTES
- 04 - 05 - CONSTRUCTION PLANS
- 06 - TYPICAL CONSTRUCTION DETAILS
- 07 - FIBER ROUTE SCHEMATIC
- 08 - SITE PHOTOGRAPHS
- 09 - RATE CARD TABLE

SCOPE OF WORK:

BORE 259' AND PLACE 1-4" HDPE E/W 3-1.25"
 INNERDUCT. BORE AND TRENCH 195' OF
 3-1.25" INNERDUCT. BORE 140' OF 2"
 INNERDUCT. PLACE 17' OF 2" EMT AND 1-2"
 U/B. PLACE 3-30"x48"x36" HANDHOLE. PLACE
 110' OF 4-11" PLENUM INNERDUCT.
 PLACE 1, 131' OF 24ct. FIBER OPTIC CABLE.



3				AS-BUILT
2				REVISION # 1
1	01/17/18	GXT/ab	CM	ORIGINAL
NO.	DATE	ENG DESIGN	DRAFTING	COMMENT

Level(3)
 COMMUNICATIONS

LEVEL 3 ENGINEER: ROBERT ULBIK
 ENGINEERING FIRM: GXT
 PROJECT NUMBER: 151346
 LOCATION: 14621 INWOOD RD., ADDISON, TX 75001
 DRAWING NAME: 14621-INWOOD-RD-ADDISON-TX_001-009.dwg
 CONFIDENTIAL/PROPRIETARY SHEET: 01 OF 09

LEGEND

LINETYPES

	UG FIBER - EXISTING
	UG FIBER - PROPOSED
	AERIAL FIBER - EXISTING
	AERIAL FIBER - PROPOSED
	STRAND - EXISTING
	STRAND - PROPOSED
	CONDUIT - EXISTING
	CONDUIT - PROPOSED
	INNERDUCT - EXISTING
	INNERDUCT - PROPOSED
	GAS
	WATER
	TELEPHONE
	ELECTRIC
	SANITARY SEWER (SEW)
	STORM DRAIN
	FENCE
	CABLE TV
	STEAM
	OIL
	UNKNOWN UTILITY
	RIGHT OF WAY
	EDGE OF PAVEMENT

SYMBOL	DESCRIPTION
ASW	ASPHALT SIDEWALK
BIP	BLACK IRON PIPE
BSP	BLACK STEEL PIPE
CSW	CONCRETE SIDEWALK
EOP	EDGE OF PAVEMENT
EOTW	EDGE OF TRAVEL WAY
FOC	FACE OF CURB
HDPE	HIGH DENSITY POLYETHYLENE
HH	HAND-HOLE
JB	JUNCTION BOX
MH	MANHOLE
MP	MILE POST
O/S	OFFSET
PVC	POLY VINYL CHLORIDE
RGS	RIGID GALVANIZED STEEL CONDUIT
ROW	RIGHT OF WAY
STA.	STATION

	RISER
	TELEPHONE
	POWER VAULT
	CATCH BASIN/INLET
	FIRE HYDRANT
	GROUND/BOND
	STREET LIGHT
	TREE
	CULVERT
	WING WALL
	BRIDGE
	MISC. UTILITY
	UTILITY POLE - EXISTING
	POLE - PROPOSED
	HANDHOLE - EXISTING
	HANDHOLE - PROPOSED
	MANHOLE - EXISTING
	MANHOLE - PROPOSED
	PULLBOX - EXISTING
	PULLBOX - PROPOSED

	VAULT - EXISTING
	VAULT - PROPOSED
	AERIAL STORAGE - EXISTING
	AERIAL STORAGE - PROPOSED
	VAULT/BUILDING STORAGE - EXISTING
	VAULT/BUILDING STORAGE - PROPOSED
	POLE ANCHOR/DOWN GUY - EXISTING
	POLE ANCHOR/DOWN GUY - PROPOSED
	PROPOSED DOWN GUY ON EXISTING ANCHOR
	TERMINATION - EXISTING
	TERMINATION - PROPOSED
	BUILDING CALLOUT - PROPOSED
	SPICE POINT - EXISTING
	SPICE POINT - PROPOSED
	SEQUENTIAL CALLOUT
	SEQUENTIAL IN TAIL CALLOUT
	SEQUENTIAL TAIL OUT CALLOUT

POLE NO	N/A
UTILITY1	0'-0"

POLE ATTACHMENT CALLOUT - EXISTING
USE DYNAMIC PULL DOWN TO SELECT
FROM 1 TO 6 ATTACHMENTS

POLE NO	N/A
UTILITY1	0'-0"

POLE ATTACHMENT CALLOUT - PROPOSED
USE DYNAMIC PULL DOWN TO SELECT
FROM 1 TO 6 ATTACHMENTS

1	CABLE FIBERS: FIBERS CABLE OWNER: LEVEL(3) CABLE LENGTH: LENGTH NOTES:
---	---

CABLE SPAN CALLOUT - EXISTING
FOR USE ON PAPER SPACE (SHOWN AT 50X)

1	CABLE FIBERS: FIBERS CABLE OWNER: LEVEL(3) CABLE LENGTH: LENGTH NOTES:
---	---

CABLE SPAN CALLOUT - PROPOSED
FOR USE ON PAPER SPACE (SHOWN AT 50X)

1	CONDUIT OWNER: LEVEL(3) CONDUIT LENGTH: LENGTH CONDUIT QTY: CONDUITS CONDUIT SIZE: SIZE CONDUIT TYPE: TYPE INNER DUCT QTY: INNERDUCTS INNER DUCT SIZE: SIZE INNER DUCT TYPE: TYPE NOTES:
---	--

CONDUIT CALLOUT - EXISTING
FOR USE ON PAPER SPACE (SHOWN AT 50X)
WITH OR WITHOUT INNER DUCT INFO

1	CONDUIT OWNER: LEVEL(3) CONDUIT LENGTH: LENGTH CONDUIT QTY: CONDUITS CONDUIT SIZE: SIZE CONDUIT TYPE: TYPE INNER DUCT QTY: INNERDUCTS INNER DUCT SIZE: SIZE INNER DUCT TYPE: TYPE NOTES:
---	--

CONDUIT CALLOUT - PROPOSED
FOR USE ON PAPER SPACE (SHOWN AT 50X)
WITH OR WITHOUT INNER DUCT INFO

1	STRAND TYPE: TYPE STRAND LENGTH: LENGTH NOTES:
---	--

STRAND CALLOUT - EXISTING
FOR USE ON PAPER SPACE (SHOWN AT 50X)

1	STRAND TYPE: TYPE STRAND LENGTH: LENGTH NOTES:
---	--

STRAND CALLOUT - PROPOSED
FOR USE ON PAPER SPACE (SHOWN AT 50X)



3				AS-BUILT
2				REVISION # 1
1	01/17/18	GXT/JB	CM	ORIGINAL
NO.	DATE	ENG DESIGN	DRAFTING	COMMENT
Level(3) COMMUNICATIONS				
LEVEL 3 ENGINEER: ROBERT ULBIK				
ENGINEERING FIRM: GXT				
PROJECT NUMBER: 151346				
LOCATION: 14621 INWOOD RD., ADDISON, TX 75001				
DRAWING NAME: 14621-INWOOD-RD-ADDISON-TX_001-009.dwg				
CONFIDENTIAL/PROPRIETARY				
				SHEET: 02 OF 09

DALLAS COUNTY
14621 INWOOD RD.,
ADDISON, TX 75001

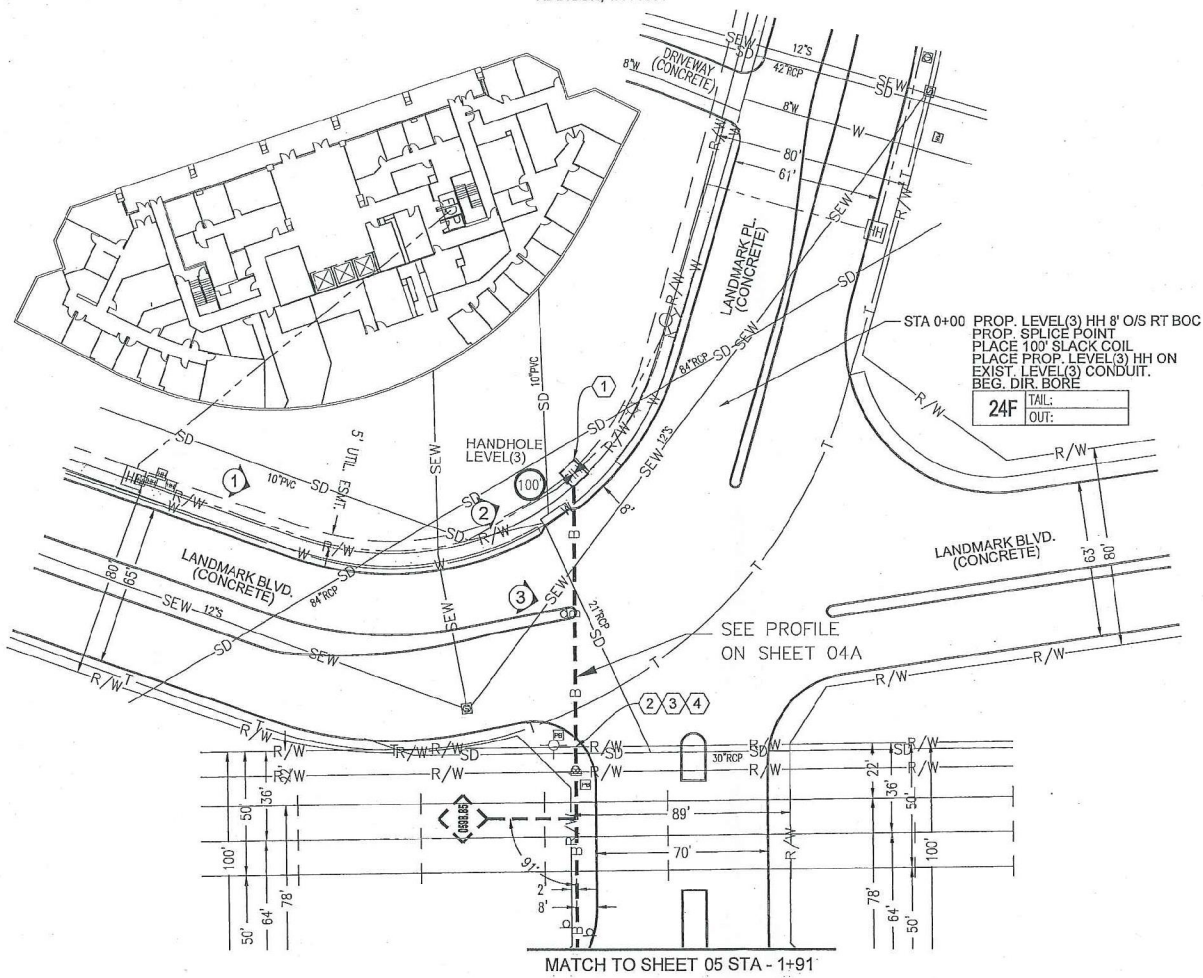

CONSTRUCTION NOTES

- ① CABLE FIBERS: 24
CABLE OWNER: LEVEL(3)
CABLE LENGTH: 100'
NOTES: PLACE LEVEL(3)
30"x48"x36" HH.
PLACE 100' SLACK COIL.
- ② CONDUIT OWNER: LEVEL(3)
CONDUIT LENGTH: 191'
CONDUIT QTY: 1
CONDUIT SIZE: 4"
CONDUIT TYPE: HDPE
NOTES: PLACE 1-1"
HDPE NOT. IN EXIST.
4" CUSTOMER OWNED
CONDUIT.
- ③ CONDUIT OWNER: LEVEL(3)
CONDUIT LENGTH: 191'
CONDUIT QTY: 3
CONDUIT SIZE: 1.25"
CONDUIT TYPE: HDPE
NOTES: DIR. BORE.
- ④ CABLE FIBERS: 24
CABLE OWNER: LEVEL(3)
CABLE LENGTH: 291'
NOTES: PLACE CABLE
THRU CONDUITS.
INCL. 100' SLACK COIL.

- ③ SYMBOL CORRESPONDS TO PHOTO LOCATIONS AND ORIENTATION. SEE SHEET #08 FOR SITE PHOTOGRAPHS.
- ② SYMBOL CORRESPONDS TO PHOTO LOCATIONS AND ORIENTATION. SEE SHEET #08 FOR SITE PHOTOGRAPHS.
- ① SYMBOL CORRESPONDS TO PHOTO LOCATIONS AND ORIENTATION. SEE SHEET #08 FOR SITE PHOTOGRAPHS.

AS-BUILT			
REVISION # 1			
1	01/17/18	GXT/JB	CM
NO.	DATE	ENG DESIGN	DRAFTING
			COMMENT



LEVEL 3 ENGINEER: ROBERT ULBIK
ENGINEERING FIRM: GXT
PROJECT NUMBER: 151346
LOCATION: 14621 INWOOD RD., ADDISON, TX 75001
DRAWING NAME: 14621-INWOOD-RD-ADDISON-TX-01-069.dwg
CONFIDENTIAL/PROPRIETARY



Page Rate Card			
Unit Code & Description	Units	Estimated Quantity	Actual Quantity
UGB-30830 - Place Locate Wire in Existing Conduit	FT	191	
UGB-30960 - Place up to 288 count FOC in conduit, up to 1500'	FT	291	
UGB-31270 - Place New - 30"x48"x36" - Non-concrete Manhole / Handhole	EACH	1	
UGB-30570 - Directional Bore up to 1500'. 1 HDPE conduit 4"	FT	191	
UGB-30900 - Place Three - Up to 2" HDPE in existing conduit	FT	191	

Page Rate Card			
Unit Code & Description	Units	Estimated Quantity	Actual Quantity
MAT-92070 - Conduit: 1 1/4" HDPE SDR-11	FT	573	
MAT-92100 - Conduit: 4" HDPE SDR-11	FT	191	
MAT-92970 - Tier 15 30"x48"x36" - w/ knock-outs and racking - Including Cover	EACH	1	
MAT-91970 - Mule Tape - 1800lb 3/8" wide	FT	573	
MAT-91890 - Locate wire #10 AWC - solid copper with insulated jacket	FT	191	
MAT-92020 - Sod	SQ FT	20	

PROFILE
NORTH SIDE OF LANDMARK PL.
LOOKING SOUTH

SCALE
HOR: 1"=50'
VER: 1"=10'

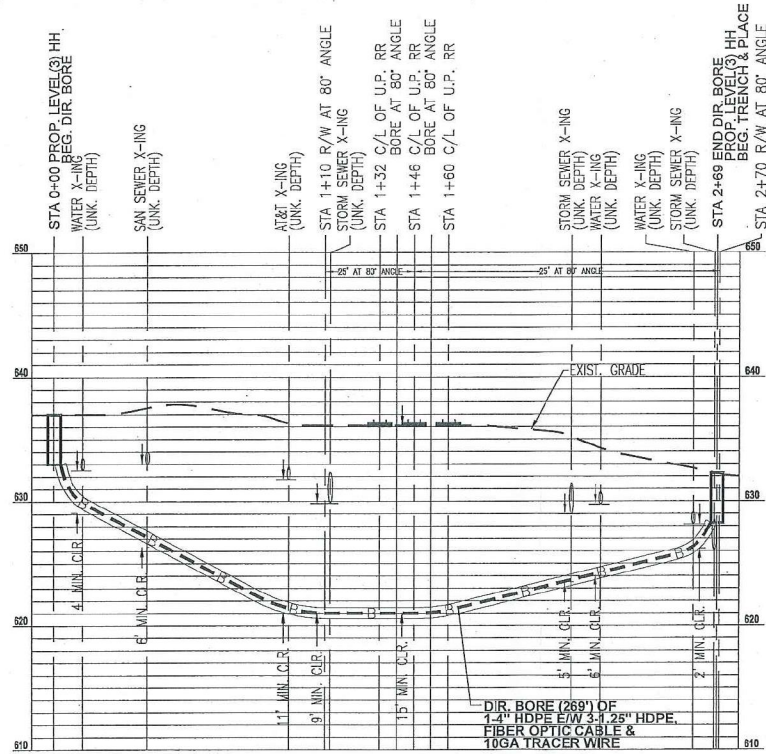

3				AS-BUILT
2				REVISION # 1
1	01/17/18	GXT/JB	CM	ORIGINAL
NO.	DATE	ENG DESIGN	DRAFTING	COMMENT

Level(3)
COMMUNICATIONS

LEVEL 3 ENGINEER: ROBERT ULBIK
ENGINEERING FIRM: GXT
PROJECT NUMBER: 151846
LOCATION: 14621 INWOOD RD., ADDISON, TX 75001
DRAWING NAME: 14621-INWOOD-RD-ADDISON-TX_001-009.dwg
CONFIDENTIAL/PROPRIETARY SHEET: 04A OF 09

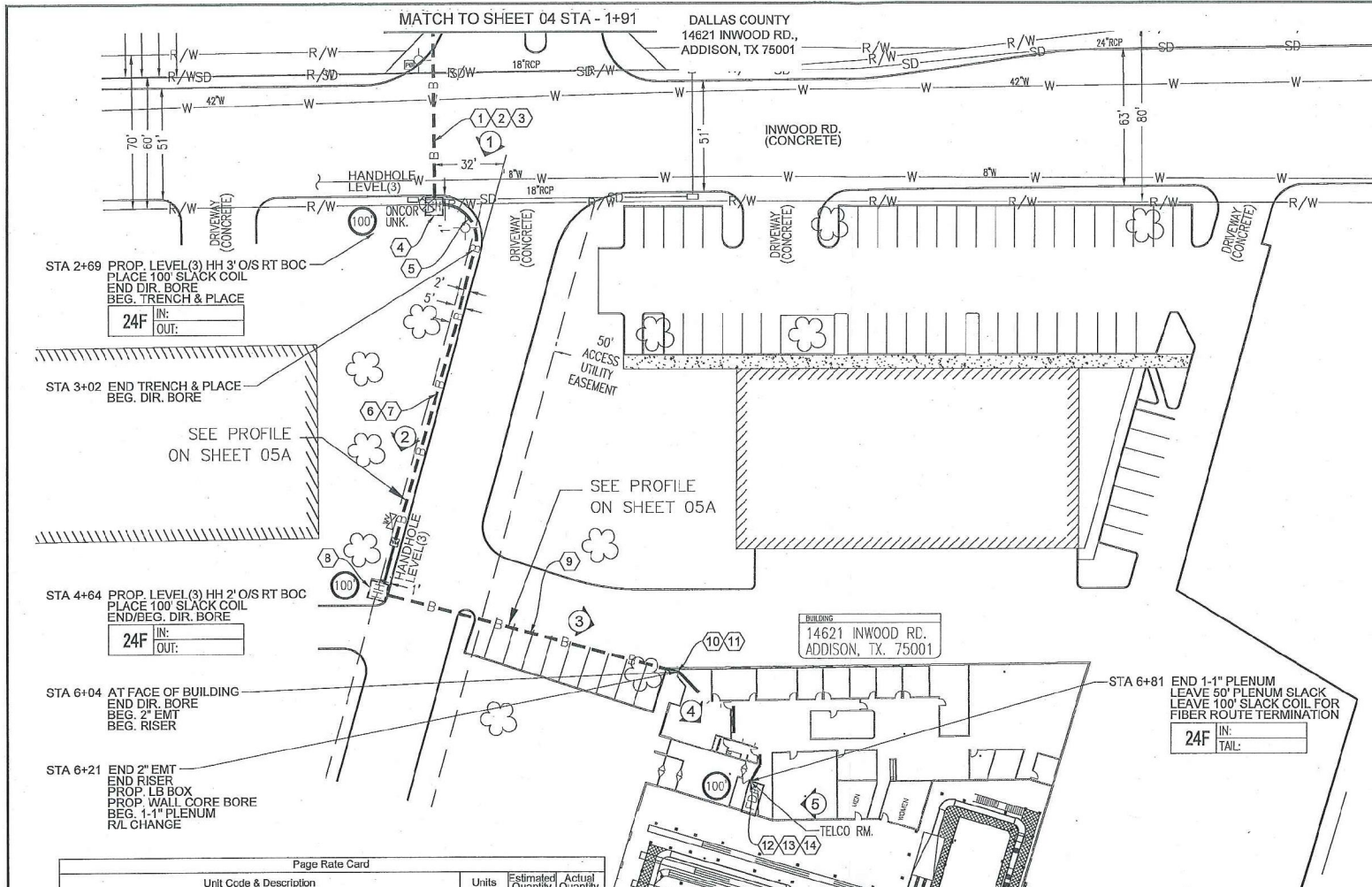

CONSTRUCTION NOTES

- ① CONDUIT OWNER: LEVEL(3)
CONDUIT LENGTH: 75'
CONDUIT QTY: 1
CONDUIT SIZE: 4"
CONDUIT TYPE: HDPE
NOTES: DIR. BORE
1-4" CASING E/W
3-1.25" ID.
- ② CONDUIT OWNER: LEVEL(3)
CONDUIT LENGTH: 75'
CONDUIT QTY: 3
CONDUIT SIZE: 1.25"
CONDUIT TYPE: HDPE
NOTES: PULL IN CASING.
- ③ CABLE FIBERS: 24
CABLE OWNER: LEVEL(3)
CABLE LENGTH: 178'
NOTES: PLACE CABLE THRU CONDUITS.
INCL. 100' SLACK COIL.
- ④ CABLE FIBERS: 24
CABLE OWNER: LEVEL(3)
CABLE LENGTH: 100'
NOTES: PLACE LEVEL(3) 30"x48"x36" HH.
PLACE 100' SLACK COIL.
- ⑤ CONDUIT OWNER: LEVEL(3)
CONDUIT LENGTH: 33'
CONDUIT QTY: 3
CONDUIT SIZE: 1.25"
CONDUIT TYPE: HDPE
NOTES: TRENCH & PLACE.
- ⑥ CONDUIT OWNER: LEVEL(3)
CONDUIT LENGTH: 162'
CONDUIT QTY: 3
CONDUIT SIZE: 1.25"
CONDUIT TYPE: HDPE
NOTES: DIR. BORE.
- ⑦ CABLE FIBERS: 24
CABLE OWNER: LEVEL(3)
CABLE LENGTH: 295'
NOTES: PLACE CABLE THRU CONDUITS.
INCL. 100' SLACK COIL.
- ⑧ CABLE FIBERS: 24
CABLE OWNER: LEVEL(3)
CABLE LENGTH: 100'
NOTES: PLACE LEVEL(3) 30"x48"x36" HH.
PLACE 100' SLACK COIL.
- ⑨ CONDUIT OWNER: LEVEL(3)
CONDUIT LENGTH: 140'
CONDUIT QTY: 1
CONDUIT SIZE: 2"
CONDUIT TYPE: HDPE
NOTES: DIR. BORE.
- ⑩ CONDUIT OWNER: LEVEL(3)
CONDUIT LENGTH: 17'
CONDUIT QTY: 1
CONDUIT SIZE: 2"
CONDUIT TYPE: EMT
NOTES: PROP. RISER. 17'
- ⑪ PROP. 2" CORE BORE.
- ⑫ CONDUIT OWNER: LEVEL(3)
CONDUIT LENGTH: 110'
CONDUIT QTY: 1
CONDUIT SIZE: 1"
CONDUIT TYPE: PLENUM
NOTES: PLACE 1" PLENUM
- ⑬ CABLE FIBERS: 24
CABLE OWNER: LEVEL(3)
CABLE LENGTH: 367'
NOTES: PLACE CABLE THRU CONDUITS.
INCL. 100' SLACK COIL.
- ⑭ LEAVE 100' SLACK COIL FOR FIBER ROUTE TERMINATION.

⑤	SYMBOL CORRESPONDS TO PHOTO LOCATIONS AND ORIENTATION. SEE SHEET #08 FOR SITE PHOTOGRAPHS.		
④	SYMBOL CORRESPONDS TO PHOTO LOCATIONS AND ORIENTATION. SEE SHEET #08 FOR SITE PHOTOGRAPHS.		
③	SYMBOL CORRESPONDS TO PHOTO LOCATIONS AND ORIENTATION. SEE SHEET #08 FOR SITE PHOTOGRAPHS.		
②	SYMBOL CORRESPONDS TO PHOTO LOCATIONS AND ORIENTATION. SEE SHEET #08 FOR SITE PHOTOGRAPHS.		
①	SYMBOL CORRESPONDS TO PHOTO LOCATIONS AND ORIENTATION. SEE SHEET #08 FOR SITE PHOTOGRAPHS.		
3			AS-BUILT
2			REVISION # 1
NO.	DATE	ENG DESIGN	DRAFTING
1	01/17/18	GXT/JB	CM
			ORIGINAL
			COMMENT

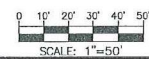
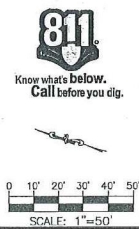

Page Rate Card			
Unit Code & Description	Units	Estimated Quantity	Actual Quantity
UGB-30020 - Trench up to 1500'; Trench 48" minimum cover	FT	33	
UGB-30160 - Place 3 - HDPE conduits in open trench up to 2" (on one reel)	FT	33	
UGB-30530 - Directional Bore up to 1500'; 1 HDPE conduit up to 2"	FT	140	
UGB-30550 - Directional Bore up to 1500'; 3 HDPE conduits up to 2" (on one reel)	FT	162	
UGB-30570 - Directional Bore up to 1500'; 1 HDPE conduit 4"	FT	78	
UGB-30830 - Place Locate Wire in Existing Conduit	FT	490	
UGB-30900 - Place Three - Up to 2" HDPE in existing conduit	FT	78	
UGB-30960 - Place up to 288 count FOC in conduit, up to 1500'	FT	613	
UGB-31270 - Place New - 30"x48"x36" - Non-concrete Manhole / Handhole	EACH	2	

ISP-41010 - Core drill up to 2" diameter.	EACH	1	
ISP-41090 - Install EMT or AC power conduit up to 2" in diameter.	FT	17	
ISP-41160 - Install innerduct (plenum, corrugated, etc.) <= 1.5" in existing conduit. (PLENUM)	FT	110	
ISP-41180 - Place junction box up to 12"x12"	EACH	1	
ISP-42100 - Place fiber cable in conduit or innerduct.	FT	227	

Page Rate Card			
Unit Code & Description	Units	Estimated Quantity	Actual Quantity
MAT-90070 - Conduit: 1 1/4" HDPE SDR-11	FT	619	
MAT-90090 - Conduit: 2" HDPE SDR-11	FT	140	
MAT-90100 - Conduit: 4" HDPE SDR-11	FT	78	
MAT-90650 - EMT 2"	FT	17	
MAT-90680 - Innerduct: 1" Plenum	FT	110	
MAT-90970 - Tier 15 30"x48"x36" - w/ knock-outs and racking - Including Cover	EACH	2	
MAT-91760 - 15-20 Receptacle	EACH	1	
MAT-91850 - 5-20R Duplex Outlet	EACH	1	
MAT-91970 - Mule Tape - 1800lb 3/8" wide	FT	1,659	
MAT-91990 - Locate wire #10 AWG - solid copper with insulated jacket	FT	490	
MAT-92020 - Sod	SQ FT	40	

PROFILE
NORTH SIDE OF DRIVEWAY

LOOKING SOUTH

SCALE:
HOR: 1"=50'
VER: 1"=10'

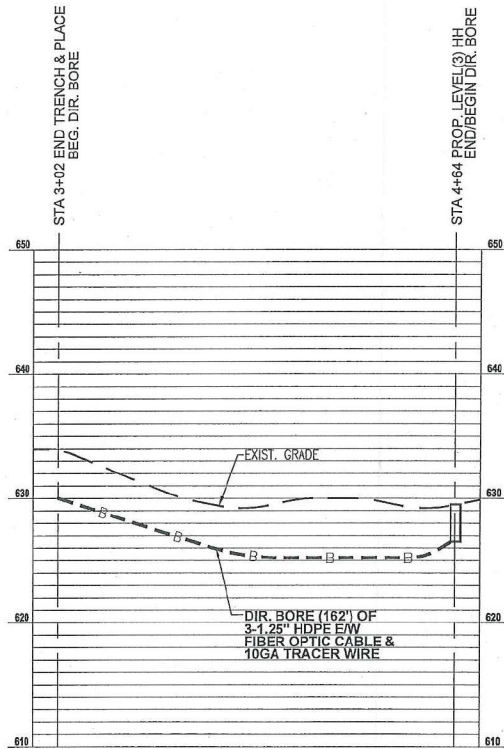

PROFILE
WEST SIDE OF PROPERTY

LOOKING EAST

SCALE:
HOR: 1"=50'
VER: 1"=10'

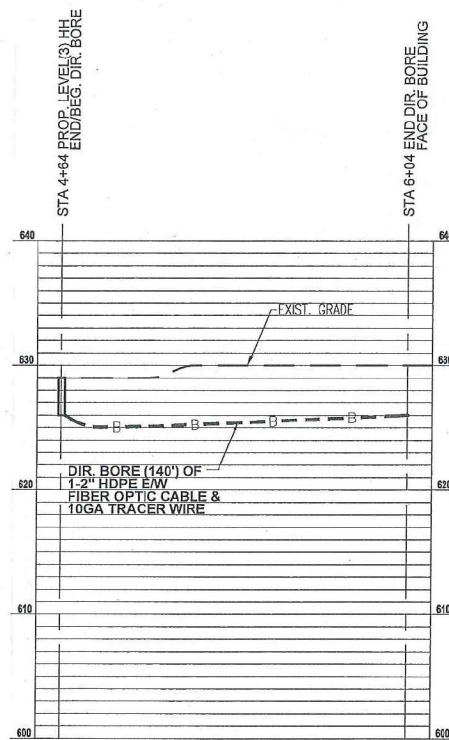

Know what's below.
Call before you dig.

3				AS-BUILT
2				REVISION # 1
1	01/17/18	GXT/UB	CM	ORIGINAL
NO.	DATE	ENG DESIGN	DRAFTING	COMMENT

Level(3)
COMMUNICATIONS

LEVEL 3 ENGINEER: ROBERT ULBIK
ENGINEERING FIRM: GXT
PROJECT NUMBER: 151346
LOCATION: 14621 INWOOD RD., ADDISON, TX 75001
DRAWING NAME: 14621-INWOOD-RD-ADDISON-TX_001-009.dwg
CONFIDENTIAL/PROPRIETARY SHEET: 05A OF 09

TYPICALS

TYPICAL DETAIL -- B
DIRECTIONAL BORE
UNDER ROAD / HIGHWAY / INTERSTATE

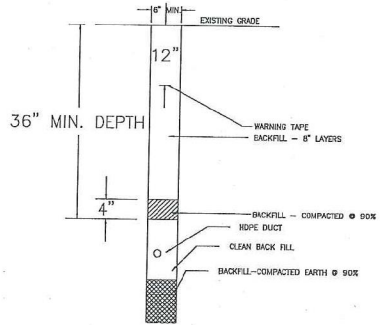
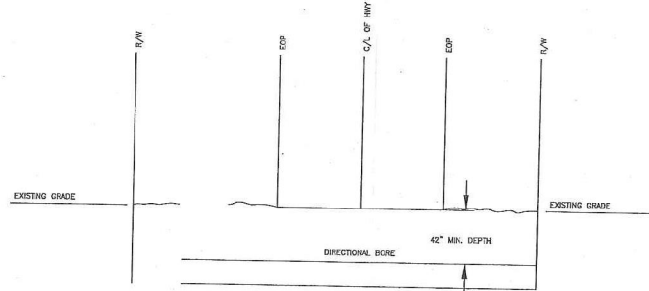

TYPICAL DETAIL -- #A
TRENCH IN SOIL (NON TRAFFIC AREAS)

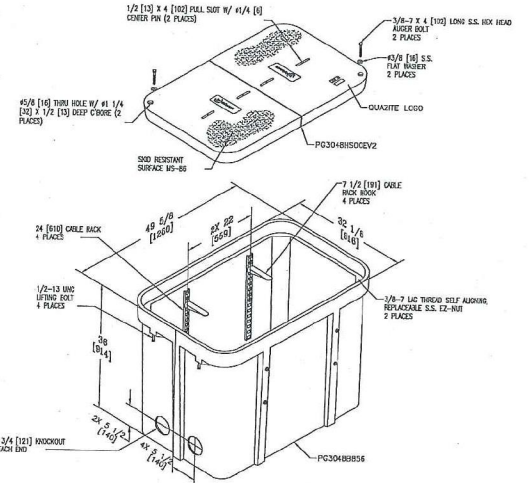

TYPICAL DETAIL -- C
QUARTZITE 30048B36 ASSEMBLY
W/ (1) 24' CABLE RACKS
& (4) 7 1/2" HOOKS
PG3048B36V2

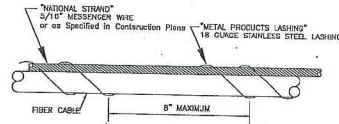

TYPICAL DETAIL -- F
LASHING

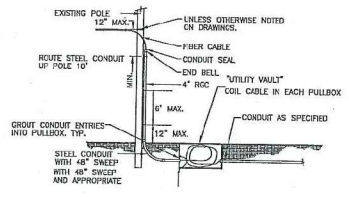

TYPICAL DETAIL -- E
AERIAL/UNDERGROUND TRANSITION

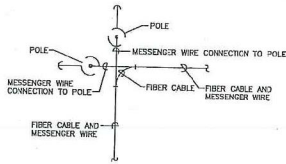

TYPICAL DETAIL -- G
CORNER/DEAD END POLE DOWNGUY

TYPICAL DETAIL -- #
PLACE SPLIT PVC BRANCH WYE
E/W H--STRIP

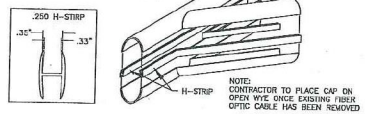
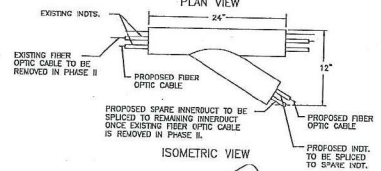

NOTE: CONTRACTOR TO PLACE CAP ON OPEN WYE ONCE EXISTING FIBER OPTIC CABLE HAS BEEN REMOVED



3				AS-BUILT
2				REVISION # 1
1	01/17/18	GXT/JB	CM	ORIGINAL
NO.	DATE	ENG DESIGN	DRAFTING	COMMENT
Level(3) COMMUNICATIONS				
LEVEL 3 ENGINEER: ROBERT ULBIK				
ENGINEERING FIRM: GXT				
PROJECT NUMBER: 151346				
LOCATION: 14621 INWOOD RD., ADDISON, TX 75301				
DRAWING NAME: 14621-INWOOD RD-ADDISON-TX_001-009.dwg				
CONFIDENTIAL/PROPRIETARY				SHEET: 06 OF 09