



**FOR ADDISON USE ONLY**  
 Permit Number: W-1343  
 Location: 14621 Stratford Ct.

**APPLICATION**  
**Right of Way Work Permit -FRANCHISE**  
 (For Franchise Utility/CTP - Street Cut/Excavation/Lane Closure)

**PLEASE PRINT LEGIBLY**

Date of Application: 3/8/18

Facility Owner Company: AT&T Company Phone #: 800-924-9420  
 Utility/CTP Representative: Susan Esquivel Cell Phone #: 214-467-8276  
 Utility/CTP Representative E-Mail: \_\_\_\_\_

General Contractor: Tenex Construction Company Phone #: 972-913-8883  
 Site Supervisor Name: Rocky Stockman 24-hour phone #: 214-202-9093  
 Contractor E-Mail address: Rocky@tenexconstruction.com Site Foreman E-Mail: \_\_\_\_\_

Work Site Address and Location: 14621 STRATFORD CT

Purpose and general description of work: Placement of Phone Service Drop

Proposed Start Work Date: 3/12/18 Estimated Completion Date: 3/23/18

Pavement Cut?  Yes  No Directional Bore/Boring?  Yes  No  
 Excavation?  Yes  No Lane Closure?  Yes  No Other: \_\_\_\_\_ ?  Yes  No

Kim Hines Kim Hines Office Manager  
 Applicant's Printed Name Signature Position with Company

Applicant's Email: Kim@tenexconstruction.com Applicant's Phone Number: 972-913-8883  
Rocky Stockman 214-202-9093 Tenex Construction  
 Direct Supervisor's Printed Name Phone Number Company Name

Supervisor's E-Mail: \_\_\_\_\_

**FOR ADDISON USE ONLY**

Received By: Michele S. Entered?  Yes Received Date: 3.8.18

Approved By: Dave Wilde Inspector: JF Issue Date: 3/9/18

Plans Submitted?  Yes  No  N/A Traffic Control Plan Submitted?  Yes  No  N/A Expiration Date: 3/23/18

Insurance Provided?  Yes  No  On File Performance/Maintenance Bond?  Yes  No  On File  N/A

Fee Paid: NA Receipt#: CTP Date: 3-12-18 Processed By: Michele S.

Picked Up By: Rocky Company: Tenex Date & Time: 11:03AM  
3-12-18

TOWN OF ADDISON INFRASTRUCTURE AND DEVELOPMENT SERVICES  
 DEPARTMENT ATTN.: RIGHT OF WAY PERMIT - DAVE WILDE 972-450-2847  
 16801 WESTGROVE RD. ADDISON, TX 75001-9010  
 PHONE: 972-450-2871 FAX: 972-450-2837

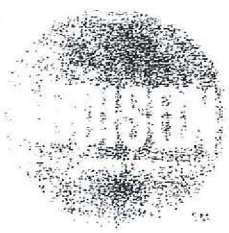

**FOR ADDISON USE ONLY**  
 Permit Number: W-1343  
 Location: 14021 Stratford Ct.

**APPLICATION**  
**Right of Way Work Permit -FRANCHISE**  
 (For Franchise Utility/CTP - Street Cut/Excavation/Lane Closure)

**Sub-Contractor List**

PLEASE PRINT LEGIBLY

General Contractor's Name: Tenex Construction General Contractor's Phone #: 972-913-8883

Sub-Contractor #1 Company Name: Magdalena Alvarez Address: \_\_\_\_\_  
 Print Sub-Contractor's Name: Magdalena Alvarez Sub-Contractor's Phone #: 972-872-5271  
 Sub-Contractor's E-Mail: \_\_\_\_\_

Print Site Supervisor's Name: Rocky Stockman Supervisor's Phone #: 214-202-9093  
 Site Supervisor's E-Mail: \_\_\_\_\_

Insurance Provided?  Yes  No  On File

Sub-Contractor #2 Company Name: Ascension Rodriguez Address: \_\_\_\_\_  
 Print Sub-Contractor's Name: Ascension Rodriguez Sub-Contractor's Phone #: 972-394-0971  
 Sub-Contractor's E-Mail: \_\_\_\_\_

Print Supervisor's Name: Rocky Stockman Supervisor's Phone #: 214-202-9093  
 Site Supervisor's E-Mail: \_\_\_\_\_

Insurance Provided?  Yes  No  On File

Sub-Contractor #3 Company Name: Tomacito Espinal Address: \_\_\_\_\_  
 Print Sub-Contractor's Name: Tomacito Espinal Sub-Contractor's Phone #: 1-214-218-5271  
 Sub-Contractor's E-Mail: \_\_\_\_\_

Print Supervisor's Name: Rocky Stockman Supervisor's Phone #: 214-202-9093  
 Site Supervisor's E-Mail: \_\_\_\_\_

Insurance Provided?  Yes  No  On File

TOWN OF ADDISON INFRASTRUCTURE AND DEVELOPMENT SERVICES  
 DEPARTMENT ATTN.: RIGHT OF WAY PERMIT - DAVE WILDE 972-450-2847  
 16801 WESTGROVE RD. ADDISON, TX 75001-9010  
 PHONE: 972-450-2871 FAX: 972-450-2837

AT&T / TENEX CONSTRUCTION  
WO#: 9374834  
14621 STRATFORD CT  
ADDISON

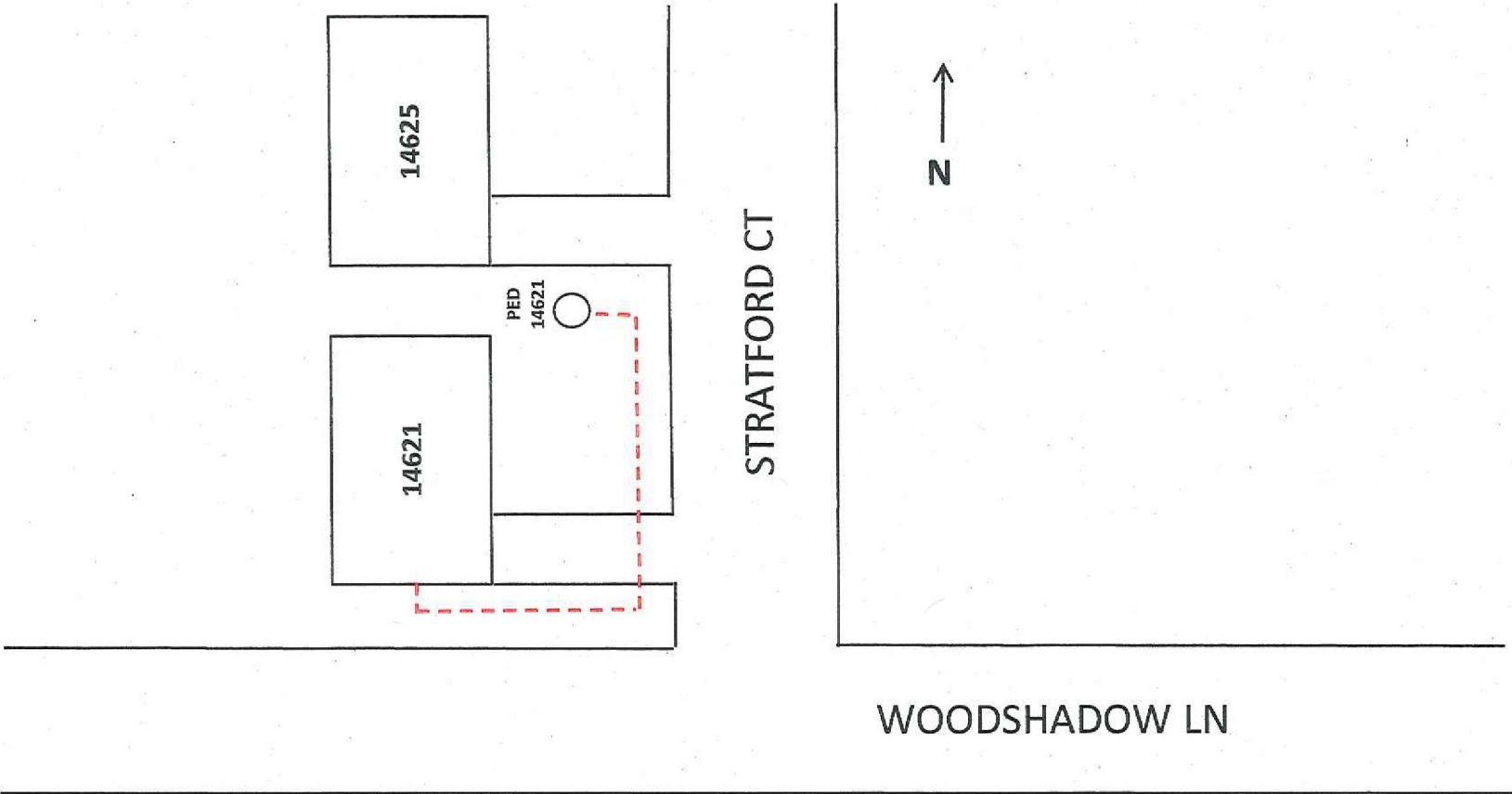

RIGHT OF WAY, EXCAVATION &  
LANE CLOSURE PERMIT



INFRASTRUCTURE &  
DEVELOPMENT SERVICES

16801 WESTGROVE DRIVE  
ADDISON, TEXAS 75001  
972.450.2871

**W-1343**

PERMIT NUMBER

**3/12/18**

START DATE

**3/23/18**

EST. COMPLETION DATE

**TENEX CONSTRUCTION AT&T**

CONTRACTOR

FOR

**14621 STRATFORD CT**

LOCATION (ADDRESS)

**FROM PEDESTAL TO HOUSE**

LOCATION (ACTUAL)

**INSTALL SERVICE TO ADDRESS**

TYPE OF WORK