



FOR ADDISON USE ONLY
 Permit Number: W-1408
 Location: 3913 Dome

APPLICATION
Right of Way Work Permit-FRANCHISE

(For Franchise Utility/CTP – Street Cut/Excavation/Lane Closure)

PLEASE PRINT LEGIBLY

Date of Application: 5/14/18
 Facility Owner Company: AT&T Company Phone #: 800-924-9920
 Utility/CTP Representative: Ramon Aziz Cell Phone #: 214-538-5536
 Utility/CTP Representative E-mail: _____
 General Contractor: Tenex Construction Company Phone #: 972-913-8883
 Site Supervisor Name: Rocky Stockman 24-hour Phone #: 214-202-9093
 Contractor E-mail: _____ Site Foreman E-mail: Rocky@tenexconstruction.com
 Work Site Address and Location: 3913 Dome Dr
 Purpose and general description of work: Placement of Phone Service Drop
 Proposed Start Work Date: 5/16/18 Estimated Completion Date: 5/15/18
 Pavement Cut? Yes No Directional Bore/Boring? Yes No Excavation? Yes No
 Lane Closure? Yes No Other: _____
 Applicant's Printed Name: Kim Hines Signature: Kim Hines Position with Company: Office Manager
 Applicant's E-mail: Kim@tenexconstruction.com Applicant's Phone #: 972-913-8883
 Direct Supervisor's Name: Rocky Stockman Phone Number: 214-202-9093 Company Name: Tenex Construction
 Supervisor's E-mail: _____

FOR ADDISON USE ONLY
 Received By: Mere S Entered? Yes No Received Date: 5-14-18
 Approved By: [Signature] Inspector: JE Issue Date: 5/18/18
 Plans Submitted? Yes No N/A Traffic Control Plan submitted? Yes No N/A Expiration Date: 6/4/18
 Insurance Provided? Yes No On File Performance/Maintenance Bond? Yes No On File N/A
 Fee Paid: NA Receipt #: CTP Processed By: Mere S
 Picked Up By: Rocky Company: Tenex Date & Time: 5-21-18

TOWN OF ADDISON INFRASTRUCTURE AND DEVELOPMENT SERVICES DEPARTMENT
 ATTN.: RIGHT OF WAY PERMIT - DAVE WILDE 972-450-2847
 16801 WESTGROVE RD. ADDISON, TX 75001-9010
 PHONE: 972-450-2871 FAX: 972-450-2837

FOR ADDISON USE ONLY	
Permit Number:	<u>W-1408</u>
Location:	<u>3913 Dome</u>

APPLICATION
Right of Way Work Permit -FRANCHISE
(For Franchise Utility/CTP - Street Cut/Excavation/Lane Closure)

Sub-Contractor List

PLEASE PRINT LEGIBLY

General Contractor's Name: Tenex Construction General Contractor's Phone #: 972-913-8883

Sub-Contractor #1 Company Name: Magdalena Alvarez Address: _____
Print Sub-Contractor's Name: Magdalena Alvarez Sub-Contractor's Phone #: 972-872-5271
Sub-Contractor's E-Mail: _____

Print Site Supervisor's Name: Rocky Stockman Supervisor's Phone #: 214-202-9093
Site Supervisor's E-Mail: _____

Insurance Provided? Yes No On File

Sub-Contractor #2 Company Name: Ascension Rodriguez Address: _____
Print Sub-Contractor's Name: Ascension Rodriguez Sub-Contractor's Phone #: 972-394-0971
Sub-Contractor's E-Mail: _____

Print Supervisor's Name: Rocky Stockman Supervisor's Phone #: 214-202-9093
Site Supervisor's E-Mail: _____

Insurance Provided? Yes No On File

Sub-Contractor #3 Company Name: Tomacito Espinal Address: _____
Print Sub-Contractor's Name: Tomacito Espinal Sub-Contractor's Phone #: 1-214-218-5271
Sub-Contractor's E-Mail: _____

Print Supervisor's Name: Rocky Stockman Supervisor's Phone #: 214-202-9093
Site Supervisor's E-Mail: _____

Insurance Provided? Yes No On File

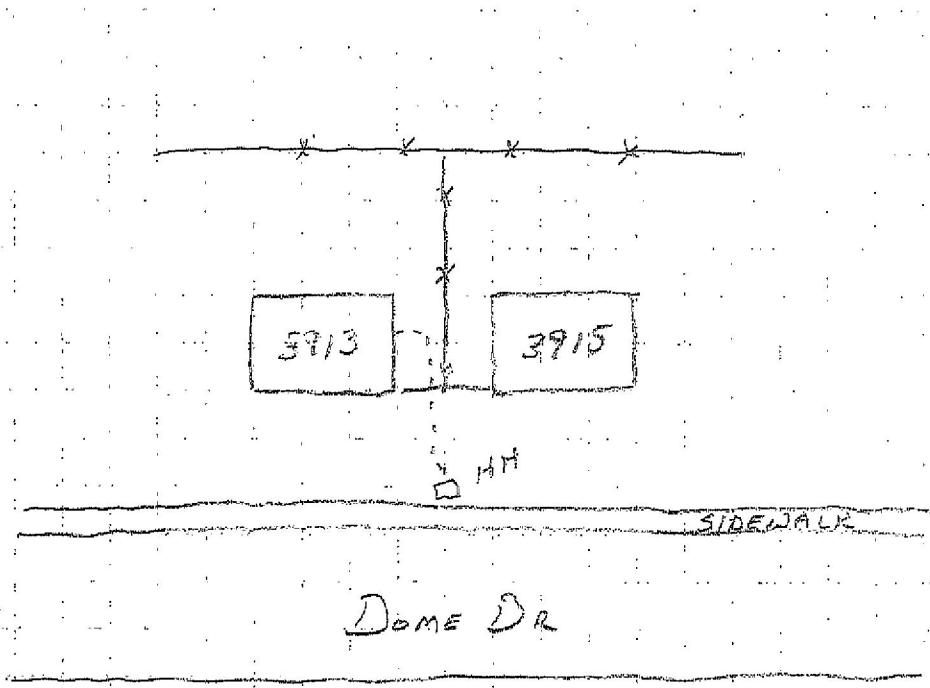

AT&T / TENEX CONST
WO 9637661
5913 DOME DR
ADDISON

DOME DR

RIGHT OF WAY, EXCAVATION &
LANE CLOSURE PERMIT



INFRASTRUCTURE &
DEVELOPMENT SERVICES

16801 WESTGROVE DRIVE
ADDISON, TEXAS 75001
972.450.2871

W-1408

PERMIT NUMBER

5/18/18

START DATE

5/30/18

EST. COMPLETION DATE

TENEX CONST.

CONTRACTOR

AT&T

FOR

3913 DOME

LOCATION (ADDRESS)

FROM HANDHOLE TO EAST SIDE OF ADDRESS

LOCATION (ACTUAL)

PLACE PHONE SERVICE DROP

TYPE OF WORK

THIS CARD MUST BE DISPLAYED ON THE JOB SITE AT ALL TIMES.