



FOR ADDISON USE ONLY  
 Permit Number: W-1993  
 Location: 370 SPRING VALLEY

**APPLICATION**

**Right of Way Work Permit-FRANCHISE**

(For Franchise Utility/CTP - Street Cut/Excavation/Lane Closure)

**PLEASE PRINT LEGIBLY**

Date of Application: 4/30/2018  
 Facility Owner Company: Spectrum Company Phone #: 214-470-5833  
 Utility/CTP Representative: Edwin Milo Cell Phone #: 214-470-5853  
 Utility/CTP Representative E-mail: Edwin.Milo@charter.com  
 General Contractor: GTI Company Phone #: 972-239-9933  
 Site Supervisor Name: MASON REEDER 24-hour Phone #: 214-738-9672  
 Contractor E-mail: mreeder@gradwell100.com Site Foreman E-mail: mreeder@gradwell100.com  
 Work Site Address and Location: 370 Springs Valley Rd  
 Purpose and general description of work: Bore 1x2" Conduit 502' Along Row & Private Prop.  
 Proposed Start Work Date: 5/2/2018 Estimated Completion Date: 6/2/2018

Pavement Cut?  Yes  No Directional Bore/Boring?  Yes  No Excavation?  Yes  No  
 Lane Closure?  Yes  No Other: \_\_\_\_\_

Mason Reeder  Construction Manager  
 Applicant's Printed Name Signature Position with Company

Applicant's E-mail: mreeder@gradwell100.com Applicant's Phone #: 214-738-9672

Mick Mahan 469-853-4088 GTI  
 Direct Supervisor's Name Phone Number Company Name

Supervisor's E-mail: Mick@gradwell100.com

**FOR ADDISON USE ONLY**

Received By: RW via Email Entered?  Yes  No Received Date: 4/30/18 1:17 PM

Approved By: Dave Wilde Inspector: JF Issue Date: 5/3/18

Plans Submitted?  Yes  No  N/A Traffic Control Plan submitted?  Yes  No  N/A Expiration Date: 5/17/18

Insurance Provided?  Yes  No  On File Performance/Maintenance Bond?  Yes  No  On File  N/A

Fee Paid: N/A Receipt #: CTP Processed By: Murey  
 Picked Up By: Mill Company: GTI Date & Time: 5-3-18 12:09 PM

TOWN OF ADDISON INFRASTRUCTURE AND DEVELOPMENT SERVICES DEPARTMENT  
 ATTN.: RIGHT OF WAY PERMIT - DAVE WILDE 972-450-2847  
 16801 WESTGROVE RD. ADDISON, TX 75001-9010  
 PHONE: 972-450-2871 FAX: 972-450-2837



FOR ADDISON USE ONLY  
 Permit Number: W1393  
 Location: 3209 Spring Valley

**APPLICATION**  
**Right of Way Work Permit -FRANCHISE**  
 (For Franchise Utility/CTP - Street Cut/Excavation/Lane Closure)

**Sub-Contractor List**

**PLEASE PRINT LEGIBLY**

General Contractor's Name: GTI General Contractor's Phone #: 972-231-9933

**Sub-Contractor #1** Company Name: SV Address: \_\_\_\_\_

Print Sub-Contractor's Name: SIMON VENTURA Sub-Contractor Phone #: 214-991-5948

Sub-Contractor's E-mail: \_\_\_\_\_

Print Site Supervisor's Name: \_\_\_\_\_ Supervisor's Phone #: \_\_\_\_\_

Site Supervisor's E-mail: \_\_\_\_\_

Insurance Provided?  Yes  No  On File

**Sub-Contractor #2** Company Name: \_\_\_\_\_ Address: \_\_\_\_\_

Print Sub-Contractor's Name: \_\_\_\_\_ Sub-Contractor Phone #: \_\_\_\_\_

Sub-Contractor's E-mail: \_\_\_\_\_

Print Supervisor's Name: \_\_\_\_\_ Supervisor's Phone #: \_\_\_\_\_

Site Supervisor's E-mail: \_\_\_\_\_

Insurance Provided?  Yes  No  On File

**Sub-Contractor #3** Company Name: \_\_\_\_\_ Address: \_\_\_\_\_

Print Sub-Contractor's Name: \_\_\_\_\_ Sub-Contractor Phone #: \_\_\_\_\_

Sub-Contractor's E-mail: \_\_\_\_\_

Print Supervisor's Name: \_\_\_\_\_ Supervisor's Phone #: \_\_\_\_\_

Site Supervisor's E-mail: \_\_\_\_\_

Insurance Provided?  Yes  No  On File

**RIGHT OF WAY, EXCAVATION &  
LANE CLOSURE PERMIT**



**INFRASTRUCTURE &  
DEVELOPMENT SERVICES**

16801 WESTGROVE DRIVE  
ADDISON, TEXAS 75001  
972.450.2871

**W-1393**

PERMIT NUMBER

**5/03/18**

START DATE

**6/02/18**

EST. COMPLETION DATE

**GTI**

CONTRACTOR

**SPECTRUM**

FOR

**3709 SPRING VALLEY RD**

LOCATION (ADDRESS)

**FROM PED @ 3721 SV TO ROW, THEN WEST 240', THEN NORTH TO REAR OF BUILDING**

LOCATION (ACTUAL)

**INSTALL CABLE FACILITIES FOR SERVICE TO BLDG**

TYPE OF WORK

THIS CARD MUST BE DISPLAYED ON THE JOB SITE AT ALL TIMES.



# Spectrum

## SULTANAS DRY CLEANING 3709 SPRING VALLEY RD ADDISON, TEXAS

VICINITY MAP

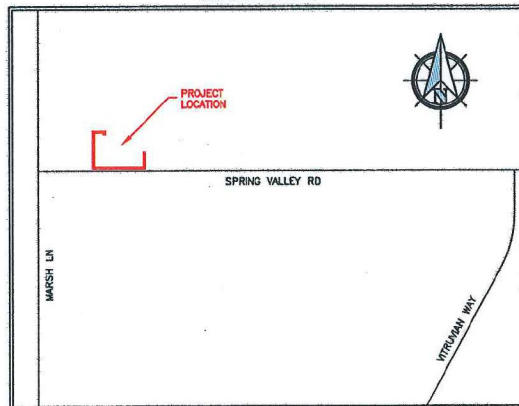

### GENERAL PROJECT NOTES

1. ALL CONSTRUCTION WORK WITHIN THE PUBLIC RIGHT-OF-WAY SHALL BE DONE IN ACCORDANCE WITH THE ORDINANCES AND REGULATIONS OF THE MUNICIPALITY IN WHICH THE WORK IS TO BE PERFORMED.
2. EXISTING UTILITY LOCATIONS SHOWN ARE TAKEN FROM AVAILABLE RECORDS AND MAY NOT BE ALL INCLUSIVE. UTILITY LOCATIONS ARE GENERALLY SCHEMATIC IN NATURE AND MAY NOT ACCURATELY REFLECT THE SIZE AND LOCATION OF EACH PARTICULAR UTILITY. THE CONSTRUCTION CONTRACTOR SHALL ASSUME RESPONSIBILITY FOR ACTUAL LINE LOCATES IN THE FIELD AND THE PROTECTION OF ALL EXISTING FACILITIES WHETHER SHOWN OR NOT. THE CONSTRUCTION CONTRACTOR SHALL ALSO ASSUME RESPONSIBILITY FOR REPAIRS TO ANY EXISTING FACILITY DAMAGED AS A DIRECT RESULT OF THE CONSTRUCTION ACTIVITIES WHETHER THE FACILITY IS SHOWN ON THE DRAWINGS OR NOT.
3. THE CONSTRUCTION CONTRACTOR SHALL BE RESPONSIBLE FOR CONTACTING ALL DEPARTMENTS WITHIN THE MUNICIPALITY AND THE UTILITY COMPANIES AT LEAST TWO WORKING DAYS PRIOR TO THE COMMENCEMENT OF WORK.

CALL BEFORE YOU DIG  
811

IT'S THE LAW

4. IT SHALL BE THE RESPONSIBILITY OF THE CONSTRUCTION CONTRACTOR TO: A) PREVENT DAMAGE TO PRIVATE AND PUBLIC PROPERTY. B) RESTORE ALL AREAS EFFECTED BY THE CONSTRUCTION TO ORIGINAL OR BETTER CONDITION.
5. BARRICADING AND TRAFFIC CONTROL SHALL BE THE RESPONSIBILITY OF THE CONSTRUCTION CONTRACTOR AND SHALL CONFORM TO THE "TEXAS MANUAL ON UNIFORM TRAFFIC CONTROL DEVICES". TRAFFIC FLOW AND ACCESS SHALL BE MAINTAINED DURING ALL PHASES OF CONSTRUCTION. THE CONSTRUCTION CONTRACTOR IS RESPONSIBLE FOR PROVIDING TRAFFIC SAFETY MEASURES FOR WORK ON THE PROJECT. THE WORK SITE SHALL BE SUITABLY LIT AND BARRICADED AT NIGHT.
6. THE CONSTRUCTION CONTRACTOR SHALL ABIDE BY ALL APPLICABLE FEDERAL, STATE AND LOCAL LAWS GOVERNING EXCAVATION. THE CONSTRUCTION CONTRACTOR SHALL PROVIDE ALL TRENCH SAFETY SYSTEMS THAT COMPLY WITH ALL LAWS GOVERNING EXCAVATION. THE CONSTRUCTION CONTRACTOR SHALL BE SOLELY RESPONSIBLE FOR ALL ASPECTS OF WORK RELATED TO EXCAVATION.
7. ALL CONCRETE USED IN ANY ROADWAY SHALL BE IN COMPLIANCE WITH THE SPECIFIED CLASSES OF CONCRETE IN THE STANDARD SPECIFICATIONS 5.8 "PORTLAND CEMENT CONCRETE PAVEMENT" AND 7.4.5 "QUALITY OF CONCRETE" AS AMENDED BY THE ADDENDUM TO THE NORTH CENTRAL TEXAS STANDARD SPECIFICATIONS FOR PUBLIC WORKS CONSTRUCTION - 2004. ALL OTHER CONCRETE SHALL BE CLASS A CONCRETE.
8. ALL REINFORCING STEEL AND DOWEL BARS IN PAVEMENT SHALL BE SUPPORTED AND MAINTAINED AT THE CORRECT CLEARANCES BY THE USE OF BAR CHAINS OR OTHER APPROVED SUPPORT.
9. ALL CONDUIT MUST BE PLACED WITH A MINIMUM 42" OF COVER, UNLESS OTHERWISE SPECIFIED.
10. ALL BACKFILLING WILL BE MECHANICALLY TAMPED IN LIFTS TO A DENSITY OF 95% PROCTOR. THE REQUIRED DENSITY WILL BE OBTAINED BY USING TAMPERS, RAMMERS OR ROLLING EQUIPMENT. LIFTS MAY VARY ACCORDING TO THE TYPE OF EQUIPMENT USED TO OBTAIN THE REQUIRED DENSITY. SAND AND DEBRIS FREE MATERIAL WILL BE USED FOR BACKFILL.

DFWT CONTACT: DAVID HATTON 972.670.2113

PREPARED BY: DFW TELECOM, INC.

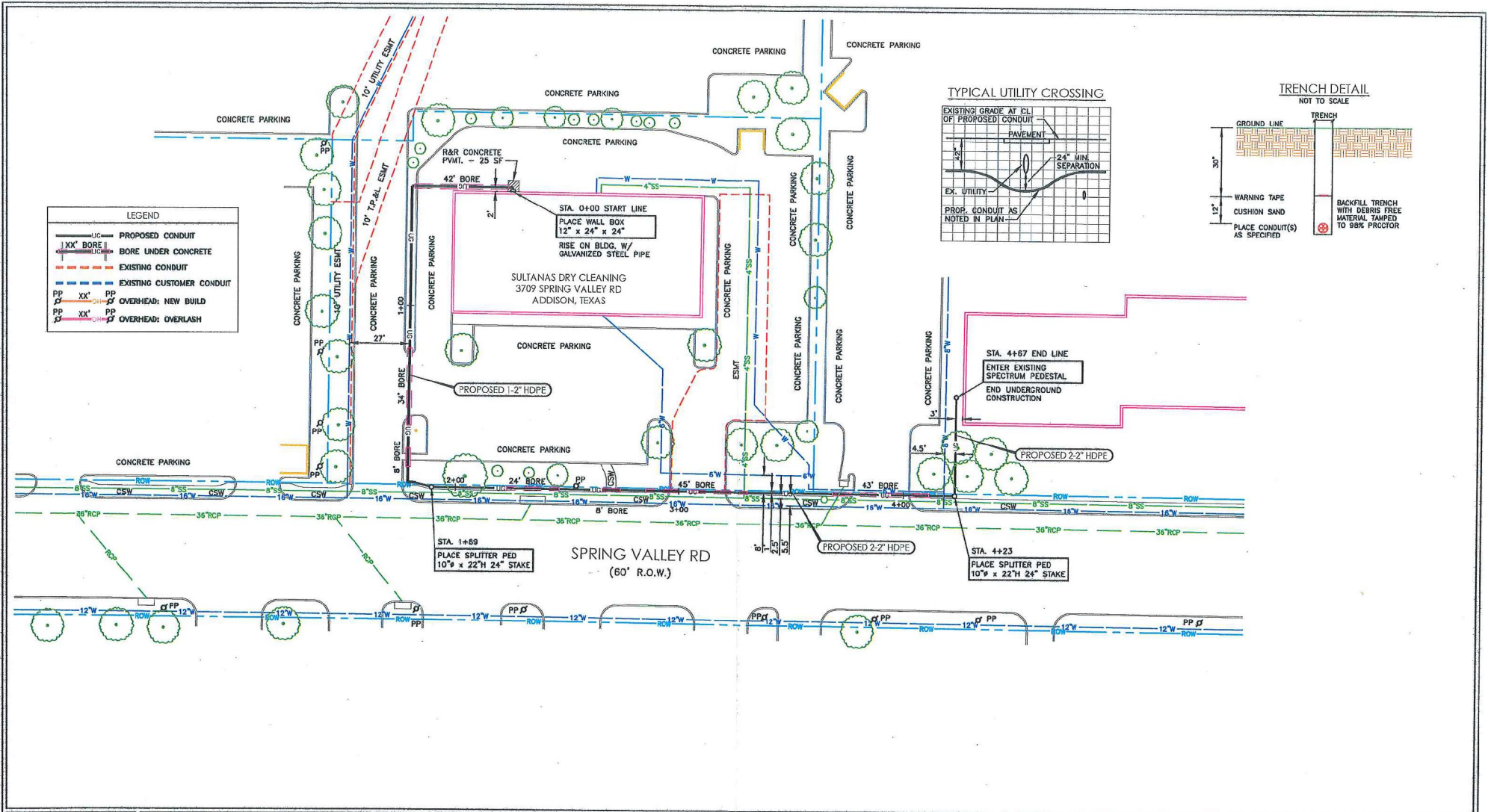

**LEGEND**

UC	PROPOSED CONDUIT
XX' BORE	BORE UNDER CONCRETE
---	EXISTING CONDUIT
---	EXISTING CUSTOMER CONDUIT
PP	OVERHEAD: NEW BUILD
PP	OVERHEAD: OVERLASH

**TYPICAL UTILITY CROSSING**

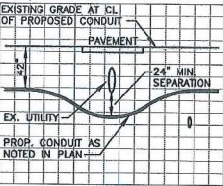

**TRENCH DETAIL**  
NOT TO SCALE

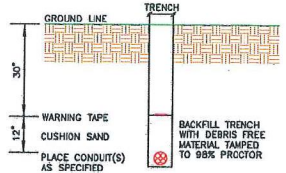

PREPARED BY:

DFWT CONTACT:  
DAVID HATTON 972.670.2113

**ESTIMATED SHEET TOTALS**

DESCRIPTION	QUANTITY	DESCRIPTION	QUANTITY
TRENCH & PLACE CONDUIT	263'	PLACE FLUSH MOUNT VAULT	
BORE & PLACE CONDUIT	204'	PLACE PEDESTAL	2
BORE & PLACE STEEL CASING		PLACE FLUSH DROP BUCKET	
PULL THROUGH EXISTING CONDUIT		PLACE POWER SUPPLY	
R & R CONCRETE SIDEWALK (SF)		PLACE WALL BOX & RISER	1
R & R CONCRETE PAVEMENT (SF)	25 SF	PLACE U-GUARD RISER	
OVERHEAD: OVERLASH		OVERHEAD: NEW BUILD	

NORTH

SHEET  
OF 1

PROJECT: SULTANAS DRY CLEANING

ADDRESS: 3709 SPRING VALLEY RD  
CITY, STATE: ADDISON, TEXAS

HORIZONTAL SCALE 1" = 40'	VERTICAL SCALE 1" = 10'	JOB NUMBER: DID - 1607280	DATE: 03-30-2018
------------------------------	----------------------------	------------------------------	---------------------