



FOR ADDISON USE ONLY
 Permit Number: W-1420 (Front entrance only)
 Location: 3900 Vitruvian Way

APPLICATION

Right of Way Work Permit - PUBLIC UTILITY/CTP
(For Public Utility/CTP - Street Cut/Excavation/Lane Closure)

PLEASE PRINT LEGIBLY

Date of application: 05/15/2018
 Facility Owner Company: ATMOS ENERGY Company Phone #: 972-360-4428
 Utility/CTP Representative: BRANDON BALL Cell Phone #: 972-360-4428
 General Contractor: DRIVER PIPELINE Company Phone #: 214-535-5368
 Site Supervisor Name: JOHNNY GONZALES 24 hour phone #: 469-346-9361
 Work Site Address and Location: 3900 VITRUVIAN WAY

Purpose and general description of work: REPLACE 10 FEET OF POLY GAS MAIN
 Proposed Start Work Date: 05/02/2018 Estimated Completion Date: 07/15/2018
 Pavement Cut? Yes No Directional Bore/Boring? Yes No
 Excavation? Yes No Lane Closure? Yes No Other: _____ ? Yes No

BRANDON BALL _____ PROJECT SPECIALIST
 Applicant's Printed Name Signature Position with Company
 Applicant's Email: BRANDON.BALL@ATMOSENERGY.COM Applicant's Phone Number: 972-360-4428

JOHNNY GONZALES _____ FCC
 Direct Supervisor's Printed Name Phone Number Company Name

FOR ADDISON USE ONLY

Received By: Nicolas Entered? Yes Received Date: 5-18-18
 Approved By: Dave Wilde Inspector: DW/JE Issue Date: 5/21/18
 Plans Submitted? Yes No N/A Traffic Control Plan Submitted? Yes No N/A Expiration Date: 6/5/18
 Insurance Provided? Yes No On File Performance/Maintenance Bond? Yes No On File N/A
 Fee Paid: NA Receipt # FRANCAISE Date: 5-29-18 Processed By: Nicolas
 Picked Up By: Luca Rivale Company: Bondwire Date & Time: 5/29/18

TOWN OF ADDISON INFRASTRUCTURE AND DEVELOPMENT SERVICES
 DEPARTMENT ATTN.: RIGHT OF WAY PERMIT - DAVE WILDE 972-450-2847
 16801 WESTGROVE RD. ADDISON, TX 75001-0010
 PHONE: 972-450-2871 FAX: 972-450-2837

11:51 AM



FOR ADDISON USE ONLY
Permit Number: <u>W-1423</u>
Location: <u>3900 Vitruvian Way</u>

APPLICATION
Right of Way Work Permit - PUBLIC UTILITY/CTP
(For Public Utility/CTP - Street Cut/Excavation/Lane Closure)

Sub-Contractor List

PLEASE PRINT LEGIBLY

General Contractor's Name: BROADWALK General Contractor's Phone #: 972-804-9965

Sub-Contractor #1 Company Name: _____ Address: _____

Print Sub-Contractor's Name: _____ Sub-Contractor Phone #: _____

Print Site Supervisor's Name: _____ Supervisor's Phone #: _____

Insurance Provided? Yes No On File

Sub-Contractor #2 Company Name: _____ Address: _____

Print Sub-Contractor's Name: _____ Sub-Contractor Phone #: _____

Print Supervisor's Name: _____ Supervisor's Phone #: _____

Insurance Provided? Yes No On File

Sub-Contractor #3 Company Name: _____ Address: _____

Print Sub-Contractor's Name: _____ Sub-Contractor Phone #: _____

Print Supervisor's Name: _____ Supervisor's Phone #: _____

Insurance Provided? Yes No On File

Pavement & Sidewalk Repair Order

Yes No

Permit Required

Yes No

Address Adison

Cast Iron Poly

Coated Stl Bare Stl

	Project #	Task #	Ser Area	Co	CC	Acct	Sub
CAPITAL	<input type="checkbox"/> 5' to 99' Main Replacements		190000	080			
	<input type="checkbox"/> Repl. Service Lines		190000	080			
	<input type="checkbox"/> Install Service Lines		190000	080			
	<input checked="" type="checkbox"/> Permanent Leak Repairs	080,56371	Capit-1	190000	080	4594	
	<input type="checkbox"/> C/P Remediation (Distrib)		190000	080			
	<input type="checkbox"/> Retire Service Lines		190000	080			
	<input type="checkbox"/> C/P Remediation (Pipeline)		700000	080			
<input type="checkbox"/> Project Number							
O&M	<input type="checkbox"/> Other Maintenance - Distribution		190000	080		8870	06111
	<input type="checkbox"/> Maintenance of Mains		190000	080		8870	06111
	<input type="checkbox"/> Reg / Relief / Other work (Distrib)		190000	080		8890	06111
	<input type="checkbox"/> Other Maintenance - Pipeline		190000	080		8630	06111
	<input type="checkbox"/> Leak Repair on Pipeline Mains		190000	080		8630	06111

Description of Work Performed Sidewalk

Cut Made By Johnny Gonzalez
 Atmos Supervisor/FCC:

Description of Pavement or Sidewalk Cut	Concrete	Asphalt	Length & Width of Cut	Street	Alley	Sidewalk
Cut 1	<input checked="" type="checkbox"/>	<input type="checkbox"/>	10x21	<input type="checkbox"/>		<input checked="" type="checkbox"/>
Cut 2	<input checked="" type="checkbox"/>	<input type="checkbox"/>	3x3	<input type="checkbox"/>	<input type="checkbox"/>	<input checked="" type="checkbox"/>
Curb Cut	<input type="checkbox"/>	<input checked="" type="checkbox"/>				

Description and Cost of Repairs	Concrete	Asphalt	Length & Width of Repair	Cost Per Ft or Sq Ft	Total Cost Per Cut
Cut 1	<input type="checkbox"/>	<input type="checkbox"/>			
Cut 2	<input type="checkbox"/>	<input type="checkbox"/>			
Curb Cut	<input type="checkbox"/>	<input checked="" type="checkbox"/>			

3966 Vitruvian

Draw a sketch of cut location.

North

RIGHT OF WAY, EXCAVATION &
LANE CLOSURE PERMIT



INFRASTRUCTURE &
DEVELOPMENT SERVICES

16801 WESTGROVE DRIVE
ADDISON, TEXAS 75001
972.460.2871

W-1421

PERMIT NUMBER

5/02/18

START DATE

7/15/18

EST. COMPLETION DATE

BOARDWALK

CONTRACTOR

ATMOS

FOR

3900 VITRUVIAN WAY

LOCATION (ADDRESS)

BETWEEN TREEWELLS, BEHIND CURB, EAST ROW

LOCATION (ACTUAL)

REPLACE 10' POLY GAS MAIN & RESTORE STREETScape

TYPE OF WORK

THIS SIGN MUST BE DISPLAYED ON THE JOB SITE AT ALL TIMES.

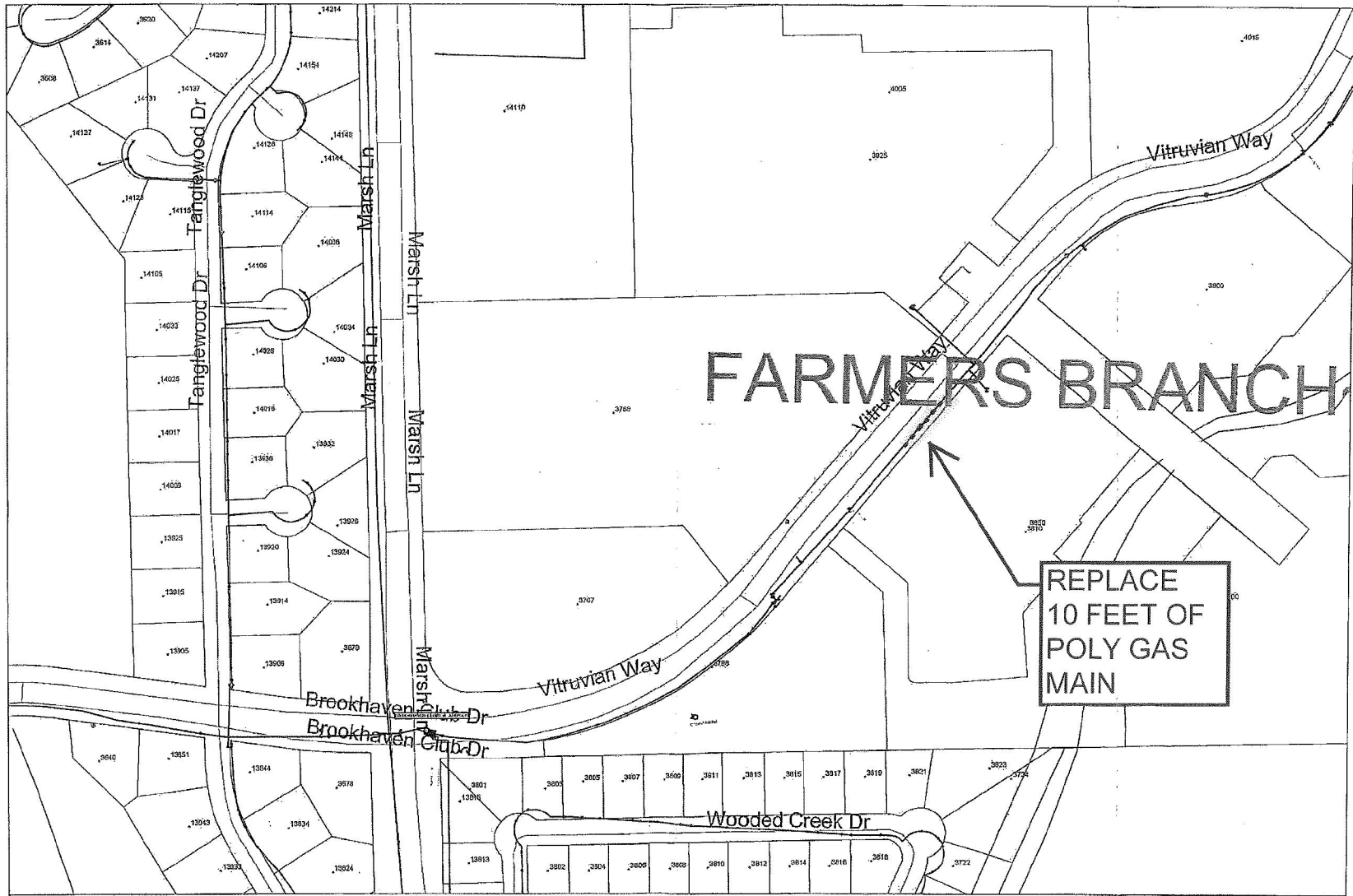

ATMOS	bball11a	Scale: 1 IN = 248 FT	05/18/18 07:58
-------	----------	----------------------	----------------

©2006-2012 Tele Atlas. All rights reserved. This material is proprietary and the subject of copyright protection and other intellectual property rights owned or licensed to Tele Atlas.