



FOR ADDISON USE ONLY

Permit Number: W-1457  
Location: 16300 Addison Rd.

APPLICATION

Right of Way Work Permit-FRANCHISE

(For Franchise Utility/CTP - Street Cut/Excavation/Lane Closure)

PLEASE PRINT LEGIBLY

Date of Application: 06/20/18  
Facility Owner Company: Unite Private Networks Company Phone #: 469-354-3214  
Utility/CTP Representative: Griselle Gonzalez Cell Phone #: 469-475-9328  
Utility/CTP Representative E-mail: griselle.gonzalez@upnfiber.com  
General Contractor: One Global Company Phone # \_\_\_\_\_  
Site Supervisor Name: Chris Webb 24-hour Phone # 972-345-7564  
Contractor E-mail: cwebb@oneglobaltele.com Site Foreman E-mail: \_\_\_\_\_  
Work Site Address and Location: 16300 Addison Rd

Purpose and general description of work: Bore and place conduit e/w fiber cable to provide service to 16300 Addison Rd

Proposed Start Work Date: 06/29/18 Estimated Completion Date: 09/30/18

Pavement Cut?  Yes  No Directional Bore/Boring?  Yes  No Excavation?  Yes  No  
Lane Closure?  Yes  No Other: \_\_\_\_\_

Griselle Gonzalez Griselle Gonzalez Construction Manager  
Applicant's Printed Name Signature Position with Company

Applicant's E-mail: griselle.gonzalez@upnfiber.com Applicant's Phone #: 469-475-9328

Bill Tyler 469-354-3214 Unite Private Networks  
Direct Supervisor's Name Phone Number Company Name

Supervisor's E-mail: bill.tyler@upnfiber.com

FOR ADDISON USE ONLY

Received By: Nicole S. Entered?  Yes Received Date: 6-20-18

Approved By: [Signature] Inspector: JEP Issue Date: 6/20/18

Plans Submitted?  Yes  No  N/A Traffic Control Plan submitted?  Yes  No  N/A Expiration Date: 7/11/18

Insurance Provided?  Yes  No  On File Performance/Maintenance Bond?  Yes  No  On File  N/A

Fee Paid: NA Receipt #: CTP Processed By: Nicole S.

Picked Up By: Eric Company: one Global Date & Time: 10:31 AM

TOWN OF ADDISON INFRASTRUCTURE AND DEVELOPMENT SERVICES DEPARTMENT  
ATTN: RIGHT OF WAY PERMIT - DAVE WILDE 972-450-2847  
16801 WESTGROVE RD. ADDISON, TX 75001-9010  
PHONE: 972-450-2871 FAX: 972-450-2837

RIGHT OF WAY, EXCAVATION &  
LANE CLOSURE PERMIT

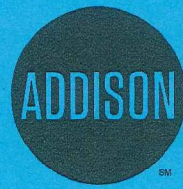

INFRASTRUCTURE &  
DEVELOPMENT SERVICES

16801 WESTGROVE DRIVE  
ADDISON, TEXAS 75001  
972.450.2871

**W-1457**

PERMIT NUMBER

**6/29/18**

START DATE

**9/30/18**

EST. COMPLETION DATE

**ONE GLOBAL**

CONTRACTOR

**UPN**

FOR

**16300 ADDISON RD**

LOCATION (ADDRESS)

**BOTH SIDES AND CROSSING ADDISON RD**

LOCATION (ACTUAL)

**INSTALL CABLE FACILITIES FOR SERVICE TO BUILDING**

TYPE OF WORK

THIS CARD MUST BE DISPLAYED ON THE JOB SITE AT ALL TIMES.

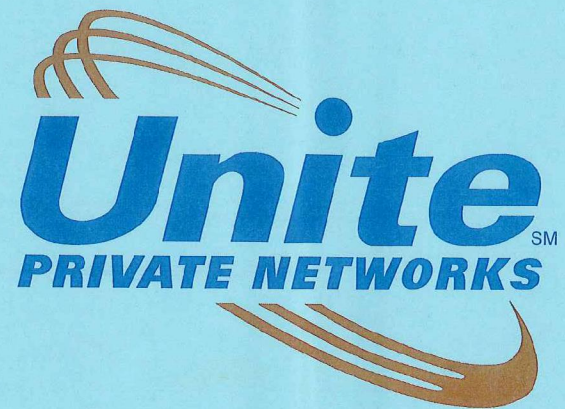

PC-18965  
SUPREME MEDICAL LABS  
16300 ADDISON RD  
ADDISON, TX 75001

CONSTRUCTION  
JUNE 15, 2018



MAP SHEET

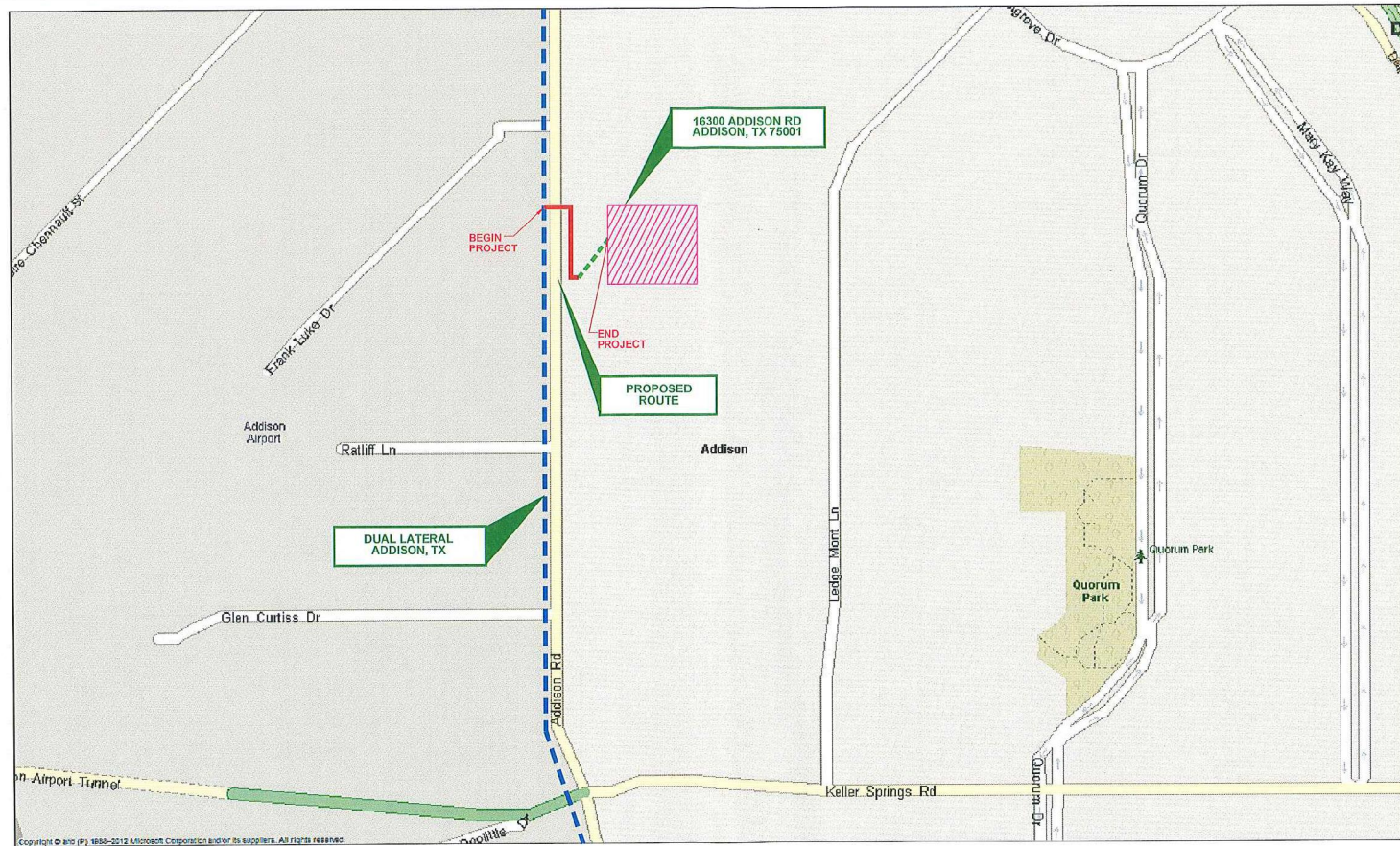

LEGEND	
AERIAL	
UNDERGROUND	
EXIST. UPN NETWORK	
PULL-THRU EXIST.	
TO BE PLACED BY OTHERS	



SUPREME MEDICAL LABS  
 16300 ADDISON RD  
 ADDISON, TX 75001

CONSTRUCTION  
 JUNE 15, 2018

16300-ADDISON-RD\_MS\_002.DWG





**CONTACT SHEET - DRAWING INDEX**

UNITE CONTACTS	DRAWING INDEX																																																											
<b>REGIONAL VICE PRESIDENT:</b> BILL TYLER 8111 LBJ FREEWAY, SUITE 600 DALLAS, TX 75251  <b>CONSTRUCTION MANAGER:</b> GRISSELLE GONZALEZ 8111 LBJ FREEWAY, SUITE 600 DALLAS, TX 75251	PHONE: (469) 354-3214	E-MAIL: bill.tyler@upnfiber.com																																																										
	CELL: (469) 475-9328	E-MAIL: griselle.gonzalez@upnfiber.com																																																										
	<table border="1" style="width:100%; border-collapse: collapse;"> <thead> <tr> <th>DESCRIPTION</th> <th>SHEET NAME</th> <th>FILE NAME</th> </tr> </thead> <tbody> <tr> <td>COVER SHEET</td> <td>CS01</td> <td>16300-ADDISON-RD_CS_001.DWG</td> </tr> <tr> <td>MAP SHEET</td> <td>MS01</td> <td>16300-ADDISON-RD_MS_002.DWG</td> </tr> <tr> <td>CONTACT/DRAWING INDEX (THIS SHEET)</td> <td>CT01</td> <td>16300-ADDISON-RD_CT_003.DWG</td> </tr> <tr> <td>GENERAL NOTES</td> <td>GN01</td> <td>16300-ADDISON-RD_GN_004.DWG</td> </tr> <tr> <td>LEGEND &amp; SYMBOLS</td> <td>LS01</td> <td>16300-ADDISON-RD_LS_005.DWG</td> </tr> <tr> <td>DETAIL SHEETS</td> <td>DT01</td> <td>16300-ADDISON-RD_DT_006-010.DWG</td> </tr> <tr> <td>TRAFFIC CONTROL DETAIL</td> <td>TC01</td> <td>16300-ADDISON-RD_TC_011-11A.DWG</td> </tr> <tr> <td>MATERIAL TAKE-OFF SHEET</td> <td>MR01</td> <td>16300-ADDISON-RD_MR_012.DWG</td> </tr> <tr> <td>FIBER SCHEMATIC SHEET</td> <td>FS01</td> <td>16300-ADDISON-RD_FS_013.DWG</td> </tr> <tr> <td>OSP/ISP DESIGN SHEETS</td> <td>P01</td> <td>16300-ADDISON-RD_P_001-002.DWG</td> </tr> </tbody> </table>			DESCRIPTION	SHEET NAME	FILE NAME	COVER SHEET	CS01	16300-ADDISON-RD_CS_001.DWG	MAP SHEET	MS01	16300-ADDISON-RD_MS_002.DWG	CONTACT/DRAWING INDEX (THIS SHEET)	CT01	16300-ADDISON-RD_CT_003.DWG	GENERAL NOTES	GN01	16300-ADDISON-RD_GN_004.DWG	LEGEND & SYMBOLS	LS01	16300-ADDISON-RD_LS_005.DWG	DETAIL SHEETS	DT01	16300-ADDISON-RD_DT_006-010.DWG	TRAFFIC CONTROL DETAIL	TC01	16300-ADDISON-RD_TC_011-11A.DWG	MATERIAL TAKE-OFF SHEET	MR01	16300-ADDISON-RD_MR_012.DWG	FIBER SCHEMATIC SHEET	FS01	16300-ADDISON-RD_FS_013.DWG	OSP/ISP DESIGN SHEETS	P01	16300-ADDISON-RD_P_001-002.DWG																								
	DESCRIPTION	SHEET NAME	FILE NAME																																																									
	COVER SHEET	CS01	16300-ADDISON-RD_CS_001.DWG																																																									
	MAP SHEET	MS01	16300-ADDISON-RD_MS_002.DWG																																																									
	CONTACT/DRAWING INDEX (THIS SHEET)	CT01	16300-ADDISON-RD_CT_003.DWG																																																									
	GENERAL NOTES	GN01	16300-ADDISON-RD_GN_004.DWG																																																									
	LEGEND & SYMBOLS	LS01	16300-ADDISON-RD_LS_005.DWG																																																									
DETAIL SHEETS	DT01	16300-ADDISON-RD_DT_006-010.DWG																																																										
TRAFFIC CONTROL DETAIL	TC01	16300-ADDISON-RD_TC_011-11A.DWG																																																										
MATERIAL TAKE-OFF SHEET	MR01	16300-ADDISON-RD_MR_012.DWG																																																										
FIBER SCHEMATIC SHEET	FS01	16300-ADDISON-RD_FS_013.DWG																																																										
OSP/ISP DESIGN SHEETS	P01	16300-ADDISON-RD_P_001-002.DWG																																																										
<b>BUILDING CONTACTS</b>																																																												
BUILDING CONTACT(S): XXXXX	(XXX) XXX-XXXX																																																											
BUILDING ENGINEER(S): XXXXX	(XXX) XXX-XXXX																																																											
<b>ENGINEER CONTACTS</b>			<b>PERMITTING AGENCIES</b>																																																									
<b>ENGINEERING FIRM:</b> GXT, LTD 1130 E. ARAPAHO RD., SUITE 625 RICHARDSON, TX 75081 PRESIDENT/CEO: MICHELLE LENKER <b>ENGINEERING CONTACT:</b> DIRECTOR OF ENGINEERING: KEN BAILEY OSP COORDINATOR: MIGUEL GONZALEZ OSP COORDINATOR: PATRICK O'BRIEN	OFFICE: (469) 385-5163 FAX: (469) 385-5164 E-MAIL: mlenker@gxtltd.com  CELL: (214) 551-5954 E-MAIL: kbailey@gxtltd.com CELL: (972) 754-9182 E-MAIL: mgonzalez@gxtltd.com CELL: (972) 948-5249 E-MAIL: pobrien@gxtltd.com	TOWN OF ADDISON 16801 WESTGROVE DR. P.O. BOX 9010 ADDISON, TX 75001 DAVID WILDE: INSPECTOR INFRASTRUCTURE & DEVELOPMENT SERVICES:  OFFICE: (972) 450-2847 FAX: (972) 450-2837 E-MAIL: dwwide@addisontx.gov																																																										
<b>CONSTRUCTION CONTACTS</b>																																																												
<b>CONSTRUCTION FIRM:</b> ONE GLOBAL 24 DECKER CT WYLLIE, TX 75098  <b>CONSTRUCTION CONTACT:</b> CHRIS WEBB  <b>SPLICING FIRM:</b> ONE GLOBAL 24 DECKER CT WYLLIE, TX 75098	(972) 345-7564																																																											
* CONTACT 48 HOURS PRIOR TO CONSTRUCTION *																																																												
<small>1130 East Arapaho Road, Suite 625 Richardson, TX 75081 Phone: 469.385.5163 Fax: 469.385.5164</small>	<table border="1" style="width:100%; border-collapse: collapse;"> <thead> <tr> <th>REV</th> <th>DESCRIPTION</th> <th>BY</th> <th>APVD</th> <th>DATE</th> </tr> </thead> <tbody> <tr><td> </td><td> </td><td> </td><td> </td><td> </td></tr> <tr><td> </td><td> </td><td> </td><td> </td><td> </td></tr> <tr><td> </td><td> </td><td> </td><td> </td><td> </td></tr> <tr><td> </td><td> </td><td> </td><td> </td><td> </td></tr> <tr><td> </td><td> </td><td> </td><td> </td><td> </td></tr> <tr><td> </td><td> </td><td> </td><td> </td><td> </td></tr> <tr><td> </td><td> </td><td> </td><td> </td><td> </td></tr> <tr><td> </td><td> </td><td> </td><td> </td><td> </td></tr> <tr><td> </td><td> </td><td> </td><td> </td><td> </td></tr> <tr><td> </td><td> </td><td> </td><td> </td><td> </td></tr> </tbody> </table>	REV	DESCRIPTION	BY	APVD	DATE																																																						
REV	DESCRIPTION	BY	APVD	DATE																																																								
				<table border="1" style="width:100%; border-collapse: collapse;"> <tr> <td>PROJECT:</td> <td>SUPREME MEDICAL LABS 16300 ADDISON RD ADDISON, TX 75001</td> <td>PROJECT CODE:</td> <td>PC-18985</td> </tr> <tr> <td>TITLE:</td> <td colspan="3">CONTACT AND INDEX SHEET</td> </tr> <tr> <td>DRAWN</td> <td>GXT</td> <td>DWG NO:</td> <td>16300-ADDISON-RD_CT_003.DWG</td> </tr> <tr> <td>APPV</td> <td> </td> <td>DATE:</td> <td> </td> </tr> <tr> <td>SHEET:</td> <td>003 OF 013</td> <td>APPROVED ORIGINAL ISSUE</td> <td>05/15/18</td> </tr> </table>		PROJECT:	SUPREME MEDICAL LABS 16300 ADDISON RD ADDISON, TX 75001	PROJECT CODE:	PC-18985	TITLE:	CONTACT AND INDEX SHEET			DRAWN	GXT	DWG NO:	16300-ADDISON-RD_CT_003.DWG	APPV		DATE:		SHEET:	003 OF 013	APPROVED ORIGINAL ISSUE	05/15/18																																			
PROJECT:	SUPREME MEDICAL LABS 16300 ADDISON RD ADDISON, TX 75001	PROJECT CODE:	PC-18985																																																									
TITLE:	CONTACT AND INDEX SHEET																																																											
DRAWN	GXT	DWG NO:	16300-ADDISON-RD_CT_003.DWG																																																									
APPV		DATE:																																																										
SHEET:	003 OF 013	APPROVED ORIGINAL ISSUE	05/15/18																																																									
INFORMATION ON THIS DOCUMENT IS PROPRIETARY AND SHALL NOT BE USED, COPIED, REPRODUCED OR DISCLOSED IN WHOLE OR IN PART WITHOUT WRITTEN CONSENT OF GUNTER																																																												



GENERAL NOTES

APPLICABLE CODES	CABLE VAULT INSTALLATION NOTES:	PROJECT INFORMATION	UNITE GENERAL NOTES:
<p>AMERICAN ASSOCIATION OF STATE HIGHWAY AND TRANSPORTATION OFFICIALS - LATEST EDITION</p> <p>OCCUPATIONAL SAFETY AND HEALTH STANDARDS - LATEST EDITION</p> <p>MANUAL ON UNIFORM TRAFFIC CONTROL DEVICES</p>	<ol style="list-style-type: none"> <li>FOR LOCATION AND ORIENTATION OF CABLE VAULTS, SEE NETWORK ROUTE PLAN.</li> <li>ALL OPENINGS, PENETRATIONS AND JOINTS IN CABLE VAULTS SEALED WITH A NON-SHINK GROUT TO FORM A WATERIGHT CABLE VAULT.</li> <li>CABLE VAULTS INSTALLED ON A BASE CONSISTING OF CLEAN GRAVEL OR CRUSHED STONE. THE MINIMUM THICKNESS OF THE BASE SHALL BE TWELVE INCHES (12").</li> <li>FINISHED SURFACE REPAIRED TO A CONDITION EQUAL TO OR GREATER THAN ORIGINAL CONDITIONS.</li> <li>BOTTOM OF EXCAVATION COMPACTED AND LEVELED PRIOR TO CABLE VAULT INSTALLATION.</li> <li>PLACE THE VAULT SO THAT THE COVER IS AT THE DESIRED GRADE ELEVATION.</li> </ol>		<ol style="list-style-type: none"> <li>THE CONTRACTOR SHALL BE SOLELY RESPONSIBLE FOR ALL CONSTRUCTION MEANS, METHODS, TECHNIQUES, PROCEDURES, AND SEQUENCES FOR COORDINATING ALL PORTIONS OF THE WORK UNDER THE CONTRACT.</li> <li>THE CONTRACTOR SHALL VISIT THE JOB SITE TO REVIEW THE SCOPE OF WORK AND EXISTING JOB SITE CONDITIONS.</li> <li>THE CONTRACTOR SHALL VERIFY ALL EXISTING CONDITIONS AND DIMENSIONS PRIOR TO SUBMITTING A BID. ANY DISCREPANCIES, CONFLICTS, OR OMISSIONS, SHALL BE REPORTED TO PROJECT MANAGER BEFORE PROCEEDING WITH THE WORK.</li> <li>THE CONTRACTOR SHALL PROTECT ALL AREAS FROM DAMAGE WHICH MAY OCCUR DURING CONSTRUCTION. ANY DAMAGE BY CONTRACTOR TO NEW AND EXISTING CONSTRUCTION, STRUCTURE, LANDSCAPING, OR EQUIPMENT SHALL BE IMMEDIATELY REPAIRED OR REPLACED TO THE SATISFACTION OF THE ROW OWNER AND PROJECT MANAGER AT THE EXPENSE OF THE CONTRACTOR.</li> <li>THE CONTRACTOR SHALL BE RESPONSIBLE FOR, AND SHALL REPLACE OR REMEDY, ANY FAULTY, IMPROPER, OR INFERIOR MATERIALS OR WORKMANSHIP OR ANY DAMAGE WHICH SHALL APPEAR WITHIN ONE YEAR AFTER THE COMPLETION AND ACCEPTANCE OF THE WORK UNDER THIS CONTRACT.</li> <li>THE CONTRACTOR SHALL REMOVE ALL RUBBISH AND WASTE MATERIALS ON A REGULAR BASIS, AND SHALL EXERCISE STRICT CONTROL OVER JOB CLEANING THROUGHOUT CONSTRUCTION UP TO COMPLETION OF WORK.</li> <li>IT SHALL BE THE RESPONSIBILITY OF THE CONTRACTOR TO LOCATE ALL EXISTING UTILITIES ADJACENT TO OR CROSSING THE NETWORK ROUTE, WHETHER SHOWN HEREIN OR NOT, AND TO PROTECT THEM FROM DAMAGE. THE CONTRACTOR SHALL BEAR ALL EXPENSES FOR REPAIR OR REPLACEMENT OF UTILITIES OR OTHER PROPERTY DAMAGED BY CONTRACTOR IN CONJUNCTION WITH THE EXECUTION OF WORK.</li> <li>THE CONTRACTOR SHALL BE RESPONSIBLE FOR THE COMPLETE SECURITY OF THE SITE WHILE THE JOB IS IN PROGRESS AND UNTIL THE JOB IS COMPLETED.</li> <li>THE CONTRACTOR SHALL PROVIDE TEMPORARY WATER, POWER, AND TOILET FACILITIES AS REQUIRED BY THE CITY OR GOVERNING AGENCY.</li> <li>THE CONTRACTOR SHALL NOTIFY PROJECT MANAGER IF DETAILS ARE CONSIDERED UNSUITABLE, UNSAFE, NOT WATERPROOF, OR NOT WITHIN CUSTOMARY TRADE PRACTICE. IF WORK IS PERFORMED, IT WILL BE ASSUMED THAT THERE IS NO OBJECTION TO THE DETAIL. DETAILS ARE INTENDED TO SHOW THE END RESULT OF THE DESIGN. MINOR MODIFICATIONS MAY BE REQUIRED TO SUIT JOB CONDITIONS, AND SHALL BE INCLUDED AS PART OF THE WORK.</li> <li>ALL SYMBOLS AND ABBREVIATIONS USED ON THE DRAWINGS ARE CONSIDERED CONSTRUCTION STANDARDS. IF THE CONTRACTOR HAS QUESTIONS REGARDING THEIR EXACT MEANING, TECH GROUP SHALL BE NOTIFIED FOR CLARIFICATION BEFORE PROCEEDING WITH THE WORK.</li> <li>ALL GRADES SHOWN AS PROPOSED FINISHED GRADES INCLUDE SURFACE TREATMENTS SUCH AS TOPSOIL OR PAVEMENT. MAKE ALLOWANCES DURING EARTHWORK OPERATIONS FOR THESE SURFACE TREATMENTS.</li> <li>ALL WORK SHOWN ON THE OSP DRAWINGS SHALL BE ACCOMPLISHED IN ACCORDANCE WITH THE REQUIREMENTS OF SPECIFICATION 02000 - FOC OSP - CONDUIT SYSTEMS.</li> </ol>
CITY GENERAL NOTES:	GENERAL COMMENTS		

ENGINEERING CONTRACTOR:

1150 East Arapaho Road, Suite 425  
Bellaire, TX 75001  
Phone: 409.285.5163  
Fax: 409.285.5161

REV	DESCRIPTION	BY	APVD	DATE



PROJECT: SUPREME MEDICAL LABS 16300 ADDISON RD ADDISON, TX 75001		PROJECT CODE: PC-18985
TITLE: GENERAL NOTES		
<small>INFORMATION ON THIS DOCUMENT IS PROPRIETARY AND SHALL NOT BE USED, COPIED, REPRODUCED OR DISCLOSED IN WHOLE OR IN PART WITHOUT WRITTEN CONSENT OF GXT</small>	DRAWN: GXT APPV: _____ CHECK: 014 OF 013	DOC NO: 16300-ADDISON-RO_GN_004.DWG APPROVED ORIGINAL ISSUE: 06/15/18

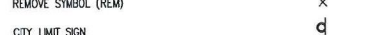
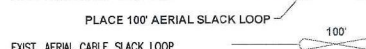
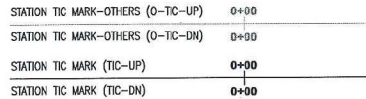
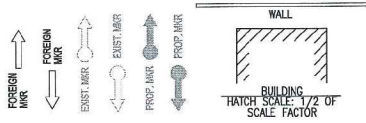

- SIGN 2 (2 POST SIGN)
- SIGN 3 (BRICK SIGN)
- TREE
- TREE LINE OR BUSH
- IRRIGATION CONTROL VALVE
- WATER VAULT
- FIRE HYDRANT
- WATER SPRINKLER
- WATER METER
- WATER VALVE
- GAS METER
- GAS VALVE
- EXIST. HH
- PROP. 36"x60"x48" HH (REGULAR HANDHOLE)
- EXIST. MH
- PROP. 4'x4'x4' MH
- SANITARY SEWER CLEAN OUT
- UNKNOWN MH
- E-MH
- SS-MH
- WW-MH
- STM-MH
- W-MH
- TEL-CABINET
- PROP-TEL-MH
- TEL-MH
- TEL-PED
- CATV-MH
- CATV-PED
- STM-INLET
- STM-INLET
- STM-DRAIN
- STR 2 (STM DRAIN GRATE WITH CONCRETE AROUND IT)
- STREET LIGHT
- TRAFFIC SIGNAL LIGHT POLE
- PROP. UTILITY POLE
- PROP-UTIL-POLE-WITH-RISER
- X-UTIL-POLE
- X-UTIL-POLE-WITH-RISER
- ELECTRIC METER
- ELECTRIC CABINET
- UTIL-HH
- LNK. VAULT
- ROW-MKR
- PARKING METER
- PULLBOX
- MAIL BOX
- R/R SIGNAL BOX
- R/R X-ING
- CELL TOWER

LEGEND OF SYMBOLS

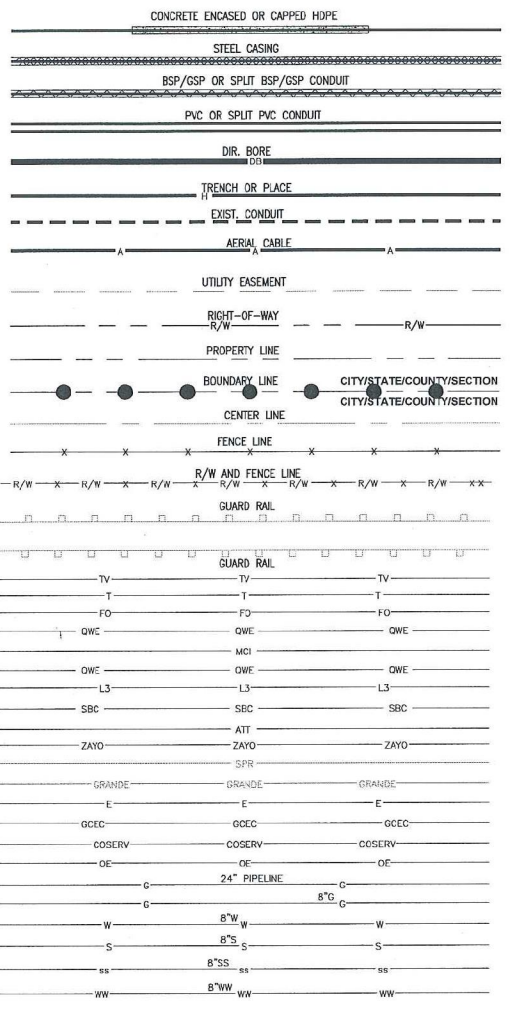
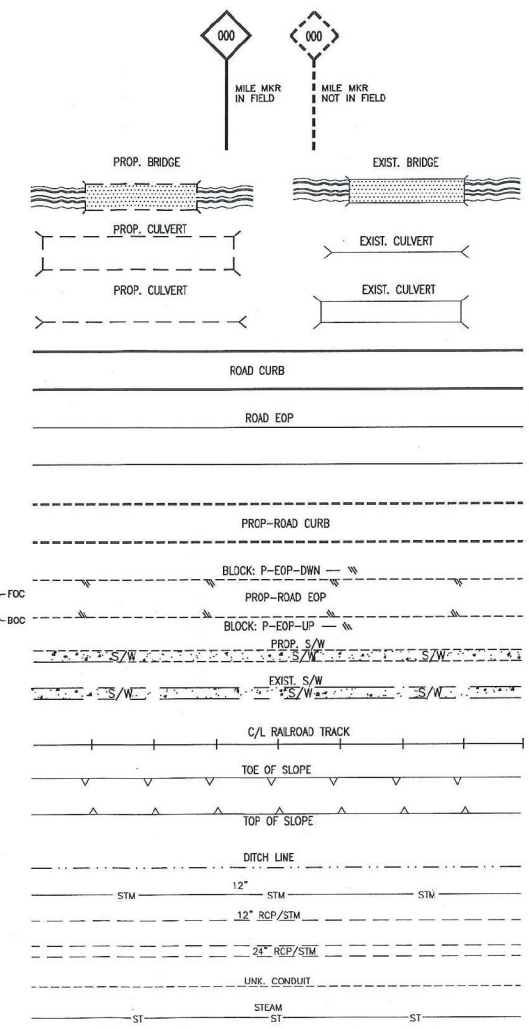

REV	DESCRIPTION	BY	APVD	DATE



PROJECT:	SUPREME MEDICAL LABS 16300 ADDISON RD ADDISON, TX 75001	PROJECT CODE:	PC-18985
TITLE:	LEGEND AND SYMBOLS		
DRAWN:	GXT	DWG NO.:	16300-ADDISON-RD_LS_005.DWG
APPY:		SHEETS:	005 OF 013 APPROVED ORIGINAL ISSUE 06/15/18

ATTENTION: ON THIS DOCUMENT IF PROPRIETARY AND SIGNAL NOT IN FULL COMPLIANCE WITH OR VIOLATION OF ANY FEDERAL, STATE OR LOCAL LAWS, REGULATIONS OR ORDINANCES, THE USER SHALL BE RESPONSIBLE FOR OBTAINING NECESSARY PERMISSIONS FROM THE APPROPRIATE AGENCIES.

## TYPICAL TRENCH DETAILS

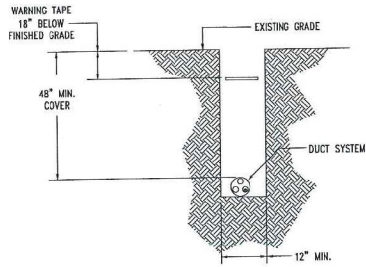

NOTE: BACKFILL WITH NATIVE ROCK FREE MATERIAL OR AS DIRECTED BY CITY. COMPACT TO DENSITY REQUIRED BY CITY.

**TYPICAL TRENCH IN EARTH**  
N.T.S.

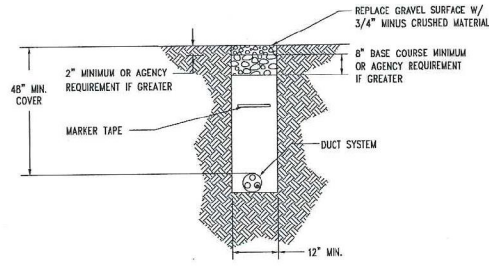

NOTE: BACKFILL WITH NATIVE ROCK FREE MATERIAL OR AS DIRECTED BY CITY. COMPACT TO 95%.

**TYPICAL TRENCH IN GRAVEL**  
N.T.S.

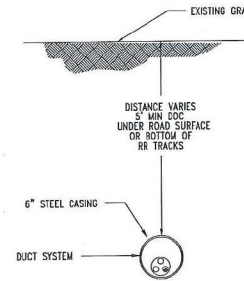

**TYPICAL JACK AND BORE**  
N.T.S.

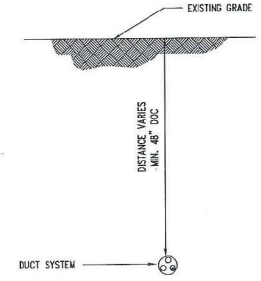

**TYPICAL DIRECTIONAL BORE**  
N.T.S.

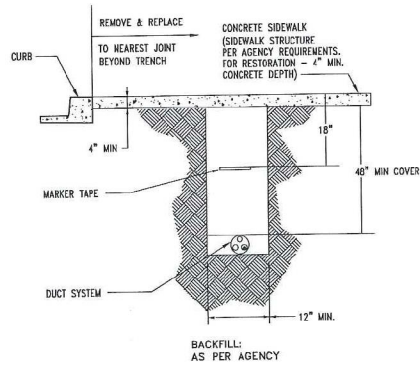

**CONCRETE SIDEWALK RESTORATION**  
N.T.S.

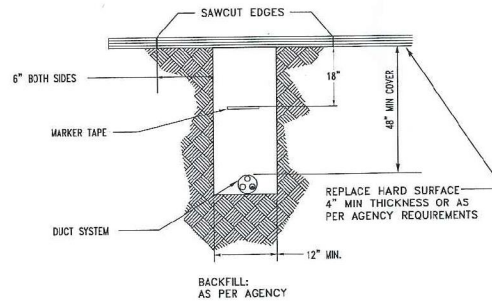

**ASPHALT PAVEMENT RESTORATION**  
N.T.S.

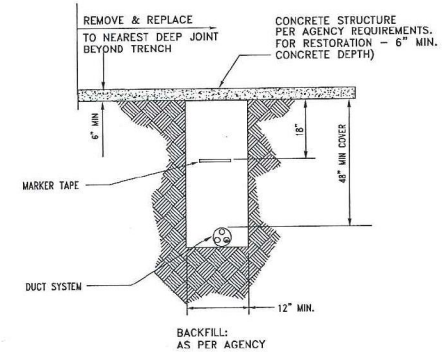

**CONCRETE PAVEMENT RESTORATION**  
N.T.S.

REV	DESCRIPTION	BY	APVD	DATE



PROJECT: SUPREME MEDICAL LABS 16300 ADDISON RD ADDISON, TX 75001		PROJECT CODE: PC-18965
TML: TYPICAL TRENCH DETAILS		
INFORMATION ON THIS DOCUMENT IS PROPRIETARY AND SHALL NOT BE COPIED, REPRODUCED OR TRANSMITTED IN ANY FORM WITHOUT WRITTEN CONSENT OF CARRIER	DRAWN: GXT APPV: APPV	DATE: 16300-ADDISON-RD_DT_00E.DWG SHEETS: 005 OF 013 APPROVED: ORIGINAL: 06/15/18

**GXT**  
 1130 East Arapahoe Road, Suite 625  
 Richardson, TX 75080  
 Phone: 409.365.5142  
 Fax: 409.365.5144



TYPICAL BORE DETAILS

**TYPICAL DIRECTIONAL BORE**  
(CROSSING ROAD/DRIVEWAY)  
2-1.25" HDPE E/W FIBER OPTIC CABLE

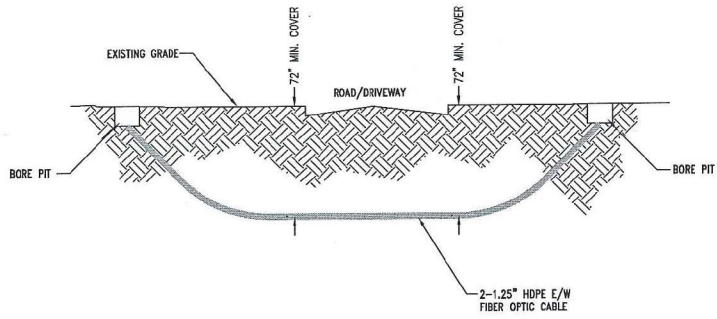

**TYPICAL DIRECTIONAL BORE**  
2-1.25" HDPE E/W FIBER OPTIC CABLE

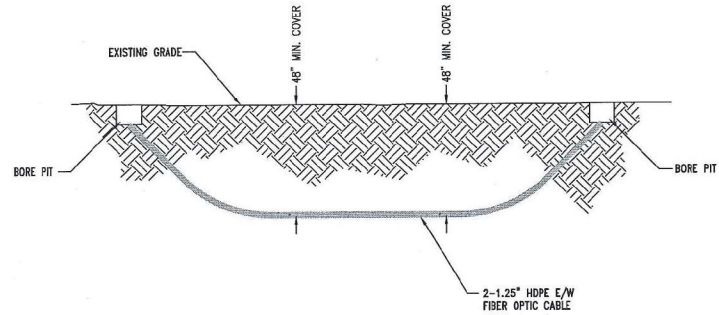

ENGINEERING CONTRACTOR:  
**GXT**  
1133 East Arapaho Road, Suite 425  
Richardson, TX 75081  
Phone: 469.385.5143  
Fax: 469.385.5144

REV	DESCRIPTION	BY	APVD	DATE



INFORMATION ON THIS DOCUMENT IS PROPRIETARY AND SHALL NOT BE LOANED, COPIED, REPRODUCED, OR DISSEMINATED IN WHOLE OR IN PART WITHOUT WRITTEN CONSENT OF CARRIER

PROJECT:	SUPREME MEDICAL LABS 16300 ADDISON RD ADDISON, TX 75001	PROJECT CODE:	PC-10865
TITLE:	TYPICAL BORE DETAILS		
DRAWN:	GXT	DWG NO.:	16300-ADDISON-RD_DT_007.DWG
APPV:		DATE:	06/15/18
SHEET:	007 OF 013	APPROVED ORIGINAL ISSUE	

### TRAFFIC NOTES

CONTRACTOR SHALL PROVIDE AND INSTALL TRAFFIC CONTROL DEVICES IN CONFORMANCE WITH PART VI OF THE TEXAS MANUAL ON UNIFORM TRAFFIC CONTROL DEVICES (TEXAS M.U.T.C.D., MOST RECENT EDITION WITH REVISIONS) DURING CONSTRUCTION.

CONTRACTOR SHALL COVER OPEN EXCAVATIONS WITH STEEL PLATES ANCHORED PROPERLY DURING NON-WORKING HOUR AND OPEN LANES FOR NORMAL TRAFFIC FLOW.

ALL TRAFFIC CONTROL DEVICES USED AT NIGHT SHALL BE REFLECTORIZED OR ILLUMINATED.

CONTRACTOR SHALL MAINTAIN LOCAL DRIVEWAY ACCESS TO RESIDENTIAL AND COMMERCIAL PROPERTIES ADJACENT TO WORK AREA AT ALL TIMES. IF PAVEMENT DROP IS MORE THAN TWELVE INCHES (12") OR MORE, LANES MAY BE CLOSED BETWEEN 9AM AND 4PM ONLY.

ACCESSIBLE PEDESTRIAN ROUTES SHALL BE PROVIDED AT ALL TIMES.

### SPACING FOR CHANNELIZING DEVICES

- A - PLASTIC DRUMS ON MERCING TAPER AT 30' C-C WITH CHEVRON SIGNS AT 60' C-C AND TYPE "C" WARNING LIGHT (FOR OVERNIGHT CLOSURE).
- B - PLASTIC DRUMS ON DOWN STREAM TAPER AT 35' C-C.
- C - PLASTIC DRUMS ON RADII AT 5' C-C.
- D - PLASTIC DRUMS ON TANGENT @ 35' C-C WITH VERTICAL PANEL AT 70' C-C AND TYPE "C" WARNING LIGHT (FOR OVERNIGHT CLOSURE).
- E - PLASTIC DRUMS IN FRONT OF CONSTRUCTION ZONE AT 20' C-C WITH VERTICAL PANEL AT 40' C-C AND TYPE "A" WARNING LIGHT (FOR OVERNIGHT CLOSURE).
- F - CONCRETE TRAFFIC BARRIER (C.T.B.) OR LOW PROFILE CONCRETE TRAFFIC BARRIER (L.P.C.T.B.) WITH REFLECTORS AT 10' C-C IF PAVEMENT DROP IS MORE THAN TWELVE INCHES (12") OR MORE.
- G - PLASTIC DRUM WITH GUARD RAIL MOUNTED.
- H - 28" TUBULAR MARKERS:
  - a) 4-LANE TO 2-LANE UNDIVIDED ROADWAY SECTIONS AT 20' C-C.
  - b) 4-LANE DIVIDED ROADWAY TO ONE SIDE TWO-WAY ROAD AT 20' C-C.
  - c) LEFT LANE, RIGHT LANE STORAGE BAYS AT 22' C-C.

### TRAFFIC CONTROL

### LONGITUDINAL BUFFER SPACE

SPEED (MPH)	LENGTH (METERS)	LENGTH (FEET)
20	11	35
25	17	55
30	26	85
35	36	120
40	51	170
45	66	220
50	84	280
55	101	335
60	125	415
65	146	485
70	178	585
75	219	720

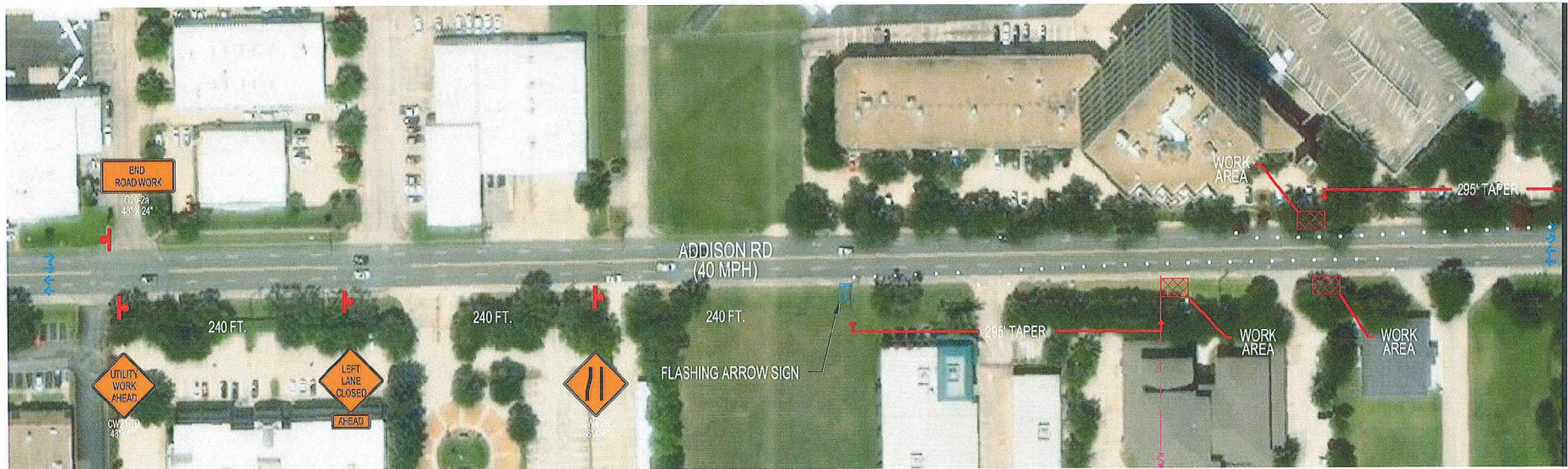

MATCHLINE 'A' SEE SHEET 11A

### MERCING TAPER LENGTHS AND SPACING OF DEVICES

POSTED SPEED	FORMULA	MINIMUM DESIRABLE TAPER LENGTHS			SUGGESTED MAXIMUM SPACING OF CHANNELIZING DEVICES	
		10' OFFSET	11' OFFSET	12' OFFSET	ON A TAPER	ON A TANGENT
30	L = WS/2 60	150'	165'	180'	30'	60' - 75'
35		205'	225'	245'	35'	70' - 90'
40		265'	295'	300'	40'	80' - 100'
45		450'	495'	540'	45'	90' - 110'
50	L = WS	500'	550'	600'	50'	100' - 105'
55		550'	605'	660'	55'	110' - 140'
60		600'	660'	700'	60'	120' - 150'
65		650'	715'	760'	65'	130' - 185'
70		700'	770'	840'	70'	140' - 175'
75		750'	805'	900'	75'	150' - 185'

POSTED SPEED (MPH)	SIGN SPACINGS (FEET)
30 OR LESS	120'
35	160'
40	240'
45	320'
50	400'
55	500'
60	600'
65	700'
70	800'

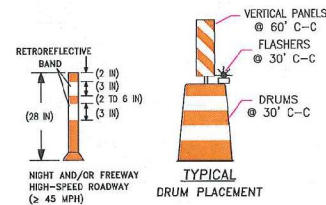

CONSTRUCTION  
JUNE 15, 2018

16300-ADDISON-RD\_TYP\_011.DWG

**TRAFFIC NOTES**

CONTRACTOR SHALL PROVIDE AND INSTALL TRAFFIC CONTROL DEVICES IN CONFORMANCE WITH PART VI OF THE TEXAS MANUAL ON UNIFORM TRAFFIC CONTROL DEVICES (TEXAS M.U.T.C.D.), MOST RECENT EDITION WITH REVISIONS) DURING CONSTRUCTION

CONTRACTOR SHALL COVER OPEN EXCAVATIONS WITH STEEL PLATES ANCHORED PROPERLY DURING NON-WORKING HOUR AND OPEN LANES FOR NORMAL TRAFFIC FLOW.

ALL TRAFFIC CONTROL DEVICES USED AT NIGHT SHALL BE REFLECTORIZED OR ILLUMINATED.

CONTRACTOR SHALL MAINTAIN LOCAL DRIVEWAY ACCESS TO RESIDENTIAL AND COMMERCIAL PROPERTIES ADJACENT TO WORK AREA AT ALL TIMES. IF PAVEMENT DROP IS MORE THAN TWELVE INCHES (12") OR MORE.

LANES MAY BE CLOSED BETWEEN 9AM AND 4PM ONLY.

ACCESSIBLE PEDESTRIAN ROUTES SHALL BE PROVIDED AT ALL TIMES.

**SPACING FOR CHANNELIZING DEVICES**

- A - PLASTIC DRUMS ON MERGING TAPER AT 30' C-C WITH CHEVRON SIGNS AT 60' C-C AND TYPE "C" WARNING LIGHT (FOR OVERNIGHT CLOSURE).
- B - PLASTIC DRUMS ON DOWN STREAM TAPER AT 35' C-C.
- C - PLASTIC DRUMS ON RADII AT 5' C-C.
- D - PLASTIC DRUMS ON TANGENT @ 35' C-C WITH VERTICAL PANEL AT 70' C-C AND TYPE "C" WARNING LIGHT (FOR OVERNIGHT CLOSURE).
- E - PLASTIC DRUMS IN FRONT OF CONSTRUCTION ZONE AT 20' C-C WITH VERTICAL PANEL AT 40' C-C AND TYPE "A" WARNING LIGHT (FOR OVERNIGHT CLOSURE).
- F - CONCRETE TRAFFIC BARRIER (C.T.B.) OR LOW PROFILE CONCRETE TRAFFIC BARRIER (L.P.C.T.B.) WITH REFLECTORS AT 10' C-C IF PAVEMENT DROP IS MORE THAN TWELVE INCHES (12") OR MORE.
- G - PLASTIC DRUM WITH GUARD RAIL MOUNTED.
- H - 28" TUBULAR MARKERS:
  - a) 4-LANE TO 2-LANE UNDIVIDED ROADWAY SECTIONS AT 20' C-C.
  - b) 4-LANE DIVIDED ROADWAY TO ONE SIDE TWO-WAY ROAD AT 20' C-C.
  - c) LEFT LANE, RIGHT LANE STORAGE BAYS AT 22' C-C.

**TRAFFIC CONTROL**

**LONGITUDINAL BUFFER SPACE**

SPEED (MPH)	LENGTH (METERS)	LENGTH (FEET)
20	11	35
25	17	55
30	26	85
35	36	120
40	51	170
45	66	220
50	84	280
55	101	335
60	125	415
65	146	485
70	178	585
75	219	720



**MERGING TAPER LENGTHS AND SPACING OF DEVICES**

POSTED SPEED	FORMULA	MINIMUM DESIRABLE TAPER LENGTHS			SUGGESTED MAXIMUM SPACING OF CHANNELIZING DEVICES	
		10' OFFSET	11' OFFSET	12' OFFSET	ON A TAPER	ON A TANGENT
30	L = WS <sup>2</sup> 60	150'	185'	180'	30'	60' - 75'
35		205'	225'	245'	35'	70' - 90'
40		285'	295'	309'	40'	80' - 100'
45		450'	485'	540'	45'	90' - 110'
50		500'	550'	600'	50'	100' - 105'
55	L = WS	550'	605'	660'	55'	110' - 140'
60		600'	660'	700'	60'	120' - 150'
65		650'	715'	780'	65'	130' - 165'
70		700'	770'	840'	70'	140' - 175'
75		750'	805'	900'	75'	150' - 185'

POSTED SPEED (MPH)	SIGN SPACINGS (FEET)
30 OR LESS	120'
35	160'
40	240'
45	320'
50	400'
55	500'
60	600'
65	700'
70	800'

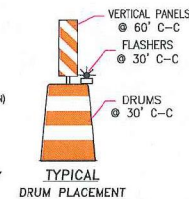
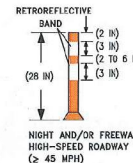

CONSTRUCTION  
 JUNE 15, 2018  
 16300-ADDISON-RD\_TYP\_11A.DWG

**DALLAS COUNTY  
ADDISON, TX**

**PROFILE  
WEST SIDE OF ADDISON RD  
LOOKING WEST**

SCALE  
HOR: 1" = 40'  
VER: 1" = 10'

STA 0+00  
EXIST. UNITS, H  
BEG. TRENCH & PLACE  
  
STA 0+37  
END TRENCH & PLACE

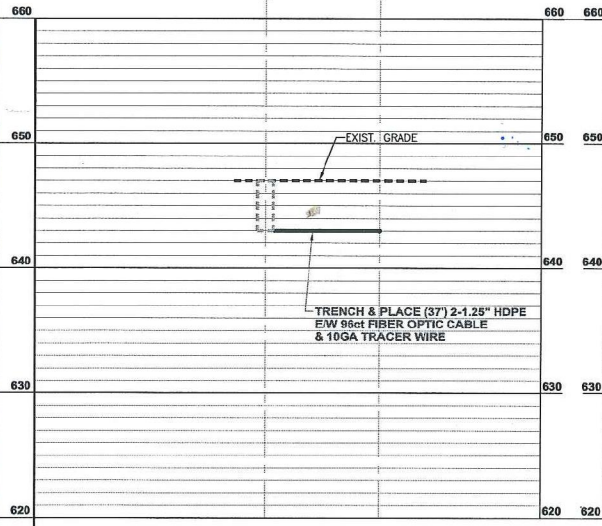

**PROFILE  
CROSSING ADDISON RD  
LOOKING NORTH**

SCALE  
HOR: 1" = 40'  
VER: 1" = 10'

STA 0+37  
BEG. DIR. BORE  
EDGE OF ROAD  
SEWER X-ING  
STORM SEWER X-ING  
  
WATER X-ING  
EDGE OF ROAD  
STA 0+91  
END DIR. BORE  
END/BEG. DIR. BORE

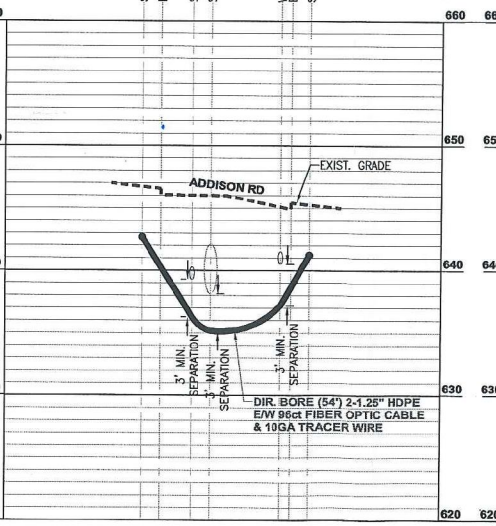

**PROFILE  
EAST SIDE OF ADDISON RD  
LOOKING EAST**

SCALE  
HOR: 1" = 40'  
VER: 1" = 10'

STA 0+91  
BEG. TRENCH & PLACE  
END TRENCH & PLACE  
BEG. DIR. BORE  
EDGE OF DRIVEWAY  
  
EDGE OF DRIVEWAY  
  
STA 2+31  
PLACE UNITS, H  
END DIR. BORE

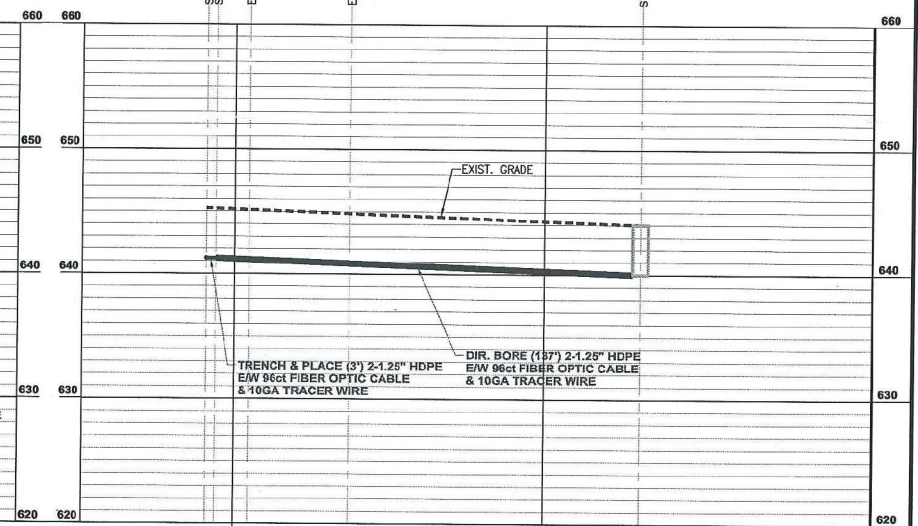

CALL BEFORE YOU DIG  
1-800-245-4545  
48 HOURS NOTICE REQUIRED

ENGINEERING CONTRACTOR:



1130 East Arapaho Blvd., Suite 425  
Richardson, TX 75081  
Tel: 972-508-2193  
Fax: 972-508-5164

REV	DESCRIPTION	BY	APVD	DATE



INFORMATION ON THIS DOCUMENT  
IS PROPRIETARY AND SHALL NOT  
BE REPRODUCED, COPIED, REPRODUCED OR  
DISCLOSED IN ANY MANNER OR BY  
ANY MEANS WITHOUT THE WRITTEN CONSENT OF GXT

PROJECT:	SUPREME MEDICAL LABS 16300 ADDISON RD ADDISON, TX 75001	PROJECT CODE:	PC-18965
TITLE:	FIBER OPTIC CABLE BUILD PROFILE		
DRAWN:	GXT	DATE:	06/15/18
APPV:		SHEETS:	01A OF 002
FILE NO.:	16300-ADDISON-RD_P_01A.DWG	REV:	
APPROVED ORIGINAL ISSUE:			