



FOR ADDISON USE ONLY
 Permit Number: W-1446
 Location: 4119 Billy Mitchell

APPLICATION
Right of Way Work Permit-FRANCHISE

(For Franchise Utility/CTP – Street Cut/Excavation/Lane Closure)

PLEASE PRINT LEGIBLY

Date of Application: 6/7/2018
 Facility Owner Company: Spectrum Company Phone #: 214-319-4811
 Utility/CTP Representative: Stephen Cross Cell Phone #: 469-416-7677
 Utility/CTP Representative E-mail: stephen.cross@charter.com
 General Contractor: TCS Communications LLC Company Phone # 817-864-9337
 Site Supervisor Name: Stephen Smith 24-hour Phone # 214-601-7722
 Contractor E-mail: stephen.smith@tcscmm.com Site Foreman E-mail: Stephen Smith
 Work Site Address and Location: 4119 Billy Mitchell Dr
 Purpose and general description of work: install new service
 Proposed Start Work Date: 6/8/2018 Estimated Completion Date: 10/8/2018
 Pavement Cut? Yes No Directional Bore/Boring? Yes No Excavation? Yes No
 Lane Closure? Yes No Other: _____
 Kasondra Pipkin  Coordinator / Project Services
 Applicant's Printed Name Signature Position with Company
 Applicant's E-mail: kasondra.pipkin@tcscmm.com Applicant's Phone #: 817-864-9337
 Rob Briggs 214-490-0781 TCS Communication LLC
 Direct Supervisor's Name Phone Number Company Name
 Supervisor's E-mail: robert.briggs@tcscmm.com

FOR ADDISON USE ONLY

Received By: Monte S Entered? Yes No Received Date: 6/7/18
 Approved By: Dave Wilde Inspector: JE Issue Date: 6/8/18
 Plans Submitted? Yes No N/A Traffic Control Plan submitted? Yes No N/A Expiration Date: 6/22/18
 Insurance Provided? Yes No On File Performance/Maintenance Bond? Yes No On File N/A
 Fee Paid: 1/A Receipt #: CTP Processed By: Monte S
 Picked Up By: Frank Company: TCS Date & Time: 6-11-18 12:28 PM

TOWN OF ADDISON INFRASTRUCTURE AND DEVELOPMENT SERVICES DEPARTMENT
 ATTN.: RIGHT OF WAY PERMIT - DAVE WILDE 972-450-2847
 16801 WESTGROVE RD. ADDISON, TX 75001-9010
 PHONE: 972-450-2871 FAX: 972-450-2837

RIGHT OF WAY, EXCAVATION &
LANE CLOSURE PERMIT

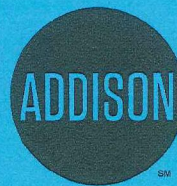

INFRASTRUCTURE &
DEVELOPMENT SERVICES

16801 WESTGROVE DRIVE
ADDISON, TEXAS 75001
972.450.2871

W-1446

PERMIT NUMBER

6/11/18

START DATE

10/8/18

EST. COMPLETION DATE

TCS COMM

CONTRACTOR

SPECTRUM

FOR

4119 BILLY MITCHELL

LOCATION (ADDRESS)

BORE FROM PED @ 4111 TO PED @ 4117 – PULL CABLE TO 4119

LOCATION (ACTUAL)

INSTALL CABLE FACILITIES FOR SERVICE TO ADDRESS

TYPE OF WORK

THIS CARD MUST BE DISPLAYED ON THE JOB SITE AT ALL TIMES.

Spectrum

BUBBI INTELISYS COMM INC
4119 BILLY MITCHELL DR
ADDISON, TEXAS

VICINITY MAP

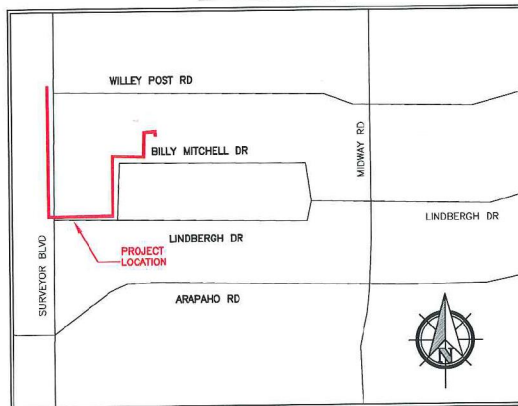

GENERAL PROJECT NOTES

1. ALL CONSTRUCTION WORK WITHIN THE PUBLIC RIGHT-OF-WAY SHALL BE DONE IN ACCORDANCE WITH THE ORDINANCES AND REGULATIONS OF THE MUNICIPALITY IN WHICH THE WORK IS TO BE PERFORMED.
2. EXISTING UTILITY LOCATIONS SHOWN ARE TAKEN FROM AVAILABLE RECORDS AND MAY NOT BE ALL INCLUSIVE. UTILITY LOCATIONS ARE GENERALLY SCHEMATIC IN NATURE AND MAY NOT ACCURATELY REFLECT THE SIZE AND LOCATION OF EACH PARTICULAR UTILITY. THE CONSTRUCTION CONTRACTOR SHALL ASSUME RESPONSIBILITY FOR ACTUAL LINE LOCATES IN THE FIELD AND THE PROTECTION OF ALL EXISTING FACILITIES WHETHER SHOWN OR NOT. THE CONSTRUCTION CONTRACTOR SHALL ALSO ASSUME RESPONSIBILITY FOR REPAIRS TO ANY EXISTING FACILITY DAMAGED AS A DIRECT RESULT OF THE CONSTRUCTION ACTIVITIES WHETHER THE FACILITY IS SHOWN ON THE DRAWINGS OR NOT.
3. THE CONSTRUCTION CONTRACTOR SHALL BE RESPONSIBLE FOR CONTACTING ALL DEPARTMENTS WITHIN THE MUNICIPALITY AND THE UTILITY COMPANIES AT LEAST TWO WORKING DAYS PRIOR TO THE COMMENCEMENT OF WORK.

CALL BEFORE YOU DIG

811

IT'S THE LAW

4. IT SHALL BE THE RESPONSIBILITY OF THE CONSTRUCTION CONTRACTOR TO: A) PREVENT DAMAGE TO PRIVATE AND PUBLIC PROPERTY. B) RESTORE ALL AREAS EFFECTED BY THE CONSTRUCTION TO ORIGINAL OR BETTER CONDITION.
5. BARRICADING AND TRAFFIC CONTROL SHALL BE THE RESPONSIBILITY OF THE CONSTRUCTION CONTRACTOR AND SHALL CONFORM TO THE "TEXAS MANUAL ON UNIFORM TRAFFIC CONTROL DEVICES". TRAFFIC FLOW AND ACCESS SHALL BE MAINTAINED DURING ALL PHASES OF CONSTRUCTION. THE CONSTRUCTION CONTRACTOR IS RESPONSIBLE FOR PROVIDING TRAFFIC SAFETY MEASURES FOR WORK ON THE PROJECT. THE WORK SITE SHALL BE SUITABLY LIT AND BARRICADED AT NIGHT.
6. THE CONSTRUCTION CONTRACTOR SHALL ABIDE BY ALL APPLICABLE FEDERAL, STATE AND LOCAL LAWS GOVERNING EXCAVATION. THE CONSTRUCTION CONTRACTOR SHALL PROVIDE ALL TRENCH SAFETY SYSTEMS THAT COMPLY WITH ALL LAWS GOVERNING EXCAVATION. THE CONSTRUCTION CONTRACTOR SHALL BE SOLELY RESPONSIBLE FOR ALL ASPECTS OF WORK RELATED TO EXCAVATION.
7. ALL CONCRETE USED IN ANY ROADWAY SHALL BE IN COMPLIANCE WITH THE SPECIFIED CLASSES OF CONCRETE IN THE STANDARD SPECIFICATIONS 5.8 "PORTLAND CEMENT CONCRETE PAVEMENT" AND 7.4.5 "QUALITY OF CONCRETE" AS AMENDED BY THE ADDENDUM TO THE NORTH CENTRAL TEXAS STANDARD SPECIFICATIONS FOR PUBLIC WORKS CONSTRUCTION - 2004. ALL OTHER CONCRETE SHALL BE CLASS A CONCRETE.
8. ALL REINFORCING STEEL AND DOWEL BARS IN PAVEMENT SHALL BE SUPPORTED AND MAINTAINED AT THE CORRECT CLEARANCES BY THE USE OF BAR CHAINS OR OTHER APPROVED SUPPORT.
9. ALL CONDUIT MUST BE PLACED WITH A MINIMUM 42" OF COVER, UNLESS OTHERWISE SPECIFIED.
10. ALL BACKFILLING WILL BE MECHANICALLY TAMPED IN LIFTS TO A DENSITY OF 95% PROCTOR. THE REQUIRED DENSITY WILL BE OBTAINED BY USING TAMPERS, RAMMERS OR ROLLING EQUIPMENT. LIFTS MAY VARY ACCORDING TO THE TYPE OF EQUIPMENT USED TO OBTAIN THE REQUIRED DENSITY. SAND AND DEBRIS FREE MATERIAL WILL BE USED FOR BACKFILL.

DFWT CONTACT: DAVID HATTON 972.670.2113

PREPARED BY: DFW TELECOM, INC.

LEGEND

	PROPOSED CONDUIT
	BORE UNDER CONCRETE
	EXISTING CONDUIT
	EXISTING CUSTOMER CONDUIT
	OVERHEAD: NEW BUILD
	OVERHEAD: OVERLASH

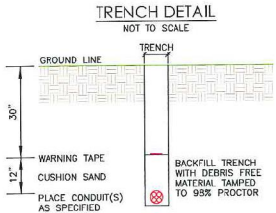
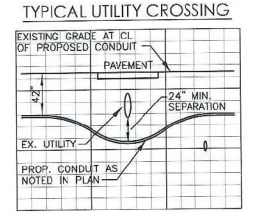
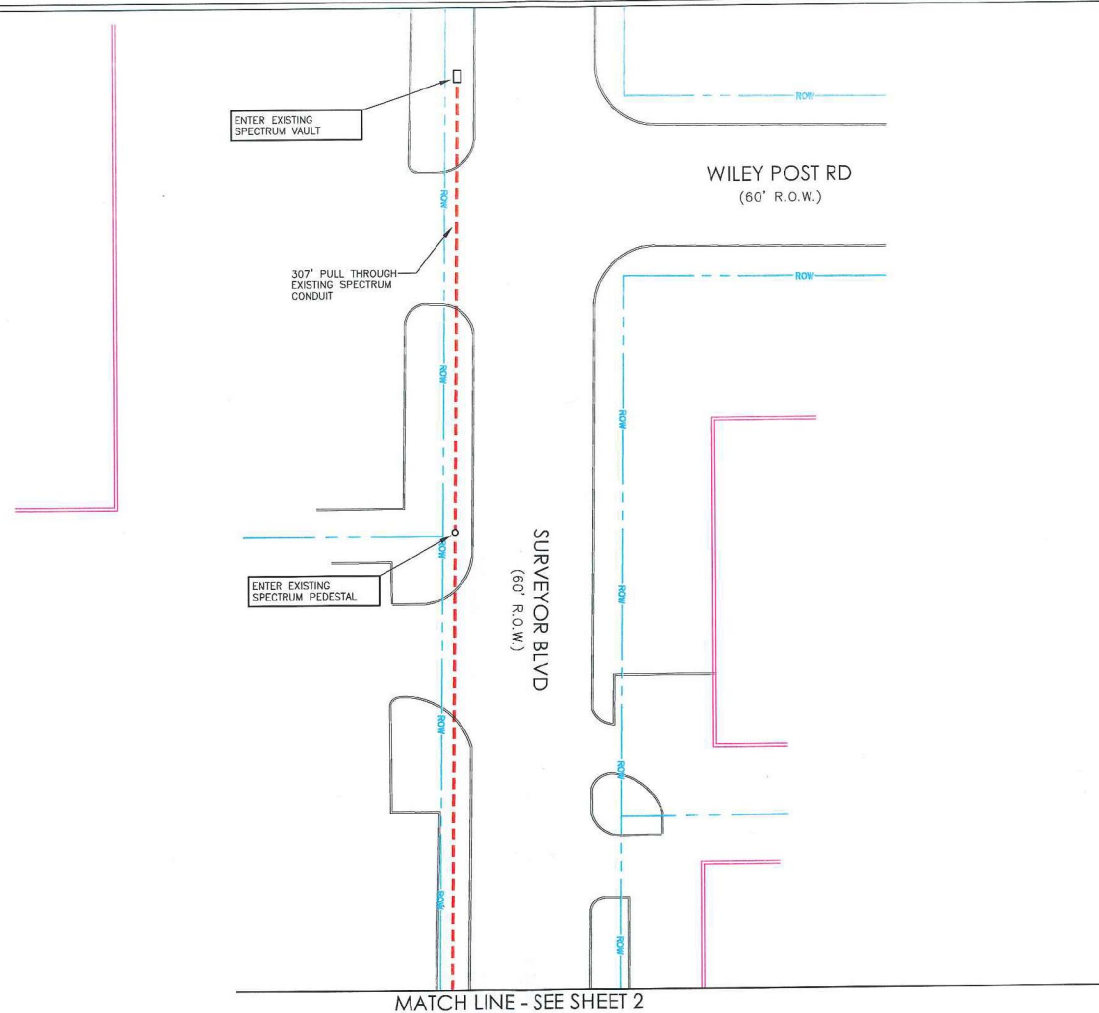

PREPARED BY:

 DFW TELECOM
 DFWT CONTACT:
 DAVID HATTON 972.670.2113

ESTIMATED SHEET TOTALS

DESCRIPTION	QUANTITY	DESCRIPTION	QUANTITY
TRENCH & PLACE CONDUIT		PLACE FLUSH MOUNT VAULT	
BORE & PLACE CONDUIT		PLACE PEDESTAL	
BORE & PLACE STEEL CASING		PLACE FLUSH DROP BUCKET	
PULL THROUGH EXISTING CONDUIT	307'	PLACE POWER SUPPLY	
R & R CONCRETE SIDEWALK (SF)		PLACE WALL BOX & RISER	
R & R CONCRETE PAVEMENT (SF)		PLACE U-GUARD RISER	
OVERHEAD: OVERLASH		OVERHEAD: NEW BUILD	

NORTH

 SHEET
 1 OF 7

PROJECT: **BUBBI INTELISYS COMM INC**
 ADDRESS: 4119 BILLY MITCHELL DR
 CITY, STATE: ADDISON, TEXAS
 HORIZONTAL SCALE: 1" = 40'
 VERTICAL SCALE: 1" = 10'
 JOB NUMBER: 629007
 DATE: 6/4/2018

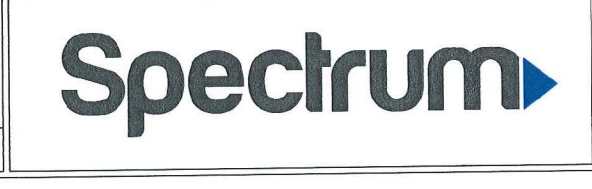

LEGEND

	PROPOSED CONDUIT
	XX' BORE
	BORE UNDER CONCRETE
	EXISTING CONDUIT
	EXISTING CUSTOMER CONDUIT
	OVERHEAD: NEW BUILD
	OVERHEAD: OVERLASH

TYPICAL UTILITY CROSSING

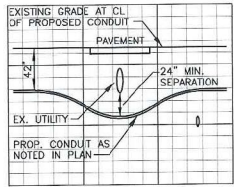

TRENCH DETAIL
NOT TO SCALE

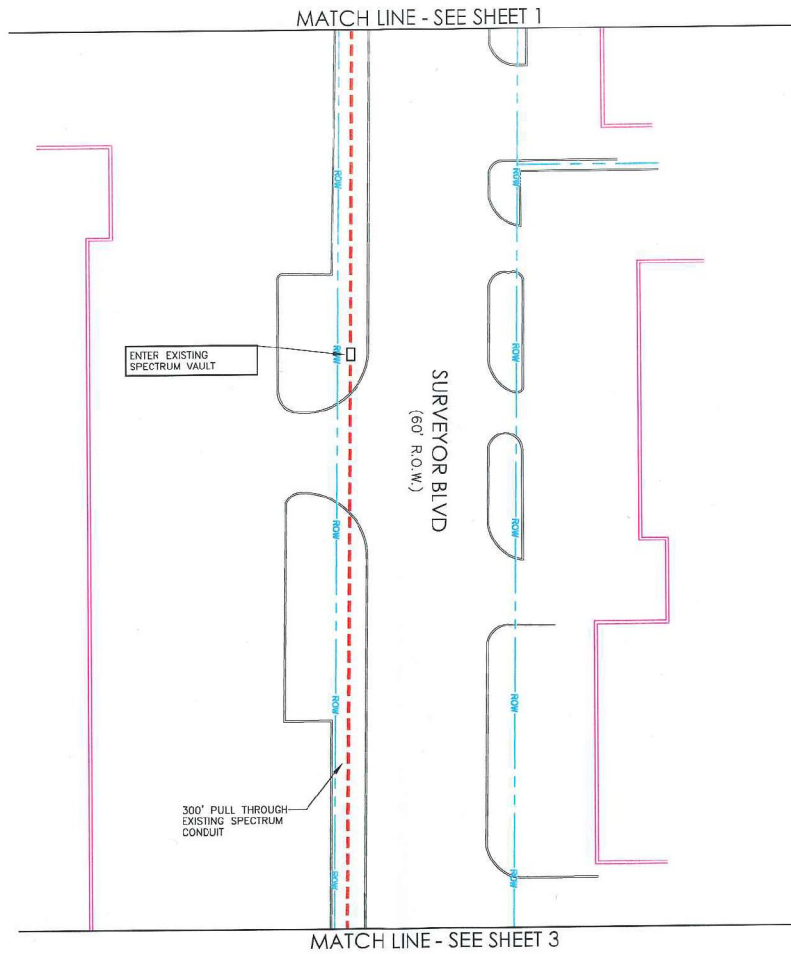
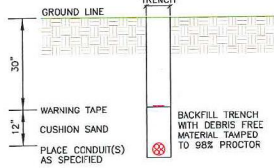

PREPARED BY:



DFWT CONTACT:
DAVID HATTON 972.670.2113

ESTIMATED SHEET TOTALS

DESCRIPTION	QUANTITY	DESCRIPTION	QUANTITY
TRENCH & PLACE CONDUIT		PLACE FLUSH MOUNT VAULT	
BORE & PLACE CONDUIT		PLACE PEDESTAL	
BORE & PLACE STEEL CASING		PLACE FLUSH DROP BUCKET	
PULL THROUGH EXISTING CONDUIT	300'	PLACE POWER SUPPLY	
R & R CONCRETE SIDEWALK (SF)		PLACE WALL BOX & RISER	
R & R CONCRETE PAVEMENT (SF)		PLACE U-GUARD RISER	
OVERHEAD: OVERLASH		OVERHEAD: NEW BUILD	

NORTH



SHEET
2 OF 7

PROJECT: **BUBBI INTELISYS COMM INC**

ADDRESS: 4119 BILLY MITCHELL DR
CITY, STATE: ADDISON, TEXAS

HORIZONTAL SCALE 1" = 40'	VERTICAL SCALE 1" = 10'	JOB NUMBER: 629007	DATE: 6/4/2018
------------------------------	----------------------------	-----------------------	-------------------



LEGEND

	PROPOSED CONDUIT
	BORE UNDER CONCRETE
	EXISTING CONDUIT
	EXISTING CUSTOMER CONDUIT
	OVERHEAD: NEW BUILD
	OVERHEAD: OVERLASH

TYPICAL UTILITY CROSSING

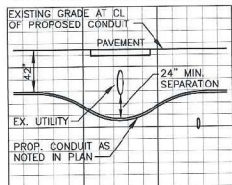

TRENCH DETAIL
NOT TO SCALE

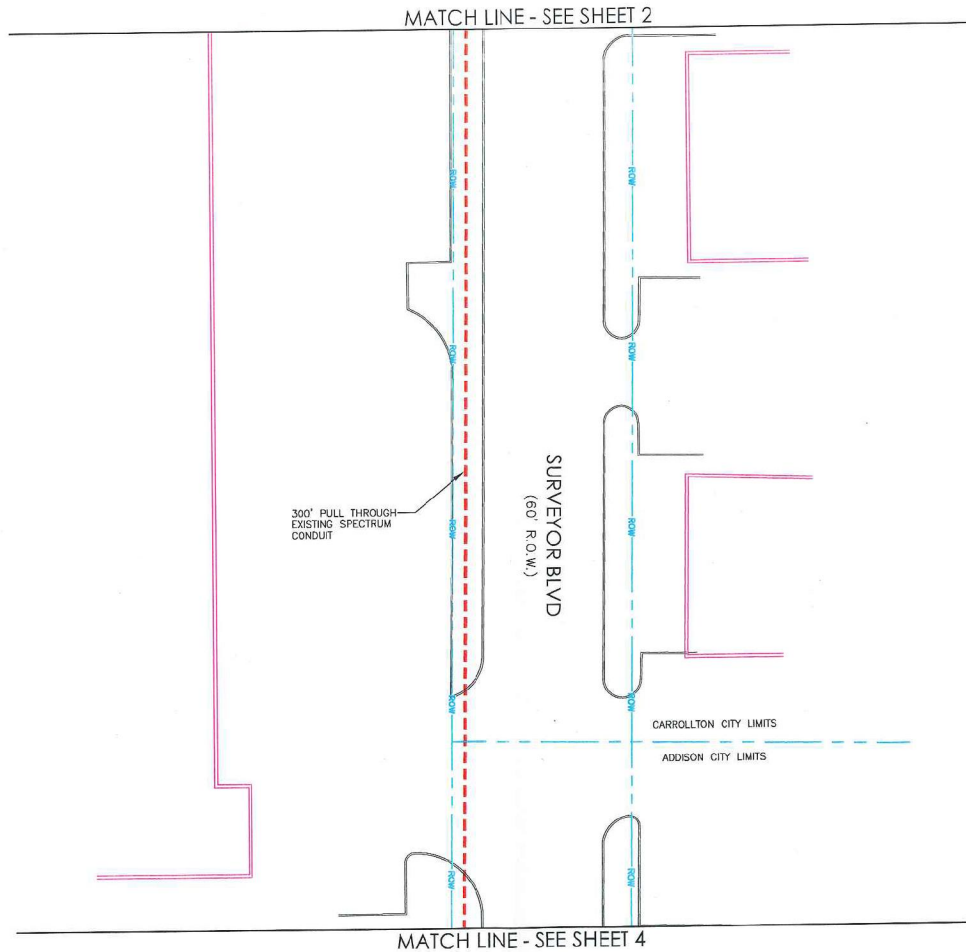
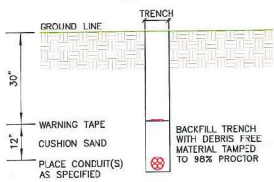

PREPARED BY:



DFWT CONTACT:
DAVID HATTON 972.670.2113

ESTIMATED SHEET TOTALS

DESCRIPTION	QUANTITY	DESCRIPTION	QUANTITY
TRENCH & PLACE CONDUIT		PLACE FLUSH MOUNT VAULT	
BORE & PLACE CONDUIT		PLACE PEDESTAL	
BORE & PLACE STEEL CASING		PLACE FLUSH DROP BUCKET	
PULL THROUGH EXISTING CONDUIT	300'	PLACE POWER SUPPLY	
R & R CONCRETE SIDEWALK (SF)		PLACE WALL BOX & RISER	
R & R CONCRETE PAVEMENT (SF)		PLACE U-GUARD RISER	
OVERHEAD: OVERLASH		OVERHEAD: NEW BUILD	



SHEET
3 OF 7

PROJECT: **BUBBI INTELISYS COMM INC**

ADDRESS: 4119 BILLY MITCHELL DR
CITY, STATE: ADDISON, TEXAS

HORIZONTAL SCALE 1" = 40'	VERTICAL SCALE 1" = 10'	JOB NUMBER 629007	DATE 6/4/2018
------------------------------	----------------------------	----------------------	------------------



LEGEND			
	PROPOSED CONDUIT		BORE UNDER CONCRETE
	EXISTING CONDUIT		EXISTING CUSTOMER CONDUIT
	OVERHEAD: NEW BUILD		OVERHEAD: OVERLASH

MATCH LINE - SEE SHEET 3

SURVEYOR BLVD
(60' R.O.W.)

LINDBERGH DR
(60' R.O.W.)

MATCH LINE - SEE SHEET 5

ENTER EXISTING SPECTRUM PEDESTAL

494' PULL THROUGH EXISTING SPECTRUM CONDUIT

ENTER EXISTING SPECTRUM VAULT

TRENCH DETAIL
NOT TO SCALE

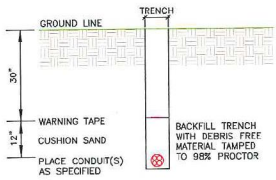

TYPICAL UTILITY CROSSING

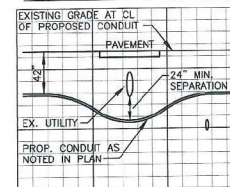

PREPARED BY:



DFWT CONTACT:
DAVID HATTON 972.670.2113

ESTIMATED SHEET TOTALS

DESCRIPTION	QUANTITY	DESCRIPTION	QUANTITY
TRENCH & PLACE CONDUIT		PLACE FLUSH MOUNT VAULT	
BORE & PLACE CONDUIT		PLACE PEDESTAL	
BORE & PLACE STEEL CASING		PLACE FLUSH DROP BUCKET	
PULL THROUGH EXISTING CONDUIT	494'	PLACE POWER SUPPLY	
R & R CONCRETE SIDEWALK (SF)		PLACE WALL BOX & RISER	
R & R CONCRETE PAVEMENT (SF)		PLACE U-GUARD RISER	
OVERHEAD: OVERLASH		OVERHEAD: NEW BUILD	



SHEET
4 OF 7

PROJECT: BUBBI INTELISYS COMM INC

ADDRESS: 4119 BILLY MITCHELL DR
CITY, STATE: ADDISON, TEXAS

HORIZONTAL SCALE 1" = 40'	VERTICAL SCALE 1" = 10'	JOB NUMBER 629007	DATE 6/4/2018
------------------------------	----------------------------	----------------------	------------------



LEGEND	
	PROPOSED CONDUIT
	BORE UNDER CONCRETE
	EXISTING CONDUIT
	EXISTING CUSTOMER CONDUIT
	OVERHEAD: NEW BUILD
	OVERHEAD: OVERLASH

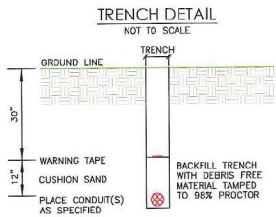
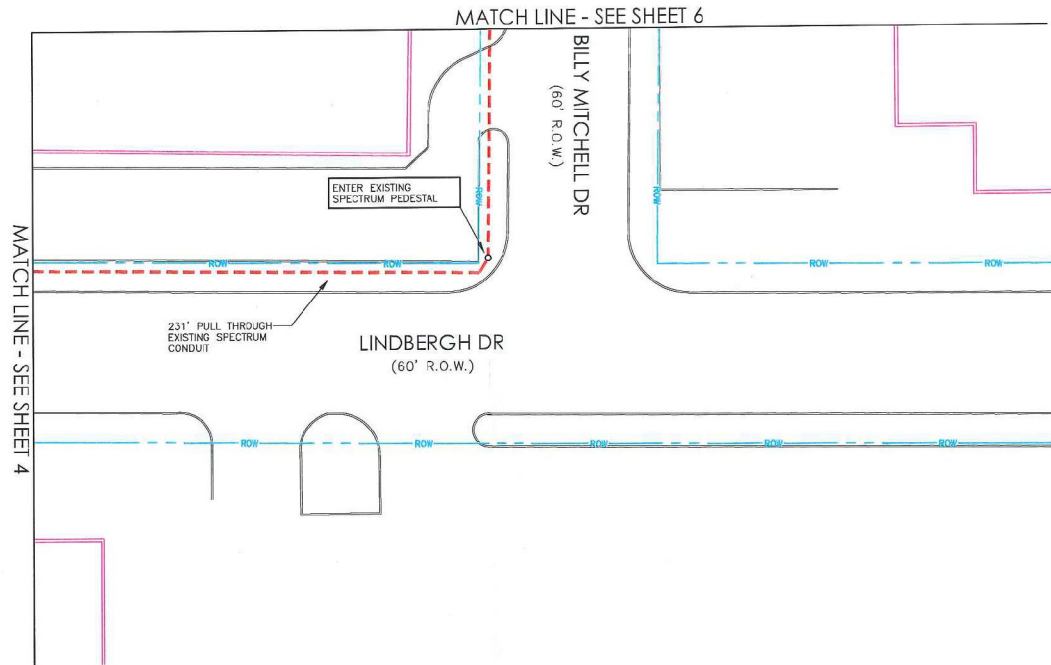

PREPARED BY:



DFWT CONTACT:
DAVID HAITON 972.670.2113

ESTIMATED SHEET TOTALS

DESCRIPTION	QUANTITY	DESCRIPTION	QUANTITY
TRENCH & PLACE CONDUIT		PLACE FLUSH MOUNT VAULT	
BORE & PLACE CONDUIT		PLACE PEDESTAL	
BORE & PLACE STEEL CASING		PLACE FLUSH DROP BUCKET	
PULL THROUGH EXISTING CONDUIT	231'	PLACE POWER SUPPLY	
R & R CONCRETE SIDEWALK (SF)		PLACE WALL BOX & RISER	
R & R CONCRETE PAVEMENT (SF)		PLACE U-GUARD RISER	
OVERHEAD: OVERLASH		OVERHEAD: NEW BUILD	



SHEET
5 OF 7

PROJECT: BUBBI INTELISYS COMM INC

ADDRESS: 4119 BILLY MITCHELL DR
CITY, STATE: ADDISON, TEXAS

HORIZONTAL SCALE 1" = 40'	VERTICAL SCALE 1" = 10'	JOB NUMBER: 629007	DATE: 6/4/2018
------------------------------	----------------------------	-----------------------	-------------------



LEGEND

	PROPOSED CONDUIT
	BORE UNDER CONCRETE
	EXISTING CONDUIT
	EXISTING CUSTOMER CONDUIT
	OVERHEAD: NEW BUILD
	OVERHEAD: OVERLASH

TYPICAL UTILITY CROSSING

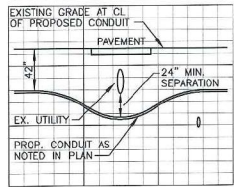

TRENCH DETAIL
NOT TO SCALE

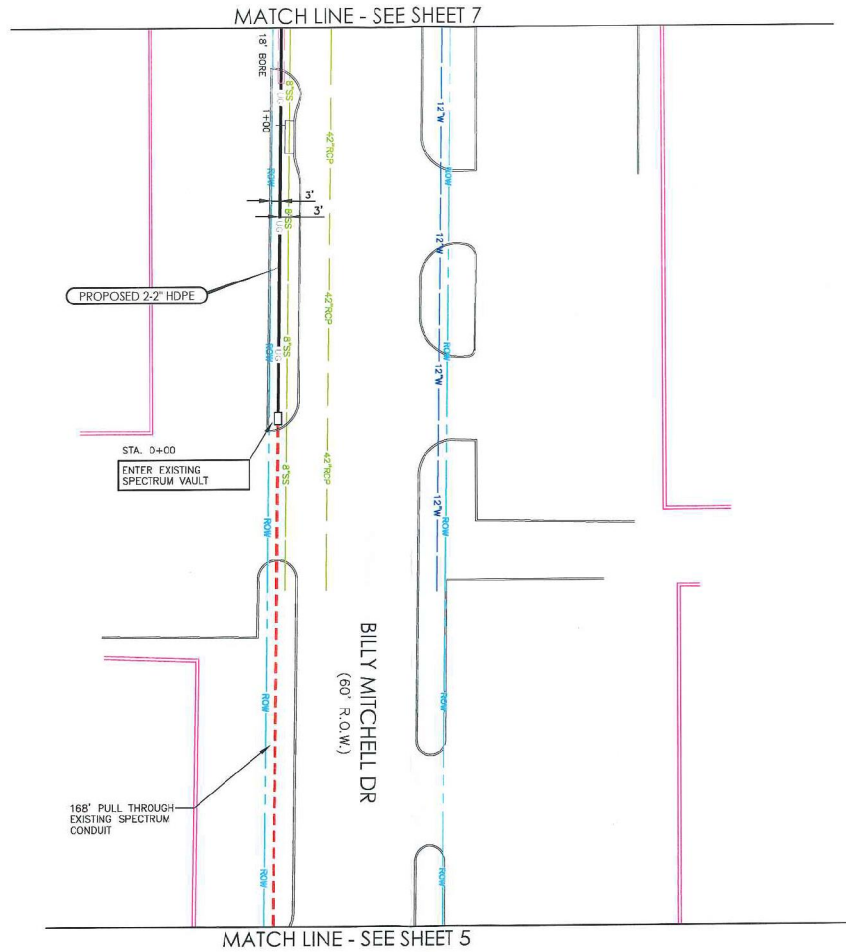
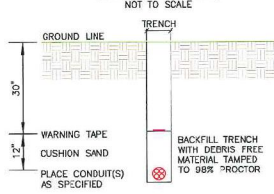

PREPARED BY:



DFWT CONTACT:
DAVID HATTON 972.670.2113

ESTIMATED SHEET TOTALS

DESCRIPTION	QUANTITY	DESCRIPTION	QUANTITY
TRENCH & PLACE CONDUIT	114'	PLACE FLUSH MOUNT VAULT	
BORE & PLACE CONDUIT	18'	PLACE PEDESTAL	
BORE & PLACE STEEL CASING		PLACE FLUSH DROP BUCKET	
PULL THROUGH EXISTING CONDUIT	168'	PLACE POWER SUPPLY	
R & R CONCRETE SIDEWALK (SF)		PLACE WALL BOX & RISER	
R & R CONCRETE PAVEMENT (SF)		PLACE U-GUARD RISER	
OVERHEAD: OVERLASH		OVERHEAD: NEW BUILD	

NORTH



SHEET
6 OF 7

PROJECT: **BUBBI INTELISYS COMM INC**

ADDRESS: 4119 BILLY MITCHELL DR
CITY, STATE: ADDISON, TEXAS

HORIZONTAL SCALE
1" = 40'

VERTICAL SCALE
1" = 10'

JOB NUMBER:
629007

DATE:
6/4/2018



LEGEND

— XX" BORE	PROPOSED CONDUIT
— XX" BORE	BORE UNDER CONCRETE
—	EXISTING CONDUIT
—	EXISTING CUSTOMER CONDUIT
PP XX' PP	OVERHEAD: NEW BUILD
PP XX' PP	OVERHEAD: OVERLASH

TRENCH DETAIL

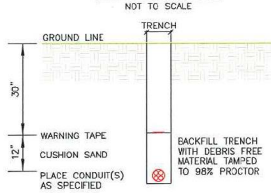

TYPICAL UTILITY CROSSING

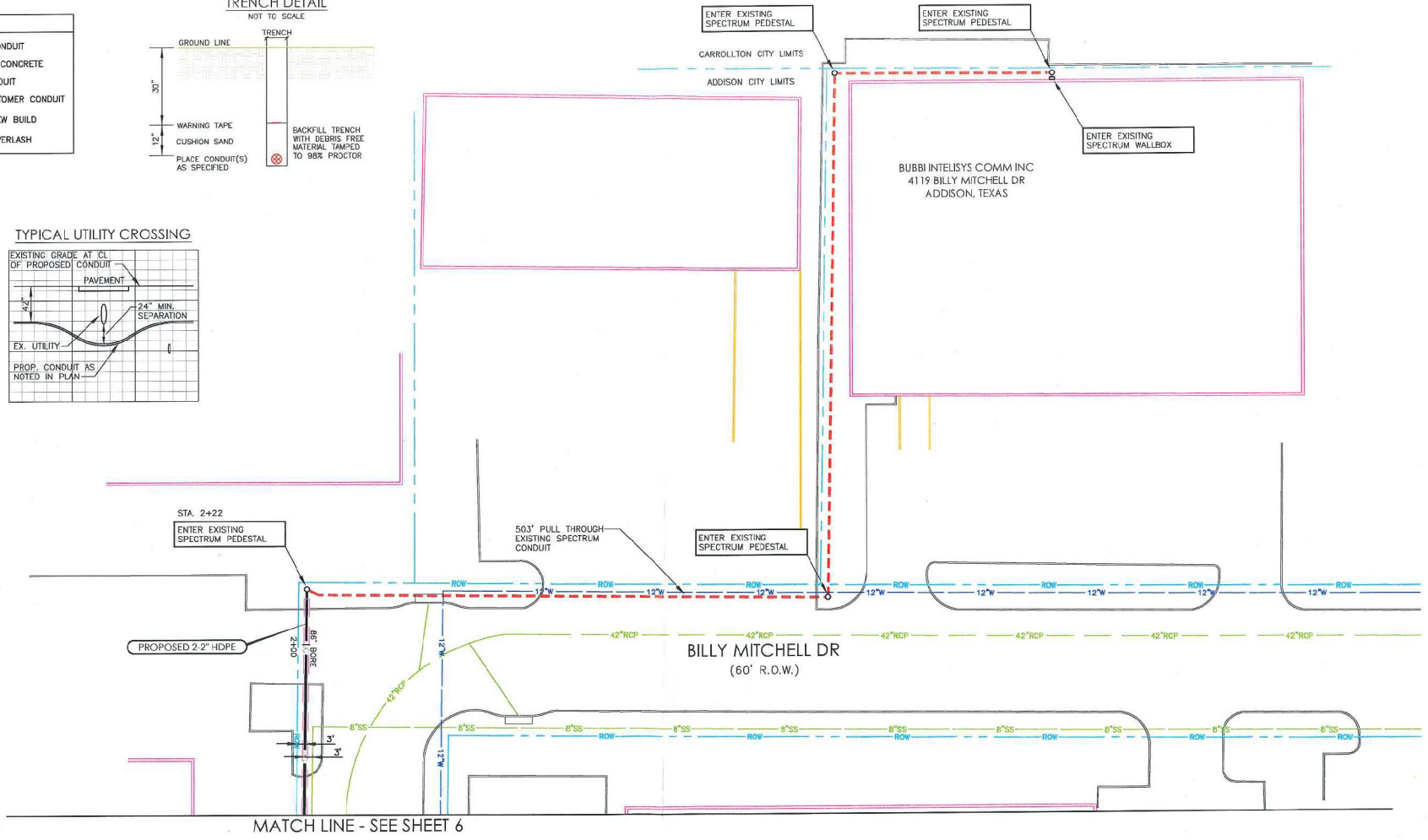
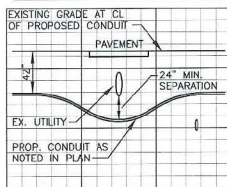

MATCH LINE - SEE SHEET 6

PREPARED BY:



DFWT CONTACT:
DAVID HATTON 972.670.2113

ESTIMATED SHEET TOTALS

DESCRIPTION	QUANTITY	DESCRIPTION	QUANTITY
TRENCH & PLACE CONDUIT	4'	PLACE FLUSH MOUNT VAULT	
BORE & PLACE CONDUIT	86'	PLACE PEDESTAL	
BORE & PLACE STEEL CASING		PLACE FLUSH DROP BUCKET	
PULL THROUGH EXISTING CONDUIT	503'	PLACE POWER SUPPLY	
R & R CONCRETE SIDEWALK (SF)		PLACE WALL BOX & RISER	
R & R CONCRETE PAVEMENT (SF)		PLACE U-GUARD RISER	
OVERHEAD: OVERLASH		OVERHEAD: NEW BUILD	

NORTH



SHEET
7 OF 7

PROJECT: **BUBBI INTELISYS COMM INC**

ADDRESS: 4119 BILLY MITCHELL DR
CITY, STATE: ADDISON, TEXAS

HORIZONTAL SCALE 1" = 40'	VERTICAL SCALE 1" = 10'	JOB NUMBER: 629007	DATE: 6/4/2018
------------------------------	----------------------------	-----------------------	-------------------

