



FOR ADDISON USE ONLY  
 Permit Number: W-1458  
 Location: 15750 Spectrum

**APPLICATION**  
**Right of Way Work Permit-GENERAL**

(General Non-Franchise, Private Development, Work for the Town and Miscellaneous Work)

**PLEASE PRINT LEGIBLY**

Date of application: 6/12/2018  
 Property Owner/Developer Name: Greystar Company Phone #: 843-720-4019  
 Property Owner Contact Name: Mike Best Phone #: 828-773-7092  
 General Contractor Name: Camp Construction Service Phone #: 972-790-8800  
 Site Supervisor Name: Luis Amezcua 24 hour phone #: 817-584-2818  
 Work Site Address and Location: 15750 Spectrum Drive, Addison, TX 75001  
 Purpose and general description of work: Remove and Replace Stucco  
 Proposed Start Work Date: 6/18/2018 Estimated Completion Date: 6/1/2019  
 Pavement Cut?  Yes  No Directional Bore/Boring?  Yes  No Excavation?  Yes  No  
 Lane Closure?  Yes  No Other: \_\_\_\_\_  
 Applicant's Printed Name: Greg Johns Position with Company: Project Manager  
 Applicant's Email: gjohns@campconstruction.com Company Name & Phone Number: Camp Construction Services & 972-790-8800

FOR ADDISON USE ONLY

Received By: Nicole S Entered?  Yes  No Received Date: 6-13-18  
 Approved By: Dave Wilde Inspector: DW/JF Issue Date: 6/27/18  
 Plans Submitted?  Yes  No  N/A Traffic Control Plan submitted?  Yes  No  N/A Expiration Date: 7/12/18  
 Insurance Provided?  Yes  No  On File Performance/Maintenance Bond?  Yes  No  On File  N/A  

<input type="checkbox"/> WA	<input type="checkbox"/> SW	Number Of Connections	Size	@\$	Each = \$
<input type="checkbox"/> WA	<input type="checkbox"/> SW	Number Of Connections	Size	@\$	Each = \$
<input type="checkbox"/> WA	<input type="checkbox"/> SW	Number Of Connections	Size	@\$	Each = \$
<input type="checkbox"/> WA	<input type="checkbox"/> SW	Number Of Connections	Size	@\$	Each = \$

Other (Description): Application Fee = \$ 50.00  
 PERMIT FEE TOTAL = \$ 50.00  
 Receipt #: attached Processed By: Nicole S  
 Picked Up By: Louis Company: Camp Date & Time: 6/27/18 2:08 PM

TOWN OF ADDISON INFRASTRUCTURE AND DEVELOPMENT SERVICES DEPARTMENT  
 ATTN: RIGHT OF WAY PERMIT - DAVE WILDE 972-450-2847  
 16801 WESTGROVE RD, ADDISON, TX 75001-9010  
 PHONE: 972-450-2871 FAX: 972-450-2837



FOR ADDISON USE ONLY  
 Permit Number: W-1152  
 Location: 15750 Spectrum

**APPLICATION**  
**Right of Way Work Permit -GENERAL**

(General Non-Franchise, Private Development, Work for the Town and Miscellaneous Work)

**Sub-Contractor List**

PLEASE PRINT LEGIBLY

General Contractor's Name: Camp Construction Services General Contractor's Phone #: 972-790-8800

Sub-Contractor #1 Company Name: S&D Construction Address: 23115 Sawmill Cross, Spring, TX 77373

Print Sub-Contractor's Name: Sam Garza Sub-Contractor Phone #: \_\_\_\_\_

Sub-Contractor's E-mail: garzas7@sbcglobal.net

Print Site Supervisor's Name: Luis Amezcua Supervisor's Phone #: 817-584-2818

Site Supervisor's E-mail: lamezcua@campconstruction.com

Insurance Provided?  Yes  No  On File

Sub-Contractor #2 Company Name: \_\_\_\_\_ Address: \_\_\_\_\_

Print Sub-Contractor's Name: \_\_\_\_\_ Sub-Contractor Phone #: \_\_\_\_\_

Sub-Contractor's E-mail: \_\_\_\_\_

Print Supervisor's Name: \_\_\_\_\_ Supervisor's Phone #: \_\_\_\_\_

Site Supervisor's E-mail: \_\_\_\_\_

Insurance Provided?  Yes  No  On File

Sub-Contractor #3 Company Name: \_\_\_\_\_ Address: \_\_\_\_\_

Print Sub-Contractor's Name: \_\_\_\_\_ Sub-Contractor Phone #: \_\_\_\_\_

Sub-Contractor's E-mail: \_\_\_\_\_

Print Supervisor's Name: \_\_\_\_\_ Supervisor's Phone #: \_\_\_\_\_

Site Supervisor's E-mail: \_\_\_\_\_

Insurance Provided?  Yes  No  On File



TOWN OF ADDISON  
INFRASTRUCTURE & DEVELOPMENT SERVICES  
16801 Westgrove Dr.  
Addison, TX 75001  
972-450-2881  
Welcome

002432-0014 Nicole S. 06/27/2018 02:07PM

MISCELLANEOUS

RIGHT OF WAY (ROWPER)  
2018 Item: ROWPER  
1.00 @ 50.00  
RIGHT OF WAY (ROWPER) 50.00

-----  
50.00

Subtotal 50.00  
Total 50.00

CREDIT CARD DEV. SVCS. 50.00

MasterCard \*\*\*\*\*3238  
Ref=1629625101  
Auth=170862  
201806271C4E  
AID=A0000000041010  
Invoice=201806271C4E  
AuthCode=170862  
Entry=Chip Read  
AppLabel=DEBIT MASTERCARD  
ATC=004B  
Seq=201806271C4E

-----  
0.00

Change due 0.00

Paid by: CAMP CONSTRUCTION

Comments: ROW PERMIT APPLICATION FEE

Signature: \_\_\_\_\_

Thank you for your payment

TOWN OF ADDISON COPY

RIGHT OF WAY, EXCAVATION &  
LANE CLOSURE PERMIT

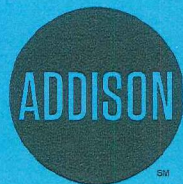

INFRASTRUCTURE &  
DEVELOPMENT SERVICES

16801 WESTGROVE DRIVE  
ADDISON, TEXAS 75001  
972.450.2871

**W-1458**

PERMIT NUMBER

**6/27/18**

START DATE

**6/01/19**

EST. COMPLETION DATE

**CAMP CONST. SVCS GREYSTAR**

CONTRACTOR

FOR

**15750 SPECTRUM DR**

LOCATION (ADDRESS)

**SPECTRUM, SPRUILL, & ALLEGRO PLACE**

LOCATION (ACTUAL)

**TRAFFIC CONTROL FOR BUILDING FACELIFT**

TYPE OF WORK

THIS CARD MUST BE DISPLAYED ON THE JOB SITE AT ALL TIMES.

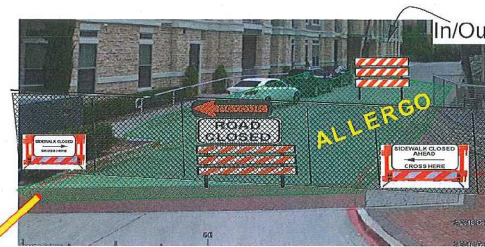

Parking Garage In/Out  
remains open  
Allergo closed North of  
2nd In/Out



Prepared by: Dallas Lite & Barricade Inc  
1607 FtWorth Ave  
Dallas, Texas 75208  
Designer: Gary Howell  
214/748-5791 06/20/2018  
Revised

**Camp Construction #009802**  
**Greg Johns 214/728-8800**  
**Louis Amezcua 817/584-2818**

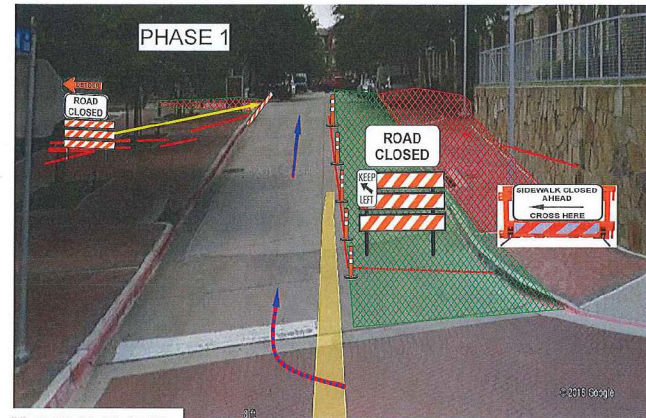
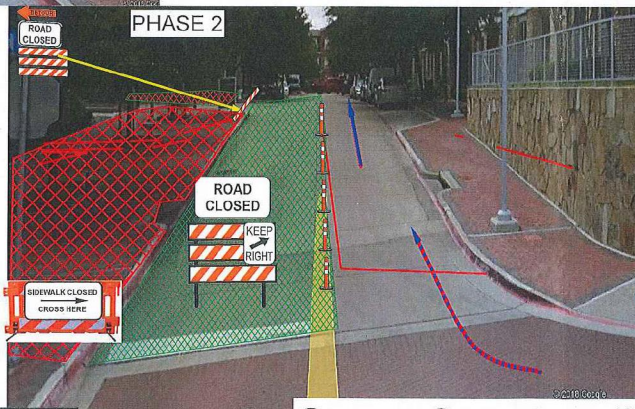
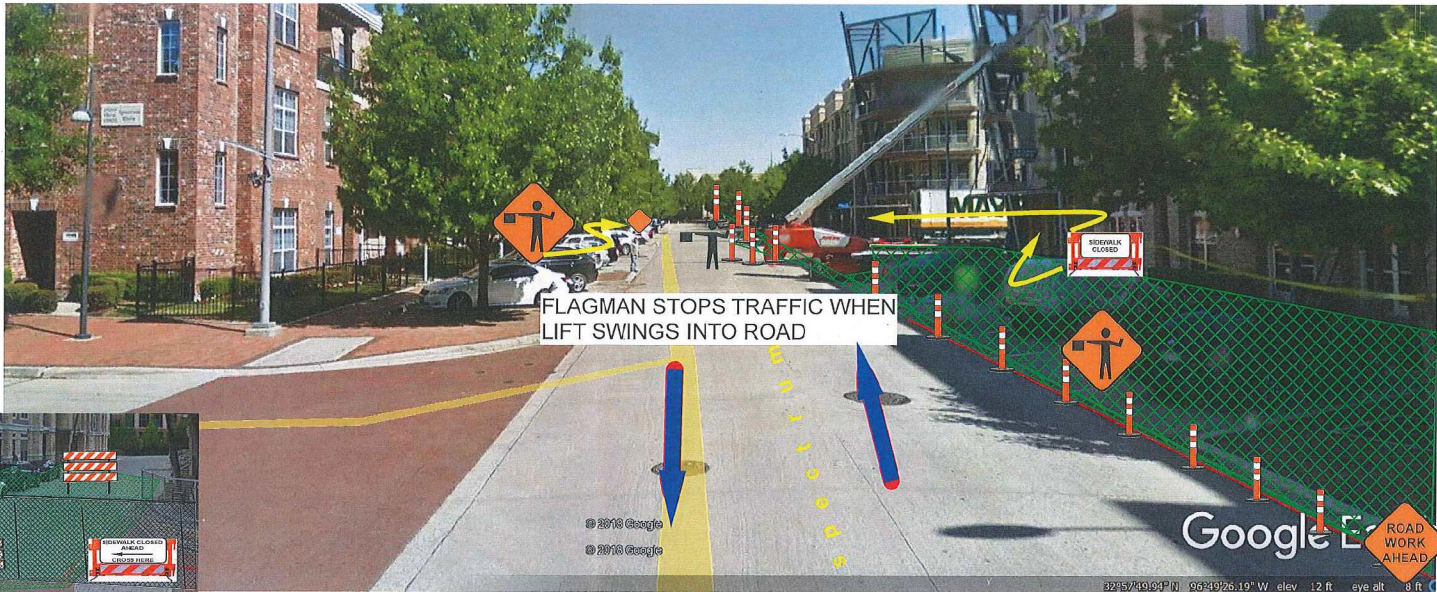

Prepared by: Dallas Lite & Barricade Inc  
 1607 Ft Worth Ave  
 Dallas, Texas 75208

Designer: Gary Howell  
 214/748-5791

06/006/20/2018  
 Revised

**Camp Construction #009802**  
**Greg Johns 214/728-8800**  
**Louis Amezcua 817/584-2818 PAGE 2**

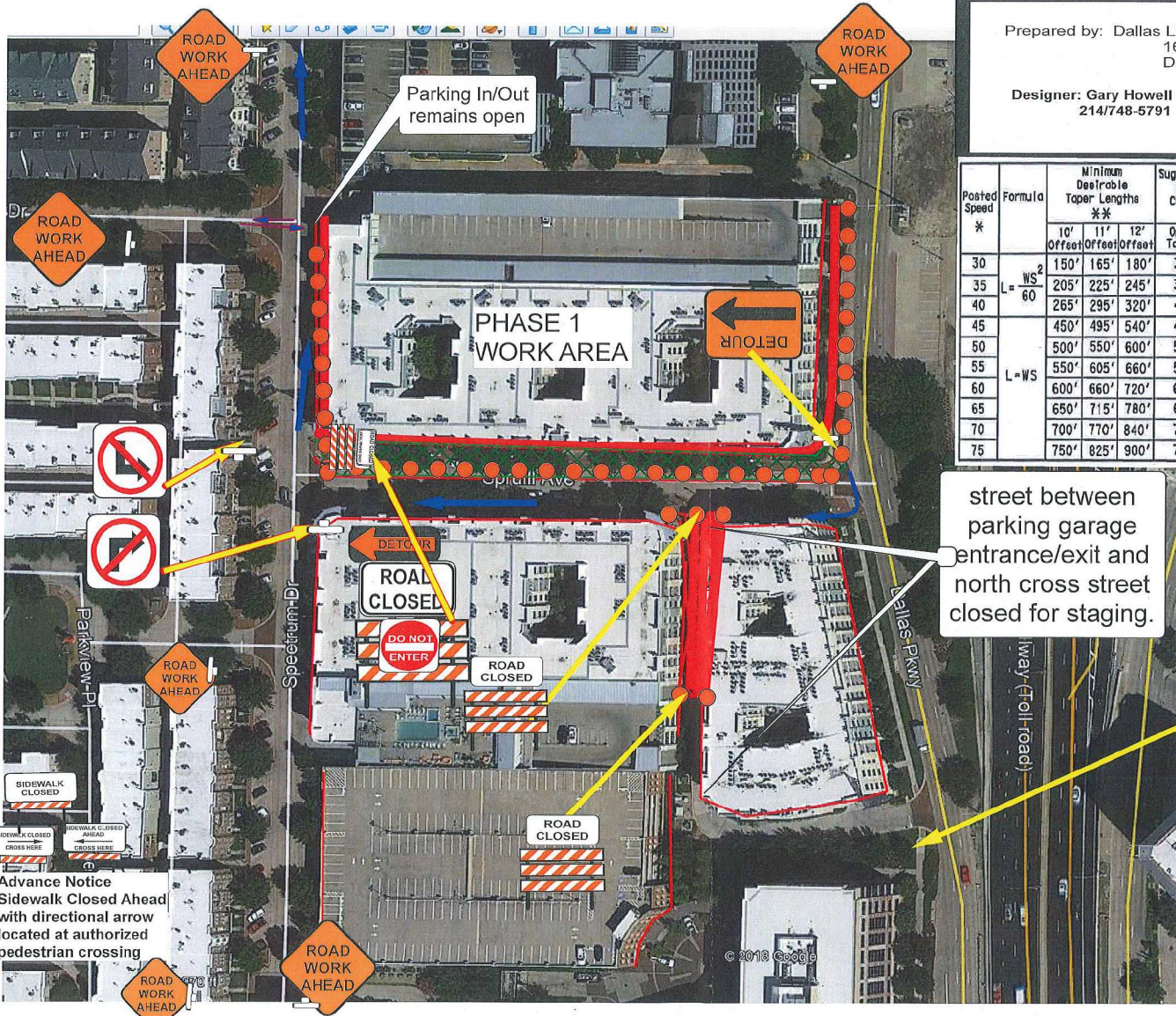

Parking In/Out remains open

Prepared by: Dallas Lite & Barricade Inc  
 1607 Ft Worth Ave  
 Dallas, Texas 75208

Designer: Gary Howell  
 214/748-5791

06/20/2018  
 Revised

Posted Speed *	Formula	Minimum Desirable Taper Lengths **			Suggested Maximum Spacing of Channelizing Devices		Minimum Sign Spacing "x" Distance	Suggested Longitudinal Buffer Space "y"'
		10' Offset	11' Offset	12' Offset	On a Taper	On a Tangent		
30	$L = \frac{WS^2}{60}$	150'	165'	180'	30'	60'	120'	90'
35		205'	225'	245'	35'	70'	160'	120'
40		265'	295'	320'	40'	80'	240'	155'
45	L=WS	450'	495'	540'	45'	90'	320'	195'
50		500'	550'	600'	50'	100'	400'	240'
55		550'	605'	660'	55'	110'	500'	295'
60		600'	660'	720'	60'	120'	600'	350'
65		650'	715'	780'	65'	130'	700'	410'
70	700'	770'	840'	70'	140'	800'	475'	
75	750'	825'	900'	75'	150'	900'	540'	

street between parking garage entrance/exit and north cross street closed for staging.

**ROAD CLOSED**  
 LOCAL TRAFFIC ONLY

Advance Notice Sidewalk Closed Ahead with directional arrow located at authorized pedestrian crossing

Prepared by: Dallas Lite & Barricade Inc  
1607 Ft Worth Ave  
Dallas, Texas 75208

Designer: Gary Howell  
214/748-5791

06/20/2018  
Revised

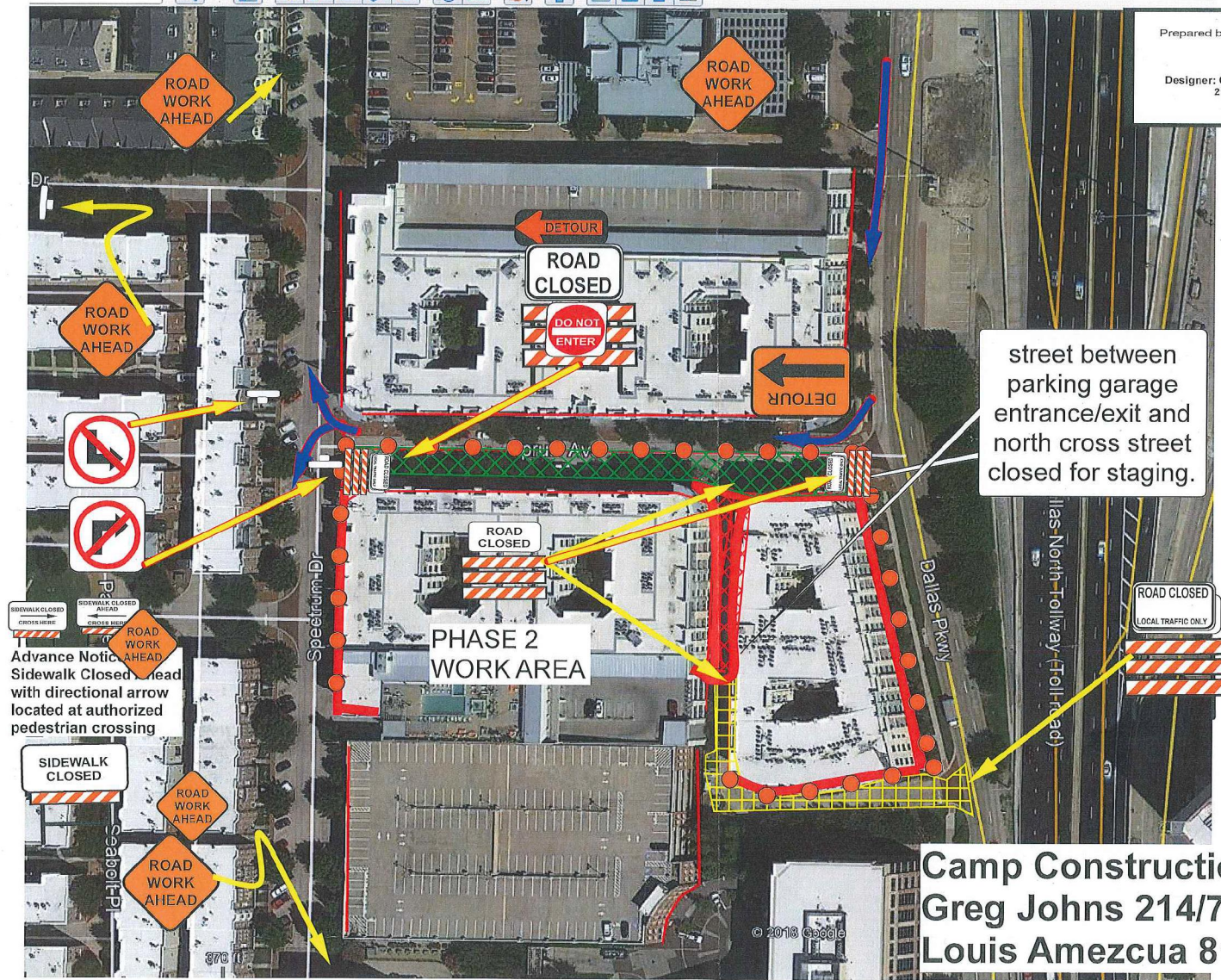

street between parking garage entrance/exit and north cross street closed for staging.

Advance Notice  
Sidewalk Closed Ahead  
with directional arrow  
located at authorized  
pedestrian crossing

Phase 2  
Page 4

Camp Construction #009802  
Greg Johns 214/728-8800  
Louis Amezcua 817/584-2818