



FOR ADDISON USE ONLY
 Permit Number: W-1481
 Location: Glenn Curtis

APPLICATION
Right of Way Work Permit-FRANCHISE

(For Franchise Utility/CTP – Street Cut/Excavation/Lane Closure)

PLEASE PRINT LEGIBLY

Date of Application: 7/13/18
 Facility Owner Company: Spectrum Cable Company Phone #: _____
 Utility/CTP Representative: Lyle Bradley Cell Phone #: 214-846-5286
 Utility/CTP Representative E-mail: lyle.bradley@charter.com
 General Contractor: New Age Communications Construction LLC Company Phone # 214-516-1918
 Site Supervisor Name: Jay Martin 24-hour Phone # 859-630-9879
 Contractor E-mail: jkenn3210@gmail.com Site Foreman E-mail: martin@nacc-llc.com
 Work Site Address and Location: Corner of Addison Rd & Glenn Curtis
 Purpose and general description of work: Underground Cable Replacement - Directional Bore
 Proposed Start Work Date: 7/17/18 7/24/18 Estimated Completion Date: 7/17/18 7/31/18
 Pavement Cut? Yes No Directional Bore/Boring? Yes No Excavation? Yes No
 Lane Closure? Yes No Other: _____
Jessica Kennedy Jessica Kennedy Construction Manager
 Applicant's Printed Name Signature Position with Company
 Applicant's E-mail: jkenn3210@gmail.com Applicant's Phone #: 214-516-1918
Jay Martin 859-630-9879 New Age Comm. Construction
 Direct Supervisor's Name Phone Number Company Name
 Supervisor's E-mail: martin@nacc-llc.com

FOR ADDISON USE ONLY

Received By: Michele S Entered? Yes Received Date: 7/13/18
 Approved By: Dave Wilde Inspector: JE Issue Date: 7/24/18
 Plans Submitted? Yes No N/A Traffic Control Plan submitted? Yes No N/A Expiration Date: 8/5/18
 Insurance Provided? Yes No On File Performance/Maintenance Bond? Yes No On File N/A
 Fee Paid: N/A Receipt #: CTP Processed By: DB
 Picked Up By: Justin Honeycutt Company: NACC Date & Time: 6-30-18

TOWN OF ADDISON INFRASTRUCTURE AND DEVELOPMENT SERVICES DEPARTMENT
 ATTN.: RIGHT OF WAY PERMIT - DAVE WILDE 972-450-2847
 16801 WESTGROVE RD. ADDISON, TX 75001-9010
 PHONE: 972-450-2871 FAX: 972-450-2837

Spectrum

RMO-95473
ADDISON RD &
GLENN CURTISS DR
ADDISON, TX

VICINITY MAP

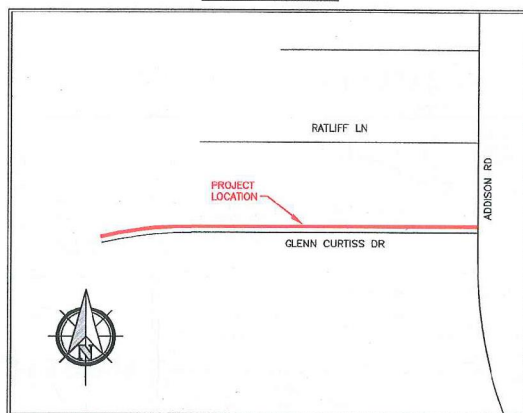

GENERAL PROJECT NOTES

1. ALL CONSTRUCTION WORK WITHIN THE PUBLIC RIGHT-OF-WAY SHALL BE DONE IN ACCORDANCE WITH THE ORDINANCES AND REGULATIONS OF THE MUNICIPALITY IN WHICH THE WORK IS TO BE PERFORMED.
2. EXISTING UTILITY LOCATIONS SHOWN ARE TAKEN FROM AVAILABLE RECORDS AND MAY NOT BE ALL INCLUSIVE. UTILITY LOCATIONS ARE GENERALLY SCHEMATIC IN NATURE AND MAY NOT ACCURATELY REFLECT THE SIZE AND LOCATION OF EACH PARTICULAR UTILITY. THE CONSTRUCTION CONTRACTOR SHALL ASSUME RESPONSIBILITY FOR ACTUAL LINE LOCATES IN THE FIELD AND THE PROTECTION OF ALL EXISTING FACILITIES WHETHER SHOWN OR NOT. THE CONSTRUCTION CONTRACTOR SHALL ALSO ASSUME RESPONSIBILITY FOR REPAIRS TO ANY EXISTING FACILITY DAMAGED AS A DIRECT RESULT OF THE CONSTRUCTION ACTIVITIES WHETHER THE FACILITY IS SHOWN ON THE DRAWINGS OR NOT.
3. THE CONSTRUCTION CONTRACTOR SHALL BE RESPONSIBLE FOR CONTACTING ALL DEPARTMENTS WITHIN THE MUNICIPALITY AND THE UTILITY COMPANIES AT LEAST TWO WORKING DAYS PRIOR TO THE COMMENCEMENT OF WORK.

CALL BEFORE YOU DIG

811

IT'S THE LAW

4. IT SHALL BE THE RESPONSIBILITY OF THE CONSTRUCTION CONTRACTOR TO: A) PREVENT DAMAGE TO PRIVATE AND PUBLIC PROPERTY. B) RESTORE ALL AREAS EFFECTED BY THE CONSTRUCTION TO ORIGINAL OR BETTER CONDITION.
5. BARRICADING AND TRAFFIC CONTROL SHALL BE THE RESPONSIBILITY OF THE CONSTRUCTION CONTRACTOR AND SHALL CONFORM TO THE "TEXAS MANUAL ON UNIFORM TRAFFIC CONTROL DEVICES". TRAFFIC FLOW AND ACCESS SHALL BE MAINTAINED DURING ALL PHASES OF CONSTRUCTION. THE CONSTRUCTION CONTRACTOR IS RESPONSIBLE FOR PROVIDING TRAFFIC SAFETY MEASURES FOR WORK ON THE PROJECT. THE WORK SITE SHALL BE SUITABLY LIT AND BARRICADED AT NIGHT.
6. THE CONSTRUCTION CONTRACTOR SHALL ABIDE BY ALL APPLICABLE FEDERAL, STATE AND LOCAL LAWS GOVERNING EXCAVATION. THE CONSTRUCTION CONTRACTOR SHALL PROVIDE ALL TRENCH SAFETY SYSTEMS THAT COMPLY WITH ALL LAWS GOVERNING EXCAVATION. THE CONSTRUCTION CONTRACTOR SHALL BE SOLELY RESPONSIBLE FOR ALL ASPECTS OF WORK RELATED TO EXCAVATION.
7. ALL CONCRETE USED IN ANY ROADWAY SHALL BE IN COMPLIANCE WITH THE SPECIFIED CLASSES OF CONCRETE IN THE STANDARD SPECIFICATIONS 5.8 "PORTLAND CEMENT CONCRETE PAVEMENT" AND 7.4.5 "QUALITY OF CONCRETE" AS AMENDED BY THE ADDENDUM TO THE NORTH CENTRAL TEXAS STANDARD SPECIFICATIONS FOR PUBLIC WORKS CONSTRUCTION - 2004. ALL OTHER CONCRETE SHALL BE CLASS A CONCRETE.
8. ALL REINFORCING STEEL AND DOWEL BARS IN PAVEMENT SHALL BE SUPPORTED AND MAINTAINED AT THE CORRECT CLEARANCES BY THE USE OF BAR CHAINS OR OTHER APPROVED SUPPORT.
9. ALL CONDUIT MUST BE PLACED WITH A MINIMUM 42" OF COVER, UNLESS OTHERWISE SPECIFIED.
10. ALL BACKFILLING WILL BE MECHANICALLY TAMPED IN LIFTS TO A DENSITY OF 95% PROCTOR. THE REQUIRED DENSITY WILL BE OBTAINED BY USING TAMPERS, RAMMERS OR ROLLING EQUIPMENT. LIFTS MAY VARY ACCORDING TO THE TYPE OF EQUIPMENT USED TO OBTAIN THE REQUIRED DENSITY. SAND AND DEBRIS FREE MATERIAL WILL BE USED FOR BACKFILL.

DFW CONTACT: DAVID HATTON 972.670.2113

PREPARED BY: DFW TELECOM, INC.

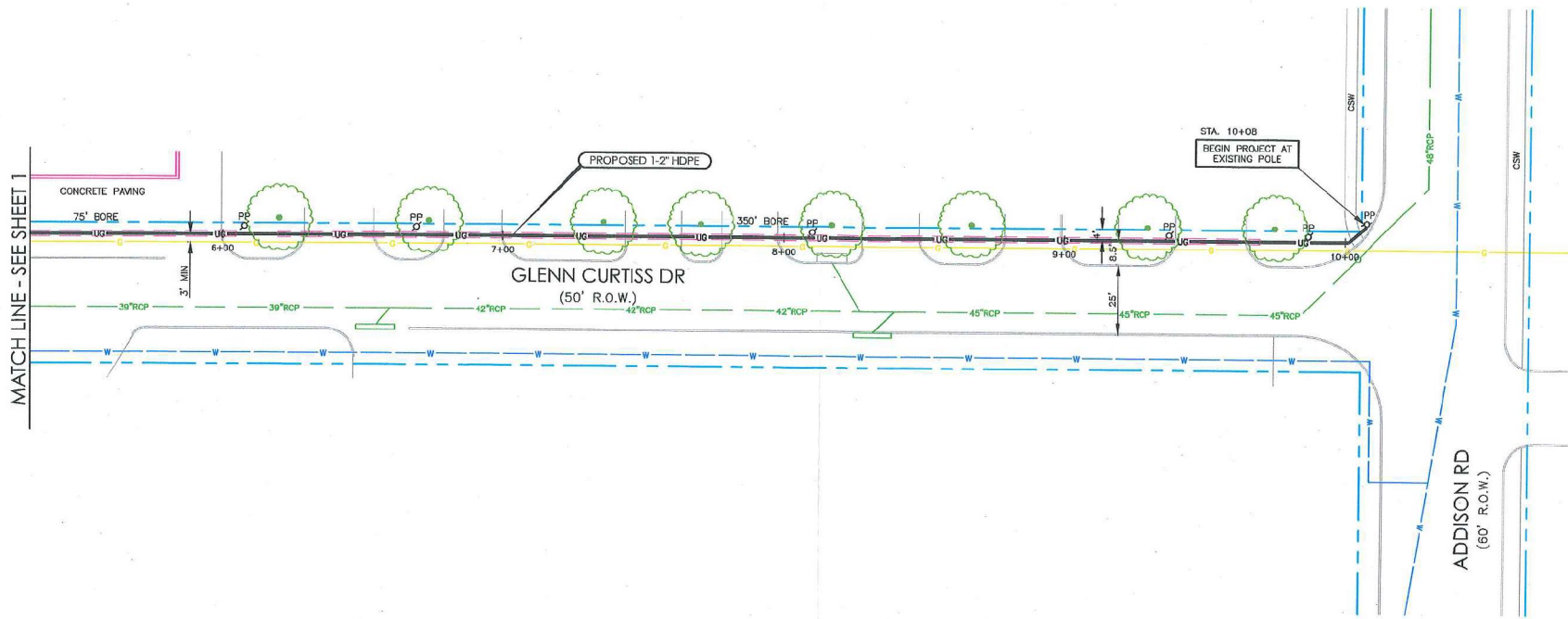

TRENCH DETAIL
NOT TO SCALE

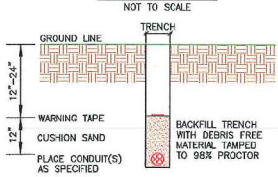

TYPICAL UTILITY CROSSING

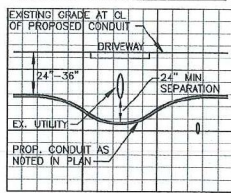

LEGEND	
UG	PROPOSED CONDUIT
XX" BORE	BORE UNDER CONCRETE
---	LEASE DUCT
---	EXISTING SPECTRUM CONDUIT
---	EXISTING CUSTOMER CONDUIT
PP XX" PP	OVERHEAD: NEW BUILD
PP XX" PP	OVERHEAD: OVERLASH

PREPARED BY:

DFW CONTACT:
DAVID HAITON 972.670.2113

ESTIMATED SHEET TOTALS			
DESCRIPTION	QUANTITY	DESCRIPTION	QUANTITY
TRENCH & PLACE CONDUIT	53'	PLACE FLUSH MOUNT VAULT	
BORE & PLACE CONDUIT	425'	PLACE PEDESTAL	
BORE & PLACE STEEL CASING		PLACE FLUSH DROP BUCKET	
PULL THROUGH EXISTING CONDUIT		PLACE POWER SUPPLY	
R & R CONCRETE SIDEWALK (SF)		PLACE WALL BOX & RISER	
R & R CONCRETE PAVEMENT (SF)		PLACE U-GUARD RISER	
AERIAL: OVERLASH		OVERHEAD: NEW BUILD	

NORTH

SHEET
2 OF 2

PROJECT: SPAN REPLACEMENT
(REPLACE EXIST. CATV DUE TO DAMAGE)

ADDRESS: ADDISON RD & GLENN CURTISS DR
CITY, STATE: ADDISON, TX

HORIZONTAL SCALE 1" = 40'	VERTICAL SCALE 1" = 10'	JOB NUMBER: 95473	DATE: 07-11-2018
------------------------------	----------------------------	----------------------	---------------------

RIGHT OF WAY, EXCAVATION &
LANE CLOSURE PERMIT

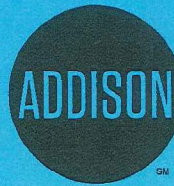

INFRASTRUCTURE &
DEVELOPMENT SERVICES

16801 WESTGROVE DRIVE
ADDISON, TEXAS 75001
972.450.2871

W-1481

PERMIT NUMBER

7/26/18

START DATE

7/31/18

EST. COMPLETION DATE

NEW AGE COMM

CONTRACTOR

SPECTRUM

FOR

GLENN CURTISS

LOCATION (ADDRESS)

FROM POLE TO PEDESTAL, NORTH SIDE OF STREET

LOCATION (ACTUAL)

INSTALL ONE 2" CONDUIT, PULL CABLE

TYPE OF WORK

THIS CARD MUST BE DISPLAYED ON THE JOB SITE AT ALL TIMES.