



FOR ADDISON USE ONLY

Permit Number: 4-1501  
Location: 6301 Addison Rd.

APPLICATION  
Right of Way Work Permit-FRANCHISE

(For Franchise Utility/CTP - Street Cut/Excavation/Lane Closure)

PLEASE PRINT LEGIBLY

Date of Application: 8/12/18

Facility Owner Company: Spectrum Company Phone #: 214-319-4811

Utility/CTP Representative: Stephen Cross Cell Phone #: 469-416-7677

Utility/CTP Representative E-mail: stephen.cross@charter.com

General Contractor: TCS Communications LLC Company Phone # 817-864-9337

Site Supervisor Name: Stephen Smith 24-hour Phone # 214-601-7722

Contractor E-mail: stephen.smith@tcscomm.com Site Foreman E-mail: Stephen Smith

Work Site Address and Location: 16301 Addison Rd PID 776213 Earthlink Business

Purpose and general description of work: install new service

Proposed Start Work Date: 8/5/2018 Estimated Completion Date: 11/5/2018

Pavement Cut?  Yes  No Directional Bore/Boring?  Yes  No Excavation?  Yes  No

Lane Closure?  Yes  No Other: \_\_\_\_\_

Kassandra Pipkin \_\_\_\_\_ Coordinator / Project Services

Applicant's Printed Name \_\_\_\_\_ Signature \_\_\_\_\_ Position with Company

Applicant's E-mail: kassandra.pipkin@tcscomm.com Applicant's Phone #: 817-864-9337

Rob Briggs \_\_\_\_\_ 214-490-0781 \_\_\_\_\_ TCS Communication LLC

Direct Supervisor's Name \_\_\_\_\_ Phone Number \_\_\_\_\_ Company Name

Supervisor's E-mail: robert.briggs@tcscomm.com

FOR ADDISON USE ONLY

Received By: Wilde Entered?  Yes  No Received Date: 8-1-18

Approved By: David Pipkin Inspector: JE Issue Date: 8/3/18

Plans Submitted?  Yes  No  N/A Traffic Control Plan submitted?  Yes  No  N/A Expiration Date: 8/17/18

Insurance Provided?  Yes  No  On File Performance/Maintenance Bond?  Yes  No  N/A

Fee Paid: NA Receipt #: 218 Processed By: Wilde Date & Time: 8-3-18

Picked Up By: AS STEVEN Company: TCS Date & Time: 7:27PM

TOWN OF ADDISON INFRASTRUCTURE AND DEVELOPMENT SERVICES DEPARTMENT

ATTN: RIGHT OF WAY PERMIT - DAVE WILDE 972-460-2847

16601 WESTGROVE RD. ADDISON, TX 75001-9010

PHONE: 972-450-2871 FAX: 972-450-2837



FOR ADDISON USE ONLY

Permit Number: W-1501  
Location: 10301 Addison Rd

**APPLICATION**  
**Right of Way Work Permit - FRANCHISE**

(For Franchise Utility/CTP - Street Cut/Excavation/Lane Closure)

**Sub-Contractor List**

**PLEASE PRINT LEGIBLY**

General Contractor's Name: TCS Communications LLC General Contractor's Phone #: 817-864-9337

**Sub-Contractor #1** Company Name: Jerry Blane Const Address: \_\_\_\_\_

Print Sub-Contractor's Name: John Jerry Sub-Contractor Phone #: 682-582-0247

Sub-Contractor's E-mail: john@jerryblaneconstruction.com

Print Site Supervisor's Name: \_\_\_\_\_ Supervisor's Phone #: \_\_\_\_\_

Site Supervisor's E-mail: \_\_\_\_\_

Insurance Provided?  Yes  No  On File

**Sub-Contractor #2** Company Name: \_\_\_\_\_ Address: \_\_\_\_\_

Print Sub-Contractor's Name: \_\_\_\_\_ Sub-Contractor Phone #: \_\_\_\_\_

Sub-Contractor's E-mail: \_\_\_\_\_

Print Supervisor's Name: \_\_\_\_\_ Supervisor's Phone #: \_\_\_\_\_

Site Supervisor's E-mail: \_\_\_\_\_

Insurance Provided?  Yes  No  On File

**Sub-Contractor #3** Company Name: \_\_\_\_\_ Address: \_\_\_\_\_

Print Sub-Contractor's Name: \_\_\_\_\_ Sub-Contractor Phone #: \_\_\_\_\_

Sub-Contractor's E-mail: \_\_\_\_\_

Print Supervisor's Name: \_\_\_\_\_ Supervisor's Phone #: \_\_\_\_\_

Site Supervisor's E-mail: \_\_\_\_\_

Insurance Provided?  Yes  No  On File

**RIGHT OF WAY, EXCAVATION & LANE CLOSURE PERMIT**

**W-1501**

PERMIT NUMBER

**8/05/18**

START DATE

**11/05/18**

EST. COMPLETION DATE

**TCS COMM**

CONTRACTOR

**SPECTRUM**

FOR

**16301 ADDISON RD**

LOCATION (ADDRESS)

**FROM PEDESTAL TO PEDESTAL ACROSS FRONTAGE**

LOCATION (ACTUAL)

**INSTALL 2-2" HDPE CONDUITS & CABLE TO BLDG**

TYPE OF WORK

THIS CARD MUST BE DISPLAYED ON THE JOB SITE AT ALL TIMES

**INFRASTRUCTURE & DEVELOPMENT SERVICES**  
16801 WESTGROVE DRIVE  
ADDISON, TEXAS 75001  
972.450.2871

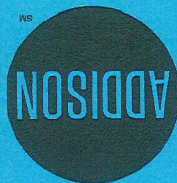



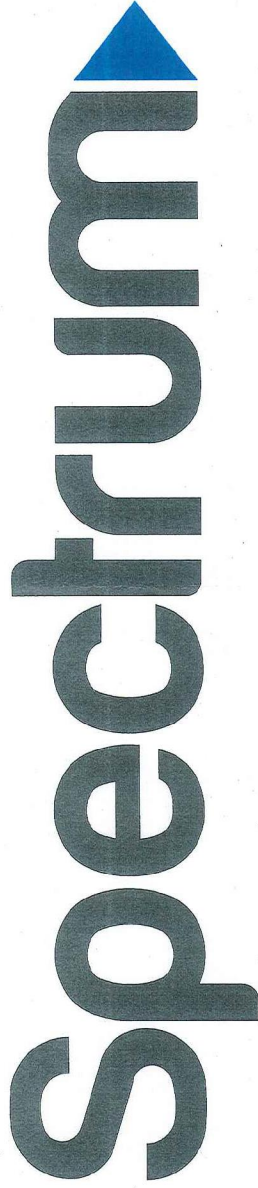

**EARTHLINK BUSINESS LLC**  
**16301 ADDISON RD**  
**ADDISON, TEXAS**

**GENERAL PROJECT NOTES**

1. ALL CONSTRUCTION WORK WITHIN THE PUBLIC RIGHT-OF-WAY SHALL BE DONE IN ACCORDANCE WITH THE ORDINANCES AND REGULATIONS OF THE MUNICIPALITY IN WHICH THE WORK IS TO BE PERFORMED.
2. EXISTING UTILITY LOCATIONS SHOWN ARE TAKEN FROM AVAILABLE RECORDS AND MAY NOT BE ALL INCLUSIVE. UTILITY LOCATIONS ARE GENERALLY SCHEMATIC IN NATURE AND MAY NOT ACCURATELY REFLECT THE SIZE AND LOCATION OF EACH PARTICULAR UTILITY. THE CONSTRUCTION CONTRACTOR SHALL ASSUME RESPONSIBILITY FOR ACTUAL LINE LOCATES IN THE FIELD AND THE PROTECTION OF ALL EXISTING UTILITIES, WHETHER SHOWN OR NOT. THE CONSTRUCTION CONTRACTOR SHALL ALSO ASSUME RESPONSIBILITY FOR REPAIRS TO ANY EXISTING FACILITY DAMAGED AS A DIRECT RESULT OF THE CONSTRUCTION ACTIVITIES WHETHER THE FACILITY IS SHOWN ON THE DRAWINGS OR NOT.
3. THE CONSTRUCTION CONTRACTOR SHALL BE RESPONSIBLE FOR CONTACTING ALL DEPARTMENTS WITHIN THE MUNICIPALITY AND THE UTILITY COMPANIES AT LEAST TWO WORKING DAYS PRIOR TO THE COMMENCEMENT OF WORK. CALL BEFORE YOU DIG 811 IT'S THE LAW
4. IT SHALL BE THE RESPONSIBILITY OF THE CONSTRUCTION CONTRACTOR TO: A) PREVENT DAMAGE TO PRIVATE AND PUBLIC PROPERTY. B) RESTORE ALL AREAS EFFECTED BY THE CONSTRUCTION TO ORIGINAL OR BETTER CONDITION.
5. BARRICADING AND TRAFFIC CONTROL SHALL BE THE RESPONSIBILITY OF THE CONSTRUCTION CONTRACTOR AND SHALL CONFORM TO THE "TEXAS MANUAL ON UNIFORM TRAFFIC CONTROL DEVICES", TRAFFIC FLOW AND ACCESS SHALL BE MAINTAINED DURING ALL PHASES OF CONSTRUCTION. THE CONSTRUCTION CONTRACTOR IS RESPONSIBLE FOR PROVIDING TRAFFIC SAFETY MEASURES FOR WORK ON THE PROJECT. THE WORK SITE SHALL BE SUITABLY LIT AND BARRICADED AT NIGHT.
6. THE CONSTRUCTION CONTRACTOR SHALL ABIDE BY ALL APPLICABLE FEDERAL, STATE AND LOCAL LAWS GOVERNING EXCAVATION. THE CONSTRUCTION CONTRACTOR SHALL PROVIDE ALL TRENCH SAFETY SYSTEMS THAT COMPLY WITH ALL LAWS GOVERNING EXCAVATION. THE CONSTRUCTION CONTRACTOR SHALL BE SOLELY RESPONSIBLE FOR ALL ASPECTS OF WORK RELATED TO EXCAVATION.
7. ALL CONCRETE USED IN ANY ROADWAY SHALL BE IN COMPLIANCE WITH THE SPECIFIED CLASSES OF CONCRETE IN THE STANDARD SPECIFICATIONS 5.8 "PORTLAND CEMENT CONCRETE PAVEMENT" AND 7.4.5 "QUALITY OF CONCRETE" AS AMENDED BY THE ADDENDUM TO THE NORTH CENTRAL TEXAS STANDARD SPECIFICATIONS FOR PUBLIC WORKS CONSTRUCTION - 2004. ALL OTHER CONCRETE SHALL BE CLASS A CONCRETE.
8. ALL REINFORCING STEEL AND DOWEL BARS IN PAVEMENT SHALL BE SUPPORTED AND MAINTAINED AT THE CORRECT CLEARANCES BY THE USE OF BAR CHAINS OR OTHER APPROVED SUPPORT.
9. ALL CONDUIT MUST BE PLACED WITH A MINIMUM 42" OF COVER, UNLESS OTHERWISE SPECIFIED.
10. ALL BACKFILLING WILL BE MECHANICALLY TAMPED IN LIFTS TO A DENSITY OF 95% PROCTOR. THE REQUIRED DENSITY WILL BE OBTAINED BY USING TAMPERS, RAMMERS OR ROLLING EQUIPMENT. METHODS MAY VARY ACCORDING TO THE TYPE OF EQUIPMENT USED TO OBTAIN THE REQUIRED DENSITY. SAND AND DEBRIS FREE MATERIAL WILL BE USED FOR BACKFILL.

VICINITY MAP

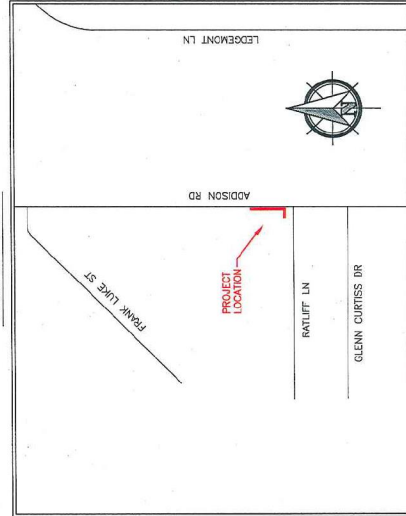

DFWT CONTACT: **DAVID HATTON 972.670.2113**

PREPARED BY: **DFW TELECOM, INC.**

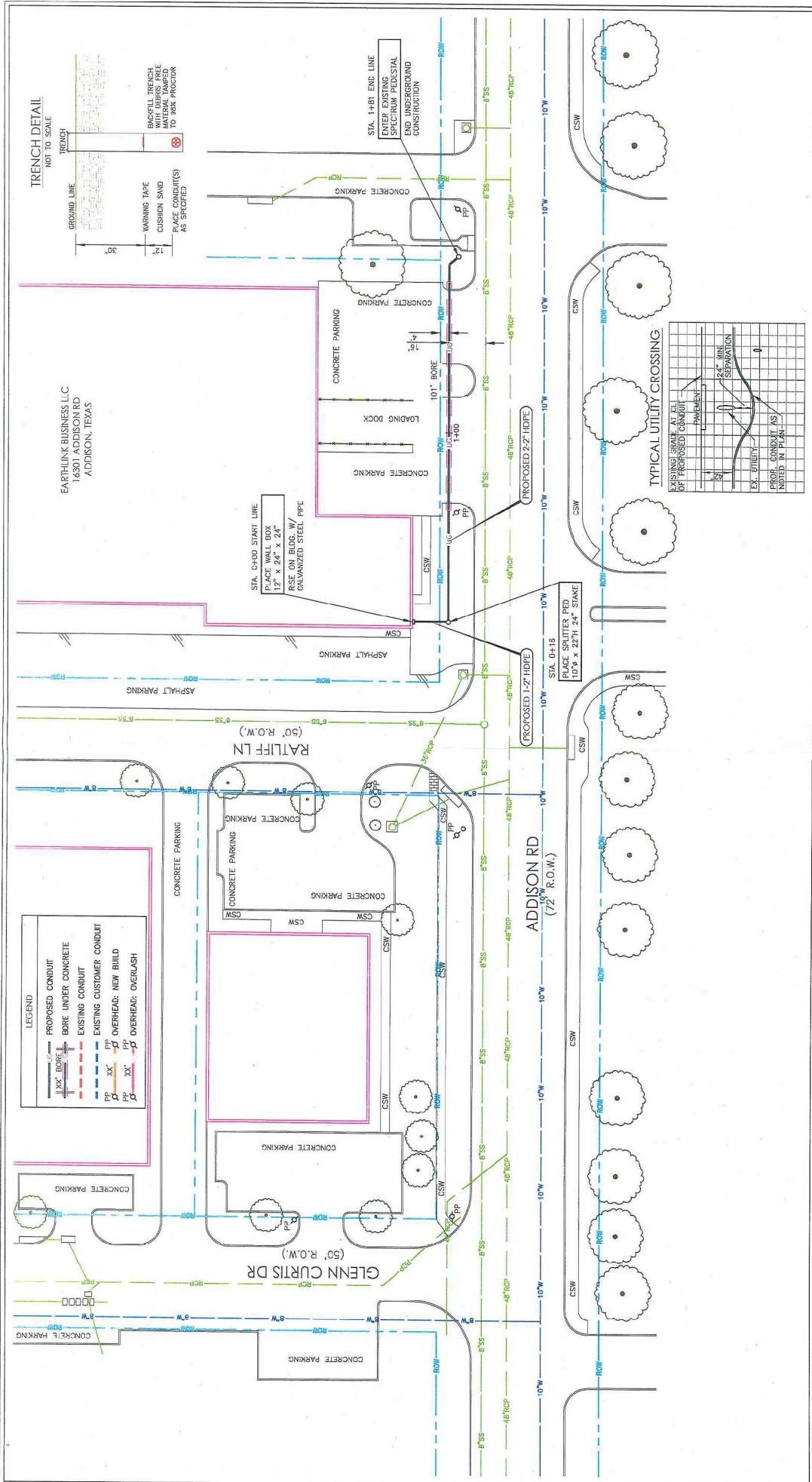

**LEGEND**

XXX BORE	PROPOSED CONDUIT
--- BORE	BORE UNDER CONCRETE
---	EXISTING CONDUIT
---	EXISTING CUSTOMER CONDUIT
PP	PP
XX	XX
XX	OVERHEAD: NEW BUILD
XX	OVERHEAD: OVERLASH

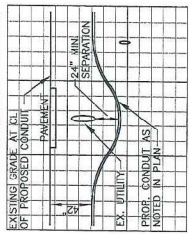
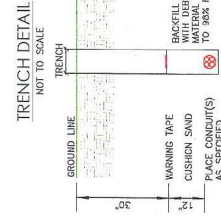

---

PROJECT: EARTHLINK BUSINESS LLC

ADDRESS: 16301 ADDISON RD  
CITY, STATE: ADDISON, TEXAS

HORIZONTAL SCALE: 1" = 40'  
VERTICAL SCALE: 1" = 10'

JOB NUMBER: PID - 776213  
DATE: 07-30-2018

---

NORTH

SHEET 1 OF 1

---

**ESTIMATED SHEET TOTALS**

DESCRIPTION	QUANTITY	DESCRIPTION	QUANTITY
TRENCH & PLACE CONDUIT	80'	PLACE FLUSH MOUNT VAULT	
BORE & PLACE CONDUIT	101'	PLACE PEDIestal	1
BORE & PLACE STEEL CASING		PLACE FLUSH DROP BUCKET	
PULL THROUGH EXISTING CONDUIT		PLACE POWER SUPPLY	
R & R CONCRETE SIDEWALK (SF)		PLACE WALL BOX & RISER	1
R & R CONCRETE PAVEMENT (SF)		PLACE U-GUARD RISER	
OVERHEAD: OVERLASH		OVERHEAD: NEW BUILD	

---

PREPARED BY:

DFT CONTACT: DAVID HAITON 972.670.2113