

ADDISON AIRPORT
TEMPORARY ACCESS ROAD

Oxford

ESSELTE

NO. 753 1/3

10%



TOWN OF

ADDISON

PUBLIC WORKS

To: Paul King

From: Jim Pierce, P.E.

Company: Constructors & Assoc.

Asst. Public Wks. Dir.

Phone: 972/450-2879

FAX #: 214-520-0413

FAX: 972/450-2837

jpierce@ci.addison.tx.us

Date: Oct 1, 2003

16801 Westgrove

P.O.Box 9010

of pages (including cover): 1

Addison, TX 75001-9010

Re: Addison Airport Access Road Project

Original in mail

Per your request

FYI

Call me

Comments: This is to accept your proposal for
the above referenced job as per your letter
of Sept. 30, 2003, and the plans, for the
amount of \$ 13,531.34.

Please consider this your notice to proceed.
The work will be inspected by Dave Wilde.
Send your invoice for the work to
my attention when completed.

Please call if you have any questions

Jim Pierce

cc Steve Chutehan

Dave Wilde

PLANS FOR GRADING AND FENCE RELOCATION

ADDISON AIRPORT TEMPORARY ACCESS ROAD

SHEET NO.	INDEX OF SHEETS
1	COVER SHEET/ LOCATION MAP
2	GENERAL NOTES/ QUANTITIES
3	LAYOUT PLAN/ TYPICAL SECTION

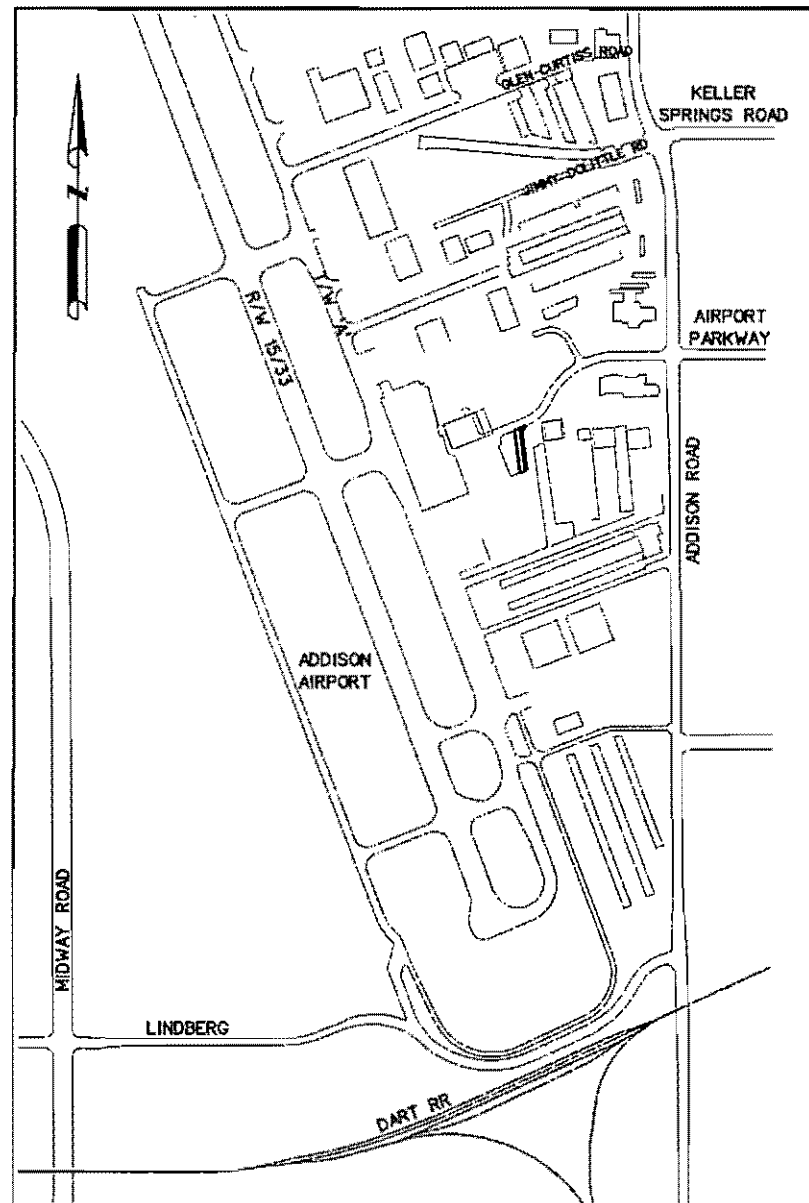
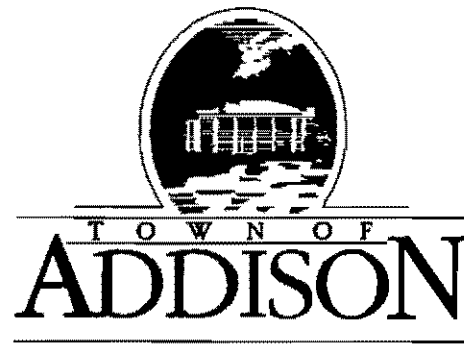

LOCATION MAP
NOT TO SCALE

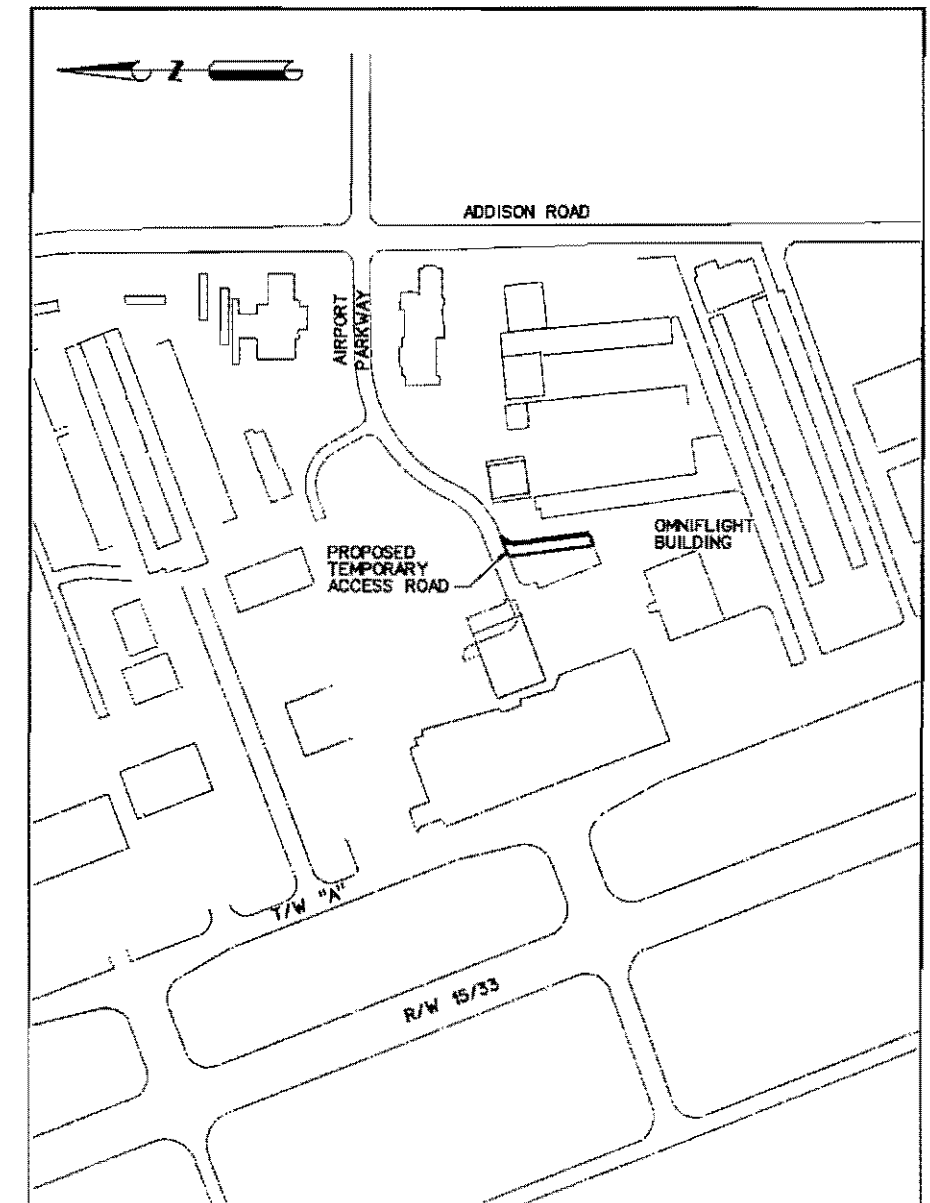

PROJECT MAP
NOT TO SCALE

CONSTRUCTION CONTROL NOTES

I. MAINTENANCE OF VEHICULAR TRAFFIC

A. VEHICULAR TRAFFIC

1. THE CONTRACTOR IS ADVISED THAT AIRPORT RUNWAY 15/33, AND ALL TAXIWAYS WILL BE ACTIVE DURING THIS CONTRACT. THE CONTRACTOR WILL BE EXPECTED TO CONDUCT THE WORK SUCH THAT THE SAFETY OF OPERATIONS IS NOT DIMINISHED AND THAT VEHICULAR FLOW IS MAINTAINED AT ALL TIMES. THE CONTRACTOR IS ADVISED, AND SHALL ACCEPT AS AN IMPORTANT CONSIDERATION OF THE WORK, THAT THE MAINTENANCE OF SAFE AND EFFICIENT ACCESS TO THE AIRPORT VIA THE ROADWAY SYSTEM IS AN INTEGRAL PART OF THE WORK. ALL TRAFFIC MAINTENANCE SHALL BE DONE IN CONFORMANCE TO THE LATEST EDITION OF THE MANUAL OF UNIFORM TRAFFIC CONTROL DEVICES.
2. ALL EXISTING ROADS OR PAVEMENTS USED AS ACCESS/HAUL ROADS SHALL BE MAINTAINED AND IMPROVED AS REQUIRED. THE ROAD OR PAVEMENT CONDITIONS WILL BE INSPECTED JOINTLY BY THE ENGINEER/RPR AND CONTRACTOR PRIOR TO AND AT THE END OF THE PROJECT. THE CONDITION OF THESE ROADS AND PAVEMENTS SHALL BE EQUAL OR BETTER THAN AT THE START OF THE PROJECT AS DETERMINED BY THE ENGINEER/RPR. MECHANICAL BROOMS WILL ALSO BE REQUIRED FOR THESE EXISTING PAVEMENT ACCESS ROADS AT ALL TIMES.

II. WORK WITHIN AIRPORT OPERATIONS AREA (AOA).

A. GENERAL REQUIREMENTS

ALL WORK TO BE PERFORMED WILL BE INSIDE OR ADJACENT TO THE AIRPORT OPERATIONS AREA (AOA). CONSEQUENTLY ALL WORK MUST BE PERFORMED SUCH THAT THE SECURITY OF THE AOA IS MAINTAINED.

THE CONTRACTOR WILL BE REQUIRED TO OBTAIN ALL VEHICLE PASSES AND TEMPORARY PERSONNEL SECURITY BADGES TO SATISFY ALL AIRPORT SECURITY REQUIREMENTS PRIOR TO BEGINNING WORK WITHIN THE AOA.

IN ADDITION, THE CONTRACTOR IS ADVISED THAT CERTAIN RULES AND RESTRICTIONS, AS CONTAINED IN FAA ADVISORY CIRCULAR 150/5370-2D AND AUGMENTED BY THESE PLANS AND SPECIFICATIONS, WILL APPLY TO THE WORK. THE CONTRACTOR SHALL BECOME FAMILIAR WITH ALL REQUIREMENTS APPLICABLE TO AIRPORT CONSTRUCTION AND COOPERATE WITH THE ENGINEER IN MAINTAINING A SAFE CONSTRUCTION SITE WHICH IS COMPATIBLE WITH AIRCRAFT AND AIRPORT OPERATIONS.

THE CONTRACTOR'S ACCESS TO THE JOB SITE AND WITHIN THE AIRCRAFT OPERATIONS AREA (AOA), SHALL BE LIMITED THROUGH THE EXISTING SECURITY GATES. THE CONTRACTOR WILL BE REQUIRED TO MAINTAIN SECURITY AT GATES AND FENCES THROUGHOUT THE DURATION OF THE PROJECT. THE CONTRACTOR WILL BE LIABLE FOR ANY FINES ISSUED BY THE FAA FOR SECURITY (OR OTHER) VIOLATIONS FOR WHICH IT IS CITED. AN ASSESSMENT OF \$1,000 MAY BE ASSESSED FOR EACH AND EVERY OCCURRENCE WHERE THE GATE IS LEFT UNGUARDED AND UNLOCKED.

NO TRENCHES IN OR DIRECTLY ADJACENT TO OPERATIONAL PAVEMENT SHALL REMAIN OPEN OVERNIGHT OR WHEN THE CONTRACTOR FINISHES WORK FOR THE DAY IN THE AREA. TRENCHES NOT BACKFILLED SHALL BE COVERED WITH STEEL PLATES TO ALLOW FOR SAFE PASSAGES BY AIRCRAFT ACROSS THE TRENCH.

THE CONTRACTOR SHALL BE RESPONSIBLE FOR REPAIR OF ANY DAMAGE TO EXISTING FACILITIES NOT DESIGNATED FOR RECONSTRUCTION OR REPLACEMENT AT HIS/HER EXPENSE. DAMAGE TO EXISTING PAVEMENTS DUE TO MOVING OR USAGE OF HEAVY EQUIPMENT OR THE TRANSPORT OF MATERIALS TO OR ON THE SITE SHALL BE REPAIRED TO EQUAL OR BETTER QUALITY BY THE CONTRACTOR AT HIS/HER OWN EXPENSE.

THE CONTRACTOR SHALL BE RESPONSIBLE FOR REPAIR OF ANY DAMAGE TO UNDERGROUND CABLES ENCOUNTERED. NO DIGGING SHALL BE PERFORMED WITHOUT FIRST CONTACTING THE AIRPORT MANAGER. ANY DAMAGE TO FAA CABLE OR OTHER UNDERGROUND CABLING OR FACILITIES SHALL BE REPAIRED IN ACCORDANCE WITH THE APPLICABLE FAA SPECIFICATIONS AND IN A MANNER ACCEPTABLE TO AIRPORT MANAGER, TXDOT AND THE ENGINEER.

CONSTRUCTION WORKERS WILL NOT BE ALLOWED TO ESTABLISH OVERNIGHT RESIDENCE ON THE PREMISES. ALL CONSTRUCTION WORKERS SHALL LEAVE THE CONSTRUCTION SITE AND AIRPORT PROPERTY AT THE END OF THEIR WORK PERIOD.

WORK CANNOT COMMENCE UNTIL:

- A). SUFFICIENT BARRICADES ARE IN PLACE TO CONFINE THE AREA AND CREATE A BARRIER BETWEEN AIRCRAFT AND VEHICLE MOVEMENT AREAS AND THE CONSTRUCTION AREA.
- B). ALL SAFETY EQUIPMENT FOR PERSONNEL AND CONSTRUCTION EQUIPMENT IS IN PLACE AND OPERABLE.
- C). A NOTICE TO PROCEED HAS BEEN ISSUED BY TOWN OF ADDISON TO THE CONTRACTOR.

III. DUST CONTROL

- A. THE CONTRACTOR SHALL PAY PARTICULAR ATTENTION TO THE DUST CONTROL REQUIREMENTS OF THIS CONTRACT. THE OPERATION OF RUNWAYS, TAXIWAYS, AND ASSOCIATED NAVAIDS ARE ESPECIALLY SENSITIVE TO DUST. THE ENGINEER RESERVES THE RIGHT TO STOP CONTRACTOR OPERATIONS, IF NECESSARY TO BRING DUST UNDER CONTROL. THE CONTRACTOR SHALL BE RESPONSIBLE FOR DUST CONTROL WITHIN THE CONSTRUCTION LIMITS AS WELL AS ALONG ANY ROADWAYS USED BY THE EQUIPMENT AND VEHICLES.
- B. WATER TRUCKS SHALL BE MAINTAINED AT ALL TIMES SUCH THAT THE ACCESS ROADS AND CONSTRUCTION AREAS CAN BE WETTED AS NECESSARY. THE CONTRACTOR SHALL BE PREPARED, AT NO EXTRA COST TO THE OWNER, TO USE ADDITIONAL WATER TRUCKS OR OTHER MEANS SHOULD IT BE NECESSARY TO MAINTAIN DUST TO AN ACCEPTABLE LEVEL. ALL WATER TRUCKS SHALL BE SUBSIDIARY TO THE VARIOUS BID ITEMS ON THE PROJECT.

IV. DEMOBILIZATION

CONDITIONS OF THE PROJECT AREA UPON COMPLETION OF THE JOB SHALL BE AS GOOD AS OR BETTER THAN THE CONDITIONS PRIOR TO STARTING WORK, IN ADDITION TO THE WORK ITEMS LISTED.

THE PROJECT AREA SHALL BE FREE OF ANY CONTRACTOR STOCKPILE MATERIALS UPON COMPLETION OF THE JOB UNLESS OTHERWISE DIRECTED BY THE ENGINEER.

UPON COMPLETION OF THE PROJECT, ALL OF THE HAUL ROUTES SHALL BE PROPERLY CLEANED TO PREVENT OBSTRUCTION AND/OR CAUSE INCONVENIENCE TO NORMAL REGULAR TRAFFIC. ALL TEMPORARY HAUL ROUTES SHALL BE REMOVED AND BROUGHT BACK TO ORIGINAL CONDITION OR BETTER.

ANY PROPERTIES BELONGING TO THE AIRPORT SHALL BE RETURNED TO THE AIRPORT OWNER.

PROPER DRAINAGE (NO LOCALIZED PONDING) SHALL BE MAINTAINED, PRIOR TO, DURING AND AFTER MOBILIZATION.

ANY DAMAGE TO THE AIRPORT PROPERTIES DURING DEMOBILIZATION SHALL BE REPAIRED AND PAID FOR AT THE CONTRACTOR'S OWN EXPENSE.

SAFETY REGULATIONS SHALL BE OBSERVED AT ALL TIMES DURING DEMOBILIZATION.

THE COST FOR DEMOBILIZATION SHALL BE CONSIDERED SUBSIDIARY TO OTHER PAY ITEMS.

ITEM	DESCRIPTION	UNIT	QUANTITY
1	MOBILIZATION	L. S.	1
2	CLEARING AND GRUBBING	L. S.	1
3	GRAVEL FOR ROADWAY (CRUSHED STONE)	S. Y.	500
4	REMOVE AND RELOCATE FENCE	L. S.	1

NOTE:

NCTCOG SPECIFICATIONS WILL BE USED FOR ALL BID ITEMS. BID ITEM NO. 3, "GRAVEL FOR ROADWAY", WILL CONFORM TO NCTCOG SPECIFICATION 4.5 AND 2.1.3 WITH THE FOLLOWING EXCEPTION TO SECTION 2.1.3: THE MINIMUM MATERIAL SIZE WILL BE 3/4". MATERIAL SMALLER THAN 3/4" LEADS ITSELF TO PRODUCING DUST, WHICH IS NOT ACCEPTABLE TO AIRPORT OPERATIONS.

HNTB ARCHITECTURE ENGINEERS PLANNERS The HNTB Companies				
TOWN OF ADDISON				
TEMPORARY ACCESS ROAD				
GENERAL NOTES AND QUANTITIES				
TOWN OF ADDISON, TEXAS				
Design J5R	Drawn GFS	DATE	PROJECT NO.	SHEET
Check J0H	Check J5H	SEPTEMBER 2003	38020	2



LEGEND
 // // // FENCE TO BE REMOVED/ RELOCATED
 XXXX RELOCATED FENCE

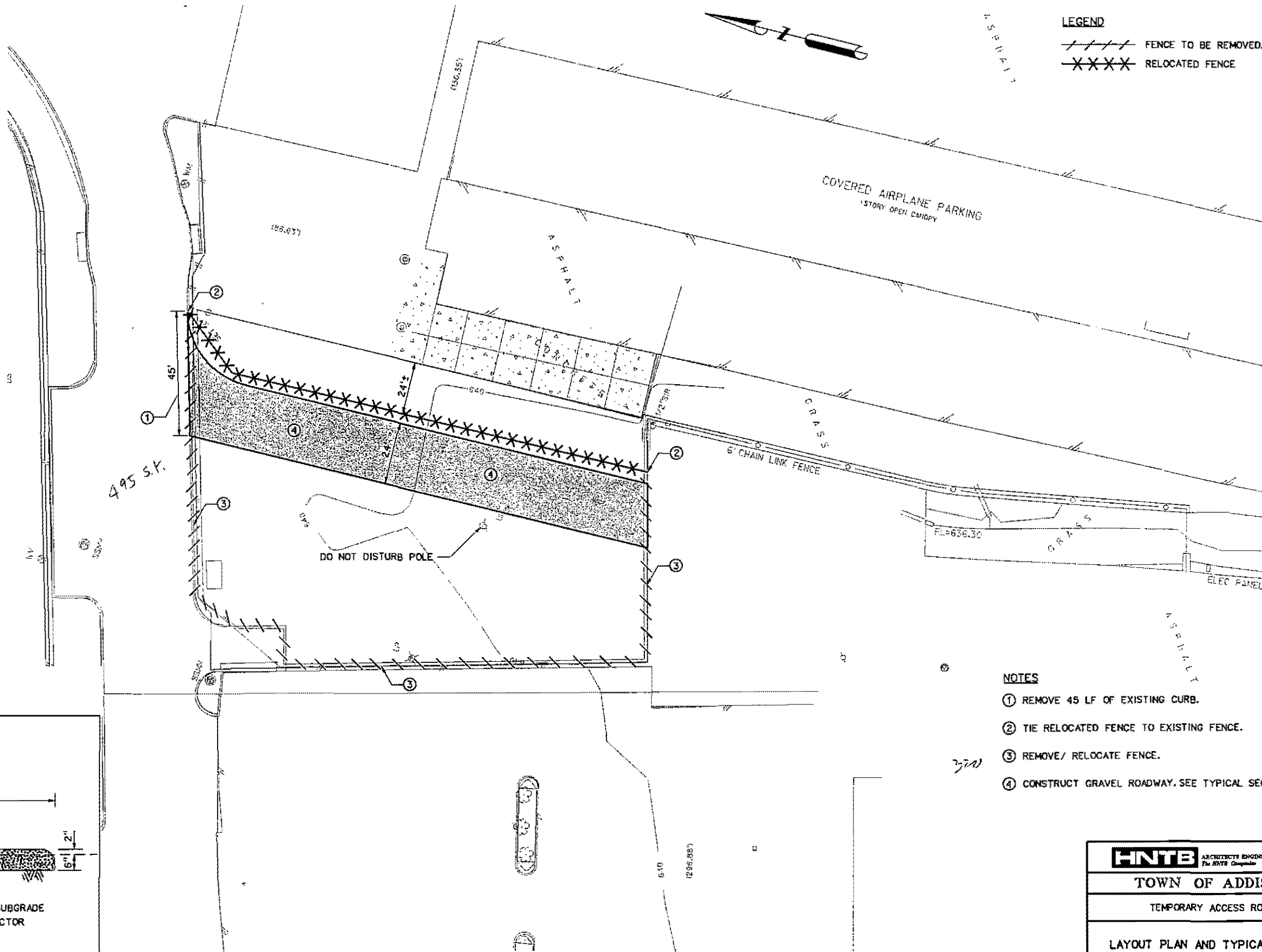

- NOTES**
- ① REMOVE 45 LF OF EXISTING CURB.
 - ② TIE RELOCATED FENCE TO EXISTING FENCE.
 - ③ REMOVE/ RELOCATE FENCE.
 - ④ CONSTRUCT GRAVEL ROADWAY. SEE TYPICAL SECTION.

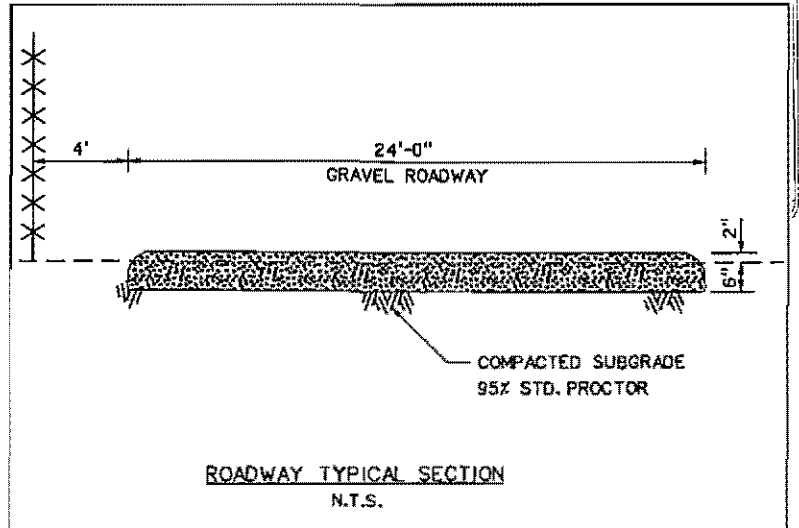

HNTB ARCHITECTS ENGINEERS PLANNERS The HNTB Companies				
TOWN OF ADDISON				
TEMPORARY ACCESS ROAD				
LAYOUT PLAN AND TYPICAL SECTION				
TOWN OF ADDISON, TEXAS				
Design JSN	Drawn GFS	DATE	PROJECT NO.	SHEET
Check JOM	Check JSN	SEPTEMBER 2003	39020	3

22-SEP-2003 07:24
 G:\39020\Cad\Exhib\17a\TempRoadEL TD1.dgn

PLANS FOR GRADING AND FENCE RELOCATION

ADDISON AIRPORT TEMPORARY ACCESS ROAD

SHEET NO.	INDEX OF SHEETS
1	COVER SHEET/ LOCATION MAP
2	GENERAL NOTES/ QUANTITIES
3	LAYOUT PLAN/ TYPICAL SECTION

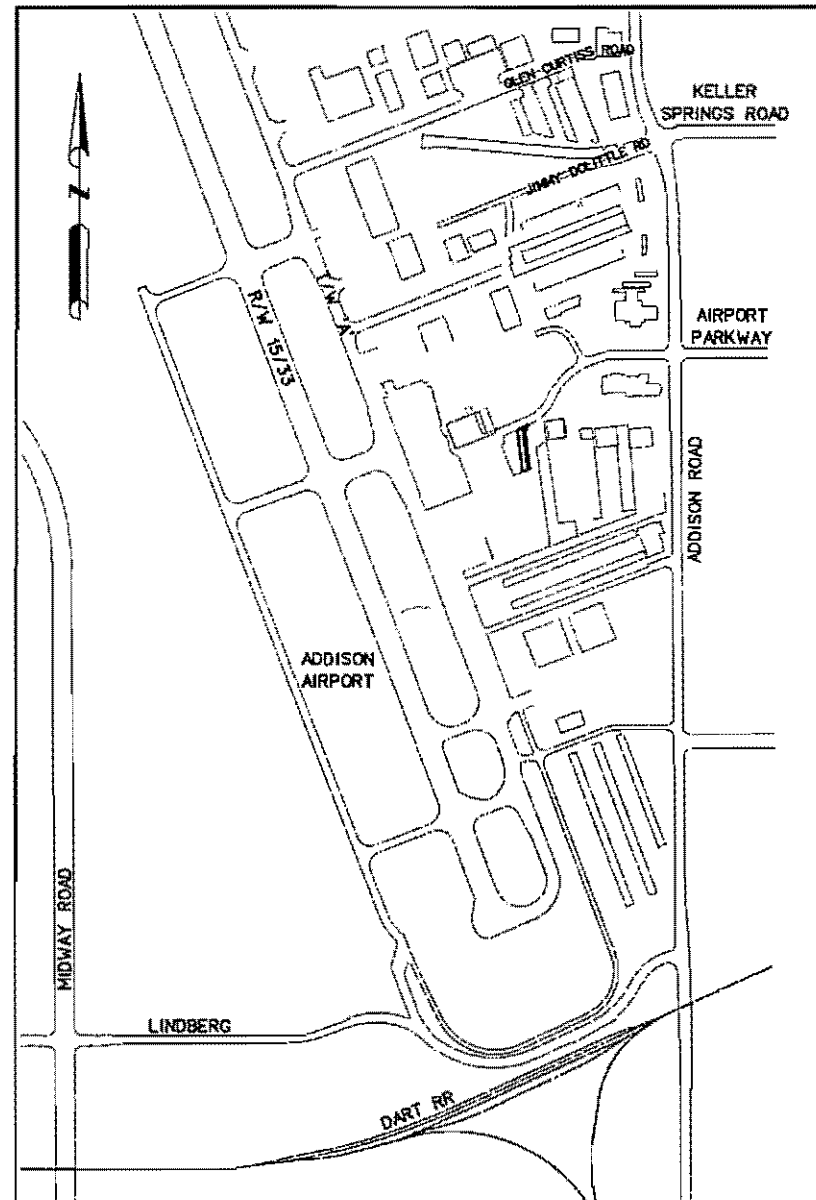
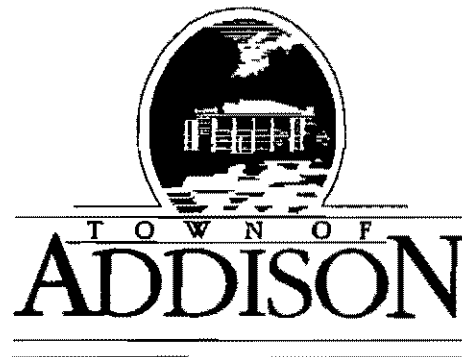

LOCATION MAP
NOT TO SCALE

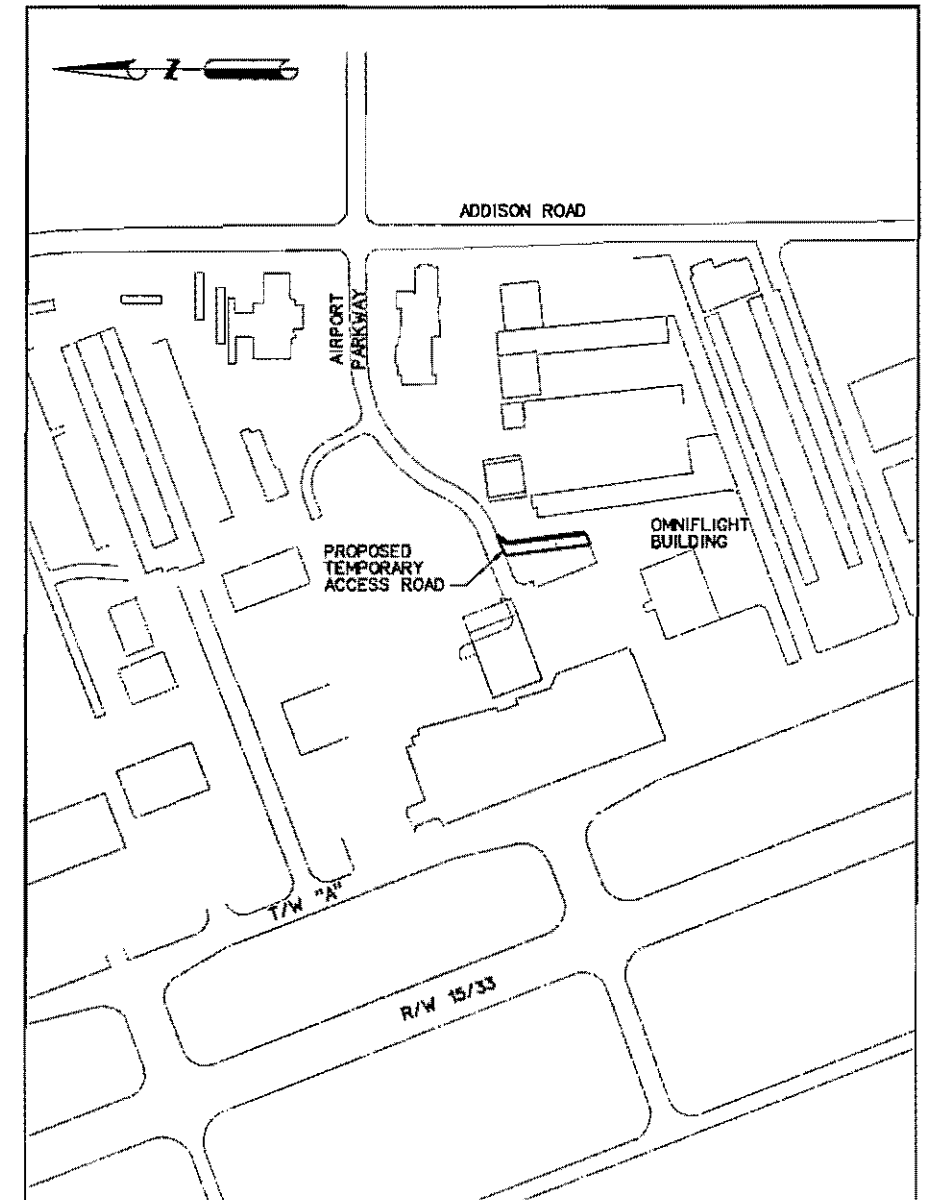

PROJECT MAP
NOT TO SCALE

CONSTRUCTION CONTROL NOTES

I. MAINTENANCE OF VEHICULAR TRAFFIC

A. VEHICULAR TRAFFIC

1. THE CONTRACTOR IS ADVISED THAT AIRPORT RUNWAY 15/33, AND ALL TAXIWAYS WILL BE ACTIVE DURING THIS CONTRACT. THE CONTRACTOR WILL BE EXPECTED TO CONDUCT THE WORK SUCH THAT THE SAFETY OF OPERATIONS IS NOT DIMINISHED AND THAT VEHICULAR FLOW IS MAINTAINED AT ALL TIMES. THE CONTRACTOR IS ADVISED, AND SHALL ACCEPT AS AN IMPORTANT CONSIDERATION OF THE WORK, THAT THE MAINTENANCE OF SAFE AND EFFICIENT ACCESS TO THE AIRPORT VIA THE ROADWAY SYSTEM IS AN INTEGRAL PART OF THE WORK. ALL TRAFFIC MAINTENANCE SHALL BE DONE IN CONFORMANCE TO THE LATEST EDITION OF THE MANUAL OF UNIFORM TRAFFIC CONTROL DEVICES.
2. ALL EXISTING ROADS OR PAVEMENTS USED AS ACCESS/HAUL ROADS SHALL BE MAINTAINED AND IMPROVED AS REQUIRED. THE ROAD OR PAVEMENT CONDITIONS WILL BE INSPECTED JOINTLY BY THE ENGINEER/RPR AND CONTRACTOR PRIOR TO AND AT THE END OF THE PROJECT. THE CONDITION OF THESE ROADS AND PAVEMENTS SHALL BE EQUAL OR BETTER THAN AT THE START OF THE PROJECT AS DETERMINED BY THE ENGINEER/RPR. MECHANICAL BROOMS WILL ALSO BE REQUIRED FOR THESE EXISTING PAVEMENT ACCESS ROADS AT ALL TIMES.

II. WORK WITHIN AIRPORT OPERATIONS AREA (AOA)

A. GENERAL REQUIREMENTS

ALL WORK TO BE PERFORMED WILL BE INSIDE OR ADJACENT TO THE AIRPORT OPERATIONS AREA (AOA). CONSEQUENTLY ALL WORK MUST BE PERFORMED SUCH THAT THE SECURITY OF THE AOA IS MAINTAINED.

THE CONTRACTOR WILL BE REQUIRED TO OBTAIN ALL VEHICLE PASSES AND TEMPORARY PERSONNEL SECURITY BADGES TO SATISFY ALL AIRPORT SECURITY REQUIREMENTS PRIOR TO BEGINNING WORK WITHIN THE AOA.

IN ADDITION, THE CONTRACTOR IS ADVISED THAT CERTAIN RULES AND RESTRICTIONS, AS CONTAINED IN FAA ADVISORY CIRCULAR 150/5370-2D AND AUGMENTED BY THESE PLANS AND SPECIFICATIONS, WILL APPLY TO THE WORK. THE CONTRACTOR SHALL BECOME FAMILIAR WITH ALL REQUIREMENTS APPLICABLE TO AIRPORT CONSTRUCTION AND COOPERATE WITH THE ENGINEER IN MAINTAINING A SAFE CONSTRUCTION SITE WHICH IS COMPATIBLE WITH AIRCRAFT AND AIRPORT OPERATIONS.

THE CONTRACTOR'S ACCESS TO THE JOB SITE AND WITHIN THE AIRCRAFT OPERATIONS AREA (AOA), SHALL BE LIMITED THROUGH THE EXISTING SECURITY GATES. THE CONTRACTOR WILL BE REQUIRED TO MAINTAIN SECURITY AT GATES AND FENCES THROUGHOUT THE DURATION OF THE PROJECT. THE CONTRACTOR WILL BE LIABLE FOR ANY FINES ISSUED BY THE FAA FOR SECURITY (OR OTHER) VIOLATIONS FOR WHICH IT IS CITED. AN ASSESSMENT OF \$1,000 MAY BE ASSESSED FOR EACH AND EVERY OCCURRENCE WHERE THE GATE IS LEFT UNGUARDED AND UNLOCKED.

NO TRENCHES IN OR DIRECTLY ADJACENT TO OPERATIONAL PAVEMENT SHALL REMAIN OPEN OVERNIGHT OR WHEN THE CONTRACTOR FINISHES WORK FOR THE DAY IN THE AREA. TRENCHES NOT BACKFILLED SHALL BE COVERED WITH STEEL PLATES TO ALLOW FOR SAFE PASSAGES BY AIRCRAFT ACROSS THE TRENCH.

THE CONTRACTOR SHALL BE RESPONSIBLE FOR REPAIR OF ANY DAMAGE TO EXISTING FACILITIES NOT DESIGNATED FOR RECONSTRUCTION OR REPLACEMENT AT HIS/HER EXPENSE DUE TO MOVING OR USAGE OF HEAVY EQUIPMENT OR THE TRANSPORT OF MATERIALS TO OR ON THE SITE SHALL BE REPAIRED TO EQUAL OR BETTER QUALITY BY THE CONTRACTOR AT HIS/HER OWN EXPENSE.

THE CONTRACTOR SHALL BE RESPONSIBLE FOR REPAIR OF ANY DAMAGE TO UNDERGROUND CABLES ENCOUNTERED. NO DIGGING SHALL BE PERFORMED WITHOUT FIRST CONTACTING THE AIRPORT MANAGER. ANY DAMAGE TO FAA CABLE OR OTHER UNDERGROUND CABLING OR FACILITIES SHALL BE REPAIRED IN ACCORDANCE WITH THE APPLICABLE FAA SPECIFICATIONS AND IN A MANNER ACCEPTABLE TO AIRPORT MANAGER, TXDOT AND THE ENGINEER.

CONSTRUCTION WORKERS WILL NOT BE ALLOWED TO ESTABLISH OVERNIGHT RESIDENCE ON THE PREMISES. ALL CONSTRUCTION WORKERS SHALL LEAVE THE CONSTRUCTION SITE AND AIRPORT PROPERTY AT THE END OF THEIR WORK PERIOD.

WORK CANNOT COMMENCE UNTIL:

- A). SUFFICIENT BARRICADES ARE IN PLACE TO CONFINE THE AREA AND CREATE A BARRIER BETWEEN AIRCRAFT AND VEHICLE MOVEMENT AREAS AND THE CONSTRUCTION AREA.
- B). ALL SAFETY EQUIPMENT FOR PERSONNEL AND CONSTRUCTION EQUIPMENT IS IN PLACE AND OPERABLE.
- C). A NOTICE TO PROCEED HAS BEEN ISSUED BY TOWN OF ADDISON TO THE CONTRACTOR.

III. DUST CONTROL

- A. THE CONTRACTOR SHALL PAY PARTICULAR ATTENTION TO THE DUST CONTROL REQUIREMENTS OF THIS CONTRACT. THE OPERATION OF RUNWAYS, TAXIWAYS, AND ASSOCIATED NAVAIDS ARE ESPECIALLY SENSITIVE TO DUST. THE ENGINEER RESERVES THE RIGHT TO STOP CONTRACTOR OPERATIONS, IF NECESSARY TO BRING DUST UNDER CONTROL. THE CONTRACTOR SHALL BE RESPONSIBLE FOR DUST CONTROL WITHIN THE CONSTRUCTION LIMITS AS WELL AS ALONG ANY ROADWAYS USED BY THE EQUIPMENT AND VEHICLES.
- B. WATER TRUCKS SHALL BE MAINTAINED AT ALL TIMES SUCH THAT THE ACCESS ROADS AND CONSTRUCTION AREAS CAN BE WETTED AS NECESSARY. THE CONTRACTOR SHALL BE PREPARED, AT NO EXTRA COST TO THE OWNER, TO USE ADDITIONAL WATER TRUCKS OR OTHER MEANS SHOULD IT BE NECESSARY TO MAINTAIN DUST TO AN ACCEPTABLE LEVEL. ALL WATER TRUCKS SHALL BE SUBSIDIARY TO THE VARIOUS BID ITEMS ON THE PROJECT.

IV. DEMOBILIZATION

CONDITIONS OF THE PROJECT AREA UPON COMPLETION OF THE JOB SHALL BE AS GOOD AS OR BETTER THAN THE CONDITIONS PRIOR TO STARTING WORK, IN ADDITION TO THE WORK ITEMS LISTED.

THE PROJECT AREA SHALL BE FREE OF ANY CONTRACTOR STOCKPILE MATERIALS UPON COMPLETION OF THE JOB UNLESS OTHERWISE DIRECTED BY THE ENGINEER.

UPON COMPLETION OF THE PROJECT, ALL OF THE HAUL ROUTES SHALL BE PROPERLY CLEANED TO PREVENT OBSTRUCTION AND/OR CAUSE INCONVENIENCE TO NORMAL REGULAR TRAFFIC. ALL TEMPORARY HAUL ROUTES SHALL BE REMOVED AND BROUGHT BACK TO ORIGINAL CONDITION OR BETTER.

ANY PROPERTIES BELONGING TO THE AIRPORT SHALL BE RETURNED TO THE AIRPORT OWNER.

PROPER DRAINAGE (NO LOCALIZED PONDING) SHALL BE MAINTAINED, PRIOR TO, DURING AND AFTER MOBILIZATION.

ANY DAMAGE TO THE AIRPORT PROPERTIES DURING DEMOBILIZATION SHALL BE REPAIRED AND PAID FOR AT THE CONTRACTOR'S OWN EXPENSE.

SAFETY REGULATIONS SHALL BE OBSERVED AT ALL TIMES DURING DEMOBILIZATION.

THE COST FOR DEMOBILIZATION SHALL BE CONSIDERED SUBSIDIARY TO OTHER PAY ITEMS.

ITEM	DESCRIPTION	UNIT	QUANTITY
1	MOBILIZATION	L. S.	1
2	CLEARING AND GRUBBING	L. S.	1
3	GRAVEL FOR ROADWAY (CRUSHED STONE)	S. Y.	500
4	REMOVE AND RELOCATE FENCE	L. S.	1

NOTE:
NCTCOG SPECIFICATIONS WILL BE USED FOR ALL BID ITEMS. BID ITEM NO. 3, "GRAVEL FOR ROADWAY", WILL CONFORM TO NCTCOG SPECIFICATION 4.5 AND 2.1.3 WITH THE FOLLOWING EXCEPTION TO SECTION 2.1.3: THE MINIMUM MATERIAL SIZE WILL BE 3/4". MATERIAL SMALLER THAN 3/4" TENDS ITSELF TO PRODUCING DUST, WHICH IS NOT ACCEPTABLE TO AIRPORT OPERATIONS.

HNTB ARCHITECTS ENGINEERS PLANNERS <small>The HNTB Companies</small>				
TOWN OF ADDISON				
TEMPORARY ACCESS ROAD				
GENERAL NOTES AND QUANTITIES				
TOWN OF ADDISON, TEXAS				
Design JSN	Drawn GFS	DATE	PROJECT NO.	SHEET
Check JKH	Check JSN	SEPTEMBER 2003	39020	2

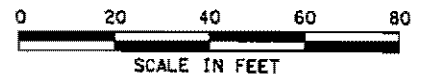

LEGEND
 - - - - - FENCE TO BE REMOVED/ RELOCATED
 - X X X X - RELOCATED FENCE

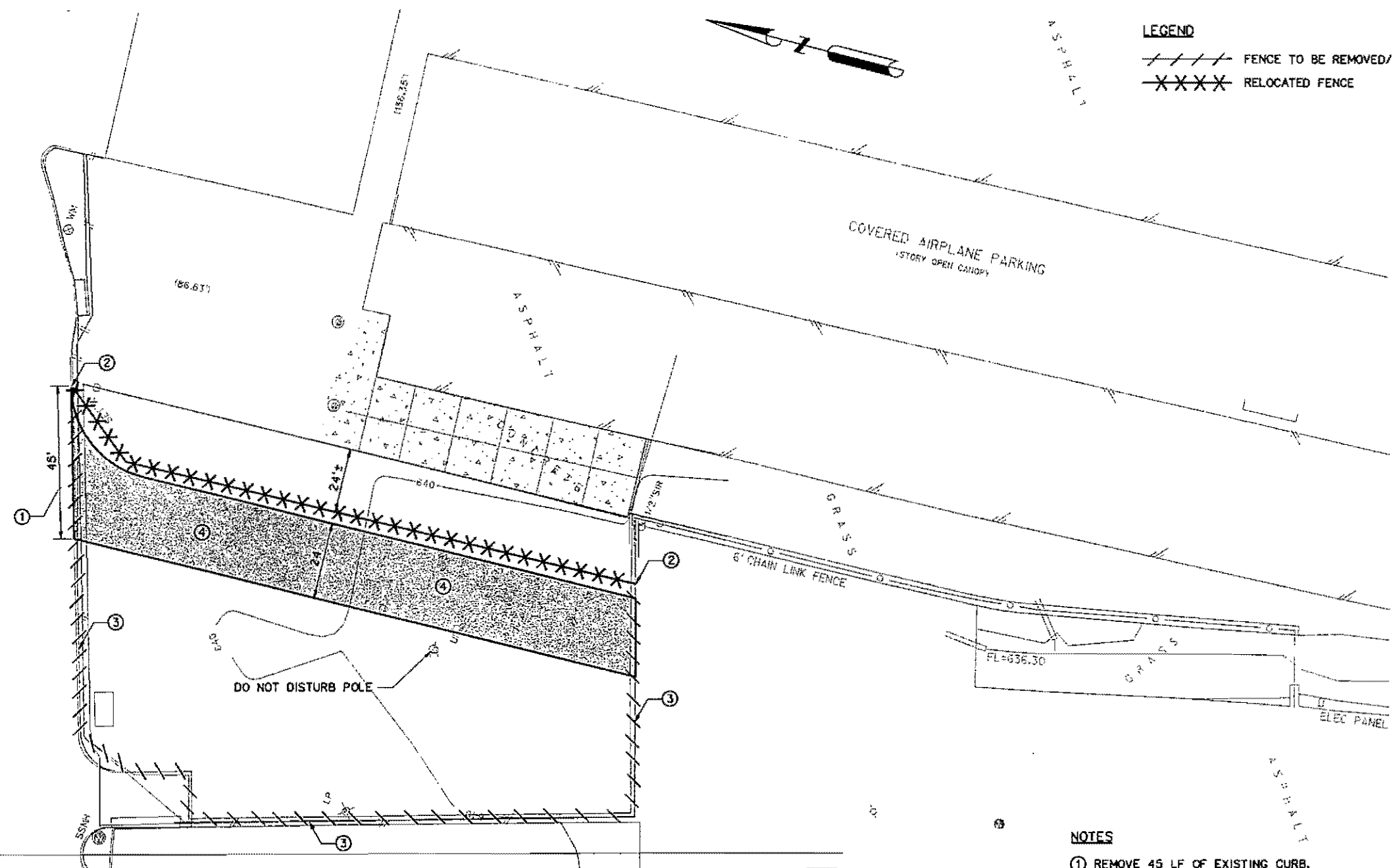

- NOTES**
- ① REMOVE 45 LF OF EXISTING CURB.
 - ② TIE RELOCATED FENCE TO EXISTING FENCE.
 - ③ REMOVE/ RELOCATE FENCE.
 - ④ CONSTRUCT GRAVEL ROADWAY. SEE TYPICAL SECTION.

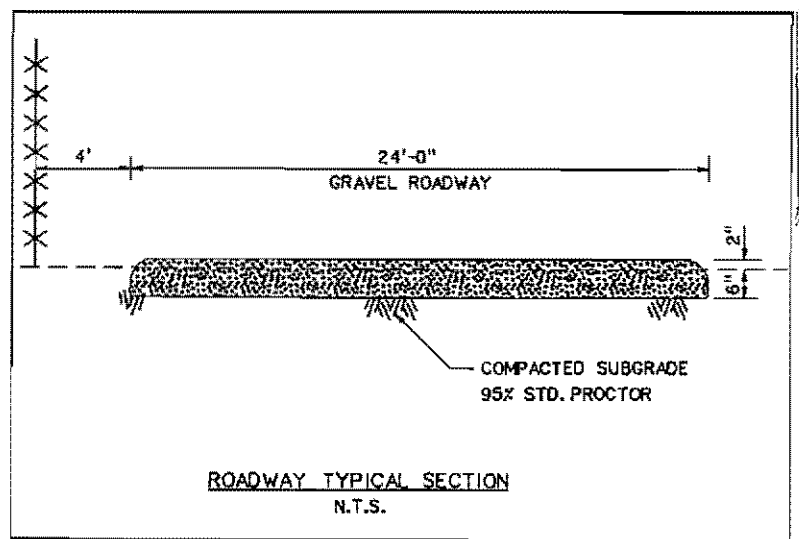

22-SEP-2003 07:24
 G:\39020\Cad\Exhibits\TempRoadEL T01.dgn

HNTB ARCHITECTS ENGINEERS PLANNERS <i>The HNTB Companies</i>				
TOWN OF ADDISON				
TEMPORARY ACCESS ROAD				
LAYOUT PLAN AND TYPICAL SECTION				
TOWN OF ADDISON, TEXAS				
Design JSN	Drawn GFS	DATE	PROJECT NO.	SHEET
Check JCH	Check JSH	SEPTEMBER 2003	39020	3

TOWN OF
ADDISON

PUBLIC WORKS

To: Paul King
Company: Constructors & Assoc.
FAX #: 214-520-0413

From: **Jim Pierce, P.E.**
Asst. Public Wks. Dir.
Phone: 972/450-2879
FAX: 972/450-2837
jpierce@ci.addison.tx.us

Date: Oct 1, 2003

16801 Westgrove
P.O.Box 9010
Addison, TX 75001-9010

of pages (including cover): 1

Re: Addison Airport Access Road Project

Original in mail Per your request FYI Call me

Comments: This is to accept your proposal for
the above referenced job as per your letter
of Sept. 30, 2003, and the plans, for the
amount of \$ 13,531.34.

Please consider this your notice to proceed.

The work will be inspected by Dave Wilde.

Send your invoice for the work to
my attention when completed.

Please call if you have any questions

Steve - please take over

this job for me. Work will start "immediately".

Jim



CONSTRUCTORS

National September 30, 2003

12-623-98210-00000

Arlington, VA

Jim Pierce
Assistant City Manager
Town of Addison
16801 Westgrove

Austin, TX

Boston, MA

Addison, Texas 75001
Fax 972-450-2837

Dallas, TX

Re: Addison Airport
Temporary Access Road
Addison, Tx

Houston, TX

Lyndhurst, NJ

Dear Mr. Pierce:

Miami, FL

We are pleased to submit our proposal for the Addison Airport Access Road Project.
Our proposal is based on plans dated September 2003

New York, NY

We look forward to working with you and your staff toward the successful completion
of this project. If you should have any questions, please feel free to call. Thank you for
your time and consideration.

San Antonio, TX

Stamford, CT

Sincerely,
CONSTRUCTORS & ASSOCIATES, INC.

International

Paul King
Senior Estimator

Dublin, Ireland

Hong Kong, China

London, England

Attachments

Madrid, Spain

Milan, Italy

Paris, France

Constructors & Associates, Inc.
3333 Welborn Street • Suite 200 • Dallas, TX 75219-5104
Tel: 214.520.3359 • Fax: 214.520.0413



CONSTRUCTORS

3333 Welborn, Suite 200
 Dallas, Tx 75219
 214-520-3353

Addison Airport Temporary Access Road

<u>Item</u>	<u>Qty</u>	<u>Unit</u>	<u>Description</u> <u>Written Unit Price</u>	<u>Numeric</u> <u>Unit Price</u>	<u>Total</u> <u>Price</u>
1.	1	LS	Mobilization One Thousand Five Hundred Eight and Sixty One DOLLARS cents	\$1,508.61	\$ 1,508.61
2.	1	LS	Clear & Grub Two Thousand Two Hundred Ninety Five and Twenty Six DOLLARS cents	\$2,295.26	\$ 2,295.26
3.	500	SY	Gravel for Temporary Roadway Eight and Fifty Five DOLLARS cents	\$8.56	\$ 4,277.53
4.	1	LS	Remove & Relocate Fence Five Thousand Four Hundred Forty Nine and Ninety Three DOLLARS cents	\$5,449.94	\$ 5,449.94

Total Base Bid	\$ 13,531.34
-----------------------	---------------------

CLARIFICATIONS & QUALIFICATIONS
For: Addison Airport – Temporary Access Road Project

1. The following items are excluded:
 - Architectural or engineering fees
 - Contingencies and / or cash allowances
 - Payment and performance bonds
 - Builders Risk Insurance
 - Hazardous material abatement work
 - Signage
 - Removal of the temporary Road