

Dallas North Tollway

Signage & pavement - 1996

— ADDISON RD. / EXCEL PKWY.  
INTERSECTION IMPROVEMENTS —

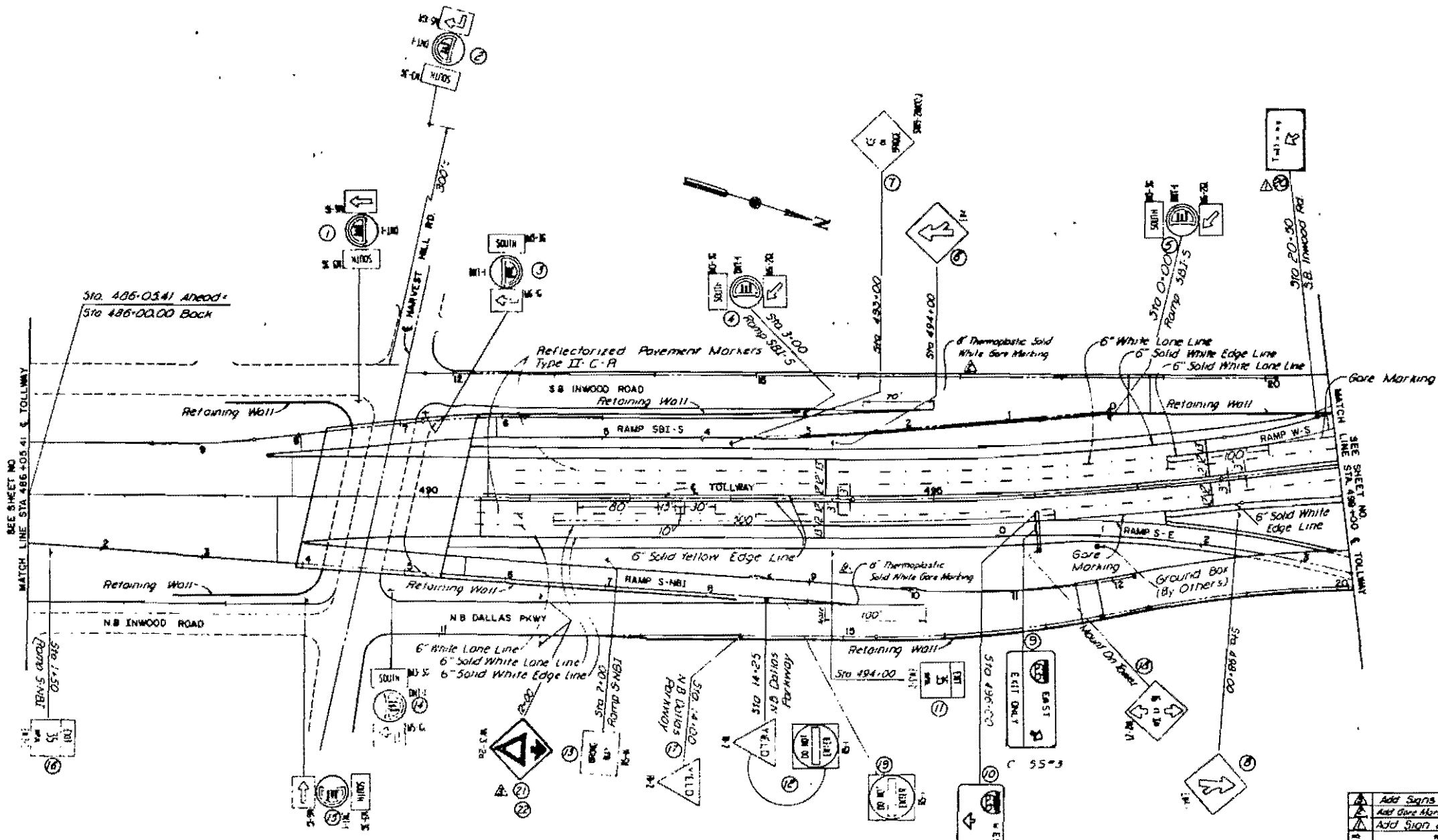

General Notes:  
 For Striping Details Not Shown,  
 See Sheet Nos. 751-76.  
 The Actual Minimum Vertical  
 Clearance Shall be Verified By  
 The Contractor and Approved By  
 The Engineer Prior to Ordering  
 Clearance Signs (W12-27)

▲	Add Signs 21 and 22	Rev	4-10-87
▲	Add Gore Marking Along SBI-S & S-NBI Ramps	Rev	10-27-86
▲	Add Sign 20	Rev	7-29-86
NO	REVISION	BY	DATE

TEXAS TURNPIKE AUTHORITY			
DALLAS NORTH TOLLWAY			
SIGNING AND PAVEMENT MARKING LAYOUT			
STA 486+05.41 TO STA 493+00			
<b>HNTB</b>			
SECTION I-VIII			
DESIGNER RAM	DATE 1-86	CHECKER JMP	DATE 1-86
DRAWN GAL	DATE 3-86	SCALE 1" = 30'	
CONTRACT NO. DNT-121 SHEET 21 OF 76			

For Striping Details Not Shown See Sheet Nos. 75 And 76.  
 For Details Of Roadway Bridge Mounted Signs See Sheet Nos. 71, 72 And 72A.

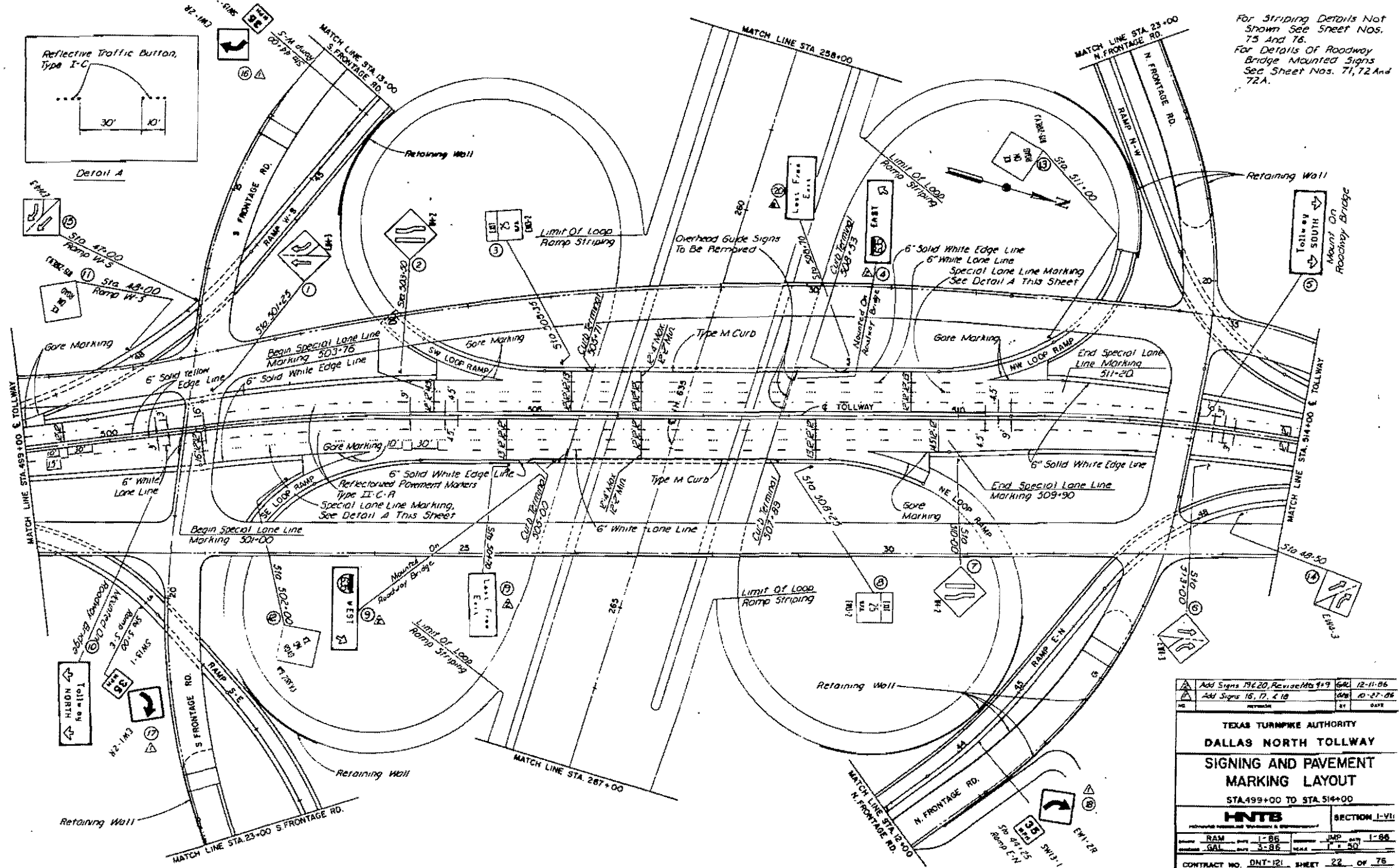
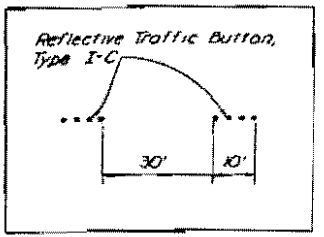

ADD SIGN 136-20, REVISIONS #1-9	DATE	12-11-86
ADD SIGN 16, 17, 4-18	DATE	10-27-86
TEXAS TURNPIKE AUTHORITY <b>DALLAS NORTH TOLLWAY</b> <b>SIGNING AND PAVEMENT MARKING LAYOUT</b> STA. 499+00 TO STA. 514+00 <b>HNTB</b> SECTION I-VII CONTRACT NO. DNT-121 SHEET 22 OF 76		

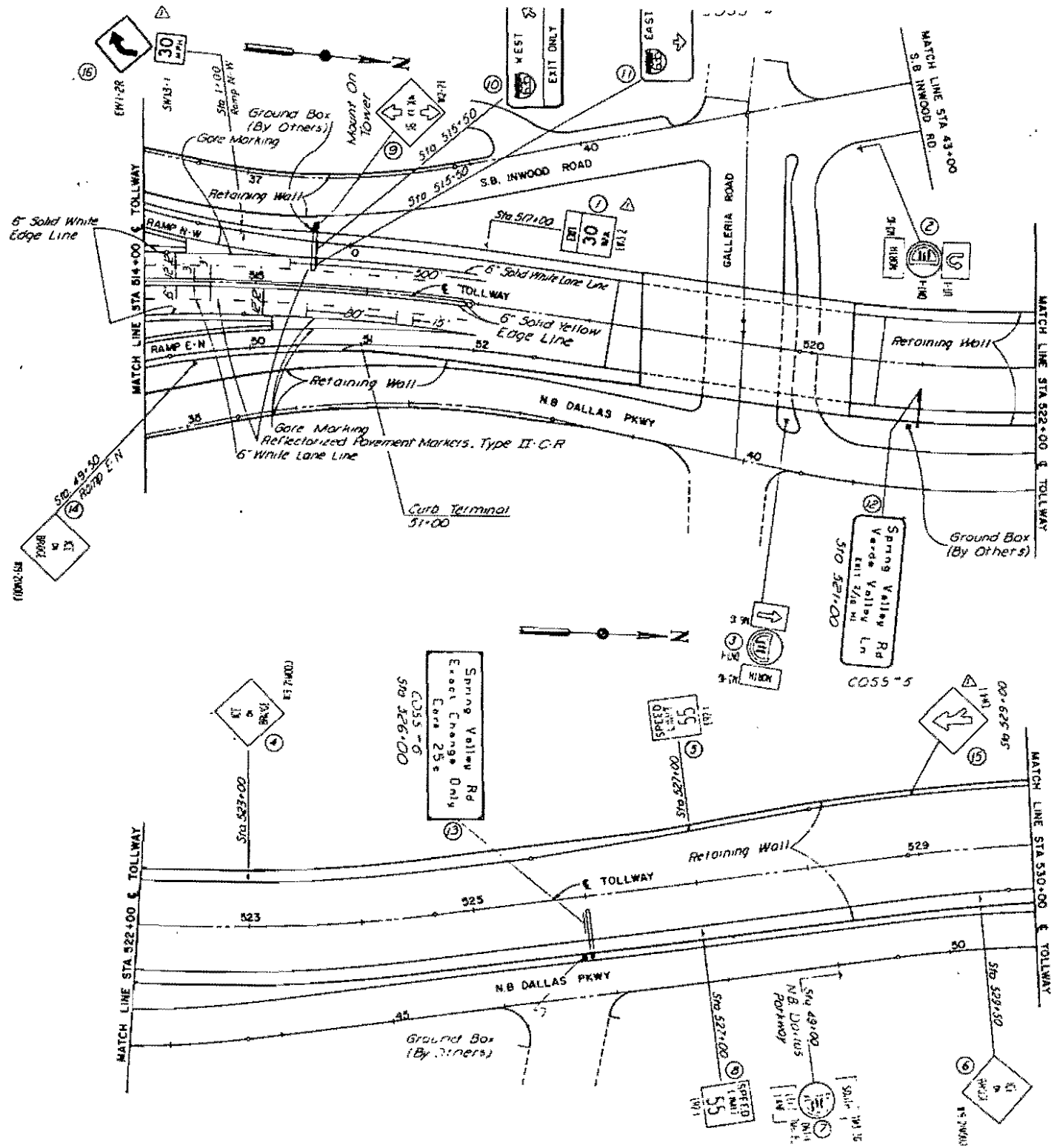

General Notes:  
 For Striping Details Not Shown  
 See Sheet Nos. 75 And 76.  
 The Actual Minimum Vertical  
 Clearance Shall Be Verified  
 By The Contractor And Approved  
 By The Engineer Prior To Ordering  
 Clearance Signs (W12-2T)

Add Signs 15 & 16, Reverse Sign 7, 500, 10-17, 25	
NO.	SECTION
TEXAS TURNPIKE AUTHORITY DALLAS NORTH TOLLWAY	
SIGNING AND PAVEMENT MARKING LAYOUT	
STA. 514+00 TO STA. 530+00	
<b>HNTB</b>	
SECTION L-1	
DESIGNED BY: RAM	DATE: 1-86
DRAWN BY: GAL	DATE: 3-86
CHECKED BY: JMP	DATE: 1-86
SCALE: 1" = 50'	SECTION: L-1
CONTRACT NO. DNT-121 SHEET 25 OF 75	

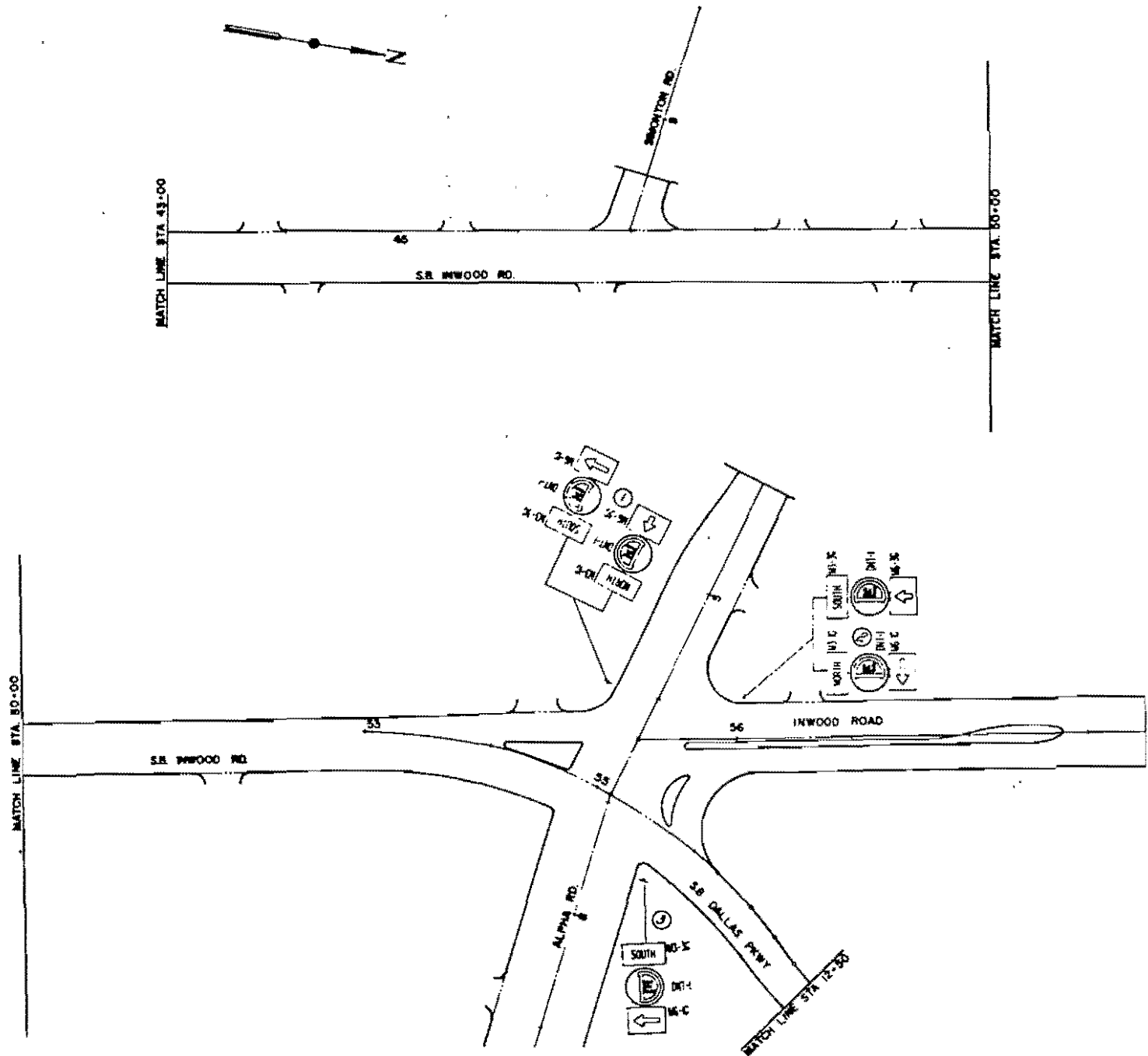

NO.	REVISION	BY	DATE
TEXAS TURNPIKE AUTHORITY DALLAS NORTH TOLLWAY SIGNING AND PAVEMENT MARKING LAYOUT S.B. INWOOD RD STA. 43+00 TO STA 59+50			
<b>HNTB</b>			SECTION 1-VIII
DESIGNED BY	RAM	DATE	1-86
CHECKED BY	JMP	DATE	1-86
APPROVED BY	GAL	DATE	3-86
SCALE	1" = 20'		
CONTRACT NO.	DNT-121	SHEET	2E OF 7E

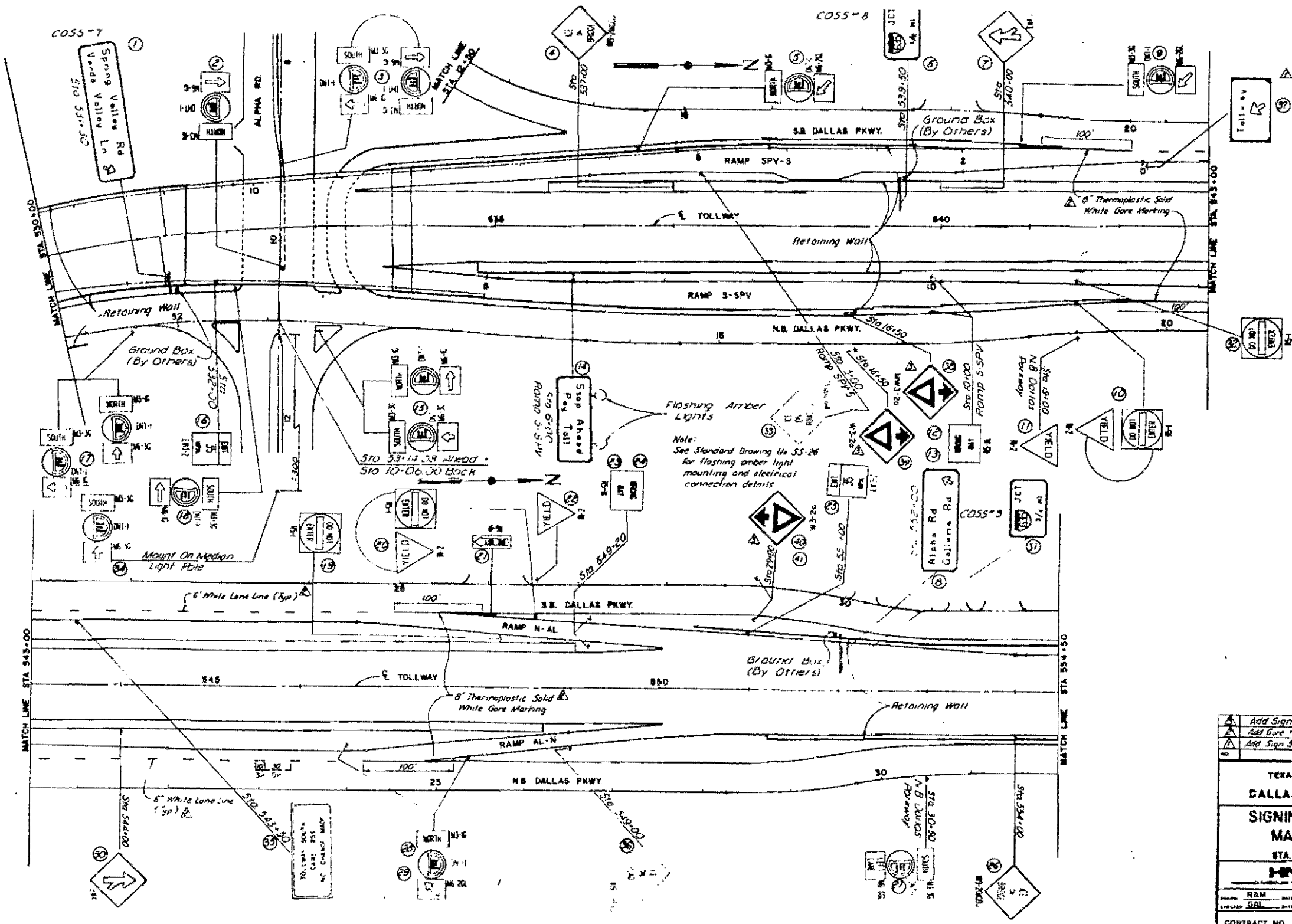

Flashing Amber Lights  
 Note: See Standard Drawing No. 55-26 for flashing amber light mounting and electrical connection details.

▲	Add Signs 38, 59, 40, 41	Rev	4-10-87
▲	Add Gore + Cone Marking	GRD	10-27-86
▲	Add Sign 37	GRD	10-10-86
NO	REVISION	BY	DATE

TEXAS TURNPIKE AUTHORITY  
 DALLAS NORTH TOLLWAY  
 SIGNING AND PAVEMENT MARKING LAYOUT  
 STA. 530+00 TO STA. 554+50

**HNTB** SECTION 1-1111

DESIGNED BY	RAM	DATE	1-86	CHECKED BY	JMP	DATE	1-86
APPROVED BY	GAL	DATE	3-86	SCALE	1" = 50'		

CONTRACT NO. DNT-121 SHEET 27 OF 76

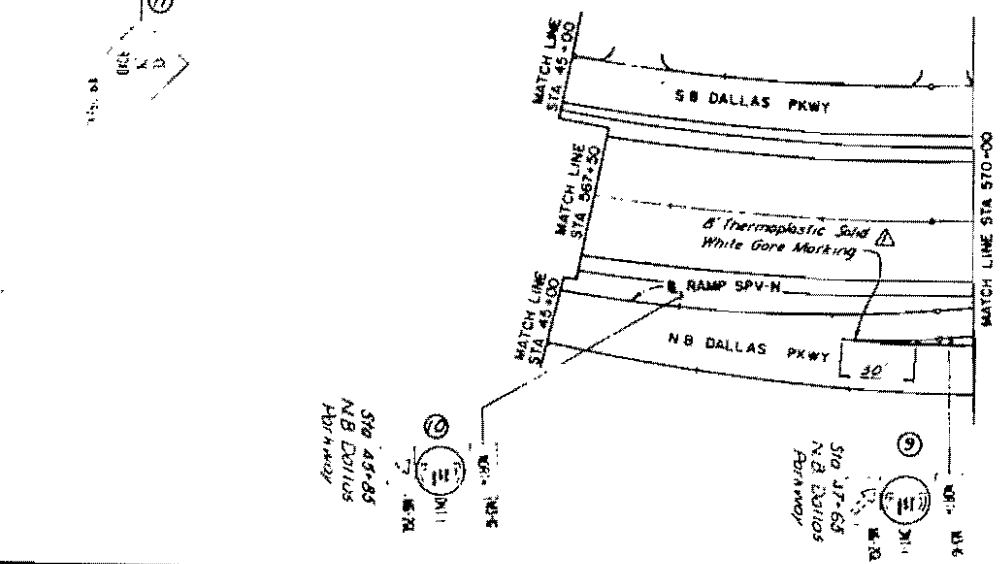
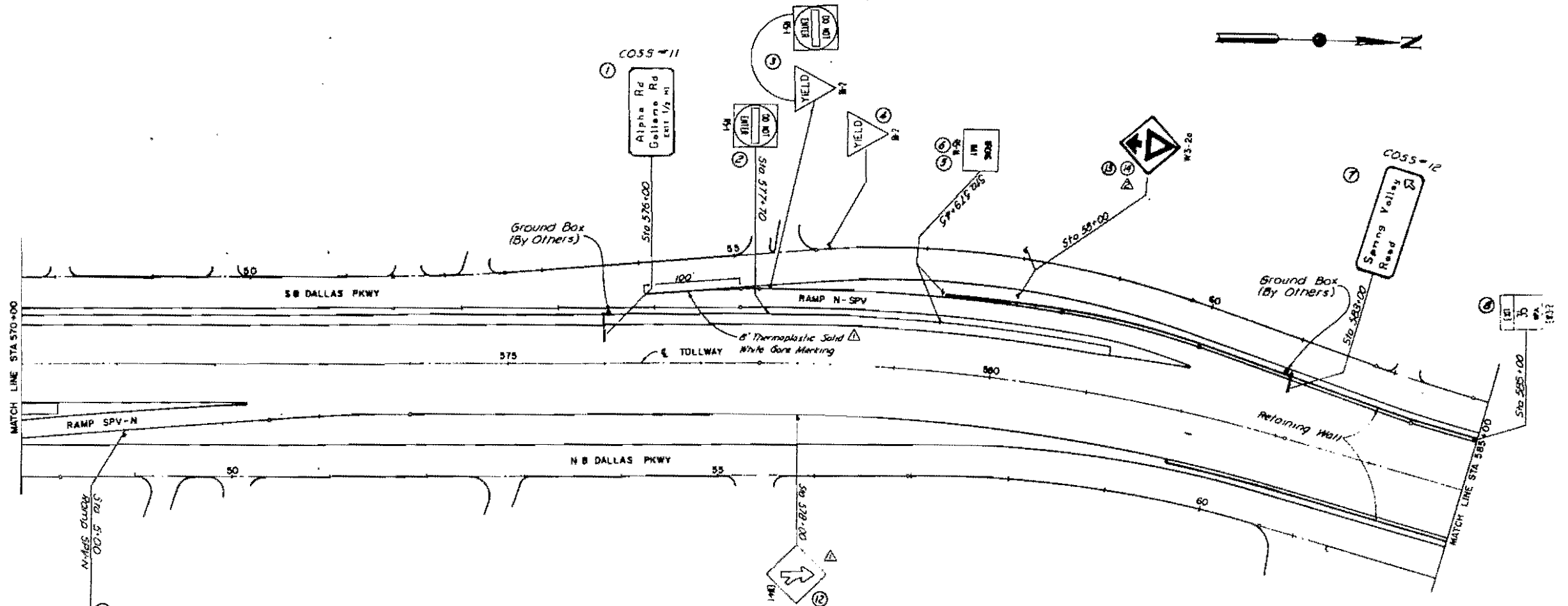

▲	Add Signs 13 L 14	Rev	4-10-87
▲	Add Gore Marking, C Sign 12	Sta	46-28-00
NO	NO SIGN	BT	DATE
TEXAS TURNPIKE AUTHORITY			
DALLAS NORTH TOLLWAY			
SIGNING AND PAVEMENT MARKING LAYOUT			
STA. 567+50 TO STA. 585+00			
<b>HNTB</b>			SECTION I-VIII
<small>HOUGHTON MIFFLIN &amp; COMPANY</small>			
RAM	1-86	JMP	1-86
GAL	5-86	DATE	1-86
CONTRACT NO. OMT-121 SHEET 29 OF 76			



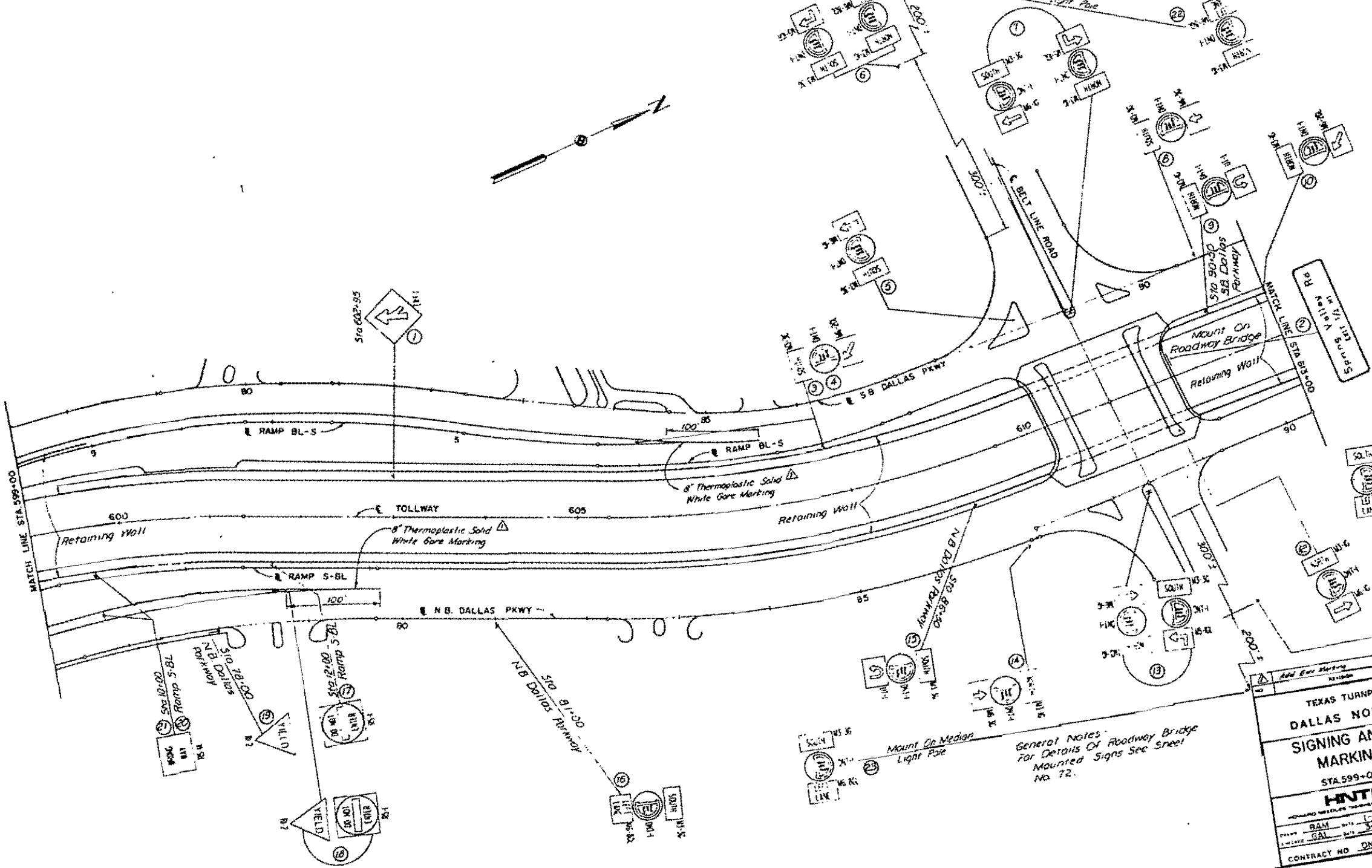
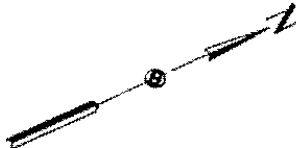

General Notes:  
 For Details Of Roadway Bridge  
 Mounted Signs See Sheet  
 No. 72.

TEXAS TURNPIKE AUTHORITY  
 DALLAS NORTH TOLLWAY  
 SIGNING AND PAVEMENT  
 MARKING LAYOUT  
 STA 599+00 TO STA. 613+00

**HNTB**

DESIGNED BY	1-86	DRAWN BY	JMP
CHECKED BY	3-86	SCALE	1" = 30'

CONTRACT NO. DNT-121, SHEET 31 OF 31

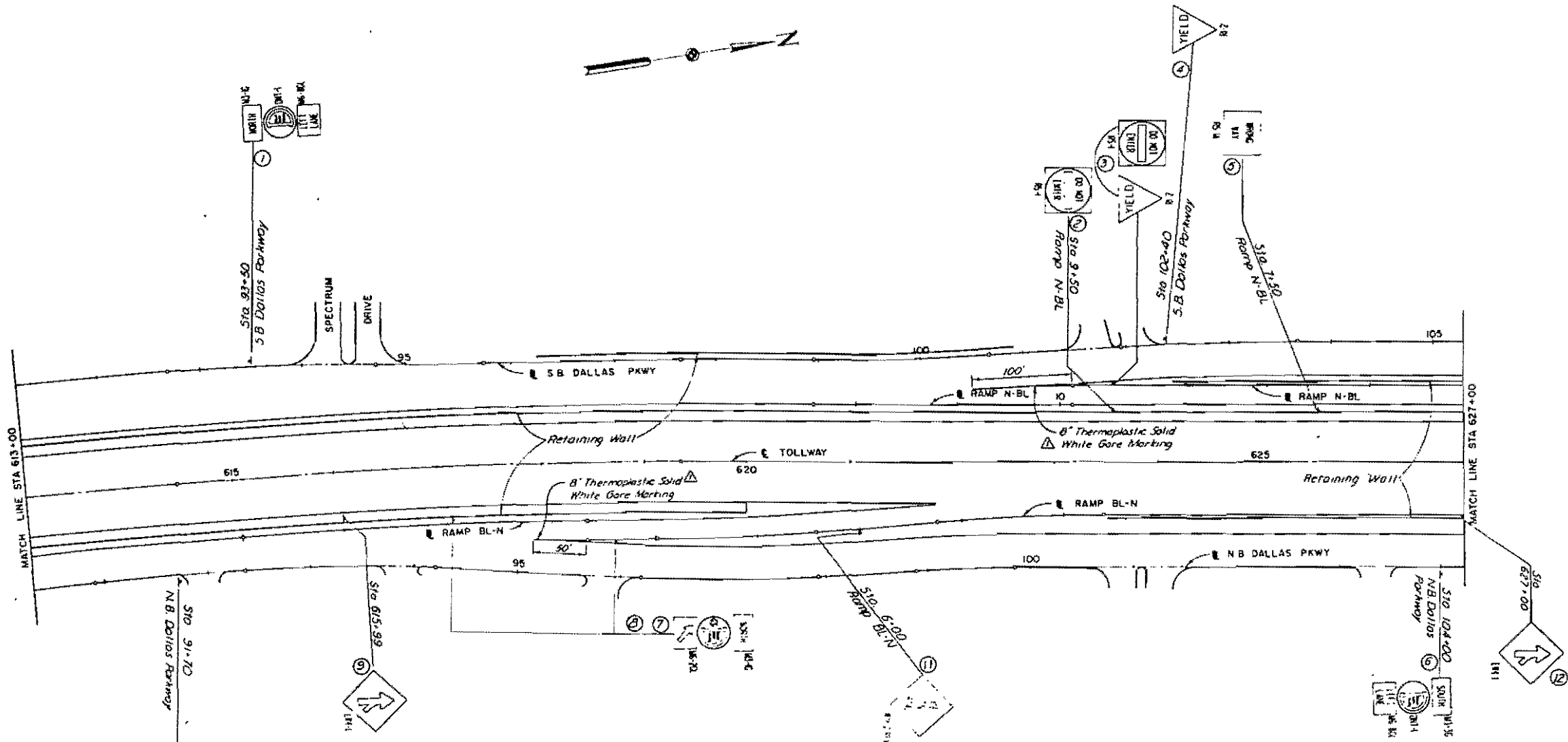

Add Gore Marking (Sign 12) NO. _____ REVISION BY _____ DATE _____	
<b>TEXAS TURNPIKE AUTHORITY</b> <b>DALLAS NORTH TOLLWAY</b> <b>SIGNING AND PAVEMENT MARKING LAYOUT</b> STA. 613+00 TO STA. 627+00	
<b>HNTB</b> <small>HOKIENGE HOLDING CORPORATION</small>	
SECTION 1-VII	
DESIGNED BY RSM DATE 1-86 CHECKED BY DAL DATE 3-86	DRAWN BY JMP DATE 1-86 SCALE 1" = 50'
CONTRACT NO. DNT-121 SHEET 32 OF 76	

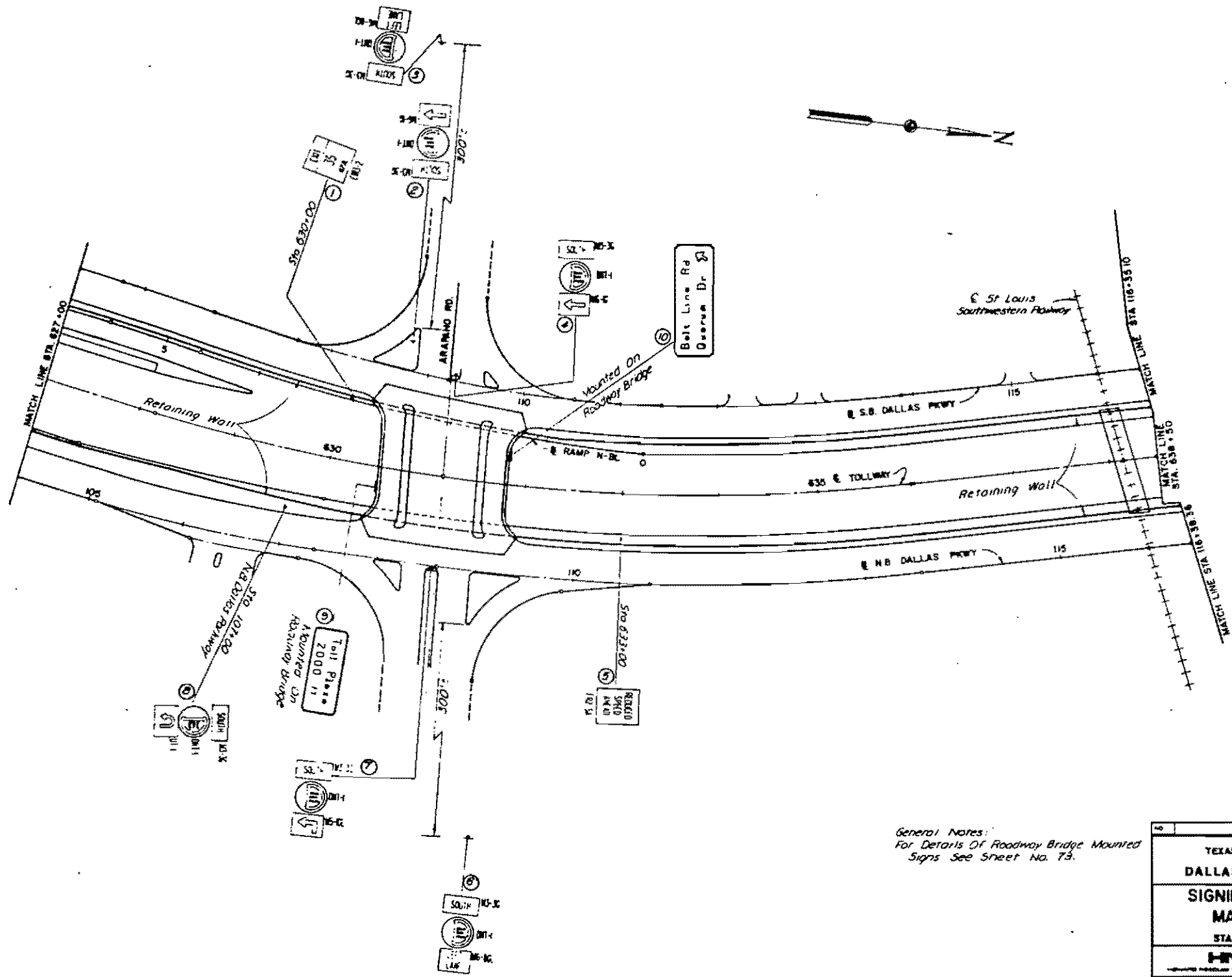

General Notes:  
 For Details Of Roadway Bridge Mounted  
 Signs See Sheet No. 73.

NO.	REVISION	BY	DATE
TEXAS TURNPIKE AUTHORITY <b>DALLAS NORTH TOLLWAY</b> <b>SIGNING AND PAVEMENT MARKING LAYOUT</b> STA. 627+00 TO STA. 638+50			
<b>HNTB</b>			SECTION I-VIII
DESIGNED BY	DATE	CHECKED BY	DATE
SAH	1-88	JMP	1-88
DRAWN BY	DATE	SCALE	
GGI	3-88	1" = 50'	
CONTRACT NO. DNT-121 SHEET 33 OF 76			

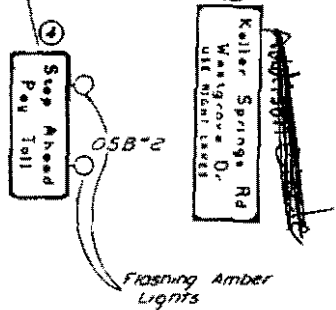
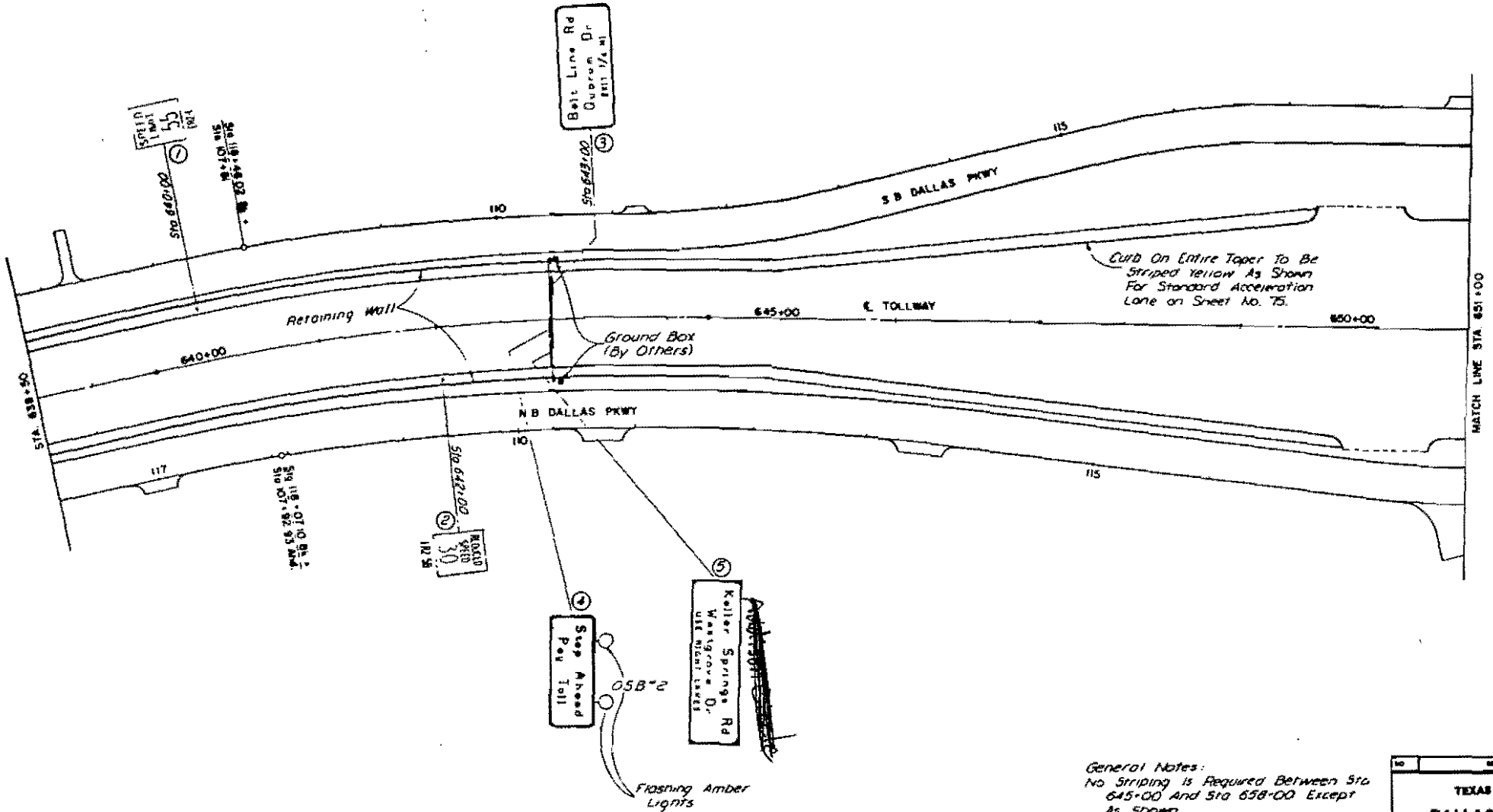

Note:  
See Standard Drawing No 55-26  
for flashing amber light mounting  
and electrical connection details

General Notes:  
No Striping is Required Between Sta  
645+00 and Sta 658+00 Except  
As Shown.

NO		REVISION		BY	DATE
TEXAS TURNPIKE AUTHORITY DALLAS NORTH TOLLWAY					
SIGNING AND PAVEMENT MARKING LAYOUT					
STA 638+50 TO STA 651+00					
<b>HNTB</b>					SECTION 1-VIII
DATE	BY	SCALE	DATE	BY	SCALE
RAM	1-86	1" = 50'	JMP	1-86	1" = 50'
GAL	3-86				
CONTRACT NO. DNT-121 SHEET 34 OF 76					

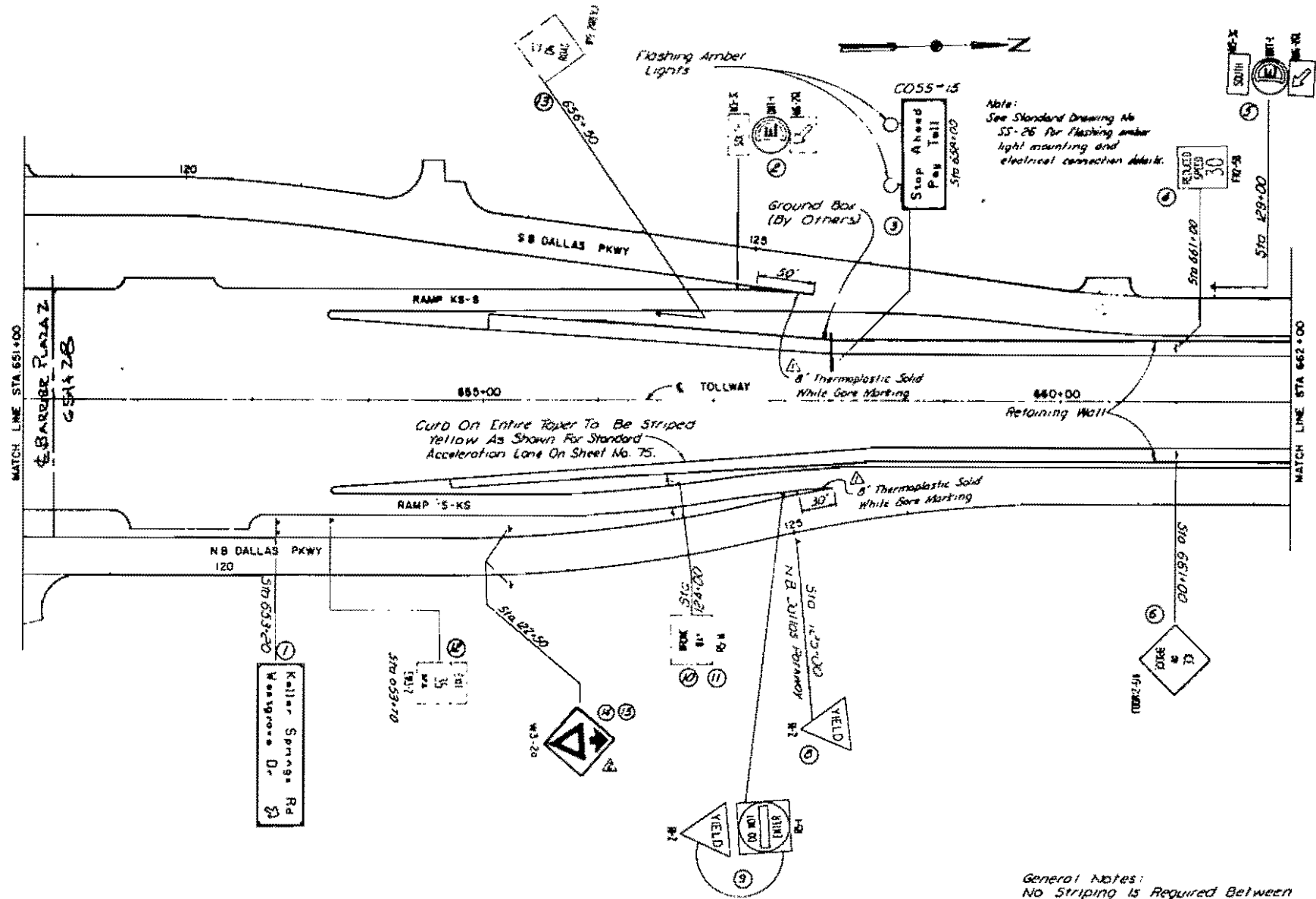

Note:  
See Standard Drawing No  
SS-26 For Flashing amber  
light mounting and  
electrical connection details.

Curd On Entire Taper To Be Striped  
Yellow As Shown For Standard  
Acceleration Lane On Sheet No. 75.

General Notes:  
No Striping Is Required Between  
Sta 643+00 and 653+00 Except  
As Shown

Sign 7 Not Used

▲	Add Signs 14 & 15	Rev	4-10-87
▲	Add Gore Marking	Rev	10-29-86
NO	BYRON	DT	BATY
TEXAS TURNPIKE AUTHORITY DALLAS NORTH TOLLWAY			
SIGNING AND PAVEMENT MARKING LAYOUT			
STA 651+00 TO STA 662+00			
<b>HNTB</b>			SECTION I-VIII
DESIGNED	RAM	DATE	1-86
CHECKED	GAL	DATE	3-86
		DESIGNED	JMP
		DATE	1-86
		CHECKED	DATE
			1-86
CONTRACT NO. DNT-121		SHEET 35 OF 76	

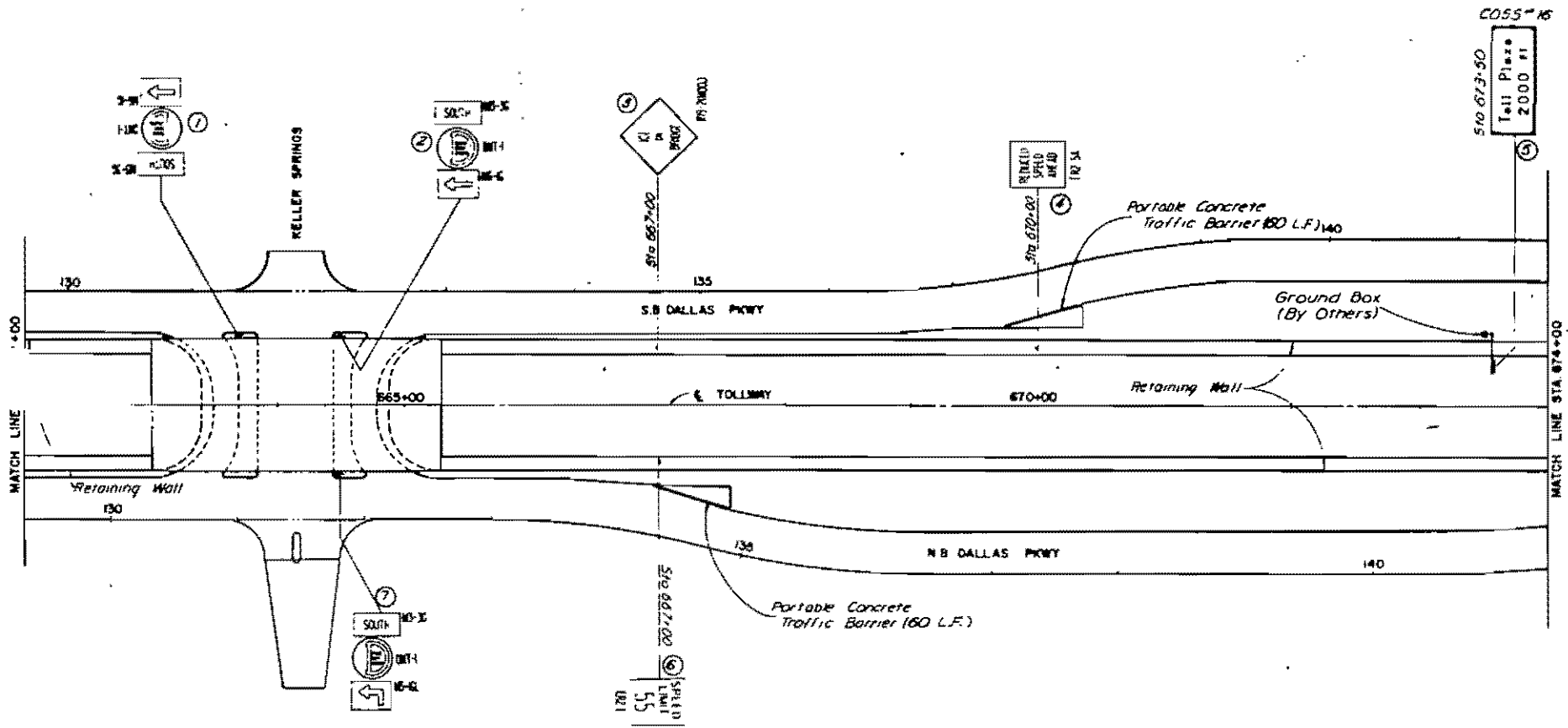

COSS-15  
510 673+50  
Toll Plaza  
2000 ft

TEXAS TURNPIKE AUTHORITY			
DALLAS NORTH TOLLWAY			
SIGNING AND PAVEMENT MARKING LAYOUT			
STA. 662+00 TO STA. 674+00			
HNTB			SECTION I-VIII
RAM	1-86	JMP	1-86
GAL	3-85	SCALE	1" = 50'
CONTRACT NO. DNT-121 SHEET 36 OF 76			

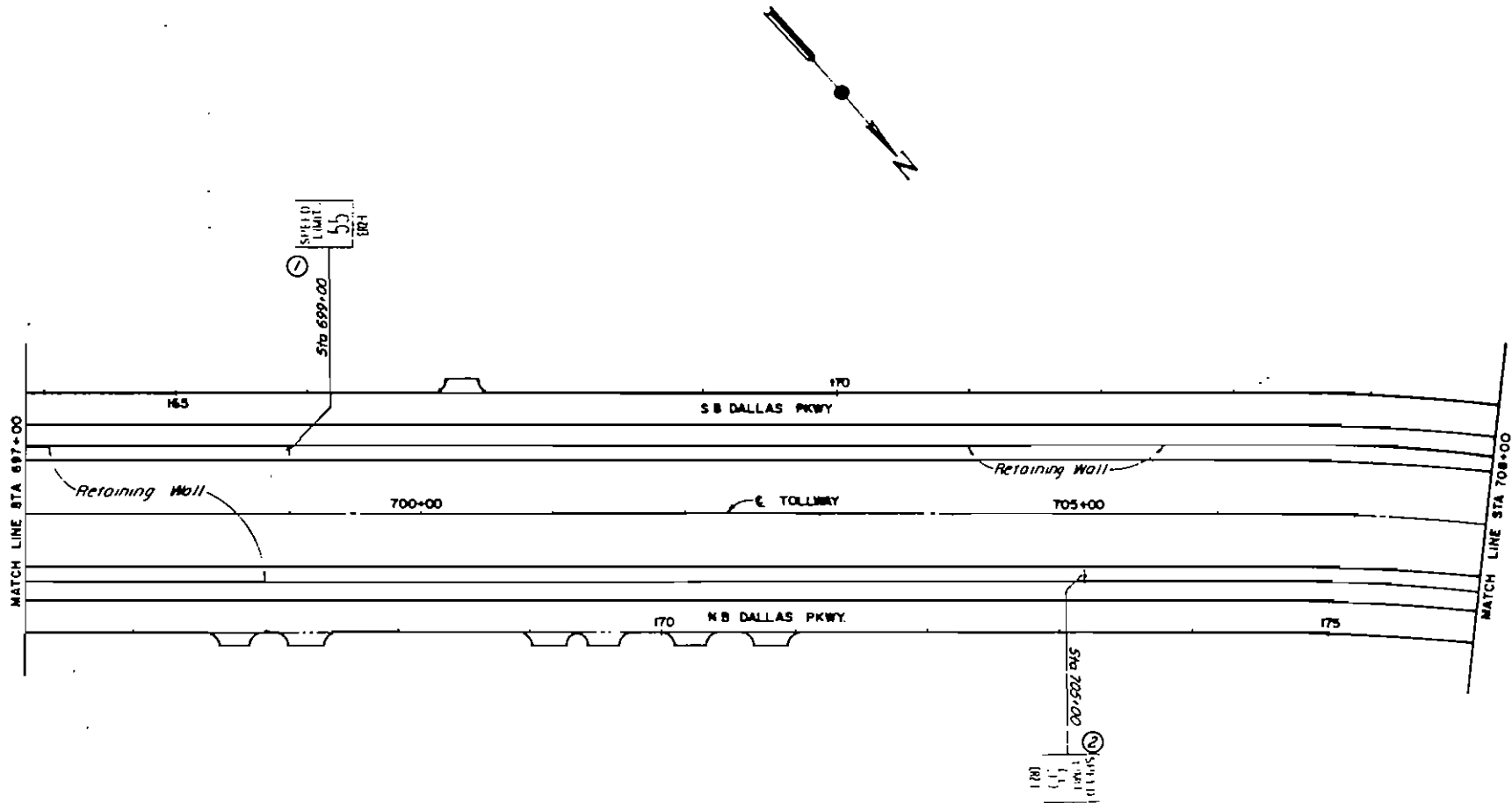

NO.	REVISED	BY	DATE
TEXAS TURNPIKE AUTHORITY DALLAS NORTH TOLLWAY <b>SIGNING AND PAVEMENT MARKING LAYOUT</b> STA. 697+00 TO STA. 708+00			
<b>HNTB</b>			SECTION I-VIII
DESIGNED BY	DATE	CHECKED BY	DATE
RAM	1-86	JMP	1-86
CHECKED BY	DATE	SCALE	SCALE
SAL	3-86	1" = 50'	1" = 50'
CONTRACT NO. DNT-121 SHEET 39 OF 76			

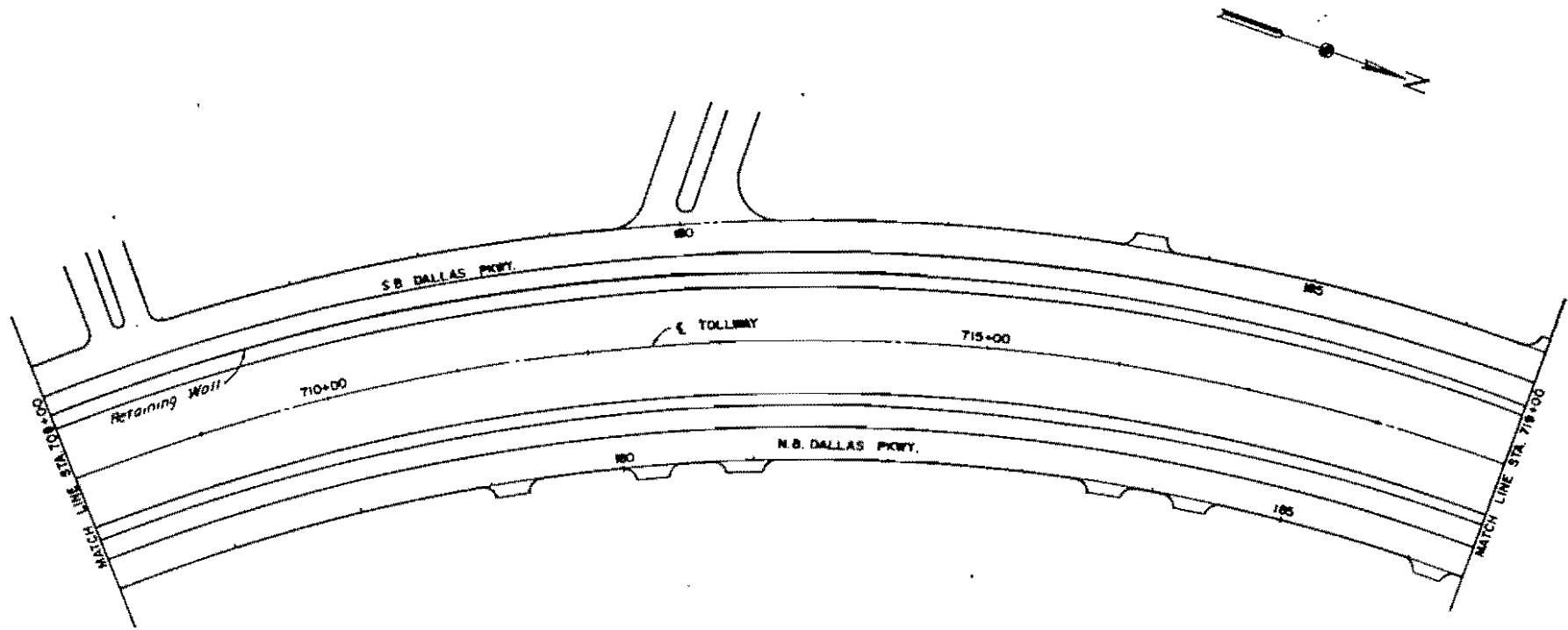

NO.	REVISION	BY	DATE
TEXAS TURNPIKE AUTHORITY DALLAS NORTH TOLLWAY <b>SIGNING AND PAVEMENT          MARKING LAYOUT</b> STA. 708+00 TO STA. 719+00			
<b>HNTB</b>			SECTION 1-VBL
DESIGNED BY	DATE	CHECKED BY	DATE
GAL	1-85	JMP	1-85
DRAWN BY	DATE	SCALE	DATE
	3-85	1" = 50'	
CONTRACT NO. DNT-121 SHEET 40 OF 76			



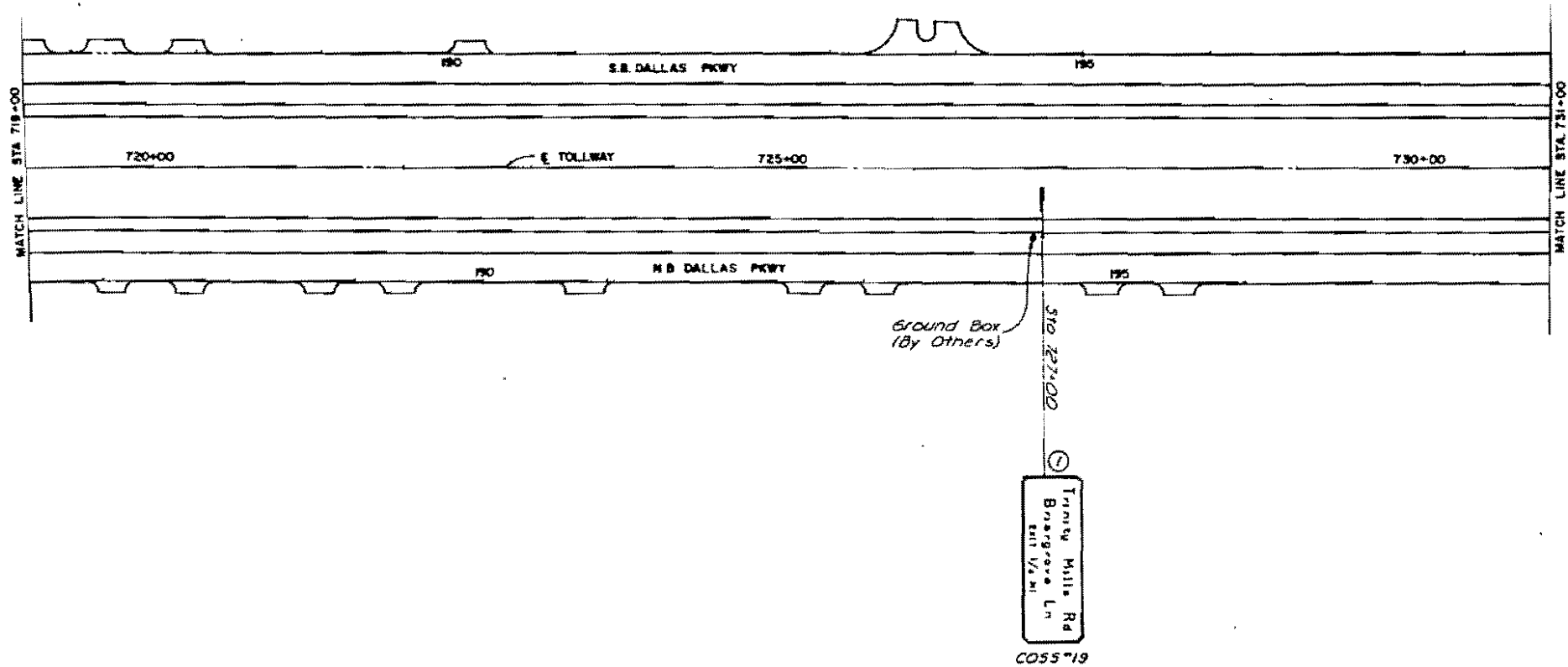

NO.	REVISION	BY	DATE
TEXAS TURNPIKE AUTHORITY DALLAS NORTH TOLLWAY <b>SIGNING AND PAVEMENT          MARKING LAYOUT</b> STA 719+00 TO STA 731+00			
<b>HNTE</b>			SECTION I-VIII
DESIGNED BY	1-86	CHECKED BY	1-86
DRAWN BY	2-86	SCALE	1" = 50'
CONTRACT NO. DNT 121 SHEET 41 OF 76			

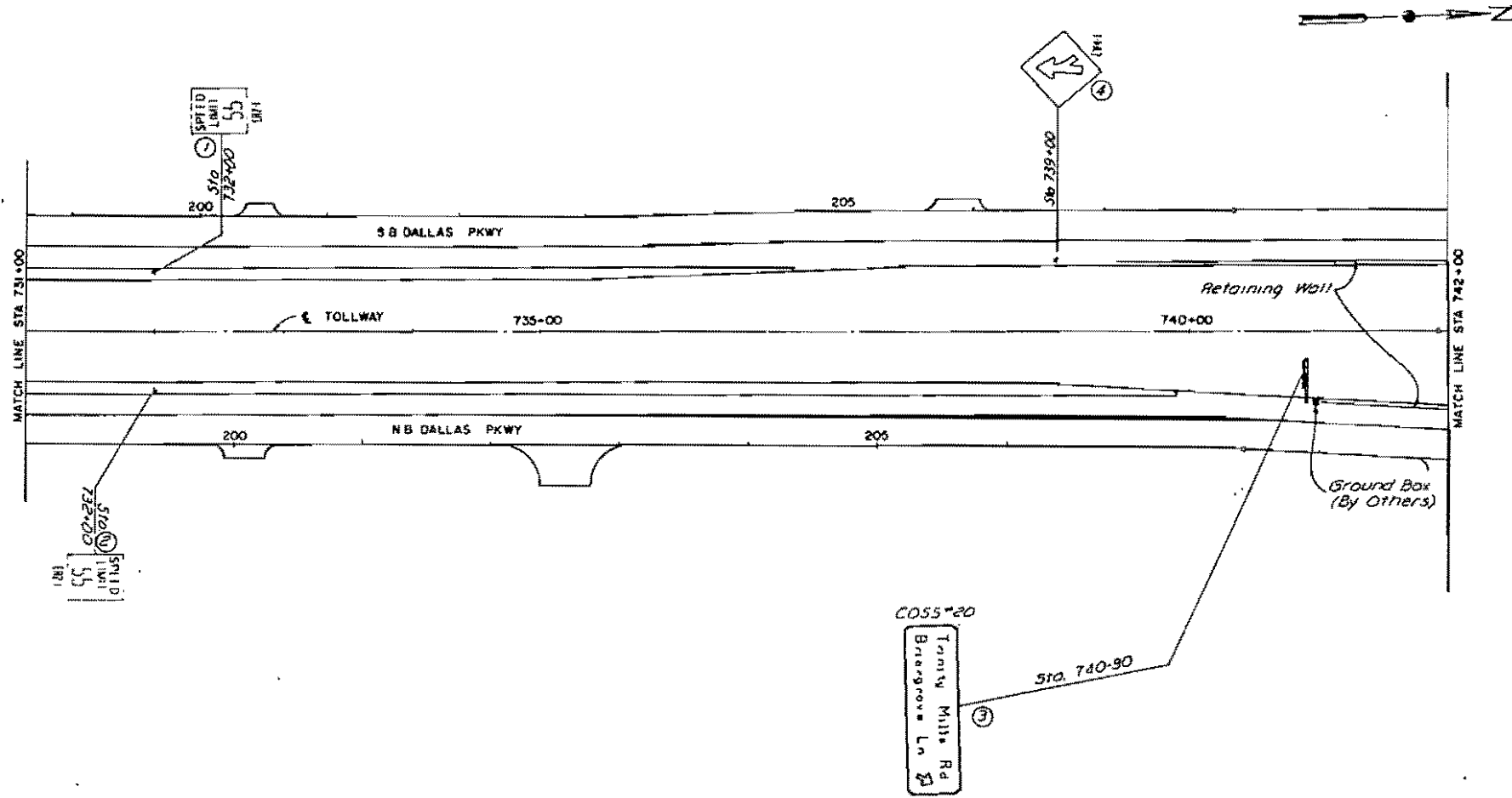

NO.	REVISION	BY	DATE
1	Add Sign 4	JDS	10-27-86
TEXAS TURNPIKE AUTHORITY DALLAS NORTH TOLLWAY SIGNING AND PAVEMENT MARKING LAYOUT STA. 731+00 TO STA. 742+00			
<b>HNTB</b>			SECTION I-VII
DESIGNED BY	DATE	DESIGNED - JWP	DATE
3/86	3-86		1-86
CHECKED BY	DATE	SCALE	
SA	3-86	1" = 50'	
CONTRACT NO. <u>ONT-121</u> SHEET <u>42</u> OF <u>76</u>			

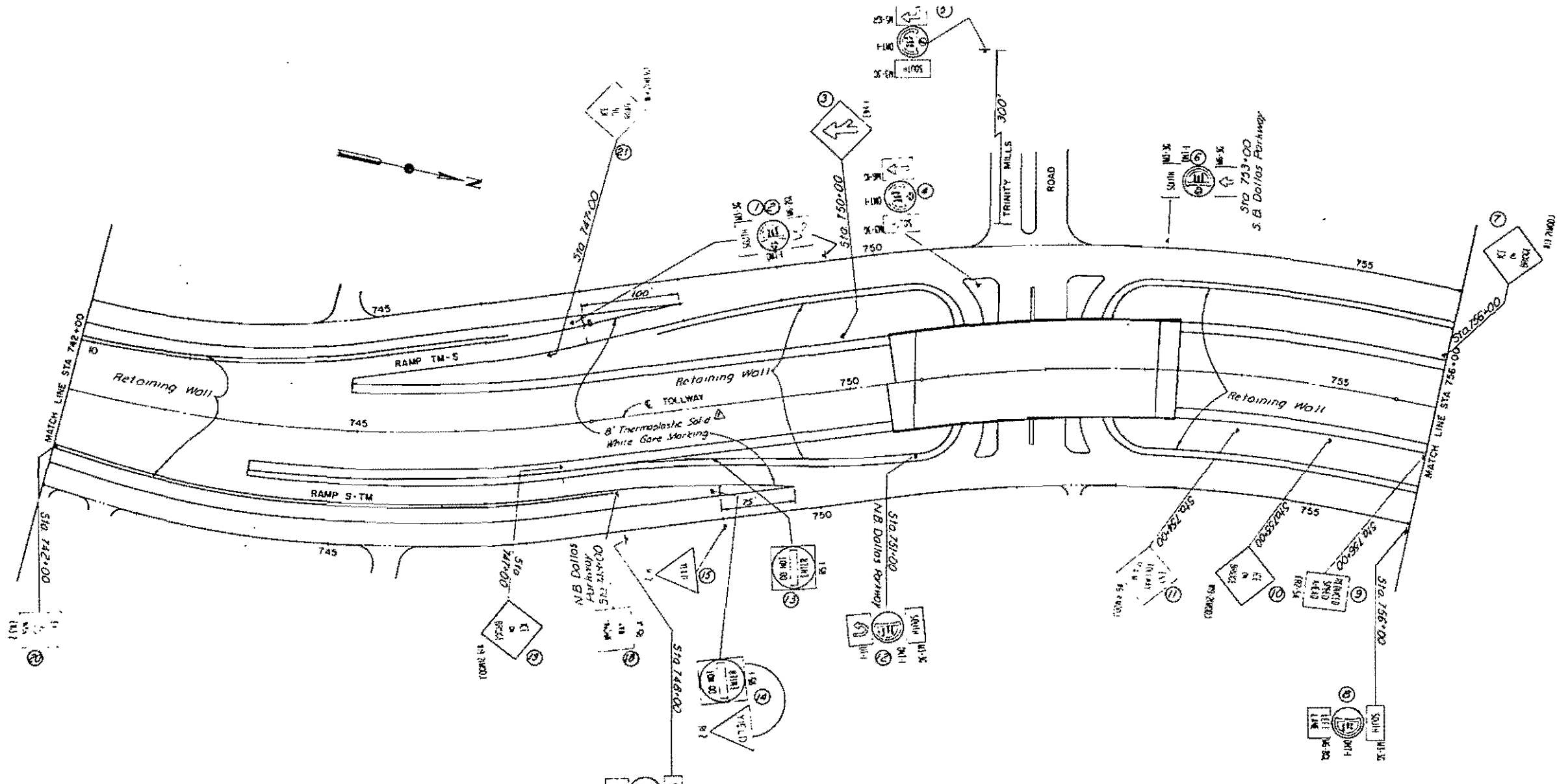

Sign (2) Not Used

Add Gate Marking		29	10-29-86
NO	REVISION	BY	DATE
TEXAS TURNPIKE AUTHORITY			
DALLAS NORTH TOLLWAY			
SIGNING AND PAVEMENT MARKING LAYOUT			
STA 742+00 TO STA 756+00			
<b>HNTB</b>			SECTION 1-VIII
DESIGNED BY	DATE	REVISION	DATE
ENGINEER	DATE	REVISION	DATE
CONTRACT NO. DNT-12L SHEET 43		OF 76	

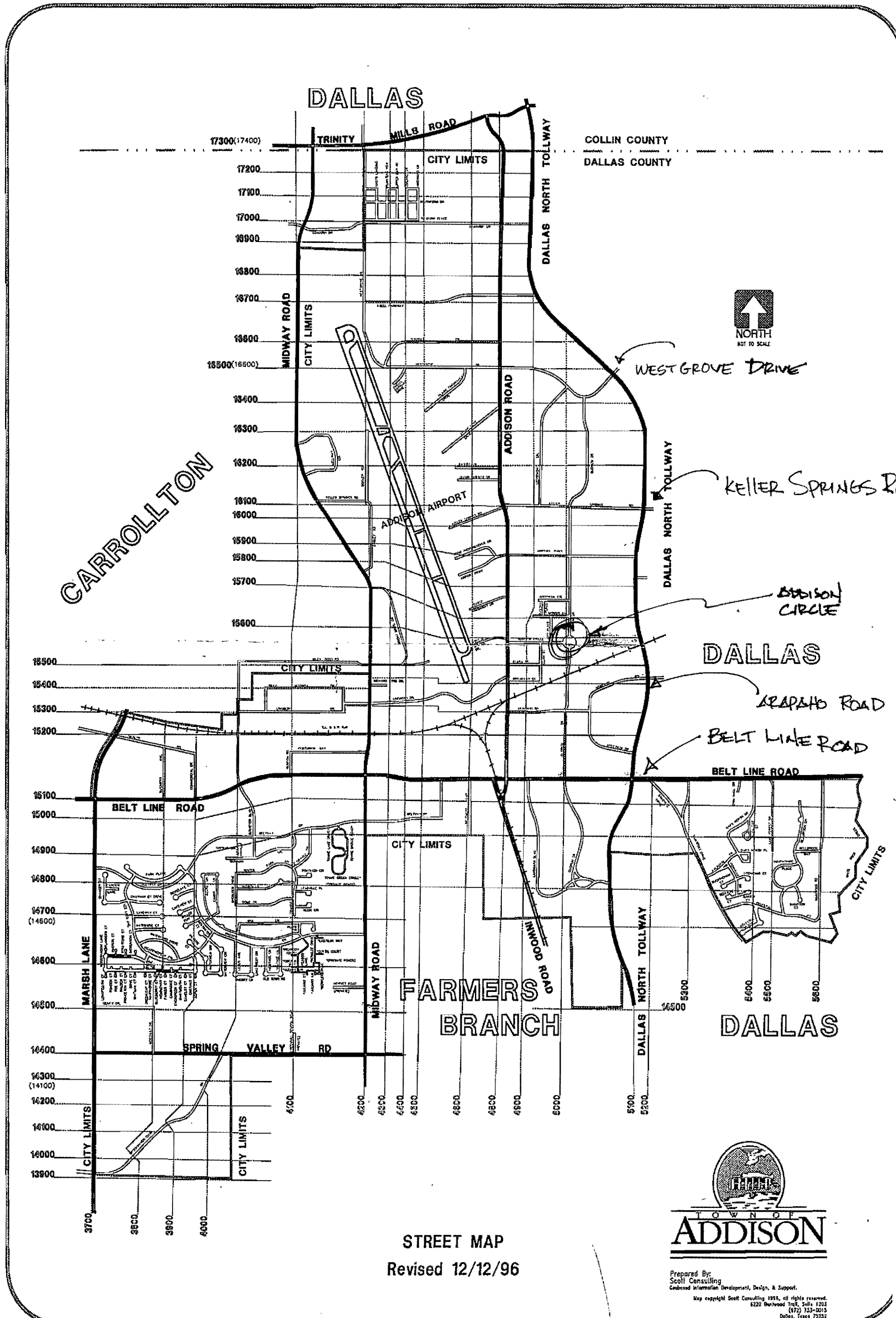

# DALLAS

CARROLLTON

# FARMERS BRANCH

# DALLAS

# DALLAS

STREET MAP  
Revised 12/12/96

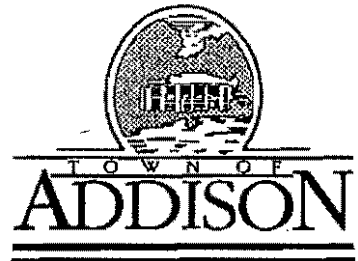

Prepared By:  
Scott Consulting  
Geospatial Information Development, Design, & Support.

Map copyright Scott Consulting 1995, all rights reserved.  
6220 Barwood Trail, Suite 1203  
(972) 753-0015  
Dallas, Texas 75234

DALLAS

COLLIN COUNTY  
DALLAS COUNTY

DALLAS NORTH TOLLWAY

TRINITY  
MILLS ROAD  
CITY LIMITS

17300(17400)

17200

17100

17000

16900

16800

16700

16600

16500(16600)

16400

16300

16200

16100

16000

15900

15800

15700

15600

15500

CARROLLTON

MIDWAY ROAD  
CITY LIMITS

ADDISON ROAD

DALLAS NORTH TOLLWAY



DALLAS

15500

15400

15300

15200

15100

15000

14900

14800

14700

14600(14500)

14500

14400

14300

14200(14100)

14100

14000

13900

13800

13700

13600

13500

4000

3900

3800

3700

3600

3500

3400

3300

3200

3100

3000

CITY LIMITS

4100

4200

4300

4400

4500

4600

4700

4800

4900

5000

5100

5200

5300

5400

5500

5600

5700

MIDWAY ROAD

BELT LINE ROAD

MARSH LANE

SPRING VALLEY RD

INWOOD ROAD

BELT LINE ROAD

CITY LIMITS

CITY LIMITS

CITY LIMITS

CITY LIMITS

DALLAS NORTH TOLLWAY

DALLAS

CITY LIMITS

CITY LIMITS

CITY LIMITS

CITY LIMITS

CITY LIMITS

CITY LIMITS

CITY LIMITS

CITY LIMITS

CITY LIMITS

CITY LIMITS

CITY LIMITS

CITY LIMITS

CITY LIMITS

CITY LIMITS

CITY LIMITS

CITY LIMITS

CITY LIMITS

CITY LIMITS

CITY LIMITS



# ADDISON STREET MAP

(UPDATED 5/98)

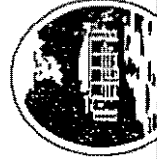

TOWN OF  
**ADDISON**

Draft letter for Ross/Sgt

8/31/98

SPOKE w/JIM PACE

9/21/98.

HE SAID HE COULDN'T HELP  
ME WITH MY REQUEST FOR  
SIGNAGE FOR Addison  
Circle on D-Pky.

HE SAID THIS TYPE OF  
REQUEST SHOULD COME  
FROM City Manager and  
be aimed at the  
"NEW" EXECUTIVE DIRECTOR

JERRY HIEBERT.

*Mung*

I CALLED Jim, SPOKE  
WITH Him on AUG 31<sup>st</sup>.

HE SAID HE STILL HAS A COPY  
OF MY ORIGINAL letter and  
will see how the NEW ~~REGIME~~  
REGIME will want to handle.

North Texas Tollway Authority  
P.O. Box 190369  
Dallas, Texas 75219

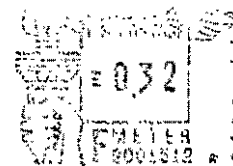
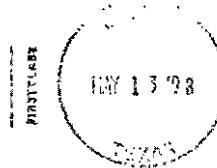

*DO NOT USE contents of this envelope*

Town of Addison  
Public Works Department  
P.O. Box 144  
Addison, Texas 75001

Attn: Mr. Michael E. Murphy, P.E.

75001-0144

