



November 4, 1981

Mr. George Dowling
Director of Community Development
City of Addison
P. O. Box 144
Addison, TX 75001

Re: Flood Plain Fill at Belt Line
Road and Winnwood Road

Dear Mr. Dowling:

Enclosed is a copy of our file on the subject fill case, which you requested. We approved the fill in the 100-year flood plain of White Rock Creek previous to the property exchange with Addison.

I trust this is the information you needed. If we may be of further assistance, feel free to contact the Storm Water Management Section of this Department.

Sincerely,

Nathan Maier
Assistant Director
Public Works Department

pm

Enclosure

PUBLIC WORKS CHECK LIST
FILL IN FLOOD PLAIN

JAT 8-21-79 FLOODPLAIN FILE FP 79-12
 TRACT Belt Line at Winnwood
 CREEK White Rock DESIGN DISCHARGE 40,000
 SOURCE OF EXISTING PROFILE White Rock Creek Study

CONSULTING ENGINEER Huitt-Zollars REVIEWED BY Nathan Maier

CRITERIA NO.	DESCRIPTION	MEETS CRITERIA	FAILS CRITERIA	REMARKS
1	Zero increase in water surface	X		
2	No erosive velocity on or off site	X		Max. velocity 6.18
3	Equal conveyance change allowed on both sides of creek	X		
4	Natural channel not relocated without E.I.S. and complete stream rehabilitation program	X		
5	Toe of fill parallel to creek	X		
6	a. Max. slope 3:1 for 50% and 6:1 for remainder	X		
	b. Slope of excavated area not in rock not to exceed 4:1			N/A
	c. Vertical walls, terracing, other slope treatments part of landscaping plan and does not unbalance flow			N/A
7	a. Excavation not lower than 1/3 depth of natural channel or 1-year flood, whichever is lower, except lakes			N/A
	b. No excavation closer than 50' from bank of natural channel			N/A
8	Landscaping plan includes:			
	a. Erosion control of cut and fill slopes	X		
	b. Restoration of excavated areas			N/A
	c. Tree protection in and below fill area	X		
	d. Natural materials where possible	X		

C RITERIA
NO.

DESCRIPTION

MEETS
CRITERIA

FAILS
CRITERIA

REMARKS

9

Proposed and existing
improvements used in study
calculations

X

10

No additional expense
in current or future
public improvements due
to plan

X

11

General Comments This application meets all criteria. I recommend
 approval.



CITY OF DALLAS

November 7, 1979

Mr. Willard R. Baker
Suite 497
Dallas Petroleum Center
13612 Midway Road
Dallas, Texas 75240

RE: FP 79-12

Dear Mr. Baker:

Permission is hereby granted to proceed with filling your tract of land in Block 8172, south of Belt Line Road and east of Winnwood Road, which was approved by the City Council on September 26, 1979, and in accordance with the plans previously submitted to this Department. Upon completion of the fill in accordance with the plans submitted to and approved by the City Council, written notification should be sent to this Department and upon verification of the elevations, the "FP" prefix will be removed from that portion of the tract that has been filled.

Yours very truly,

Monroe McCorkle
Director
Public Works Department

s1

Nathan



CITY OF DALLAS

October 3, 1979

Mr. Willard R. Baker
Suite 497
Dallas Petroleum Center
13612 Midway Road
Dallas, TX 75240

Dear Mr. Baker:

The Dallas City Council at its public hearing on September 26, 1979 approved your request for fill and removal of the flood plain prefix. A copy of the official action is attached for your files.

A fill permit can be obtained from the Storm Water Management Program of the Public Works Department. For information, phone 670-6188.

If I can be of further assistance in this case, please feel free to call.

With kindest regards,

A handwritten signature in cursive script that reads "Richard L. Miller".

Richard L. Miller
Urban Planner
Environmental/Community Planning

s1

attachment

cc: ~~Tomie [redacted]~~, Program Manager
Storm Water Management
Public Works

OFFICIAL ACTION OF THE DALLAS CITY COUNCIL

September 26, 1979

79-2882

FLOOD PLAIN 79-12

A public hearing was called on flood plain case FP-79-12, application for the fill and removal of the Flood Plain prefix on property presently zoned a Flood Plain (Residential-16,000 Square Feet) District on the east side of Winnwood Road, south of Belt Line Road.

No one appeared who wished to be heard regarding this issue.

Councilman Leedom moved to close the public hearing and follow the recommendation of the urban plan staff and approve the request for the fill and removal of the flood plain prefix.

Motion unanimously carried. (Folsom , Nicol absent; Hicks absent when vote taken)



ROBERT S. SLOAN
City Secretary

RSS/gw

Memorandum



CITY OF DALLAS

DATE August 21, 1979

TO Ray Stanland
Urban Planning

SUBJECT Fill Permit Application
Belt Line & Winwood
File FP 79-12

The subject tract is in the flood plain of White Rock Creek. The application meets all of the fill criteria. I recommend approval of this request.

A handwritten signature in cursive script that reads "Monroe McCorkle".

Monroe McCorkle
Director of Public Works

rh

Hop, MARK, GEO, C.J. & RON

4-1-82

Review drainage file

1. Willard Baker - visit him to insure he is complying
 - at time of development visit Stewart Beatty
 - who builds path along creek.
 - Be sure he sends new topo to Kallas and gets letter of approval from them.

✓ 2. Stanley Peskey - A woman West

- Reg'd to pay an assessment on Inwood - is it paid?
- Restrict driveway on Inwood to northbound exist only.

✓ * 3, 10:00 AM Wed - Levitz meeting

ZONING & DEVELOPMENT

Chris Price

Willard Baker

King Copeland

Sakowitz

Registry-Spectrum

Quorum Drive

Sir Lancelot

Burns Petroleum

Les Lacs

Overall Zoning

Rice Institute

Mowing Policy

02/11/10

NATIONAL FLOOD INSURANCE PROGRAM

FIRM
FLOOD INSURANCE RATE MAP

CITY OF
ADDISON, TEXAS
DALLAS COUNTY

ONLY PANEL PRINTED

COMMUNITY-PANEL NUMBER
481089 0005 A

EFFECTIVE DATE:
JULY 16, 1980



U.S. DEPARTMENT OF HOUSING
AND URBAN DEVELOPMENT
FEDERAL INSURANCE ADMINISTRATION

BELT LINE RD.

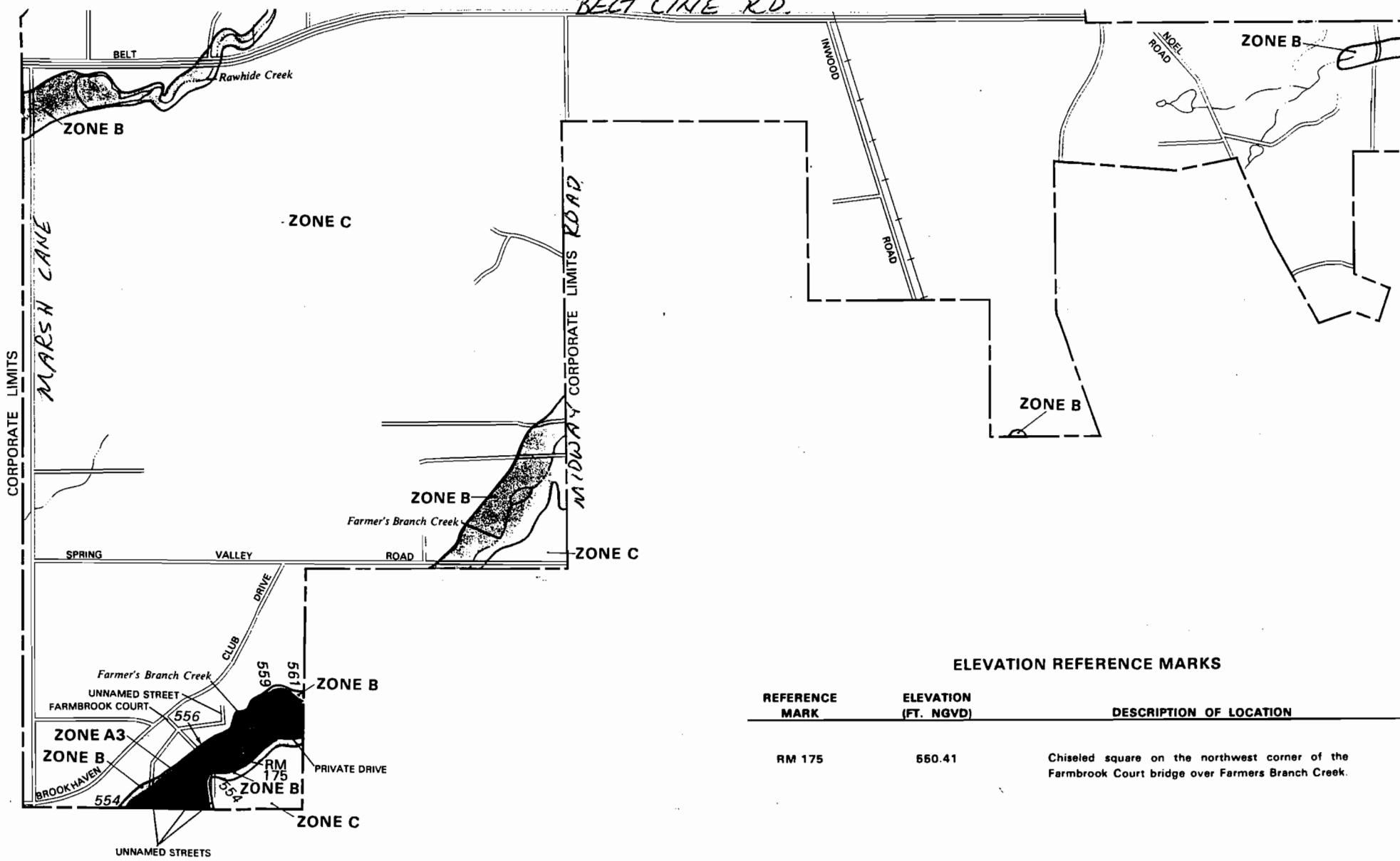

ELEVATION REFERENCE MARKS

REFERENCE MARK	ELEVATION (FT. NGVD)	DESCRIPTION OF LOCATION
RM 175	560.41	Chiseled square on the northwest corner of the Farmbrook Court bridge over Farmers Branch Creek.

FIELD NOTES

BEING a tract of land out of the A. Bledsoe Survey, Abstract No. 157 and being a part of City Block Site, City of Dallas, and being more particularly described as follows:

BEGINNING at the intersection of the East R.O.W. line of Winnwood Lane (60 ft. R.O.W.) and the block line of City Blocks 8172 and 8173, said point also being 1329.73 feet South of the center line of Belt Line Road;

THENCE in a Northerly direction along the East R.O.W. line of Winnwood Lane, a curve to the left whose tangent bearing of North $05^{\circ}14'12''$ East, having a center angle of $04^{\circ}33'44''$, a radius of 4091.83 feet, and an arc length of 325.81 feet;

THENCE North $00^{\circ}04'28''$ East, along the East R.O.W. of said Winnwood Lane a distance of 724.22 feet to an angle point;

THENCE South $89^{\circ}19'32''$ East, 160.39 feet to an angle point;

THENCE South $24^{\circ}30'00''$ East, 96.00 feet to an angle point;

THENCE South $00^{\circ}40'00''$ West, 120.00 feet to an angle point;

THENCE South $16^{\circ}00'00''$ West, 120.00 feet to an angle point;

THENCE South $23^{\circ}30'00''$ West, 132.00 feet to an angle point;

THENCE South $00^{\circ}40'28''$ West, 106.00 feet to an angle point;

THENCE South $27^{\circ}00'00''$ East, 218.00 feet to an angle point;

THENCE South $10^{\circ}00'00''$ East, 116.00 feet to an angle point;

THENCE South $24^{\circ}00'00''$ West, 140.00 feet to an angle point;

THENCE South $08^{\circ}30'00''$ West, 63.00 feet to an angle point;

THENCE North $89^{\circ}44'37''$ West, 190.00 feet to the POINT OF BEGINNING and CONTAINING 190,486. Square Feet or 4.373 Acres of Land, more or less.

MUELLER CO.

MANUFACTURERS OF WATER AND GAS DISTRIBUTION AND SERVICE PRODUCTS
MAIN OFFICE AND FACTORY: DECATUR, ILLINOIS

SOUTHWEST SALES OFFICE
14114 Dallas Parkway
Suite 322
Dallas, TX 75240
Phone: 214-934-1137

JIM KOLLOCK
1405 Hampton Lane
Plano, Texas 75075
Phone: 214 424-1877

Dallas gave requirements
(DALLAS)
NATHAN D. MAIER, P.E.
670 - 6526
RE. WILLARD BAKER

o Get specific requirements
before any building permits
are issued —

(11-4-81) — Talked with Nathan
& he is to send me a copy
of everything he has on Willard
Baker —

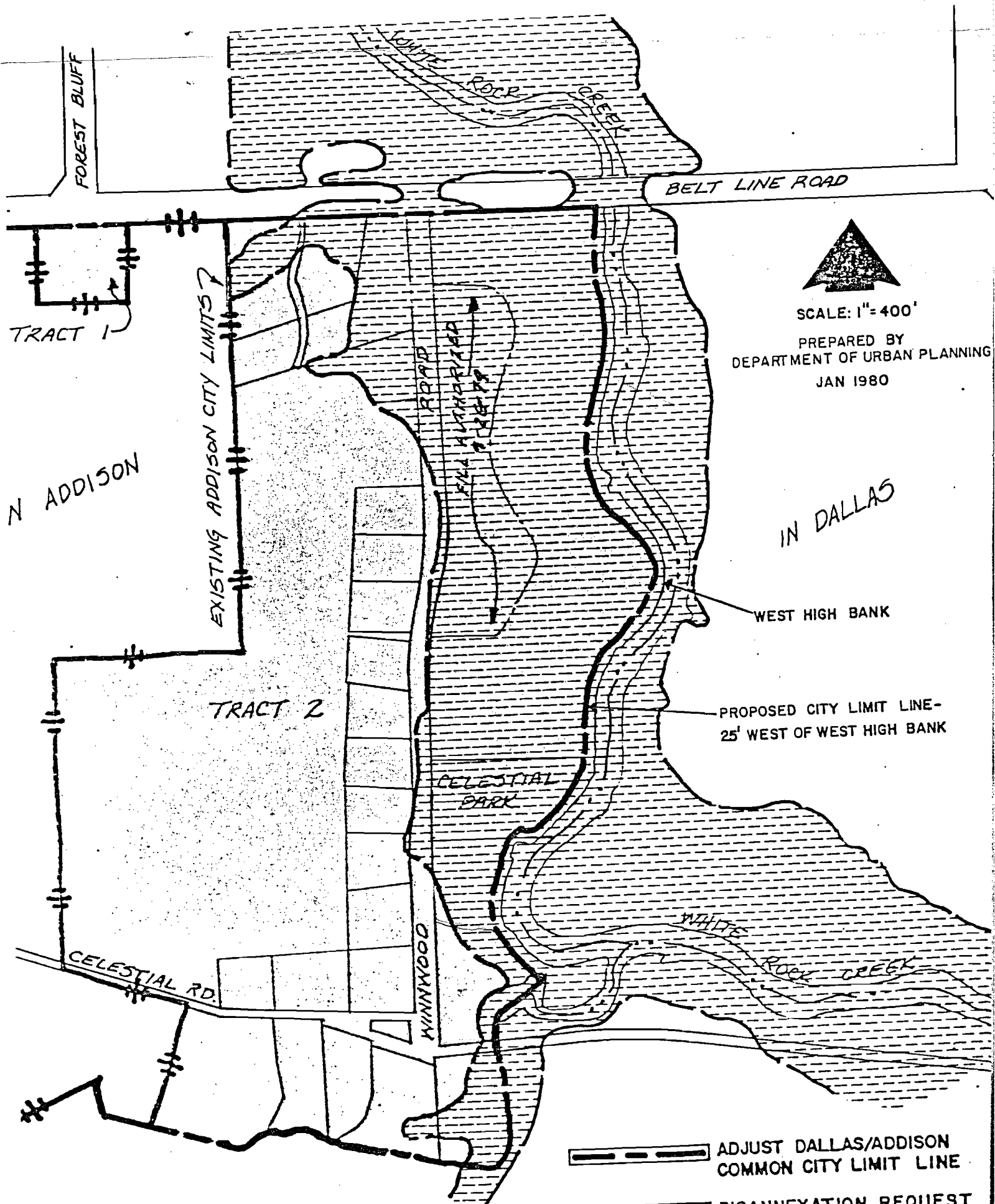

SCALE: 1" = 400'

PREPARED BY
DEPARTMENT OF URBAN PLANNING
JAN 1980

IN DALLAS

WEST HIGH BANK

PROPOSED CITY LIMIT LINE-
25' WEST OF WEST HIGH BANK

CELESTIAL PARK

WHITE ROCK CREEK

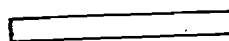
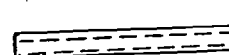
-  ADJUST DALLAS/ADDISON COMMON CITY LIMIT LINE
-  DISANNEXATION REQUEST BY ADDISON
-  FLOOD PLAIN DELINEATION

DALLAS-ADDISON CITY LIMIT ADJUSTMENT

EXHIBIT C

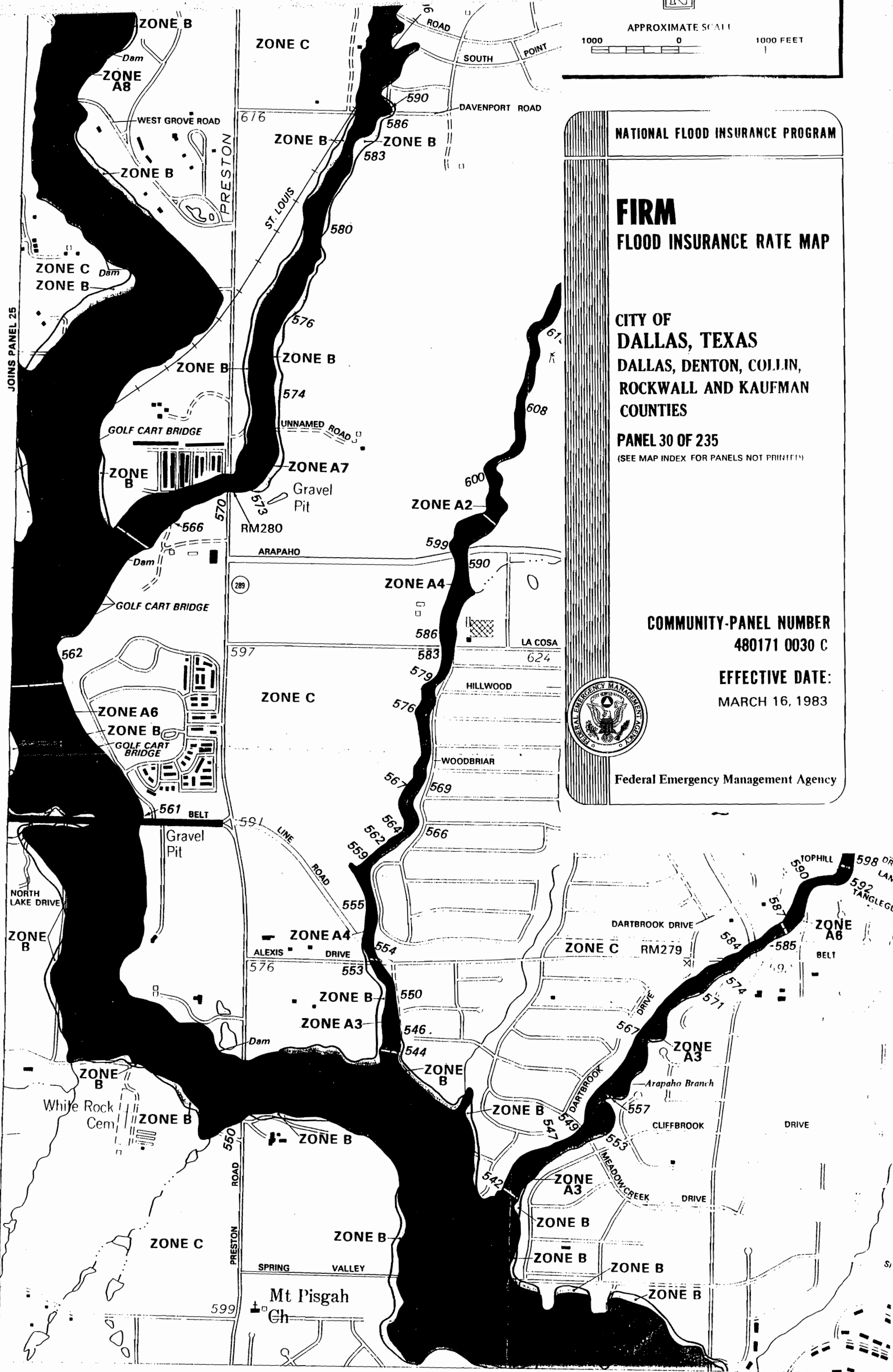

JOINS PANEL 25

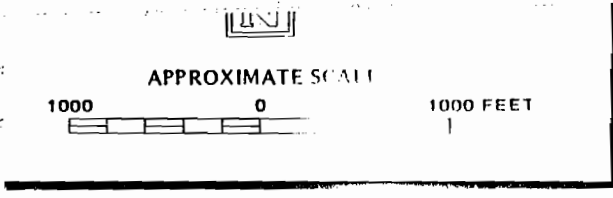

NATIONAL FLOOD INSURANCE PROGRAM

**FIRM
FLOOD INSURANCE RATE MAP**

**CITY OF
DALLAS, TEXAS
DALLAS, DENTON, COLLIN,
ROCKWALL AND KAUFMAN
COUNTIES**

PANEL 30 OF 235
(SEE MAP INDEX FOR PANELS NOT PRINTED)

**COMMUNITY-PANEL NUMBER
480171 0030 C**

**EFFECTIVE DATE:
MARCH 16, 1983**



Federal Emergency Management Agency

JOINS PANEL 60

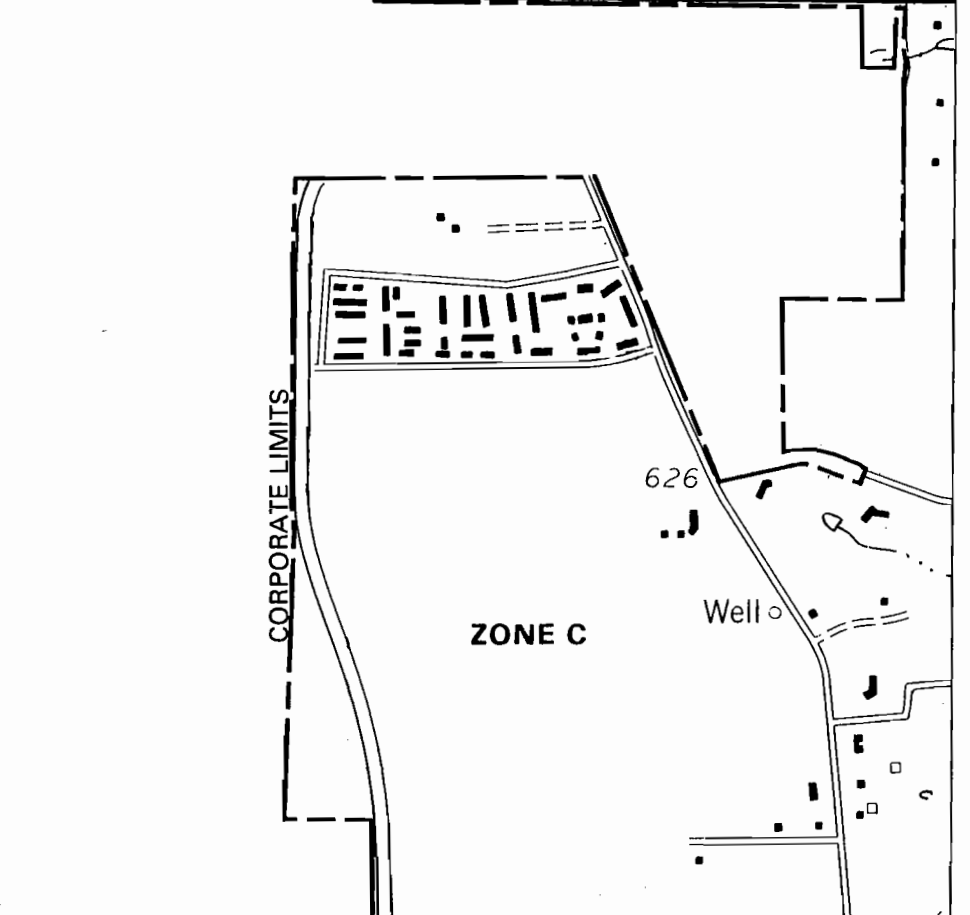
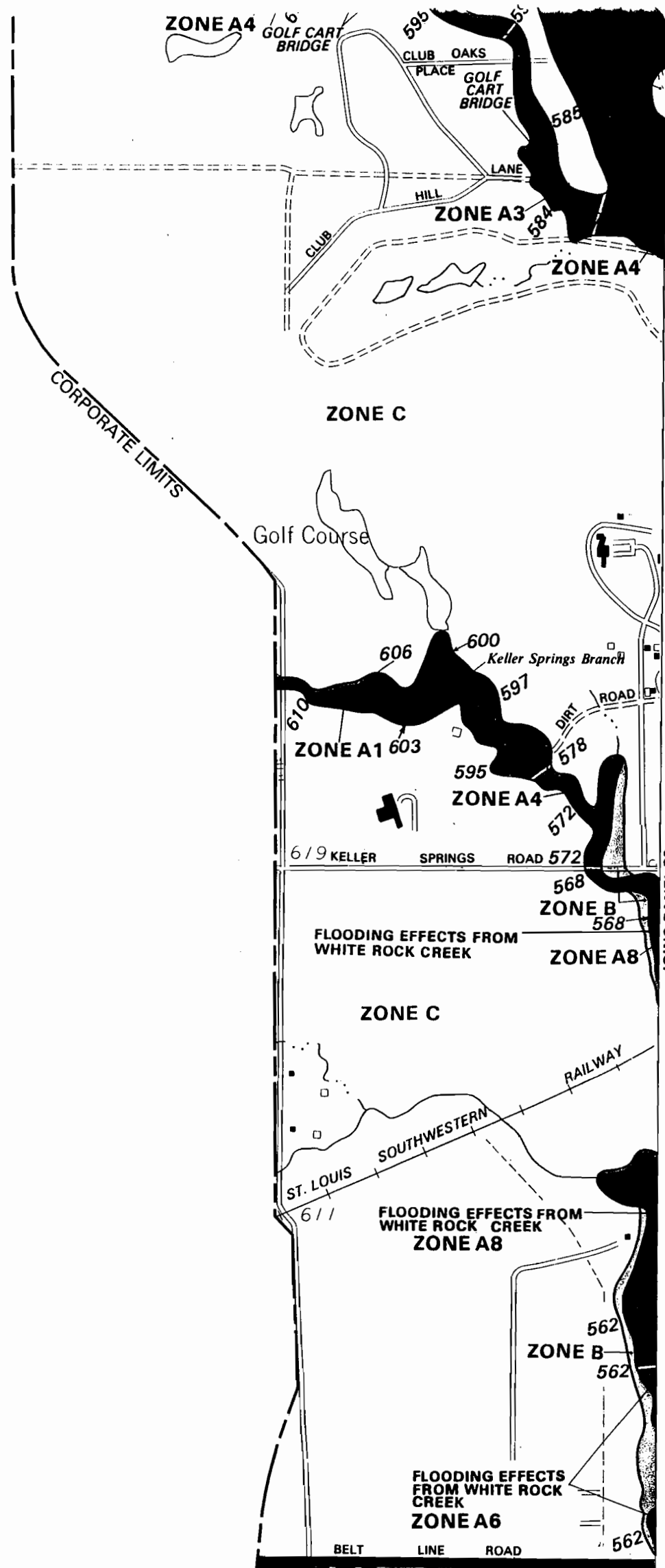

- ing with average depths less than one (1) foot or where the contributing drainage area is less than one square mile; or areas protected by levees from the base flood. (Medium shading)
- C** Areas of minimal flooding. (No shading)
- D** Areas of undetermined, but possible, flood hazards.
- V** Areas of 100-year coastal flood with velocity (wave action); base flood elevations and flood hazard factors not determined.
- V1-V30** Areas of 100-year coastal flood with velocity (wave action); base flood elevations and flood hazard factors determined.

NOTES TO USER

Certain areas not in the special flood hazard areas (zones A and V) may be protected by flood control structures.

This map is for flood insurance purposes only; it does not necessarily show all areas subject to flooding in the community or all planimetric features outside special flood hazard areas.

For adjoining map panels, see separately printed Index To Map Panels.

INITIAL IDENTIFICATION:
JANUARY 10, 1975

FLOOD HAZARD BOUNDARY MAP REVISIONS:
FEBRUARY 11, 1977
JULY 8, 1980

FLOOD INSURANCE RATE MAP EFFECTIVE:
MARCH 16, 1983

Refer to the FLOOD INSURANCE RATE MAP EFFECTIVE date shown on this map to determine when actuarial rates apply to structures in the zones where elevations or depths have been established.

To determine if flood insurance is available in this community, contact your insurance agent, or call the National Flood Insurance Program at (800) 638-6620.

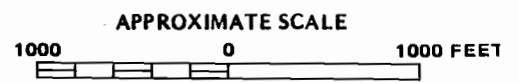

NATIONAL FLOOD INSURANCE PROGRAM

**FIRM
FLOOD INSURANCE RATE MAP**

**CITY OF
DALLAS, TEXAS
DALLAS, DENTON, COLLIN,
ROCKWALL AND KAUFMAN
COUNTIES**

PANEL 25 OF 235
(SEE MAP INDEX FOR PANELS NOT PRINTED)

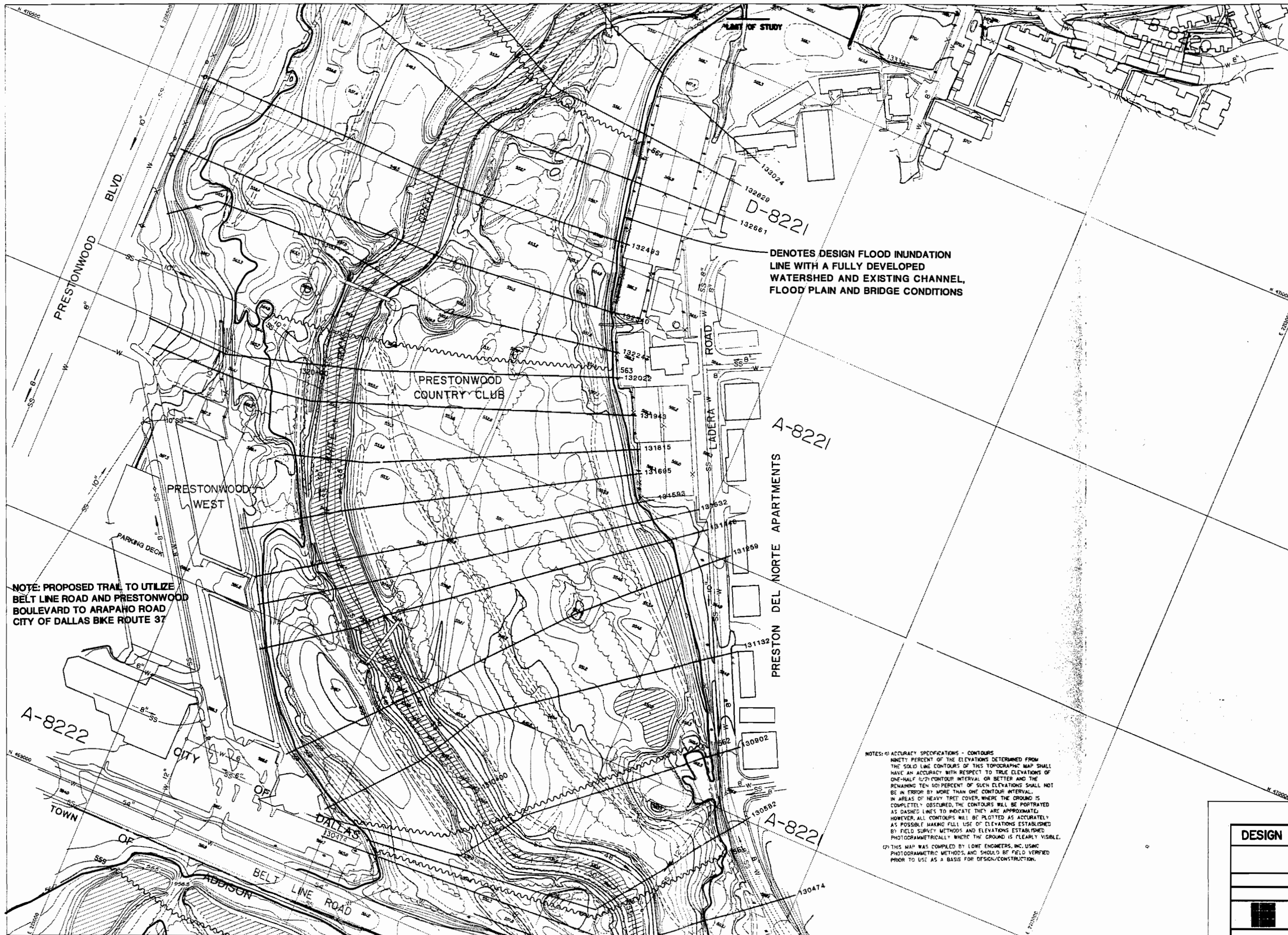

DENOTES DESIGN FLOOD INUNDATION LINE WITH A FULLY DEVELOPED WATERSHED AND EXISTING CHANNEL, FLOOD PLAIN AND BRIDGE CONDITIONS

NOTE: PROPOSED TRAIL TO UTILIZE BELT LINE ROAD AND PRESTONWOOD BOULEVARD TO ARAPAHO ROAD CITY OF DALLAS BIKE ROUTE 37

NOTES: (1) ACCURACY SPECIFICATIONS - CONTOURS
 (2) PERCENT OF THE ELEVATIONS DETERMINED FROM THE SOLID LINE CONTOURS OF THIS TOPOGRAPHIC MAP SHALL HAVE AN ACCURACY WITH RESPECT TO TRUE ELEVATIONS OF ONE-HALF (1/2) CONTOUR INTERVAL OR BETTER AND THE REMAINING TEN (10) PERCENT OF SUCH ELEVATIONS SHALL NOT BE IN ERROR BY MORE THAN ONE CONTOUR INTERVAL. IN AREAS OF HEAVY TREE COVER, WHERE THE GROUND IS COMPLETELY OBSCURED, THE CONTOURS WILL BE PORTRAYED AS DASHED LINES TO INDICATE THEY ARE APPROXIMATE. HOWEVER, ALL CONTOURS WILL BE PLOTTED AS ACCURATELY AS POSSIBLE MAKING FULL USE OF ELEVATIONS ESTABLISHED BY FIELD SURVEY METHODS AND ELEVATIONS ESTABLISHED PHOTOGRAMMETRICALLY WHERE THE GROUND IS CLEARLY VISIBLE.
 (3) THIS MAP WAS COMPILED BY LOWE ENGINEERS, INC. USING PHOTOGRAMMETRIC METHODS, AND SHOULD BE FIELD VERIFIED PRIOR TO USE AS A BASIS FOR DESIGN/CONSTRUCTION.

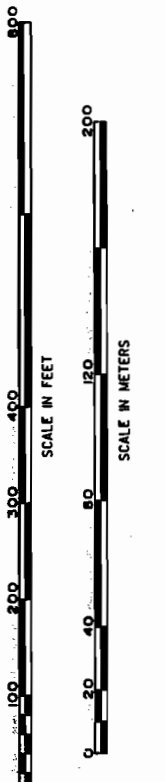

The Co-ordinate System Shown is Based on the TEXAS STATE CO-ORDINATE SYSTEM, North Central Zone
 CONTOUR INTERVAL ONE FOOT
 TOPOGRAPHY COMPILED BY PHOTOGRAMMETRIC METHODS FROM AERIAL PHOTOGRAPHS TAKEN FEBRUARY 26, 1966 BY LOWE ENGINEERS, INC.

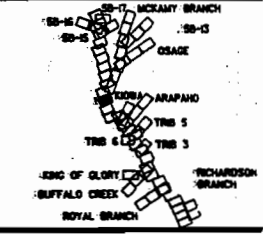

THE INFORMATION SHOWN WAS GENERATED USING COMPUTER AIDED DRAFTING/DESIGN TECHNIQUES.

DESIGN FLOOD INUNDATION LIMITS		
WHITE ROCK CREEK		
FLOOD PLAIN MANAGEMENT		
DALLAS, TEXAS		
ALBERT H. HALFF ASSOCIATES, INC. ENGINEERS • SCIENTISTS • SURVEYORS		
PLATE 4 - 20	DATE FEBRUARY 1988	FILE NO. 4210
		NO. 50



CITY OF DALLAS
DEPARTMENT OF PUBLIC WORKS

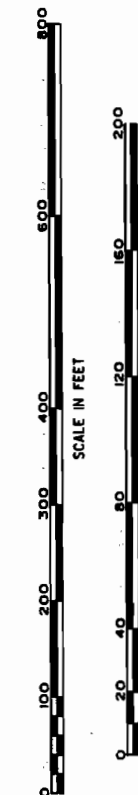

The Co-ordinate System Shown
is Based on the TEXAS STATE
CO-ORDINATE SYSTEM, North
Central Zone.
CONTOUR INTERVAL ONE FOOT
TOPOGRAPHY COMPILED BY PHOTOGRAMMETRY
METHODS FROM AERIAL PHOTOGRAPHS TAKEN
FEBRUARY 26, 1986 BY LOWE ENGINEERS, INC.

SEE PLATE 4-17

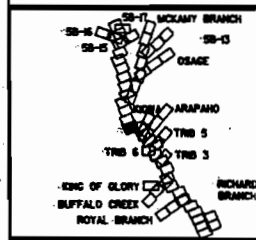

THE INFORMATION SHOWN WAS GENERATED
USING COMPUTER AIDED DRAFTING/DESIGN
TECHNIQUES.

DESIGN FLOOD INUNDATION LIMITS			
WHITE ROCK CREEK			
FLOOD PLAIN MANAGEMENT			
DALLAS, TEXAS			
ALBERT H. HALFF ASSOCIATES, INC. ENGINEERS • SCIENTISTS • SURVEYORS			
PLATE 4 - 18	DATE	FILE	NO.
	FEBRUARY 1988	4210	5

SEE PLATE 4-17

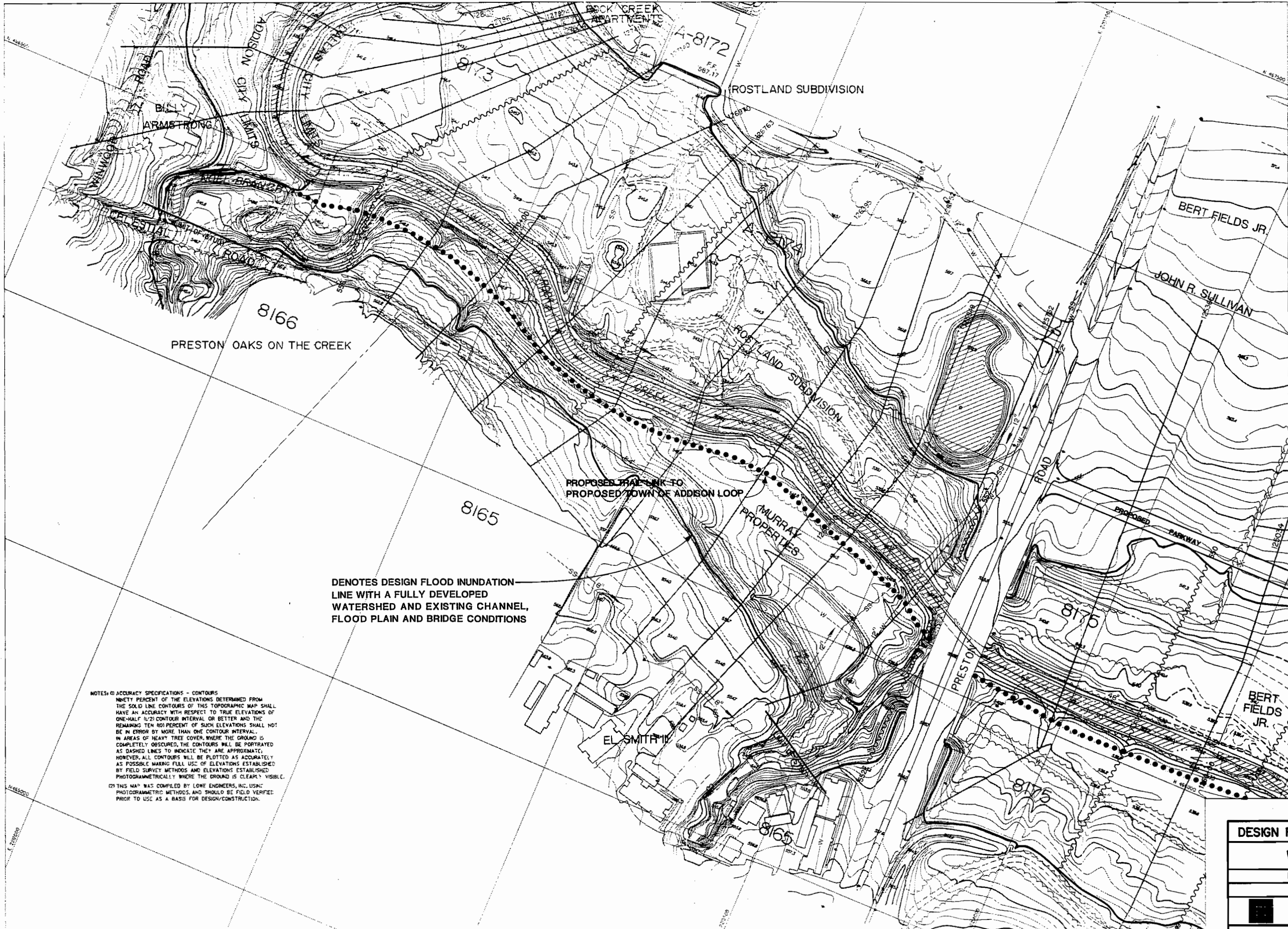

DENOTES DESIGN FLOOD INUNDATION
LINE WITH A FULLY DEVELOPED
WATERSHED AND EXISTING CHANNEL,
FLOOD PLAIN AND BRIDGE CONDITIONS

NOTES: ACCURACY SPECIFICATIONS - CONTOURS
NINETY PERCENT OF THE ELEVATIONS DETERMINED FROM
THE SOLID LINE CONTOURS OF THIS TOPOGRAPHIC MAP SHALL
HAVE AN ACCURACY WITH RESPECT TO TRUE ELEVATIONS OF
ONE-HALF (1/2) CONTOUR INTERVAL OR BETTER AND THE
REMAINING TEN PERCENT OF SUCH ELEVATIONS SHALL NOT
BE IN ERROR BY MORE THAN ONE CONTOUR INTERVAL.
IN AREAS OF HEAVY TREE COVER, WHERE THE GROUND IS
COMPLETELY OBSCURED, THE CONTOURS WILL BE PORTRAYED
AS DASHED LINES TO INDICATE THEY ARE APPROXIMATE.
HOWEVER, ALL CONTOURS WILL BE PLOTTED AS ACCURATELY
AS POSSIBLE MAKING FULL USE OF ELEVATIONS ESTABLISHED
BY FIELD SURVEY METHODS AND ELEVATIONS ESTABLISHED
PHOTOGRAMMETRICALLY WHERE THE GROUND IS CLEARLY VISIBLE.
THIS MAP WAS COMPILED BY LOWE ENGINEERS, INC. USING
PHOTOGRAMMETRIC METHODS, AND SHOULD BE FIELD VERIFIED
PRIOR TO USE AS A BASIS FOR DESIGN/CONSTRUCTION.



CITY OF DALLAS
DEPARTMENT OF PUBLIC WORKS

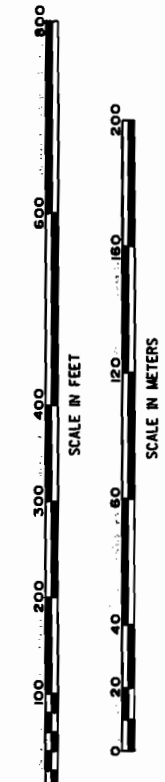

The Co-ordinate System shown is based on the TEXAS STATE CO-ORDINATE SYSTEM, North Central Zone.
CONTOUR INTERVAL ONE FOOT
TOPOGRAPHY COMPILED BY PHOTOGRAMMETRIC METHODS FROM AERIAL PHOTOGRAPHS BY FEBRUARY 25, 1966 BY LOWE ENGINEERS.

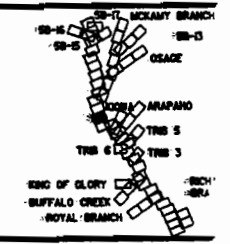

THE INFORMATION SHOWN WAS OBTAINED USING COMPUTER AIDED DRAFTING/DESIGN TECHNIQUES.

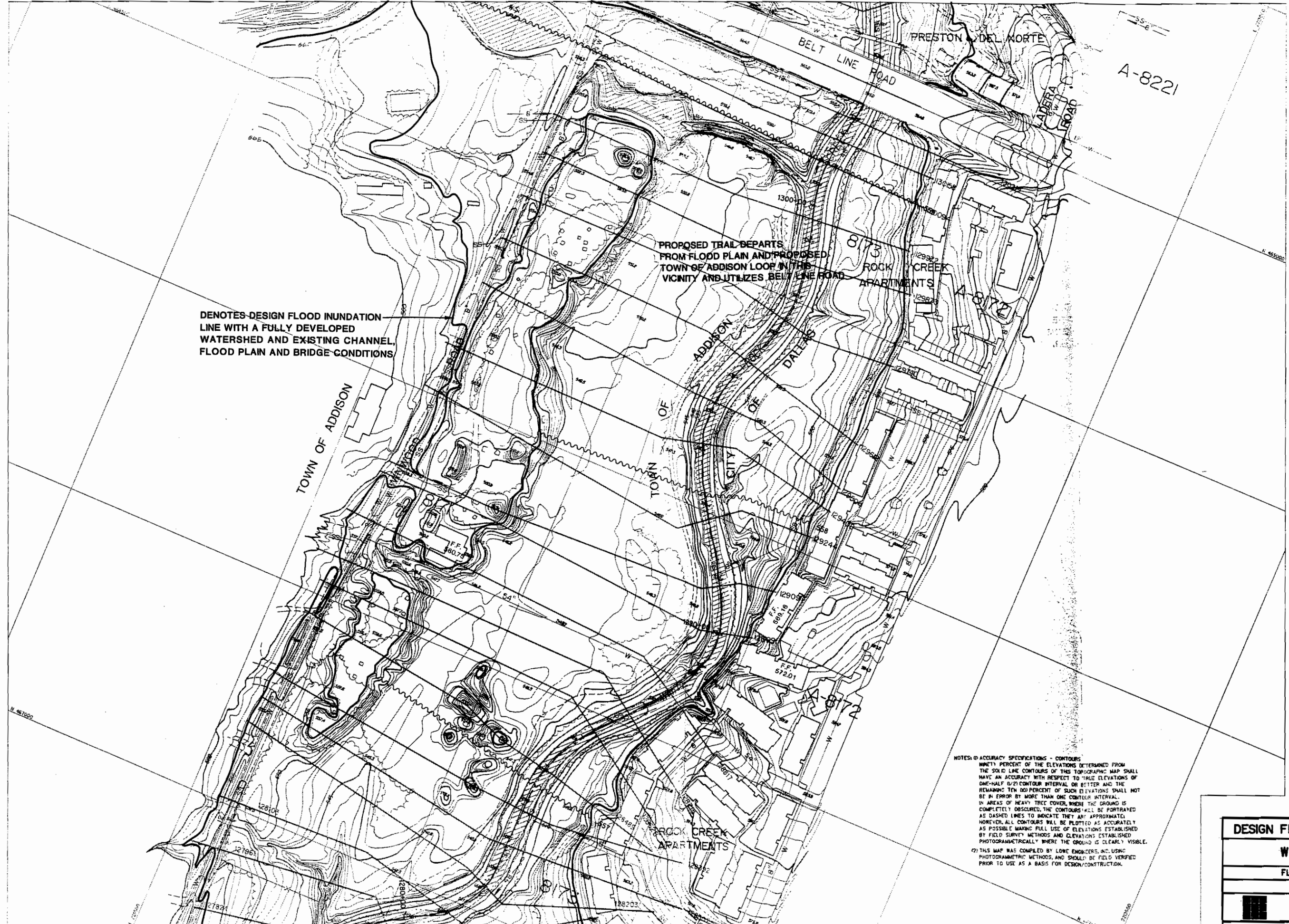

DENOTES DESIGN FLOOD INUNDATION LINE WITH A FULLY DEVELOPED WATERSHED AND EXISTING CHANNEL, FLOOD PLAIN AND BRIDGE CONDITIONS

PROPOSED TRAIL DEPARTS FROM FLOOD PLAIN AND PROPOSED TOWN OF ADDISON LOOP IN THIS VICINITY AND UTILIZES BELT LINE ROAD

NOTES: (1) ACCURACY SPECIFICATIONS - CONTOURS
NINETY PERCENT OF THE ELEVATIONS DETERMINED FROM THE SOLID LINE CONTOURS OF THIS TOPOGRAPHIC MAP SHALL HAVE AN ACCURACY WITH RESPECT TO TRUE ELEVATIONS OF ONE-HALF (1/2) CONTOUR INTERVAL OR BETTER AND THE REMAINING TEN PERCENT OF SUCH ELEVATIONS SHALL NOT BE IN ERROR BY MORE THAN ONE CONTOUR INTERVAL.
IN AREAS OF HEAVY TREE COVER, WHERE THE GROUND IS COMPLETELY OBLSCURED, THE CONTOURS WILL BE PORTRAYED AS DASHED LINES TO INDICATE THEY ARE APPROXIMATE. HOWEVER, ALL CONTOURS WILL BE PLOTTED AS ACCURATELY AS POSSIBLE MAKING FULL USE OF ELEVATIONS ESTABLISHED BY FIELD SURVEY METHODS AND ELEVATIONS ESTABLISHED PHOTOGRAMMETRICALLY WHERE THE GROUND IS CLEARLY VISIBLE.
(2) THIS MAP WAS COMPILED BY LOWE ENGINEERS, INC. USING PHOTOGRAMMETRIC METHODS, AND SHOULD BE FIELD VERIFIED PRIOR TO USE AS A BASIS FOR DESIGN/CONSTRUCTION.

DESIGN FLOOD INUNDATION LIMIT

WHITE ROCK CREEK

FLOOD PLAIN MANAGEMENT

DALLAS, TEXAS

ALBERT H. HALFF ASSOCIATES, INC.
ENGINEERS • SCIENTISTS • SURVEYORS

DATE	FILE
FEBRUARY 1988	421D

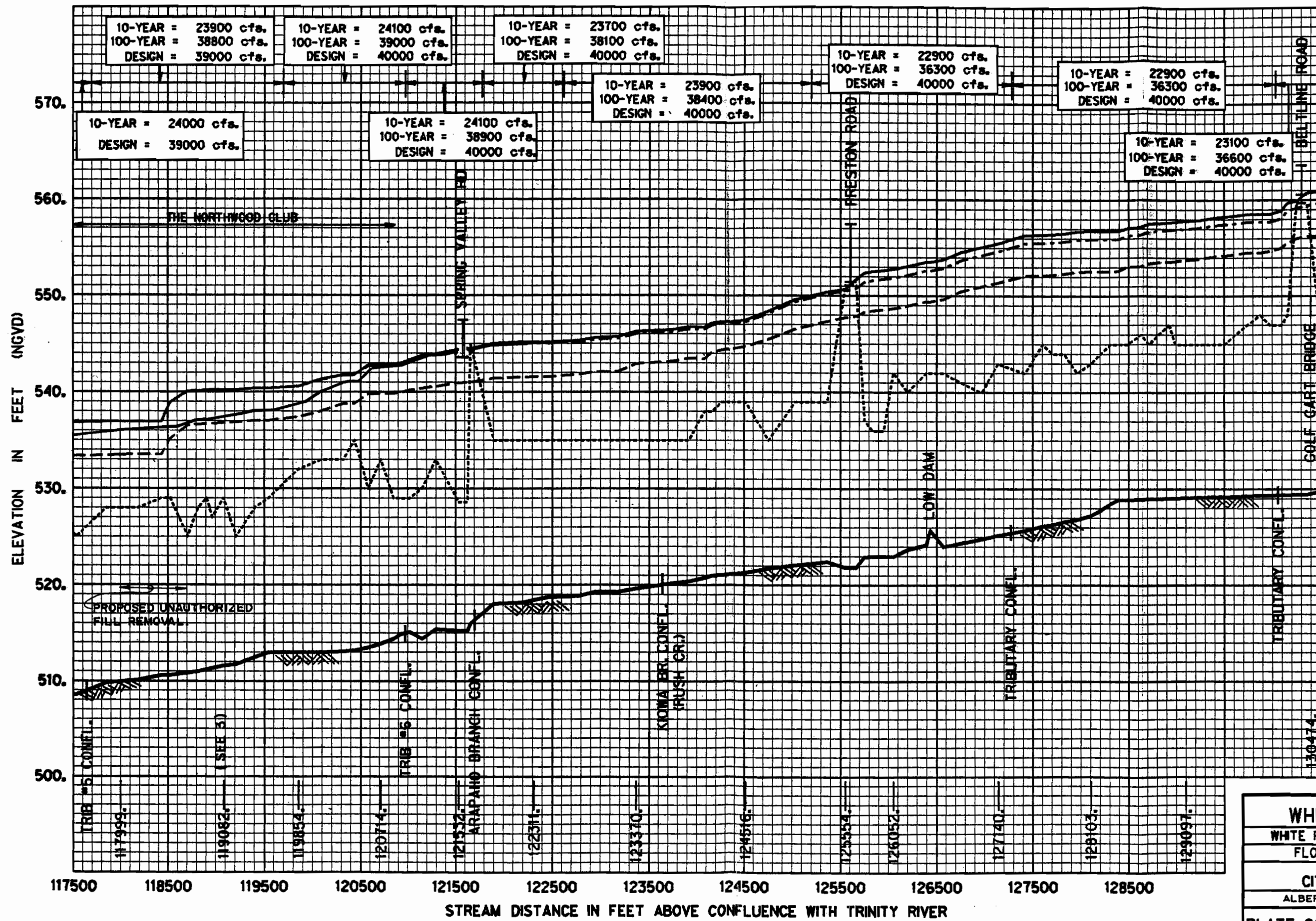

LEGEND

- BRIDGE
- CULVERT
- DESIGN FLOOD^(1,2)
- 100-YEAR FLOOD⁽²⁾
- 10-YEAR FLOOD⁽²⁾
- LOW BANK
- STREAM BED
- CROSS SECTION NAME (=STATION)
- DESIGN FLOOD, PROPOSED IMPROVEMENTS RECOMMENDED IN MANAGEMENT PLAN.

(1) Design Flood= Flood of Record (1964) on This Sheet.

(2) NOTE: PROFILE BASED ON EXISTING CHANNEL AND FLOODPLAIN CONDITIONS, FULLY DEVELOPED WATERSHED.

(3) NOTE: UNDER BASE CONDITIONS, SPLIT FLOW OCCURS FROM DOWNSTREAM OF ALPHA RD. (SECTION 1160+20) TO UPSTREAM OF CREEKSIDE DEVELOPMENT (SECTION 1190+82) APPROX. 6000 cfs IS DIVERTED FROM THE MAIN CHANNEL IN THIS REACH.

FLOOD PROFILES			
WHITE ROCK CREEK			
WHITE ROCK CREEK & TRIBUTARIES			
FLOOD PLAIN MANAGEMENT			
DEPARTMENT OF PUBLIC WORKS			
CITY OF DALLAS, TEXAS			
ALBERT H. HALFF ASSOCIATES, INC.			
PLATE 20-04	DATE	NOTES	FILE
	1989	8429 DHW/CE/EM	421D
			NO. 50

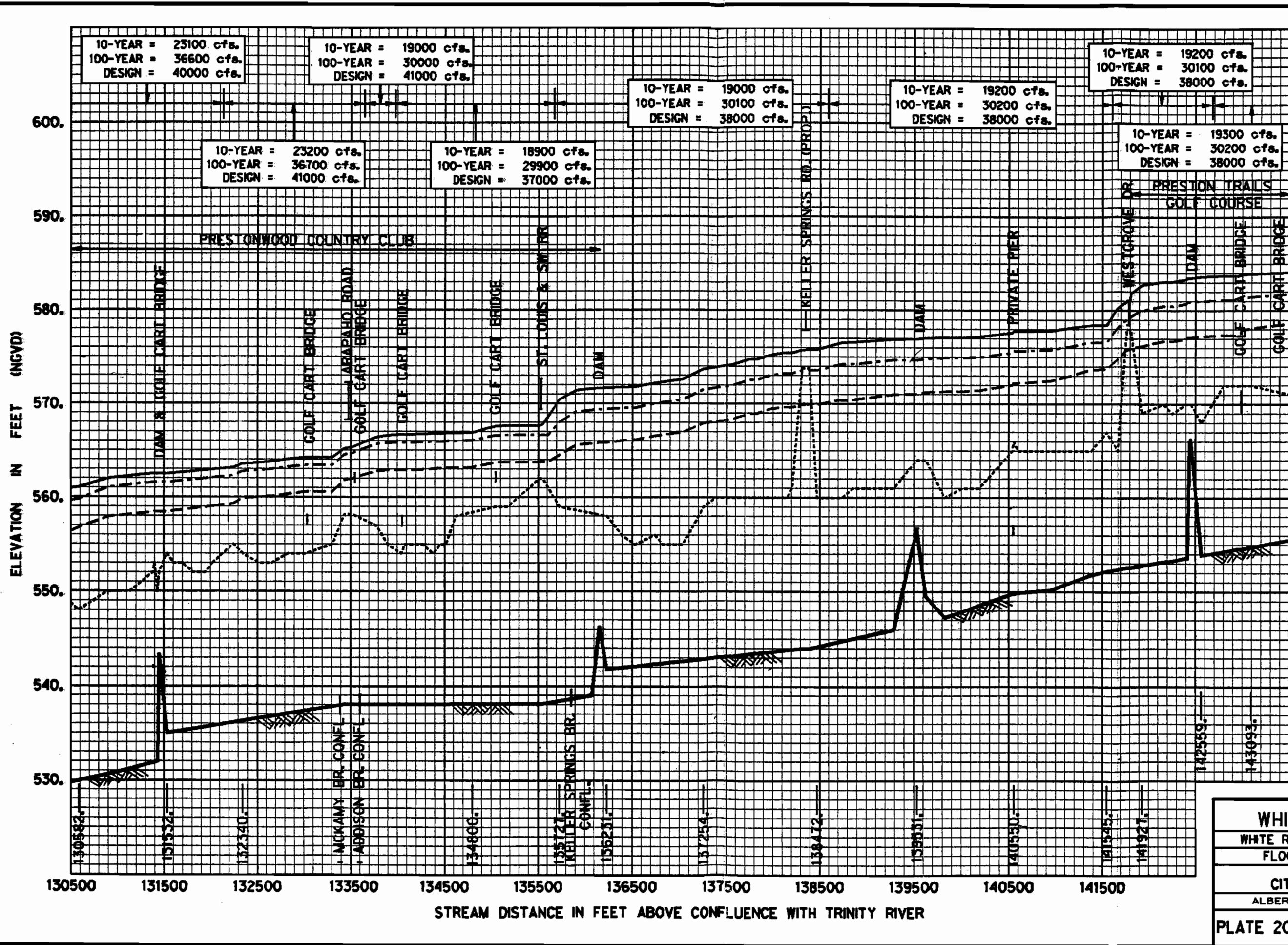

LEGEND

- BRIDGE
- CULVERT
- DESIGN FLOOD^(1,2)
- 100-YEAR FLOOD⁽²⁾
- 10-YEAR FLOOD⁽²⁾
- LOW BANK
- STREAM BED
- CROSS SECTION NAME (=STATION)

240'

(1) Design Flood= Flood of Record (1964) on This Sheet.

(2) NOTE: PROFILE BASED ON EXISTING CHANNEL AND FLOODPLAIN CONDITIONS, FULLY DEVELOPED WATERSHED.

FLOOD PROFILES			
WHITE ROCK CREEK			
WHITE ROCK CREEK & TRIBUTARIES			
FLOOD PLAIN MANAGEMENT			
DEPARTMENT OF PUBLIC WORKS			
CITY OF DALLAS, TEXAS			
ALBERT H. HALFF ASSOCIATES, INC.			
PLATE 20-05	DATE	NOTES	FILE NO.
	1989	8429 PRINCEPDM	421D 50

Scale: 1" = 50'
April 13, 1981

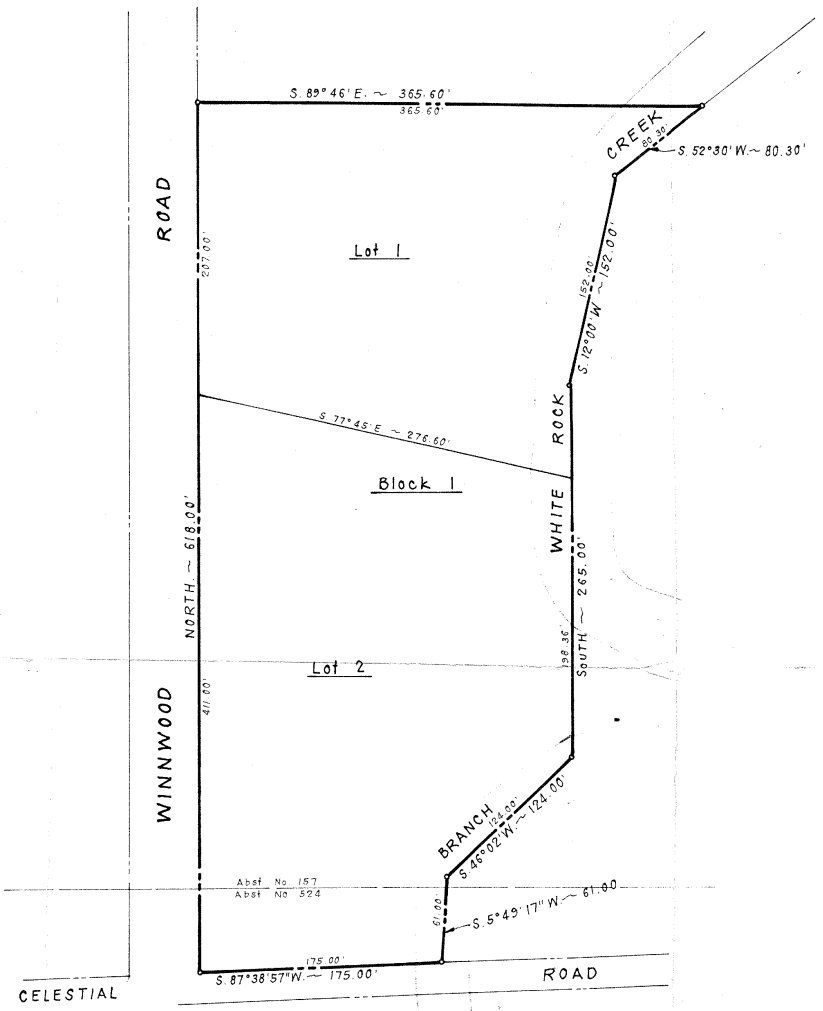

11-13-81
 TALKED W/ NATHAN AGAIN - HE IS TO SEND A COPY OF F.P. CRITERIA TO BE MET - ALSO WILL SEND A COPY OF ANY CORRESPONDENCE W/ WILLIAM BAKER -
 AT THE TIME BAKER REQUESTS BUILDING PERMIT, ASK HIM TO SUBMIT SITE PLAN SHOWING FULL AREAS & NEW CORNERS TO DALLAS THEN ASK THEM TO WRITE A LETTER OF APPROVAL

OWNERS CERTIFICATE

STATE OF TEXAS
 COUNTY OF DALLAS

WHEREAS, Charles Ray Allen and wife Georgia Ann Allen are the owners of a tract of land situated in the A. Bledsoe Survey, Abstract No. 157, and the Thomas Garvin Survey, Abstract No. 524, City of Addison, Dallas County, Texas and being more particularly described as follows:

BEGINNING at the intersection of the North line of Celestial Road, and the East line of Winwood Road, an iron stake for corner;
 THENCE North along the East line of Winwood Road, 618.00 feet to a rod by old post found for corner;
 THENCE S 89°46'E, with general line of old crooked wire fence part of way, passing the High Bank of White Rock Creek in all a distance of 365.6 feet to a point in the center of said White Rock Creek;
 THENCE S 55°30'W, along center of said creek, 80.3 feet to a point for corner;
 THENCE S 12°00'W, along center of said creek, 152.00 feet to a point for corner;
 THENCE South and leaving said creek at distance of 149.2 feet and continuing and entering Branch and in all a distance of 265.00 feet to point for corner in center of said Branch;
 THENCE S 46°02'W, 124.00 feet to a point in center of said Branch;
 THENCE S 59°47'W, 61.00 feet to a point in the North line of said Celestial Road, a point for corner;
 THENCE S 87°38'57"W, along the North line of said Celestial Road, 175.00 feet to the point of beginning and containing 3.71 acres of land.

NOW THEREFORE, KNOW ALL MEN BY THESE PRESENTS:

That we, Charles Ray Allen and wife, Georgia Ann Allen, do hereby adopt this plat designating the hereinabove described property as CHARLES RAY ALLEN ADDITION, an addition to the City of Addison, Dallas County, Texas.

WITNESS MY HAND AT DALLAS, TEXAS, this the 30th day of April 1981
 Charles Ray Allen, Owner
 Georgia Ann Allen, Owner

STATE OF TEXAS
 COUNTY OF DALLAS

BEFORE me the undersigned authority, a Notary Public in and for said county and state, on this date personally appeared Charles Ray Allen and Georgia Ann Allen, known to me to be the persons whose names subscribed to the foregoing instrument and acknowledged to me that they executed the same for the purpose and consideration herein expressed.

GIVEN UNDER MY HAND AND SEAL OF OFFICE THIS THE 30th day of April 1981.

SURVEYOR'S CERTIFICATE

KNOW ALL MEN BY THESE PRESENTS:

That I, Raeburn A. White, do hereby certify that I prepared this plat from an actual and accurate survey of the land and that the corner monuments shown thereon were properly placed under my personal supervision in accordance with the platting rules and regulations of the City Plan Commission of the City of Addison.

Raeburn A. White, Registered Public Surveyor

STATE OF TEXAS
 COUNTY OF DALLAS

BEFORE me, the undersigned, a Notary Public in and for said County and State on this day personally appeared Raeburn A. White, known to me to be the person whose name is subscribed to the foregoing instrument and acknowledged to me that he executed the same for the purpose and consideration therein expressed and in the capacity therein stated.

GIVEN under my hand and seal of office this the 16 day of April 1981.

Notary Public in and for Dallas County, Texas

This plat approved subject to all rules, regulations and platting ordinances of the City of Addison, Texas.

The day of _____, 1981.

ATTEST

City Secretary _____ Mayor _____

FINAL PLAT
 CHARLES RAY ALLEN ADDITION
 ADDISION, TEXAS

CHARLES RAY ALLEN ~ OWNER
 2571 VALLEY VIEW LANE DALLAS, TEXAS 75234

RAEBURN A. WHITE SURVEYOR
 2801 OLD ORCHARD ROAD GARLAND, TEXAS 75041

Block 1 TOTAL = 3.71 ACRES

KEY TO MAP

100-Year Flood Boundary
 Zone Designation With
 Effective Date
 100-Year Flood Boundary
 500-Year Flood Boundary
 Base Flood Elevation Line
 With Elevation in Feet**

(Elev. 897)
 RM/ X
 • M/1.5

Elevation Reference Mark

Strip Mile

***EXPLANATION OF ZONE DESIGNATIONS**

**Referenced to the National Geodetic Vertical Datum of 1929

EXPLANATION

A Areas of 100-year flood; sea level elevation, and flood hazard factors not determined.

AO Areas of 100-year flood; sea level elevation, and flood hazard factors not determined; where average annual exceedance probability is less than 1 percent.

AH Areas of 100-year flood; sea level elevation, and flood hazard factors not determined; where average annual exceedance probability is less than 1 percent.

A1-A3B Areas of 100-year flood; sea level elevation, and flood hazard factors not determined; where average annual exceedance probability is less than 1 percent.

AOB Areas of 100-year flood; sea level elevation, and flood hazard factors not determined; where average annual exceedance probability is less than 1 percent.

B Areas of 500-year flood; sea level elevation, and flood hazard factors not determined.

C Areas of 100-year flood; sea level elevation, and flood hazard factors not determined; where average annual exceedance probability is less than 1 percent.

V Areas of 100-year flood; sea level elevation, and flood hazard factors not determined; where average annual exceedance probability is less than 1 percent.

V1-V99 Areas of 100-year flood; sea level elevation, and flood hazard factors not determined; where average annual exceedance probability is less than 1 percent.

NOTES TO USER

Areas shown on this map are for informational purposes only. This map is for flood insurance purposes only. It does not constitute an offer of insurance. For more information on the community or for additional map products, see separate printed maps to map panels.

INITIAL IDENTIFICATION

FLOOD HAZARD BOUNDARY MAP REVISIONS

FLOOD INSURANCE RATE MAP EFFECTIVE

FLOOD INSURANCE RATE MAP REVISIONS

Refer to the FLOOD INSURANCE RATE MAP EFFECTIVE sheet of this map to determine when seasonal rates apply to this map. This map is for informational purposes only. It does not constitute an offer of insurance. For more information on the community or for additional map products, see separate printed maps to map panels.

Refer to the FLOOD INSURANCE RATE MAP EFFECTIVE sheet of this map to determine when seasonal rates apply to this map. This map is for informational purposes only. It does not constitute an offer of insurance. For more information on the community or for additional map products, see separate printed maps to map panels.

Refer to the FLOOD INSURANCE RATE MAP EFFECTIVE sheet of this map to determine when seasonal rates apply to this map. This map is for informational purposes only. It does not constitute an offer of insurance. For more information on the community or for additional map products, see separate printed maps to map panels.

Refer to the FLOOD INSURANCE RATE MAP EFFECTIVE sheet of this map to determine when seasonal rates apply to this map. This map is for informational purposes only. It does not constitute an offer of insurance. For more information on the community or for additional map products, see separate printed maps to map panels.

Refer to the FLOOD INSURANCE RATE MAP EFFECTIVE sheet of this map to determine when seasonal rates apply to this map. This map is for informational purposes only. It does not constitute an offer of insurance. For more information on the community or for additional map products, see separate printed maps to map panels.

Refer to the FLOOD INSURANCE RATE MAP EFFECTIVE sheet of this map to determine when seasonal rates apply to this map. This map is for informational purposes only. It does not constitute an offer of insurance. For more information on the community or for additional map products, see separate printed maps to map panels.

Refer to the FLOOD INSURANCE RATE MAP EFFECTIVE sheet of this map to determine when seasonal rates apply to this map. This map is for informational purposes only. It does not constitute an offer of insurance. For more information on the community or for additional map products, see separate printed maps to map panels.

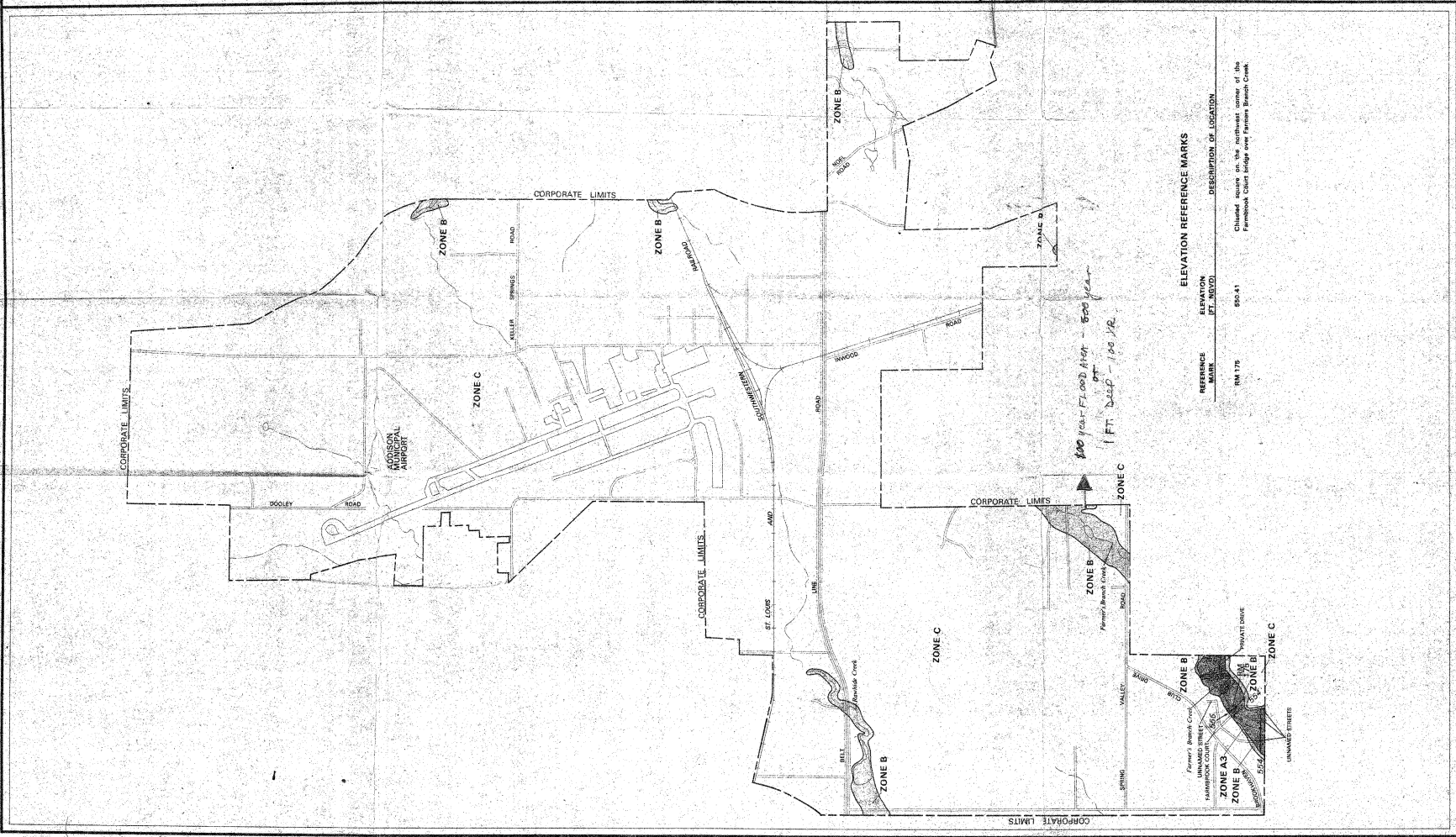

ELEVATION REFERENCE MARKS

REFERENCE MARK	ELEVATION IN FEET, MUDON	DESCRIPTION OF LOCATION
RM 775	950.41	Chained source on the southeast corner of the Facebook Club's bridge over Farmer's Branch Creek

100 Year Flood Area - 500 Year Flood
 1 FT. DEEP - 100 YR.

ADDISON AIRPORT

FARMER'S BRANCH CREEK

FARMER'S BRANCH DAM

FARMER'S BRANCH CREEK BRIDGE

VALLEY ROAD

UNPAVED STREETS

NATIONAL FLOOD INSURANCE PROGRAM

FIRM FLOOD INSURANCE RATE MAP

CITY OF ADDISON, TEXAS DALLAS COUNTY

ONLY PANEL PRINTED

PRELIMINARY

COMMUNITY PANEL NUMBER 481085 0005

EFFECTIVE DATE: MAR 08 1979

U.S. DEPARTMENT OF HOUSING AND URBAN DEVELOPMENT FEDERAL INSURANCE ADMINISTRATION

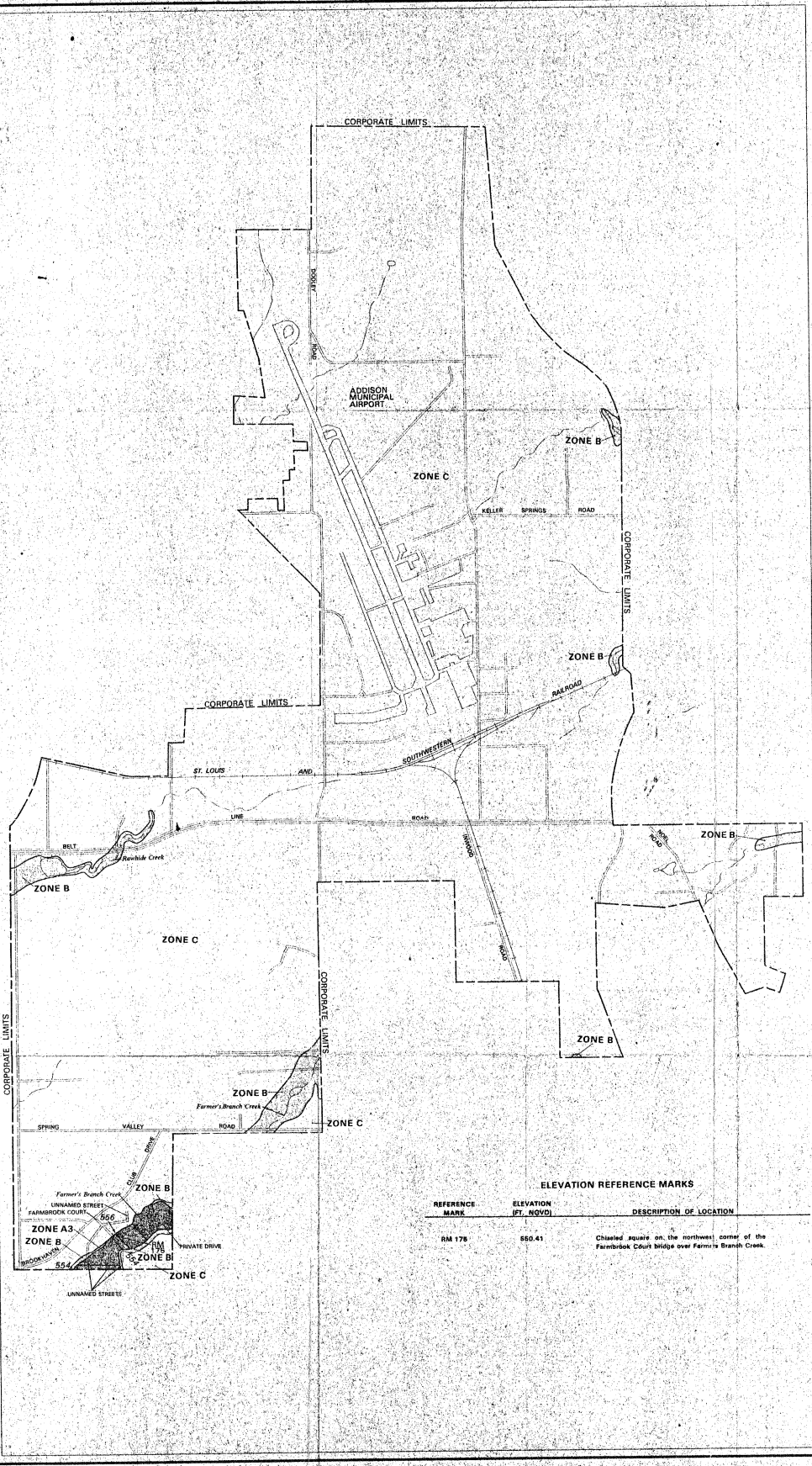

KEY TO MAP

- 500-Year Flood Boundary
- 100-Year Flood Boundary
- Zone Designations* With Date of Identification
e.g., 12/2774
- 100-Year Flood Boundary
- 500-Year Flood Boundary
- Base Flood Elevation Line With Elevation in Feet**
- Base Flood Elevation in Feet Where Uniform Within Zone** (EL 987)
- Elevation Reference Mark RM7
- River Mile M1.5

**Referenced to the National Geodetic Vertical Datum of 1929

***EXPLANATION OF ZONE DESIGNATIONS**

EXPLANATION

ZONE

- A** Areas of 100-year floods; base flood elevations and flood hazard factors not determined.
- A0** Areas of 100-year shallow flooding where depths are between one (1) and three (3) feet; average depths of inundation are shown, but no flood hazard factors are determined.
- A1** Areas of 100-year shallow flooding where depths are between one (1) and three (3) feet; base flood elevations are shown, but no flood hazard factors are determined.
- A1-A30** Areas of 100-year floods; base flood elevations and flood hazard factors determined.
- A99** Areas of 100-year flood to be protected by flood protection where under construction; base flood elevations and flood hazard factors not determined.
- B** Areas between limits of the 100-year flood and 500-year flood or certain areas subject to 100-year flooding with average depths less than one (1) foot or where the contributing drainage area is less than one square mile; all areas protected by levees from the base flood. (Medium shading)
- C** Areas of undetermined, but possible, flood hazards.
- D** Areas of undetermined, but possible, flood hazards.
- V** Areas of 100-year coastal flood with velocity (wave action); base flood elevations and flood hazard factors not determined.
- V1-V30** Areas of 100-year coastal flood with velocity (wave action); base flood elevations and flood hazard factors determined.

NOTES TO USER

Certain areas not in the special flood hazard areas (zones A and V) may be protected by flood control structures.

This map is for flood insurance purposes only; it does not necessarily show all areas subject to flooding in the community or all planimetric features outside special flood hazard areas.

For adjoining map panels, see separately printed Index To Map Panels.

INITIAL IDENTIFICATION

FLOOD HAZARD BOUNDARY MAP REVISIONS:

FLOOD INSURANCE RATE MAP EFFECTIVE:

FLOOD INSURANCE RATE MAP REVISIONS:

Refer to the FLOOD INSURANCE RATE MAP EFFECTIVE date shown on this map to determine what special flood hazard areas apply to structures in the zones where elevations or depths have been established.

To determine if flood insurance is available in the community, contact your insurance agent, or call the National Flood Insurance Program, at (800) 678-6620, or (504) 224-5877.

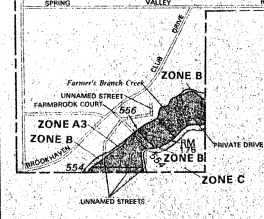

ELEVATION REFERENCE MARKS

REFERENCE MARK	ELEVATION (FT. NGVD)	DESCRIPTION OF LOCATION
RM 176	880.41	Chiseled square on the northwest corner of the Farmbrook Court bridge over Farmer's Branch Creek.

NATIONAL FLOOD INSURANCE PROGRAM

FIRM
FLOOD INSURANCE RATE MAP

CITY OF
ADDISON, TEXAS
DALLAS COUNTY

ONLY PANEL PRINTED

PRELIMINARY

COMMUNITY-PANEL NUMBER
481085 0005

EFFECTIVE DATE:
MAR 08 1979

U.S. DEPARTMENT OF HOUSING AND URBAN DEVELOPMENT
FEDERAL INSURANCE ADMINISTRATION

KEY TO MAP

SPECIAL FLOOD HAZARD AREA

ZONE A

Note: These maps may not include all Special Flood Hazard Areas. Special Flood Hazard Areas shown on these maps may be modified, and other areas added.

FOR EXTENSIVE FLOOD INSURANCE INFORMATION IN THIS COMMUNITY, CONTACT YOUR INSURANCE AGENT, OR CALL THE NATIONAL FLOOD INSURANCE PROGRAM, AT (800) 338-6820, OR (800) 445-8671.

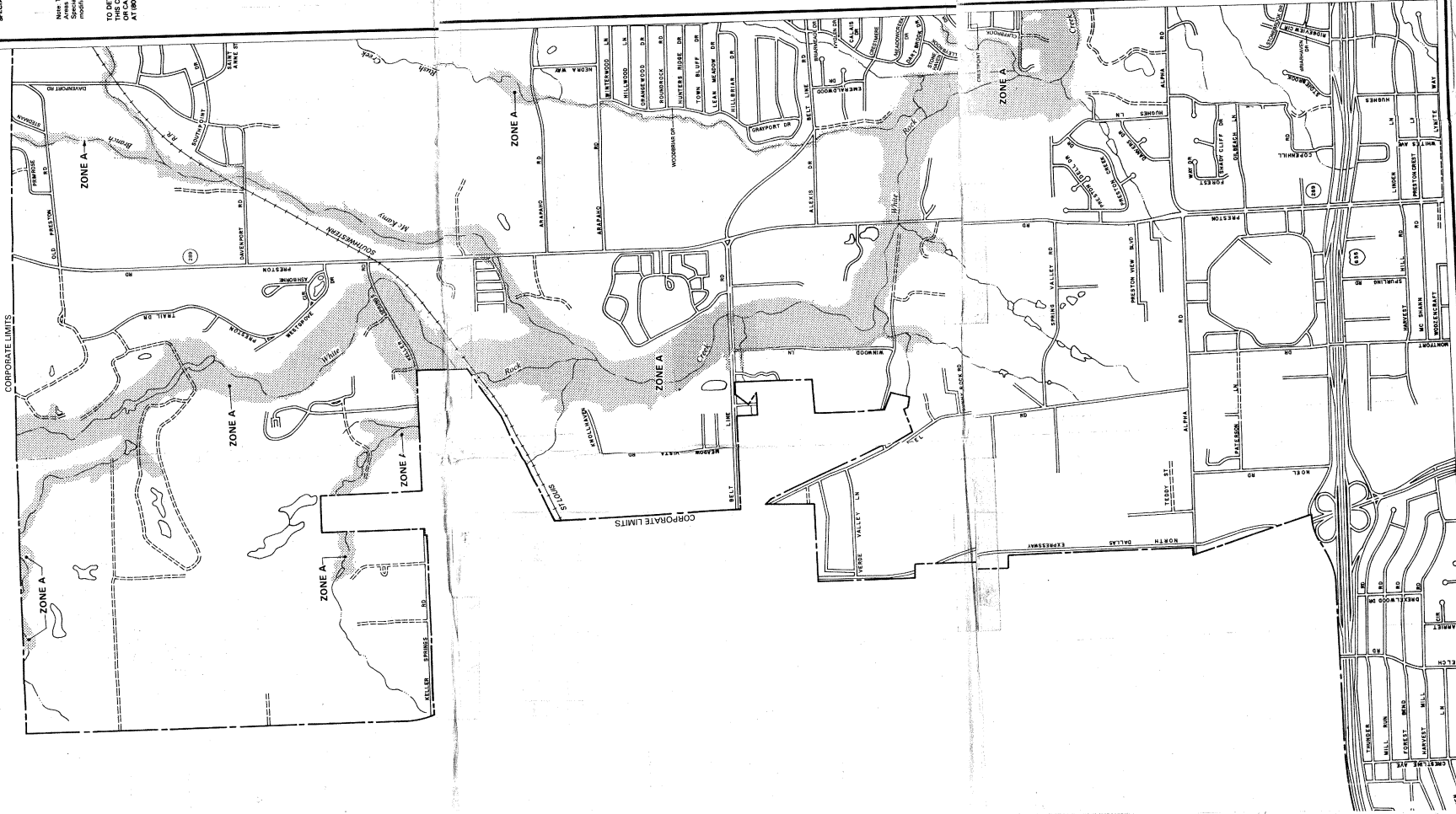

NATIONAL FLOOD INSURANCE PROGRAM

FHBM
FLOOD HAZARD BOUNDARY MAP
 CITY OF
DALLAS,
TEXAS
 DALLAS COUNTY

PANEL 2 OF 21
SEE MAP INDEX FOR PANELS NOT PRINTED

COMMUNITY-PANEL NUMBER
480171.0002

MAP REVISION
JULY 8, 1991



U.S. DEPARTMENT OF HOUSING AND URBAN DEVELOPMENT
FEDERAL HOUSING ADMINISTRATION

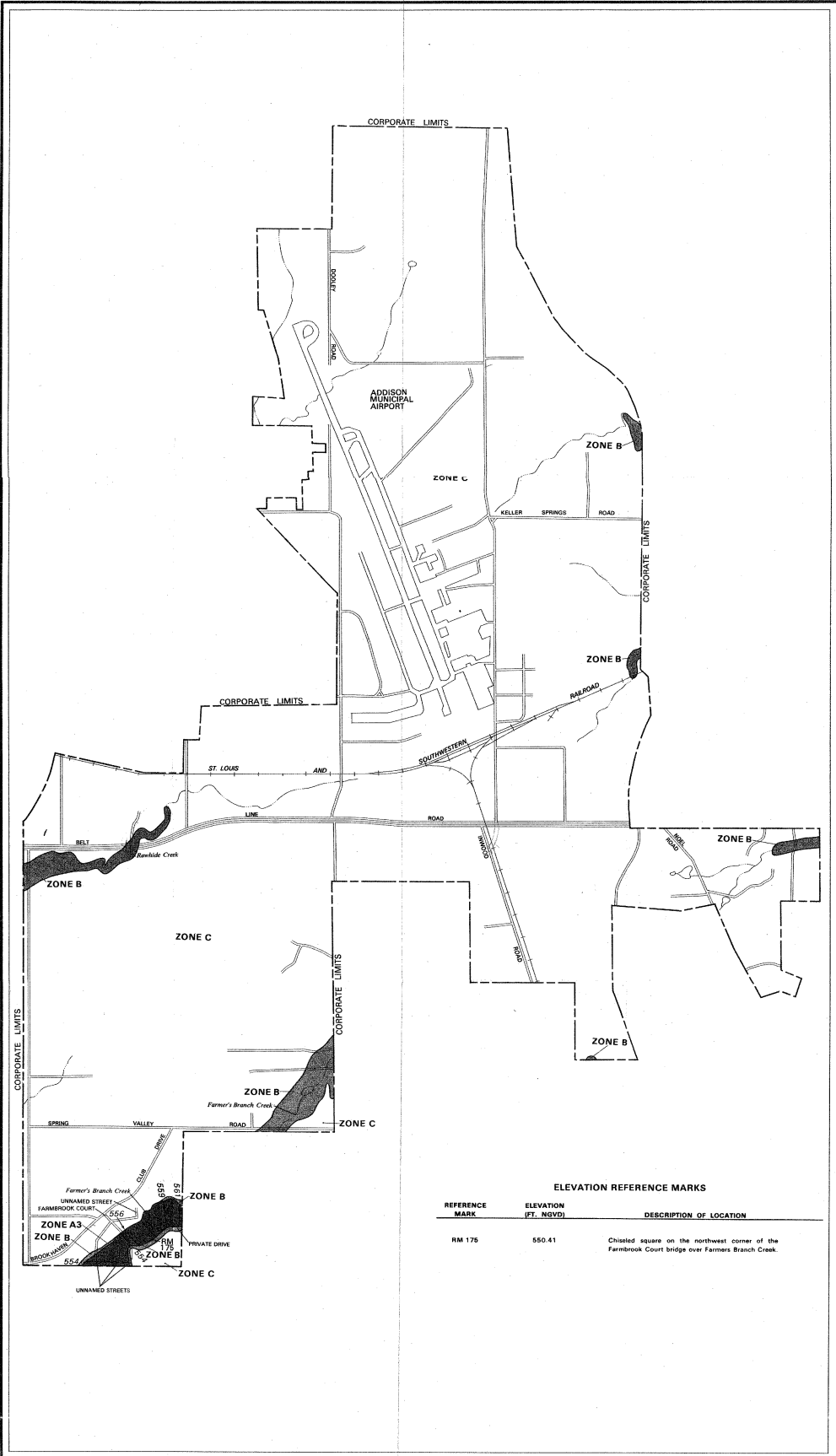

KEY TO MAP

500-Year Flood Boundary ————

100-Year Flood Boundary ————

Zone Delineations* With Date of Identification e.g. 1/2/74

100-Year Flood Boundary ————

500-Year Flood Boundary ————

Base Flood Elevation Line With Elevation in Feet**

Base Flood Elevation in Feet Where Uniform Within Zone** (EL 987)

Elevation Reference Mark RM7x

River Mile •M1.5

**Referenced to the National Geodetic Vertical Datum of 1929

***EXPLANATION OF ZONE DESIGNATIONS**

ZONE EXPLANATION

A Areas of 100-year flood; base flood elevations and flood hazard factors not determined.

AD Areas of 100-year shallow flooding where depths are between one (1) and three (3) feet; average depths of inundation are shown, but no flood hazard factors are determined.

AH Areas of 100-year shallow flooding where depths are between one (1) and three (3) feet; base flood elevations are shown, but no flood hazard factors are determined.

A1-A3D Areas of 100-year flood; base flood elevations and flood hazard factors determined.

ABB Areas of 100-year flood to be protected by flood protection system under construction; base flood elevations and flood hazard factors not determined.

B Areas between limits of the 100-year flood and 200-year flood; or certain areas subject to 100-year flooding with average depths less than one (1) foot or where the contributing drainage area is less than one square mile; or areas protected by levees from the base flood. (Medium shading)

C Areas of minimal flooding. (No shading)

D Areas of undetermined, but possible, flood hazards.

V Areas of 100-year coastal flood with velocity (wave action); base flood elevations and flood hazard factors not determined.

V1-V3D Areas of 100-year coastal flood with velocity (wave action); base flood elevations and flood hazard factors determined.

NOTES TO USER

Certain areas not in the special flood hazard areas (zones A and V) may be protected by flood control structures.

This map is for flood insurance purposes only; it does not necessarily show all areas subject to flooding in the community or all planimetric features outside special flood hazard areas.

INITIAL IDENTIFICATION:
OCTOBER 25, 1976

FLOOD INSURANCE RATE MAP EFFECTIVE:
JULY 16, 1980

Refer to the FLOOD INSURANCE RATE MAP EFFECTIVE date shown on this map to determine when actuarial rates apply to structures in the zones where elevations or depths have been established.

To determine if flood insurance is available in this community, contact your insurance agent, or call the National Flood Insurance Program, at (800) 638-6620, or (800) 424-8872.



ELEVATION REFERENCE MARKS

REFERENCE MARK	ELEVATION (FT. NGVD)	DESCRIPTION OF LOCATION
RM 175	550.41	Chiseled square on the northwest corner of the Farmbrook Court bridge over Farmers Branch Creek.

NATIONAL FLOOD INSURANCE PROGRAM

FIRM FLOOD INSURANCE RATE MAP

CITY OF ADDISON, TEXAS DALLAS COUNTY

ONLY PANEL PRINTED

REC. W/FEMA
LVL. OF 4-15-81

COMMUNITY-PANEL NUMBER 481087 0005 A

EFFECTIVE DATE: JULY 16, 1980

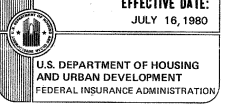

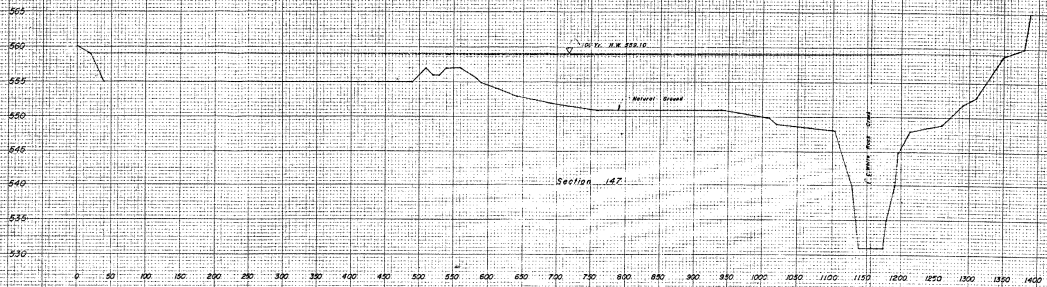

7

CREEK CROSS-SECTION					
OAK BEND ESTATES					
ENGINEERS WILLARD BAKER & LAWRENCE BROOKS					
MUTTY-ZOLLARS, Consulting Engineers					
CITY OF DALLAS, TEXAS					
DESIGN DRAWN	DATE	SCALE	NOTES	FILE	NO.
H.W.	JAN	6-79			
NO. 50					

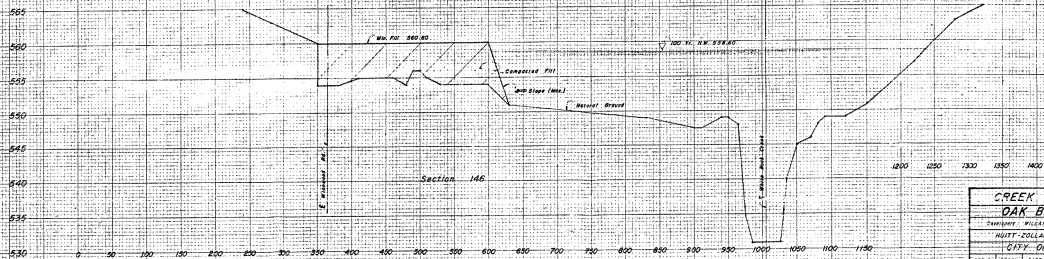
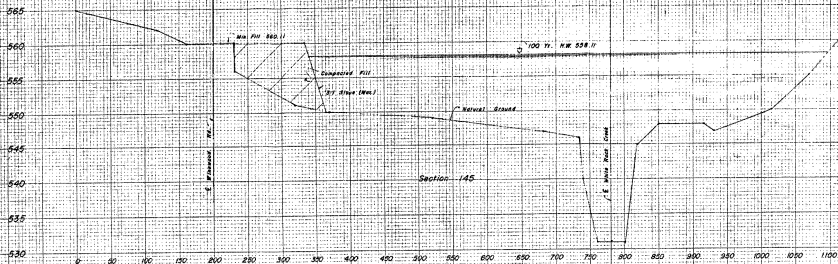

CREEK CROSS-SECTION					
OAK BEND ESTATES					
ENGINEERS: WILLARD BAUER AND LARRY BRIDGES					
CITY OF DALLAS, Consulting Engineers					
CITY OF DALLAS, TEXAS					
SECTION	DATE	SCALE	NOTES	FILE	NO.
N-2	1.18.	1:15'	11/17/51		

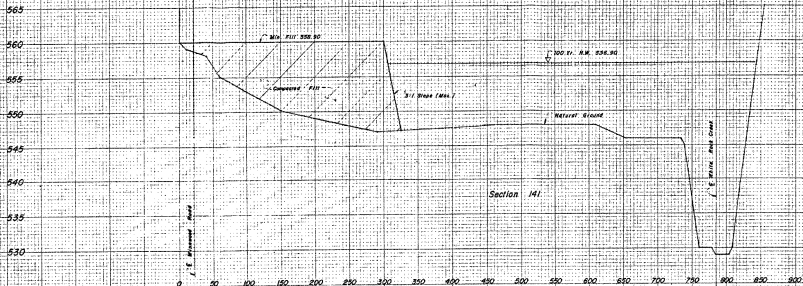

Section 141

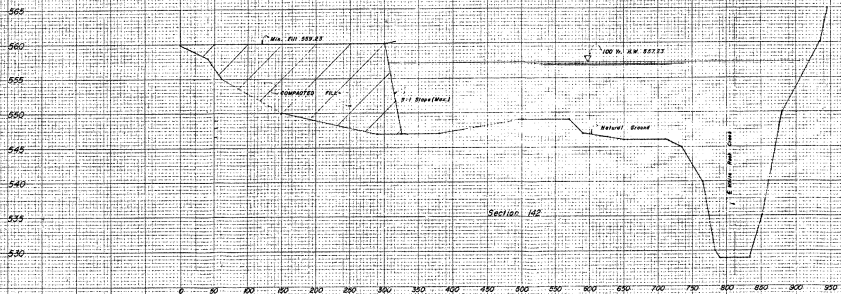

Section 142



CREEK CROSS-SECTION					
OAK BEND ESTATES					
DORVIN WILLARD BAKER AND COMPANY ENGINEERS					
MURTY DOLLARD, Consulting Engineer					
CITY OF DALLAS, TEXAS					
FIELD DRAWN	DATE	SCALE	NOTES	FILE	NO.
A-Z	JAN. 8/27	8/16"			

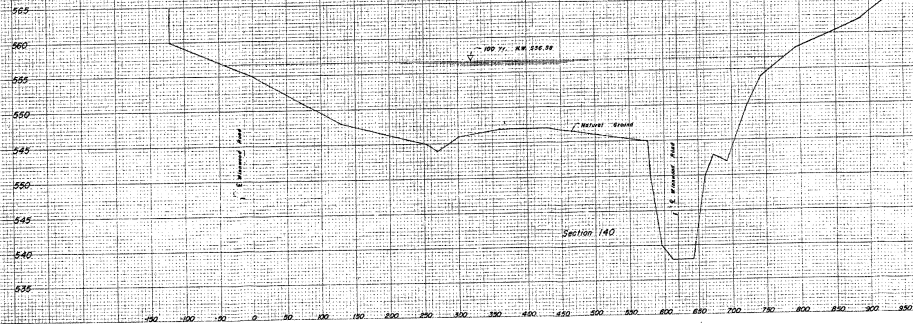
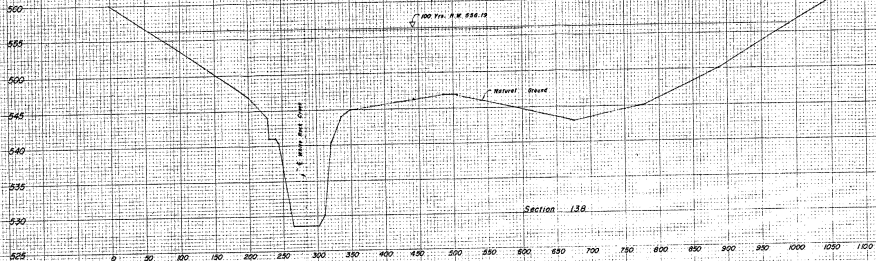

3
7

CREEK CROSS-SECTION					
OAK BEND ESTATES					
DRAWING: WILLARD BAKER AND LOUANE BRIDGES					
MULTY-COLLARS, CONSULTING ENGINEERS					
CITY OF DALLAS, TEXAS					
SECTION	DATE	SCALE	WORKS	FILE	NO.
140	4.24	VERTICAL			

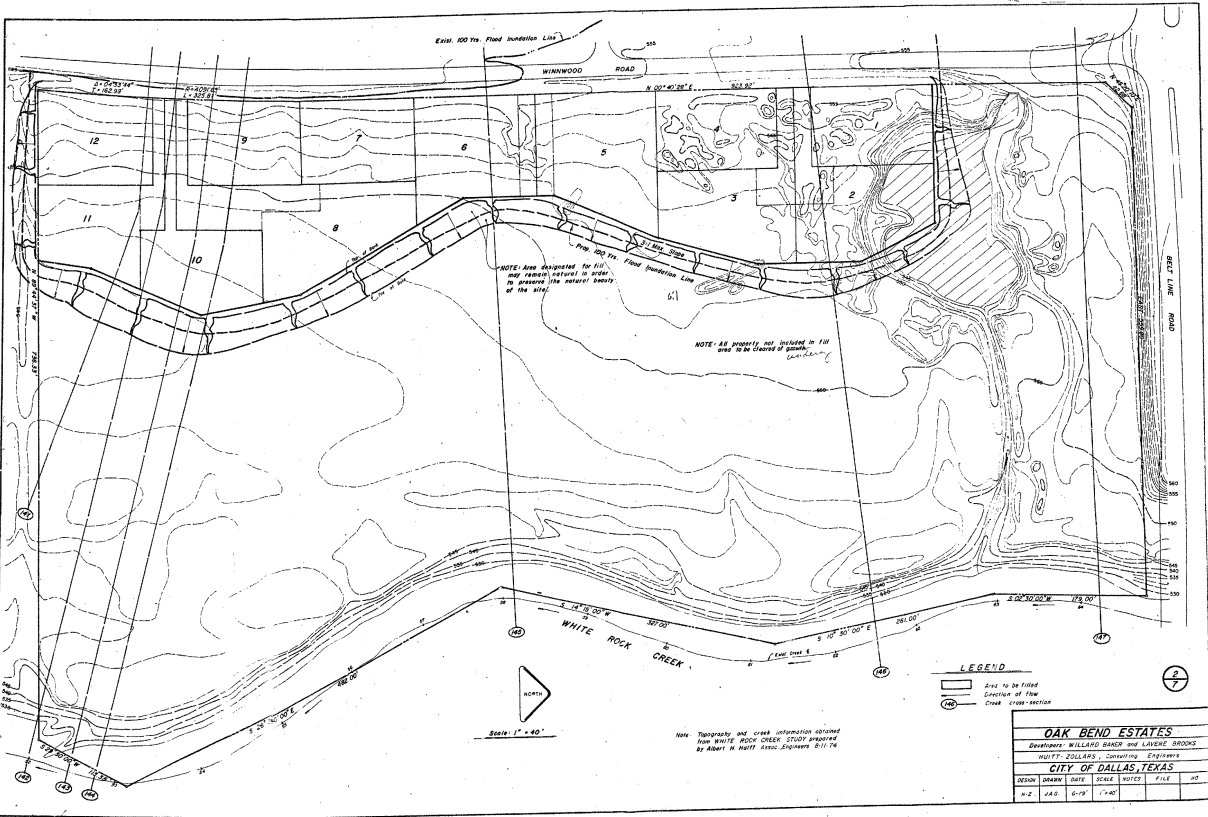

Exist. 100 Yrs. Flood inundation Line

WINNWOOD ROAD

315

300

12

9

7

6

5

N 00° 40' 28" E 322.97'

3

2

11

8

10

NOTE: Area designated for fill may remain natural in order to preserve the natural beauty of the site.

NOTE: All property not included in fill area to be cleared of brush.

Prop. 100 Yrs. Flood inundation Line

31 Mile Stone

61

WHITE ROCK CREEK

140

141

142

143

144

145

146

147

148

149

150

151

152

153

154

155

156

157

158

159

160

161

162

163

164

165

166

167

168

169

170

171

172

173

174

175

176

177

178

179

180

181

182

183

184

185

186

187

188

189

190

191

192

193

194

195

196

197

198

199

200

201

202

203

204

205

206

207

208

209

210

211

212

213

214

215

216

217

218

219

220

221

222

223

224

225

226

227

228

229

230

231

232

233

234

235

236

237

238

239

240

241

242

243

244

245

246

247

248

249

250

251

252

253

254

255

256

257

258

259

260

261

262

263

264

265

266

267

268

269

270

271

272

273

274

275

276

277

278

279

280

281

282

283

284

285

286

287

288

289

290

291

292

293

294

295

296

297

298

299

300

301

302

303

304

305

306

307

308

309

310

311

312

313

314

315

316

317

318

319

320

321

322

323

324

325

326

327

328

329

330

331

332

333

334

335

336

337

338

339

340

341

342

343

344

345

346

347

348

349

350

351

352

353

354

355

356

357

358

359

360

361

362

363

364

365

366

367

368

369

370

371

372

373

374

375

376

377

378

379

380

381

382

383

384

385

386

387

388

389

390

391

392

393

394

395

396

397

398

399

400

401

402

403

404

405

406

407

408

409

410

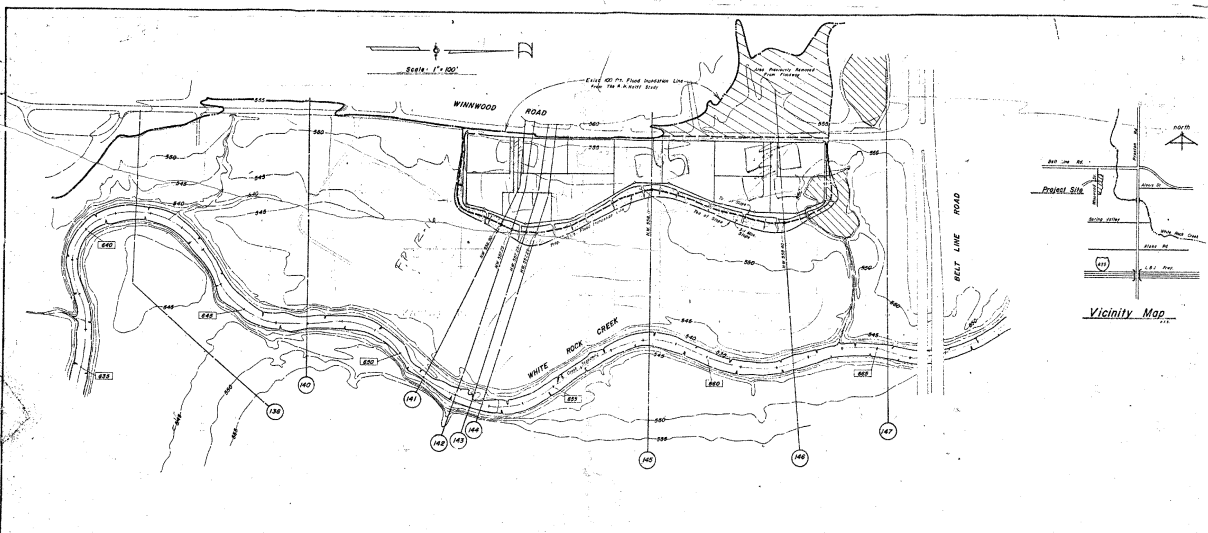

FILL PERMIT REQUEST
OAK BEND ESTATES

FOR
WILLARD BAKER and LAVERE BROOKS
 TWO TURTLE CREEK VILLAGE
 DALLAS, TEXAS 75219

BY
HUITT-ZOLLARS, Consulting Engineers
 8730 KING GEORGE, SUITE 121
 DALLAS, TEXAS 75235

24

