

**PLAT OF BELTWAY OFFICE PARK - TRACT VII**

PART OF THE ELISHA FIKE SURVEY  
ABSTRACT # 418  
CITY OF ADDISON, TEXAS

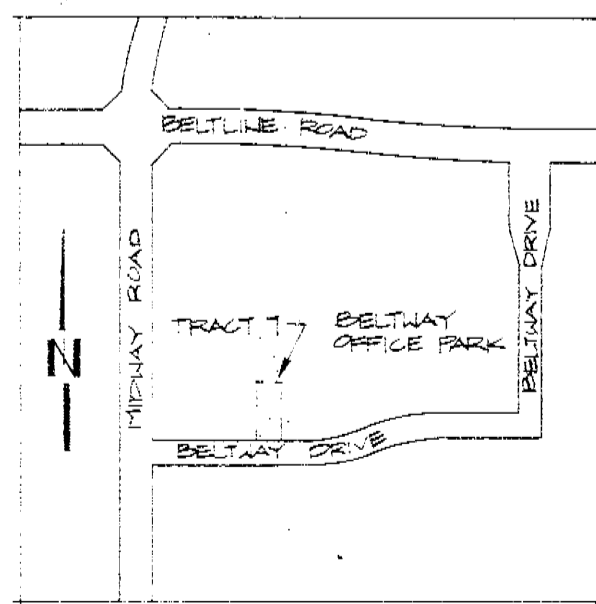

**CERTIFICATE OF APPROVAL**

APPROVED BY THE CITY OF ADDISON, DALLAS COUNTY, TEXAS  
THIS 11<sup>th</sup> DAY OF July 1978.

*James Sharp*  
SECRETARY

**OWNER'S CERTIFICATE**

STATE OF TEXAS  
COUNTY OF DALLAS

WHEREAS, VICTOR LISSIAK, JR. AND RALPH HAMM, JR., ARE THE OWNERS OF A TRACT OF LAND SITUATED IN THE CITY OF ADDISON, DALLAS COUNTY, TEXAS, AND BEING PART OF THE ELISHA FIKE ABSTRACT 418, AND ALSO BEING PART OF A 14.077 ACRE TRACT OF LAND CONVEYED TO ROBERT W. COLLINS, TRUSTEE, BY DEED DATED JUNE 21, 1973, AND RECORDED IN VOLUME 73128, PAGE 0613, AND ALL OF A 26.1091 ACRE TRACT OF LAND CONVEYED TO ROBERT W. COLLINS, TRUSTEE, BY DEED DATED JUNE 21, 1973, AND RECORDED IN VOLUME 73122, PAGE 0836, OF THE DEED RECORDS OF DALLAS COUNTY, AND BEING MORE PARTICULARLY DESCRIBED AS FOLLOWS:

BEGINNING AT A POINT FOR CORNER WHICH IS 419.78 FEET DUE EAST OF THE INTERSECTION OF THE EASTERLY LINE OF MIDWAY ROAD (60 FEET WIDE) AND THE NORTHERLY LINE OF BELTWAY DRIVE (60 FEET WIDE);  
THENCE DUE NORTH, 240.0 FEET TO A POINT FOR CORNER;  
THENCE DUE EAST, 100.0 FEET TO A POINT FOR CORNER;  
THENCE DUE SOUTH, 240.0 FEET TO A POINT FOR CORNER ON THE NORTHERLY LINE OF BELTWAY DRIVE;  
THENCE DUE WEST ALONG SAID NORTHERLY LINE OF BELTWAY DRIVE, 100.0 FEET TO THE POINT OF BEGINNING AND CONTAINING 0.551 ACRES (24000 SQ. FT.)

NOW THEREFORE, KNOW ALL MEN BY THESE PRESENTS:

THAT, VICTOR LISSIAK, JR., AND RALPH HAMM, JR., DO HEREBY ADOPT THIS PLAT DESIGNATING THE HEREIN DESCRIBED PROPERTY AS TRACT VII BELTWAY OFFICE PARK, AN ADDITION TO THE CITY OF ADDISON, TEXAS. THE EASEMENTS SHOWN THEREON ARE HEREBY RESERVED FOR THE PURPOSES AS INDICATED. NO BUILDINGS, FENCES, TREES, SHRUBS, OR OTHER IMPROVEMENTS OR GROWTHS SHALL BE CONSTRUCTED, RECONSTRUCTED, OR PLACED UPON, OVER OR ACROSS THE EASEMENTS AS SHOWN. SAID EASEMENTS OR GROWTHS SHALL BE CONSTRUCTED, RECONSTRUCTED, OR PLACED UPON, OVER OR ACROSS THE EASEMENTS AS SHOWN. SAID EASEMENTS BEING HEREBY RESERVED FOR THE MUTUAL USE AND ACCOMMODATION OF ALL PUBLIC UTILITIES USING OR DESIRING TO USE SAME. ALL AND ANY PUBLIC UTILITY SHALL HAVE THE RIGHT TO REMOVE AND KEEP REMOVED ALL OR PARTS OF ANY BUILDINGS, FENCES, TREES, SHRUBS OR OTHER IMPROVEMENTS OR GROWTHS WHICH IN ANY WAY MAY ENHANCE OR INTERFERE WITH THE CONSTRUCTION, MAINTENANCE OR EFFICIENCY OF ITS RESPECTIVE SYSTEM ON THE EASEMENTS AND ALL PUBLIC UTILITIES SHALL AT ALL TIMES HAVE THE FULL RIGHT OF INGRESS AND EGRESS TO OR FROM AND UPON SAID EASEMENTS FOR THE PURPOSE OF CONSTRUCTING, RECONSTRUCTING, INSPECTING, PATROLLING, MAINTAINING AND ADDING TO OR REMOVING ALL PARTS OF ITS RESPECTIVE SYSTEMS WITHOUT THE NECESSITY AT ANY TIME OF PROCURING THE PERMISSION OF ANYONE. ALL PUBLIC UTILITY SHALL HAVE THE RIGHT OF INGRESS AND EGRESS TO PRIVATE PROPERTY FOR THE PURPOSE OF READING METERS AND ANY MAINTENANCE AND SERVICE REQUIRED OR ORDINARILY PERFORMED BY THAT UTILITY.

THIS PLAT APPROVED SUBJECT TO ALL PLATTING ORDINANCES, RULES, REGULATIONS AND RESOLUTIONS OF THE CITY OF ADDISON, TEXAS.

WITNESS MY HAND AT ADDISON, TEXAS, THIS 8<sup>th</sup> DAY OF June 1978.

*Victor Lissiak, Jr.*  
VICTOR LISSIAK, JR.  
*Ralph Hamm, Jr.*  
RALPH HAMM, JR.

STATE OF TEXAS  
COUNTY OF DALLAS

BEFORE ME, THE UNDERSIGNED AUTHORITY, ON THIS DAY APPEARED VICTOR LISSIAK, JR. AND RALPH HAMM, JR., KNOWN TO ME TO BE THE PERSONS WHOSE NAMES ARE SUBSCRIBED TO THE FOREGOING INSTRUMENT AND ACKNOWLEDGED TO ME THAT THEY EXECUTED THE SAME FOR THE PURPOSES AND CONSIDERATIONS THEREIN EXPRESSED AND IN THE CAPACITY THEREIN STATED.

GIVEN UNDER MY HAND AND SEAL OF OFFICE, THIS 8<sup>th</sup> DAY OF June 1978.

*James Amington*  
NOTARY PUBLIC IN AND FOR DALLAS COUNTY, TEXAS



**ENGINEER'S DECLARATION**

KNOW ALL MEN BY THESE PRESENTS:

THAT I, RODNEY BLACK, DO HEREBY DECLARE THAT I PREPARED THIS PLAT FROM AN ACTUAL AND ACCURATE SURVEY OF THE LAND IN ACCORDANCE WITH THE PLATTING RULES AND REGULATIONS OF THE CITY OF ADDISON, TEXAS. THIS PROPERTY IS SUBJECT TO ANY AND ALL EASEMENTS SHOWN AND OR RECORDED.

*Rodney Black*  
RODNEY BLACK  
REGISTERED PROFESSIONAL ENGINEER

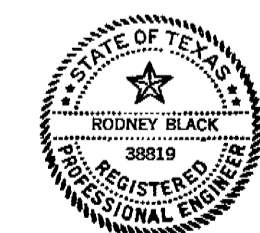

STATE OF TEXAS  
COUNTY OF DALLAS

BEFORE ME, THE UNDERSIGNED AUTHORITY ON THIS DAY PERSONALLY APPEARED RODNEY BLACK, KNOWN TO ME TO BE THE PERSON WHOSE NAME IS SUBSCRIBED TO THE FOREGOING INSTRUMENT AND ACKNOWLEDGED TO ME THAT HE EXECUTED THE SAME FOR THE PURPOSES AND CONSIDERATIONS THEREIN EXPRESSED AND IN THE CAPACITY THEREIN STATED.

GIVEN UNDER MY HAND AND SEAL OF OFFICE, THIS 8<sup>th</sup> DAY OF June 1978.

*James Amington*  
NOTARY PUBLIC IN AND FOR DALLAS COUNTY, TEXAS



CONSULTING ENGINEERS  
**Lissiak/Black & Associates Inc.**  
4500 BELTLINE ROAD, DALLAS TEXAS 75240 TELEPHONE 214 831 8187



PLAT OF BELTWAY OFFICE PARK - TRACT VII  
VICTOR LISSIAK & RALPH HAMM - OWNERS  
4500 BELTLINE RD. SUITE 400  
DALLAS, TEX. 75240

NO. 11  
DATE  
REVISION

JOB NO. 1806  
DATE 6 JULY 78  
REVISION

SHEET NO. 1 OF 1