

GREASE INTERCEPTOR SCHEDULE

MODEL NO.	USUAL CAP. (LBS)	EMPTY CAP. (LBS)	LENGTH (L)	WIDTH (W)	HEIGHT (H)	INLET (F1)	OUTLET (F2)
GT-1000	1500	3000	3'-2"	5'-8"	7'-0"	5'-9"	5'-0"

OTHER SIZES ARE AVAILABLE. CONTACT RACETRAC FOR MORE INFORMATION.

ENGINEERING DATA:
 THE GREASE INTERCEPTOR IS STRUCTURALLY & HYDRAULICALLY ENGINEERED TO CONFORM TO REGIONAL PLUMBING CODES RECOMMENDED IN MOST JURISDICTIONS. THE UNIT IS DESIGNED TO BE INSTALLED IN A CONCRETE SLAB WITH A MINIMUM 2" THICKNESS. THE UNIT IS NOT APPROVED FOR GRAVITY FLOW SEWER SYSTEMS. A SAMPLE WELL IS UTILIZED ON THE OUTLET SIDE FOR SAMPLING BY THE LOCAL WATER AUTHORITY.

SPECIFICATIONS:
 CONCRETE:
 CLASS II CONCRETE WITH MINIMUM STRENGTH OF 4000 PSI AT 28 DAYS. LIMITS OF MONOLITHIC CONSTRUCTION AT FLOOR LEVEL. FIRST STAGE OF WALL AND Baffle WITH SECTIONAL REBAR TO REQUIRED DEPTH (MONOLITHIC Baffle REQUIRED). SLIDE-IN TYPE IS NOT ACCEPTABLE.

REINFORCEMENTS:
 GRADE 60 REINFORCEMENT WITH STEEL REBAR CONFORMING TO ASTM A615 ON REQUIRED CENTERS OR EQUAL.

C-1. CASTINGS:
 MANHOLE FRAMES, COVERS OR GRATES ARE MANUFACTURED OF GRAY CAST IRON CONFORMING TO ASTM A48. 75 CLASS 30. MANHOLE SHALL BE NOMINAL 24 INCH DIAMETER AND BE MADE OF 304L.

Grease Trooper®
 Grease Interceptor

ANSI **ASSE** **ASPE** **ASPI**

GREASE INTERCEPTOR SERIES GT
1500 GALLON CAPACITY

SCALE: NONE DWG. NO: GT-1
 DATE: 2012

4 GREASE TRAP (1500 GALLON CAPACITY) & SAMPLE WELL DETAILS OR "APPROVED EQUAL"

ENGINER OF RECORD APPROVAL
 REQUIRED FOR "APPROVED EQUAL"

SD2 NTS

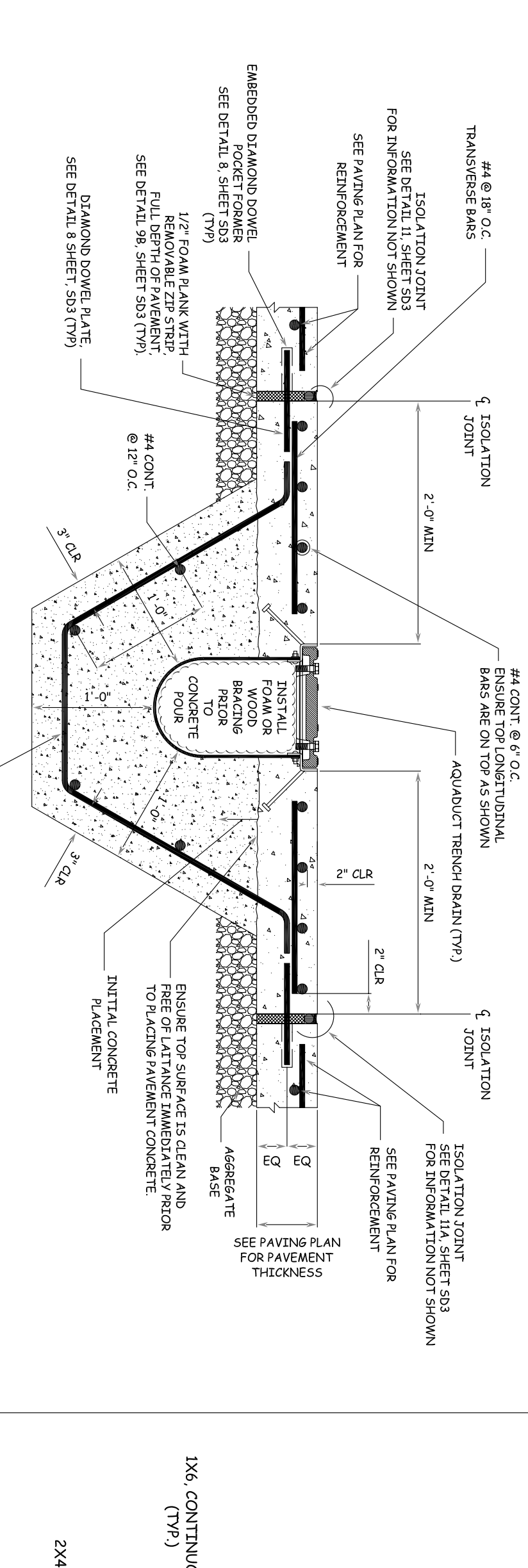
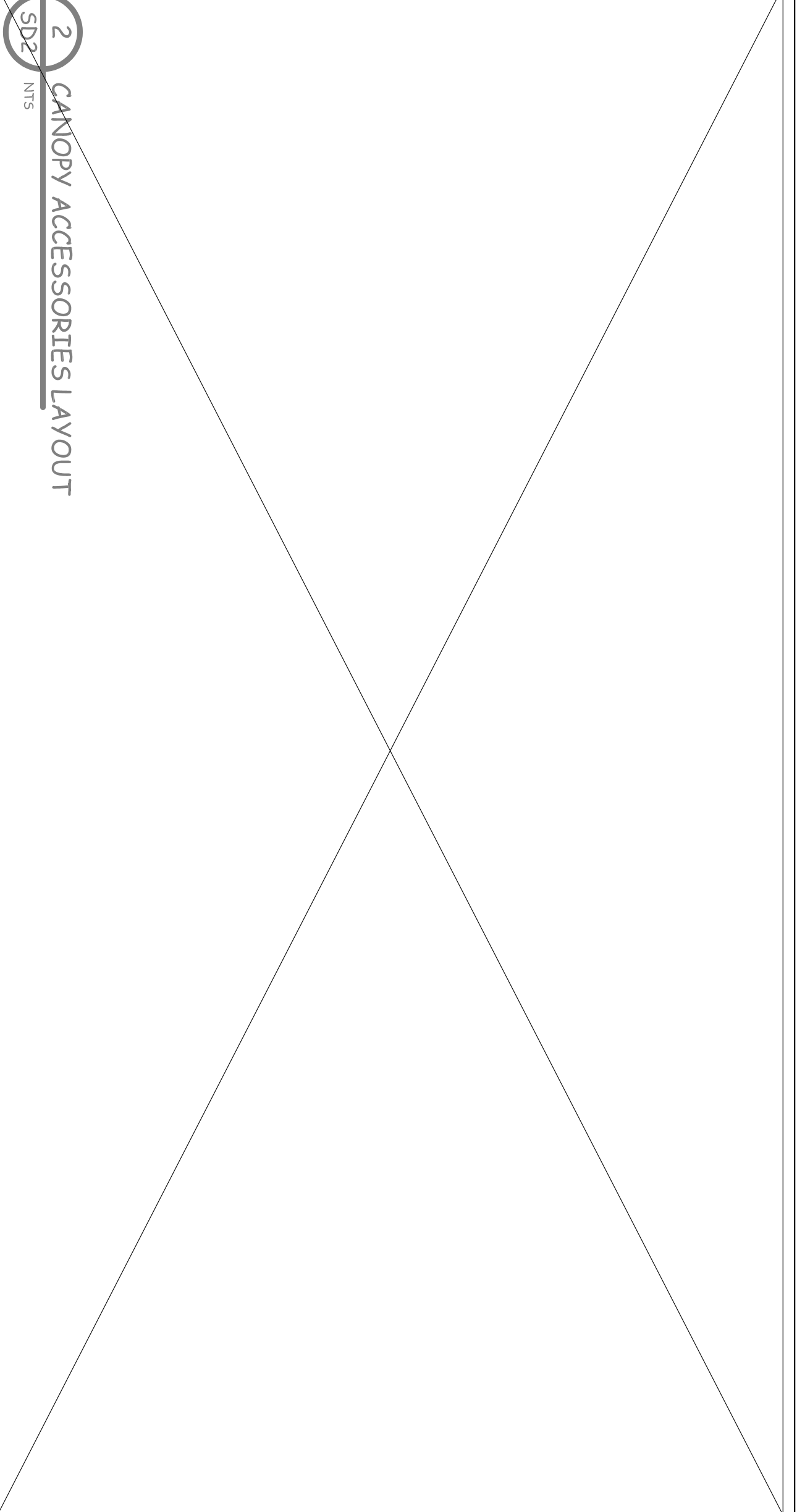

5 TYP. CONCRETE DETAIL FOR AQUADUCT TRENCH DRAIN

NOTES:
 1. LIGHT POLES TO BE 4x4, REQUIRED BY RACETRAC AND TO BE INSTALLED BY GENERAL CONTRACTOR. SEE SITE PLAN FOR POLE LOCATIONS.
 2. LIGHT FIXTURES TO BE ALI - SELECTRA 997 AREA LIGHTING MODEL. STRV4-2000 FCO AND (68-12ED)-88-ROST TOP MOUNT WITH A MAXIMUM EFFECTIVE PROTECTED AREA OF 0.33 SF PER FIXTURE. THIS SHALL BE PAID FOR BY OTHERS. SEE LIGHT FIXTURE FOR POLE WIND DESIGN CRITERIA BASED ON THE FOLLOWING:
 A. WIND SPEED 75 MPH WITH EXPOSURE C RISK CATEGORY II
 B. WIND DESIGN WIND SPEED 75 MPH
 C. WIND DESIGN WIND PRESSURE 13.6 PSF
 D. DESIGN WIND PRESSURE 13.6 PSF
 E. DESIGN WIND PRESSURE 13.6 PSF

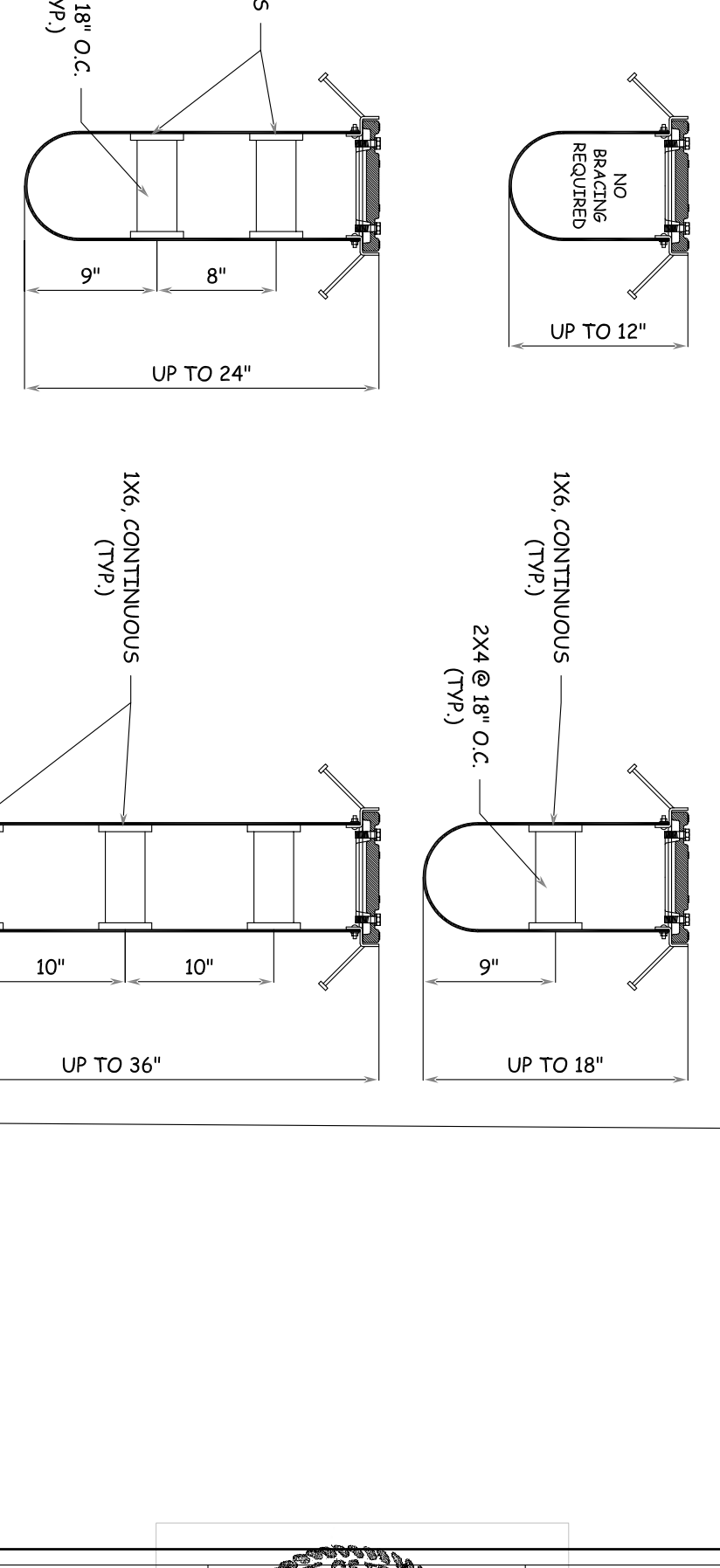
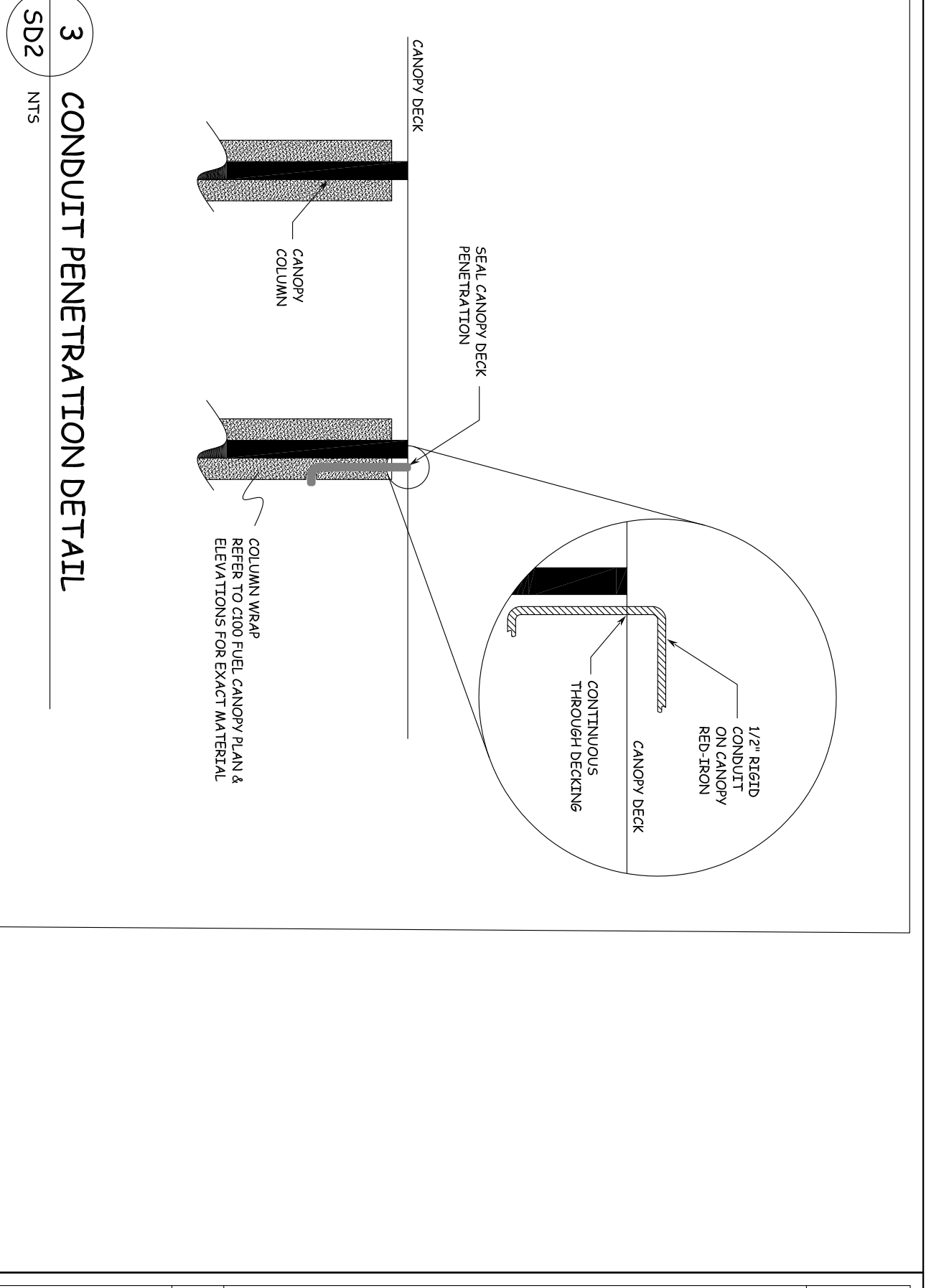
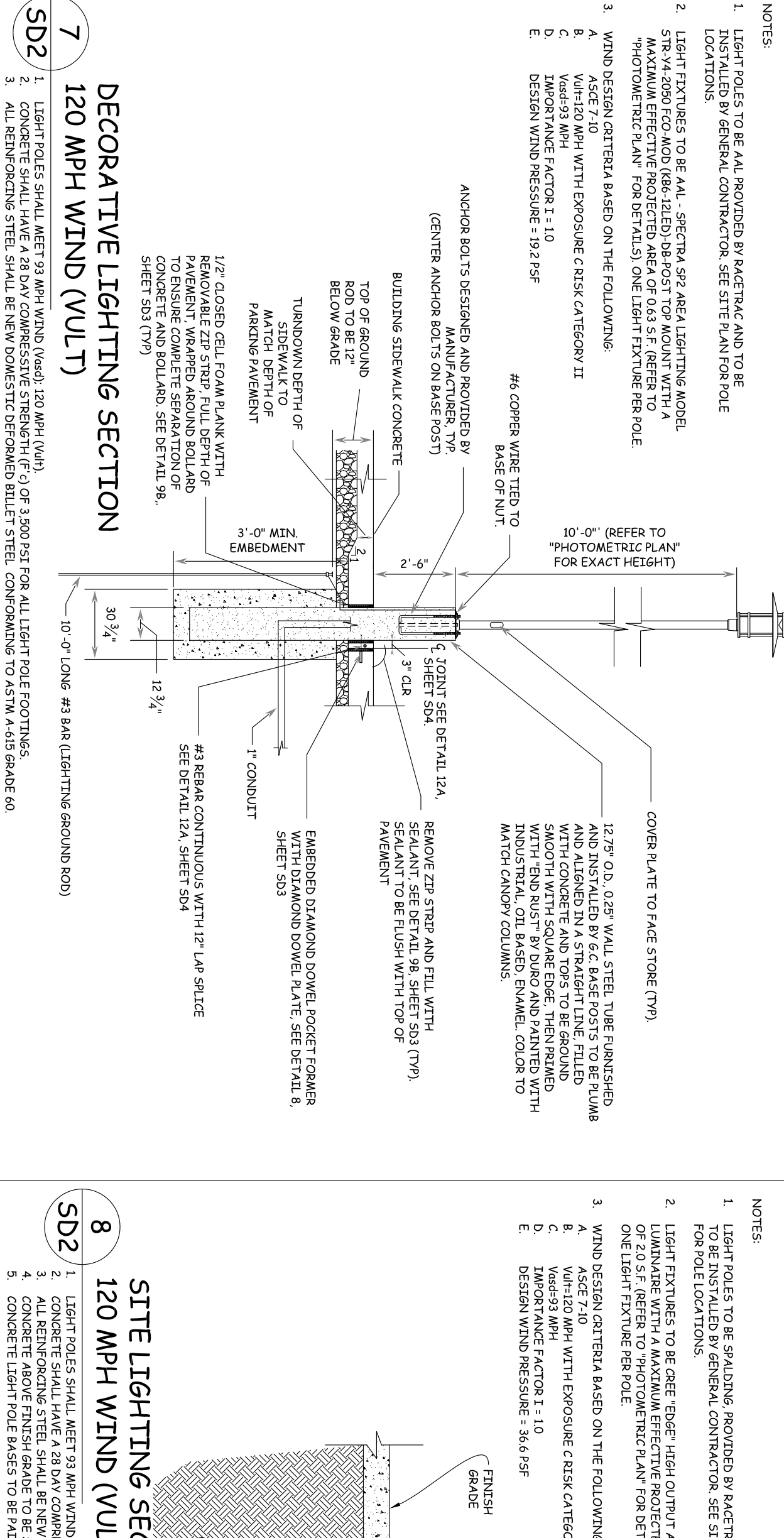

6 AQUADUCT TRENCH DRAIN BRACING LAYOUT DETAILS

NOTE:
 1. FOR TRENCH DRAINS OVER 36" IN DEPTH, ADD AN ADDITIONAL LEVEL OF BRACING FOR EACH ADDITIONAL 12" OF DEPTH.

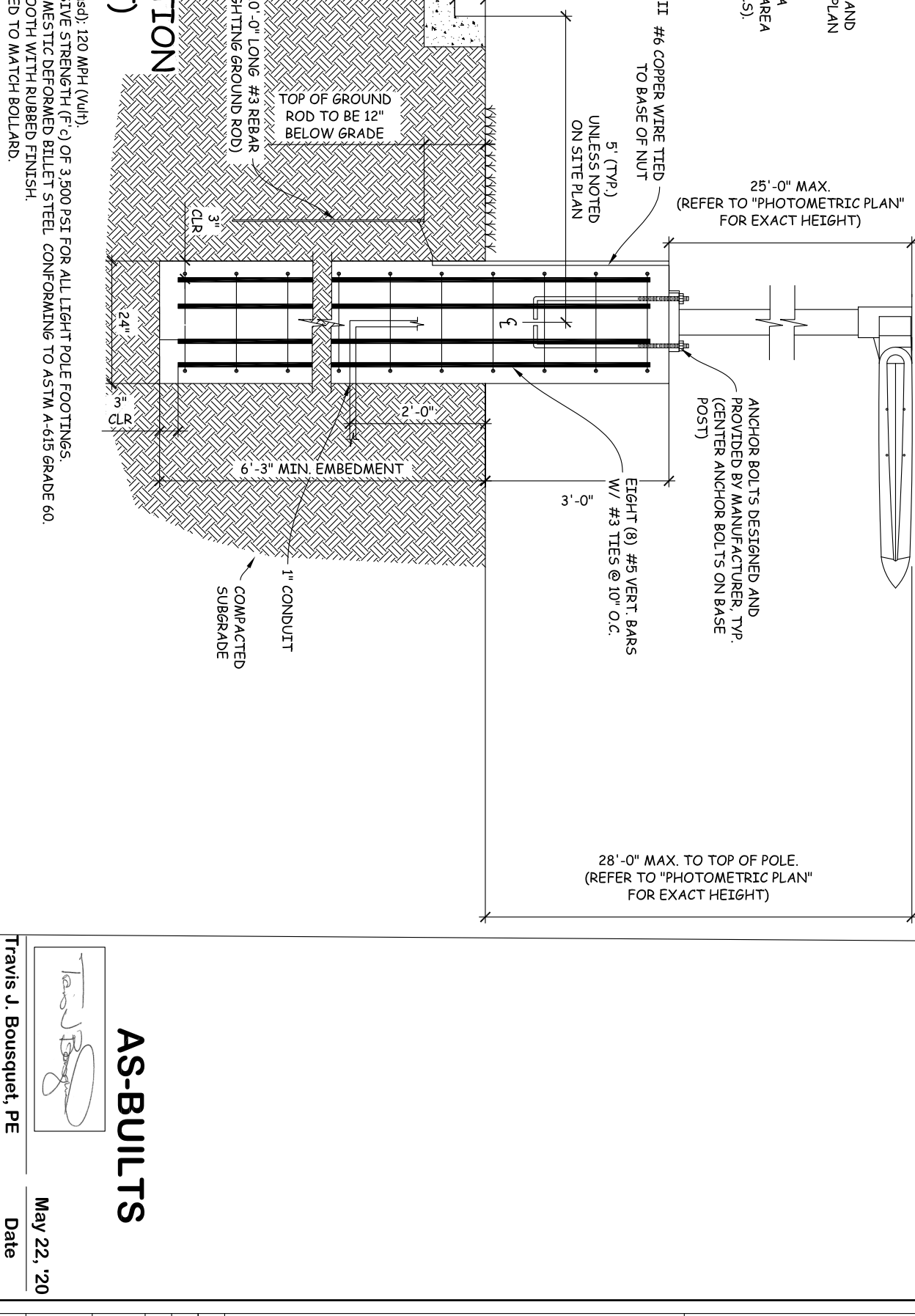

8	As-Builts to City	05/22/20
7	Modification to sidewalk along Arapaho	04/16/20
6	Additional Spot elevations to GC	11/07/19
5	REVISED PLANS TO TOWN	08/23/2019
4	TOWN SUBMITTAL	04/05/2019
3	TOWN SUBMITTAL	08/30/2018
2	TOWN SUBMITTAL	08/28/2018
1	TOWN SUBMITTAL	02/12/2018
NO.		DATE

THESE PLANS ARE SUBJECT TO FEDERAL COPYRIGHT LAWS: ANY USE OF SAME WITHOUT THE EXPRESSED WRITTEN PERMISSION OF RACETRAC PETROLEUM, INC. IS PROHIBITED.

RACETRAC
 RACETRAC PETROLEUM, INC.
 3225 CUMBERLAND BOULEVARD
 SUITE 100 ATLANTA, GA 30339
 (770) 431-7600

JONES CARTER
 Texas Board of Professional Engineers Registration No. F-439
 4508 Mercedale Plaza Drive, Suite 200 • Fort Worth, TX 76137 • 817.388.2300

AS-BUILTS
 May 22, '20
 Date

DETAIL SHEET 2 (PRIVATE)
RACETRAC
 Beltline/Marsh Business Park
 Lot 2, Block 1
 3.133 Ac. - Zoned: Light Retail
 Addison, Texas

DATE: May 22, '20
 SCALE: 1"=30'
 DRAWING BY: TJB

SD2 VERSION