

Plotted By: Lemier, Morgan Street Setback Layout: C7.00 October 24, 2019 09:42:00am K:\VDL\Addison\067792503 - Addison Galaxy FBO\ACAD\Draw\Sheets\Site Plan\Visibility Triangles.dwg
 This document, together with the concepts and designs presented herein, is intended only for the specific purpose and client for which it was prepared. Release of and improper reliance on this document without written authorization and approval by Kimley-Horn and Associates, Inc. shall be without liability to Kimley-Horn and Associates, Inc.

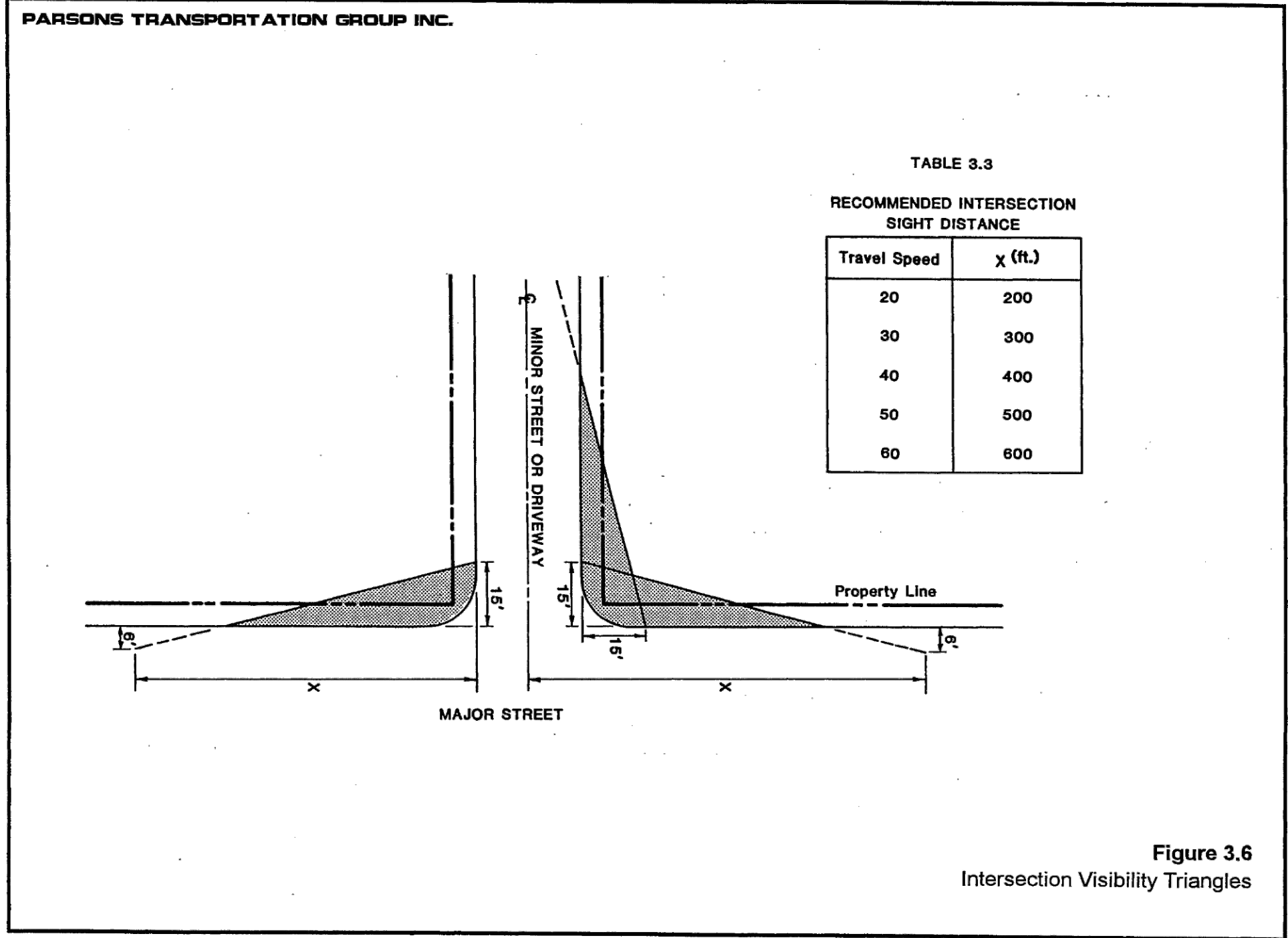
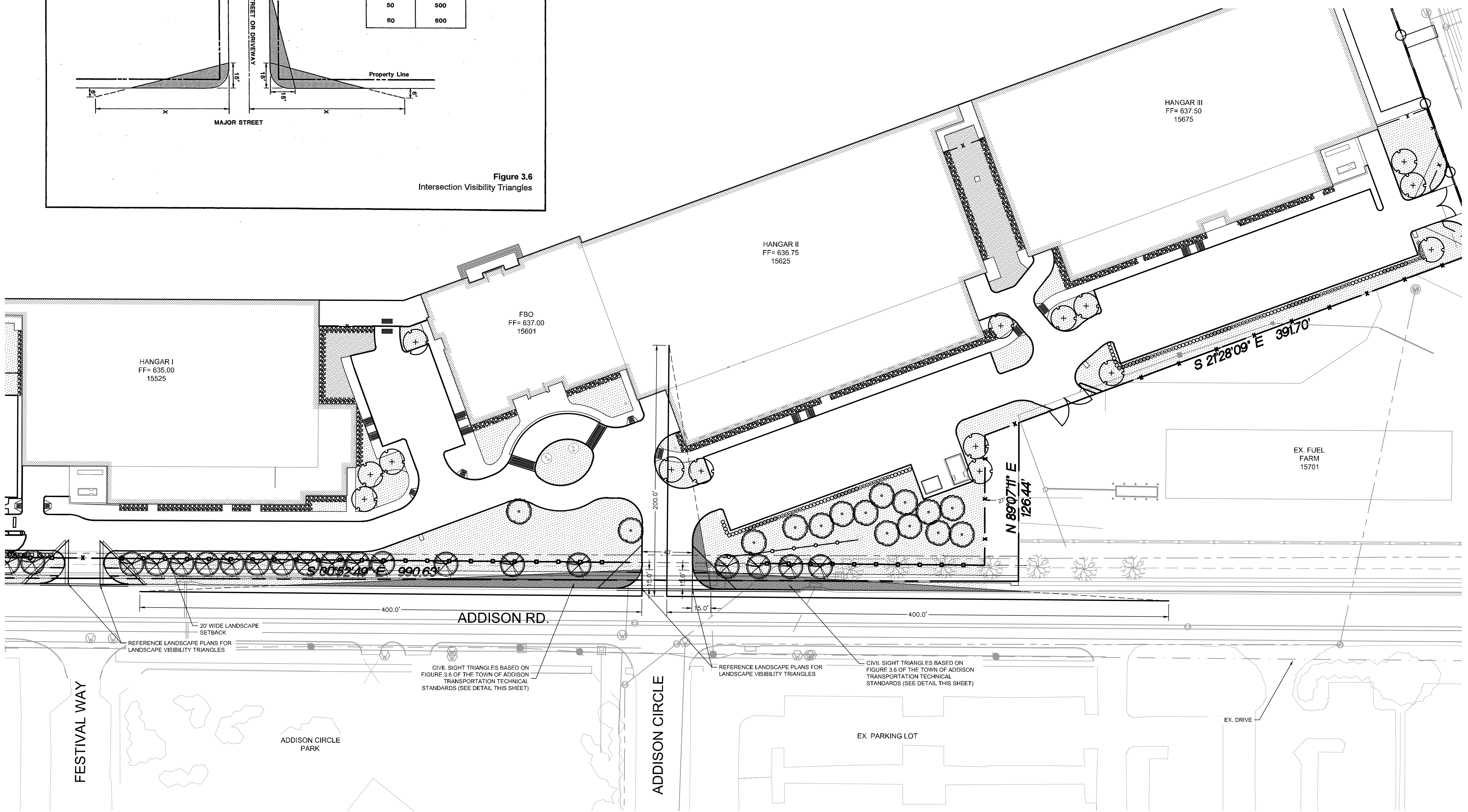
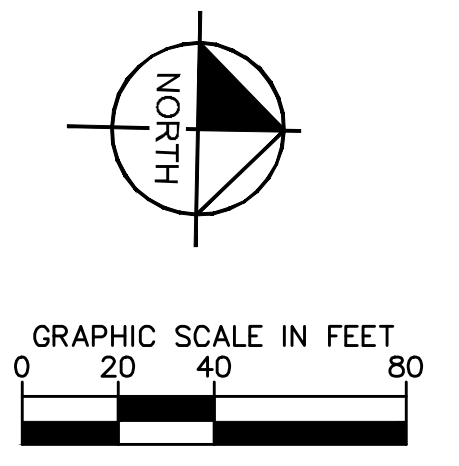

Figure 3.6
Intersection Visibility Triangles

THIS PLAN CONFORMS WITH DESIGN STANDARDS INCLUDED IN THE TOWN OF ADDISON TRANSPORTATION PLAN, WATER SYSTEM REQUIREMENTS, WASTE WATER SYSTEM REQUIREMENTS, AND DRAINAGE CRITERIA MANUAL.

FLOOD PLAIN NOTE:
NO FLOODPLAIN EXISTS ONSITE. PER FEMA FIRM 48113C0180K, DATE 07/07/2014, THIS SITE IS ZONE X UNSHADED, AREAS DETERMINED TO BE OUTSIDE THE 0.2% ANNUAL CHANGE FLOOD PLAIN.



ADDENDUM #1	ADDENDUM #5	NO.	REVISIONS	DATE	BY

Kimley»Horn
 © 2019 KIMLEY-HORN AND ASSOCIATES, INC.
 1400 WOODLAND DRIVE, SUITE 225
 THE WOODLANDS, TX 77380
 PHONE: 281-475-2816
 TBPE FIRM REGISTRATION F-928
 WWW.KIMLEY-HORN.COM

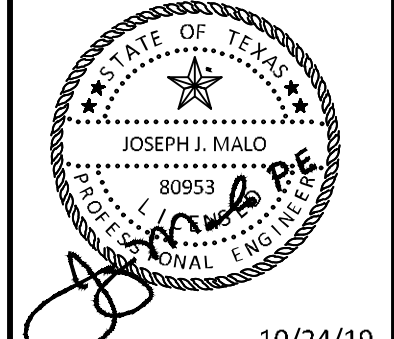

KHA PROJECT	DATE	SCALE	DESIGNED BY	DRAWN BY	CHECKED BY
067792503	10/24/2019	AS SHOWN	HCV	EAC	HCV

SIGHT VISIBILITY TRIANGLE PLAN

ADDISON GALAXY FBO
 15601 ADDISON RD.
 PREPARED FOR
BLACK FOREST VENTURE
 DALLAS, TEXAS

SHEET NUMBER
C7.00