

MATCHLINE CENTER

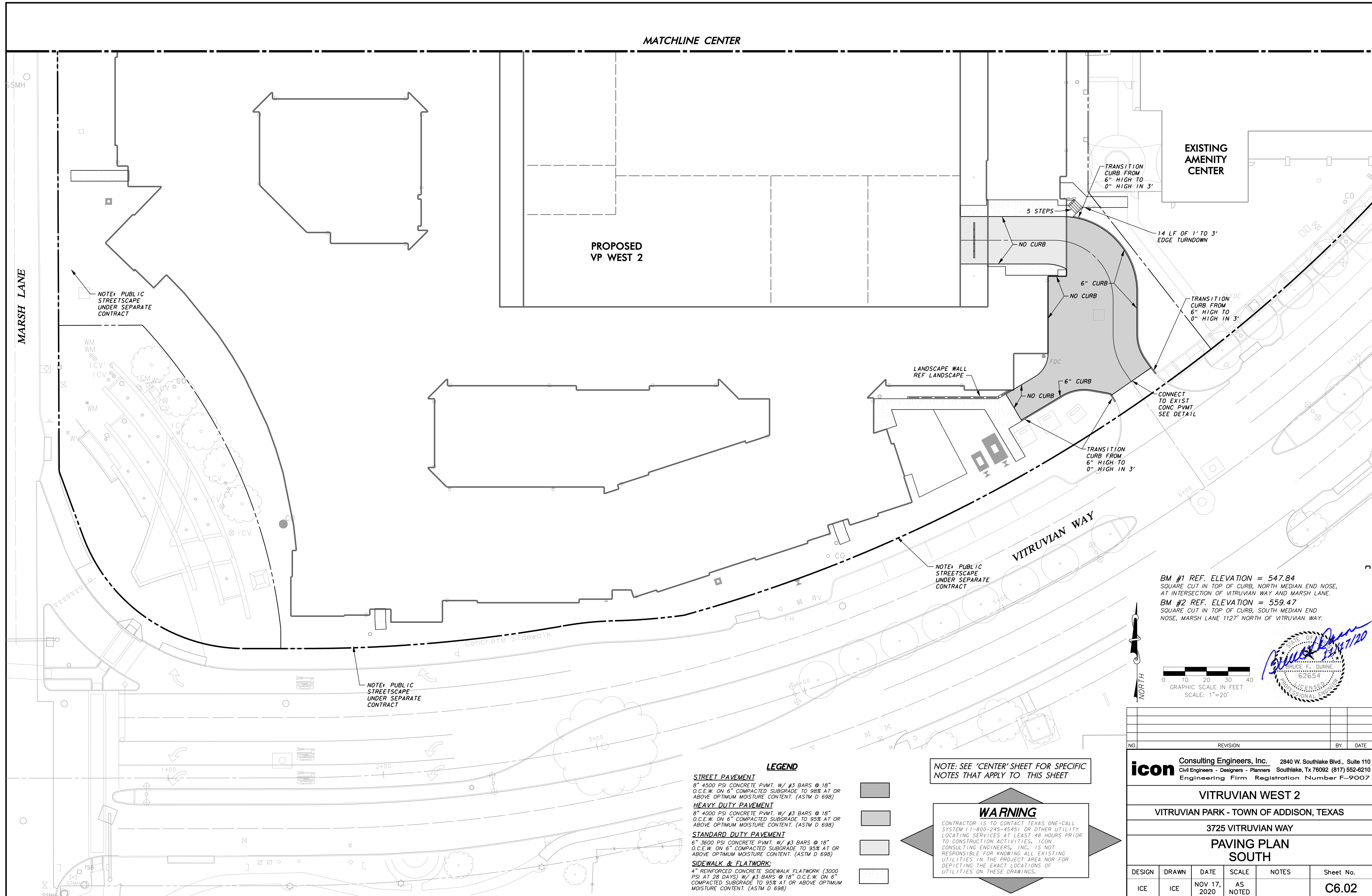

NOTE: PUBLIC STREETSCAPE UNDER SEPARATE CONTRACT

NOTE: PUBLIC STREETSCAPE UNDER SEPARATE CONTRACT

NOTE: PUBLIC STREETSCAPE UNDER SEPARATE CONTRACT

BM #1 REF. ELEVATION = 547.84
 SQUARE CUT IN TOP OF CURB, NORTH MEDIAN END NOSE,
 AT INTERSECTION OF VITRUVIAN WAY AND MARSH LANE.
 BM #2 REF. ELEVATION = 559.47
 SQUARE CUT IN TOP OF CURB, SOUTH MEDIAN END
 NOSE, MARSH LANE 112' NORTH OF VITRUVIAN WAY.

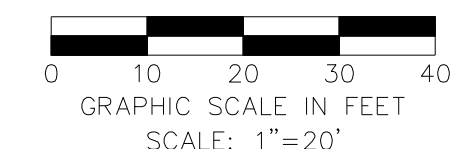

LEGEND

- STREET PAVEMENT**
8" 4500 PSI CONCRETE PVMT. W/ #3 BARS @ 18" O.C.E.W. ON 6" COMPACTED SUBGRADE TO 98% AT OR ABOVE OPTIMUM MOISTURE CONTENT. (ASTM D 698)
- HEAVY DUTY PAVEMENT**
8" 4000 PSI CONCRETE PVMT. W/ #3 BARS @ 18" O.C.E.W. ON 6" COMPACTED SUBGRADE TO 95% AT OR ABOVE OPTIMUM MOISTURE CONTENT. (ASTM D 698)
- STANDARD DUTY PAVEMENT**
6" 3600 PSI CONCRETE PVMT. W/ #3 BARS @ 18" O.C.E.W. ON 6" COMPACTED SUBGRADE TO 95% AT OR ABOVE OPTIMUM MOISTURE CONTENT. (ASTM D 698)
- SIDEWALK & FLATWORK:**
4" REINFORCED CONCRETE SIDEWALK FLATWORK (3000 PSI AT 28 DAYS) W/ #3 BARS @ 18" O.C.E.W. ON 6" COMPACTED SUBGRADE TO 95% AT OR ABOVE OPTIMUM MOISTURE CONTENT. (ASTM D 698)

NOTE: SEE 'CENTER' SHEET FOR SPECIFIC NOTES THAT APPLY TO THIS SHEET

WARNING

CONTRACTOR IS TO CONTACT TEXAS ONE-CALL SYSTEM (1-800-245-4545) OR OTHER UTILITY LOCATING SERVICES AT LEAST 48 HOURS PRIOR TO CONSTRUCTION ACTIVITIES. ICON CONSULTING ENGINEERS, INC. IS NOT RESPONSIBLE FOR KNOWING ALL EXISTING UTILITIES IN THE PROJECT AREA NOR FOR DEPICTING THE EXACT LOCATIONS OF UTILITIES ON THESE DRAWINGS.

| NO. | REVISION | BY | DATE |
|-----|----------|----|------|
| | | | |

icon Consulting Engineers, Inc. 2840 W. Southlake Blvd., Suite 110
 Civil Engineers - Designers - Planners Southlake, TX 76092 (817) 552-6210
 Engineering Firm Registration Number F-9007

VITRUVIAN WEST 2
 VITRUVIAN PARK - TOWN OF ADDISON, TEXAS
 3725 VITRUVIAN WAY
PAVING PLAN SOUTH

| DESIGN | DRAWN | DATE | SCALE | NOTES | Sheet No. |
|--------|-------|--------------|----------|-------|--------------|
| ICE | ICE | NOV 17, 2020 | AS NOTED | | C6.02 |

VITRUVIAN WEST 2 - PROJECT NO. 5019-18