

# PLANS FOR THE CONSTRUCTION OF VITRUVIAN WEST 2 STREETSCAPE IMPROVEMENTS FOR VITRUVIAN PARK PUBLIC INFRASTRUCTURE - PHASE 5, BLOCK 200B TOWN OF ADDISON, TEXAS TOWN PROJECT # 2019-01C



**JOE CHOW**  
MAYOR

**PAUL WALDEN**  
**TOM BRAUN**  
**IVAN HUGHES**  
**GUILLELMO QUINTANILLA**  
**LORI WARD**  
**MARLIN WILLESEN**  
COUNCIL MEMBERS

**WESLEY S. PIERSON**  
CITY MANAGER  
**LISA A. PYLES**  
DIRECTOR OF PUBLIC  
WORKS & ENGINEERING

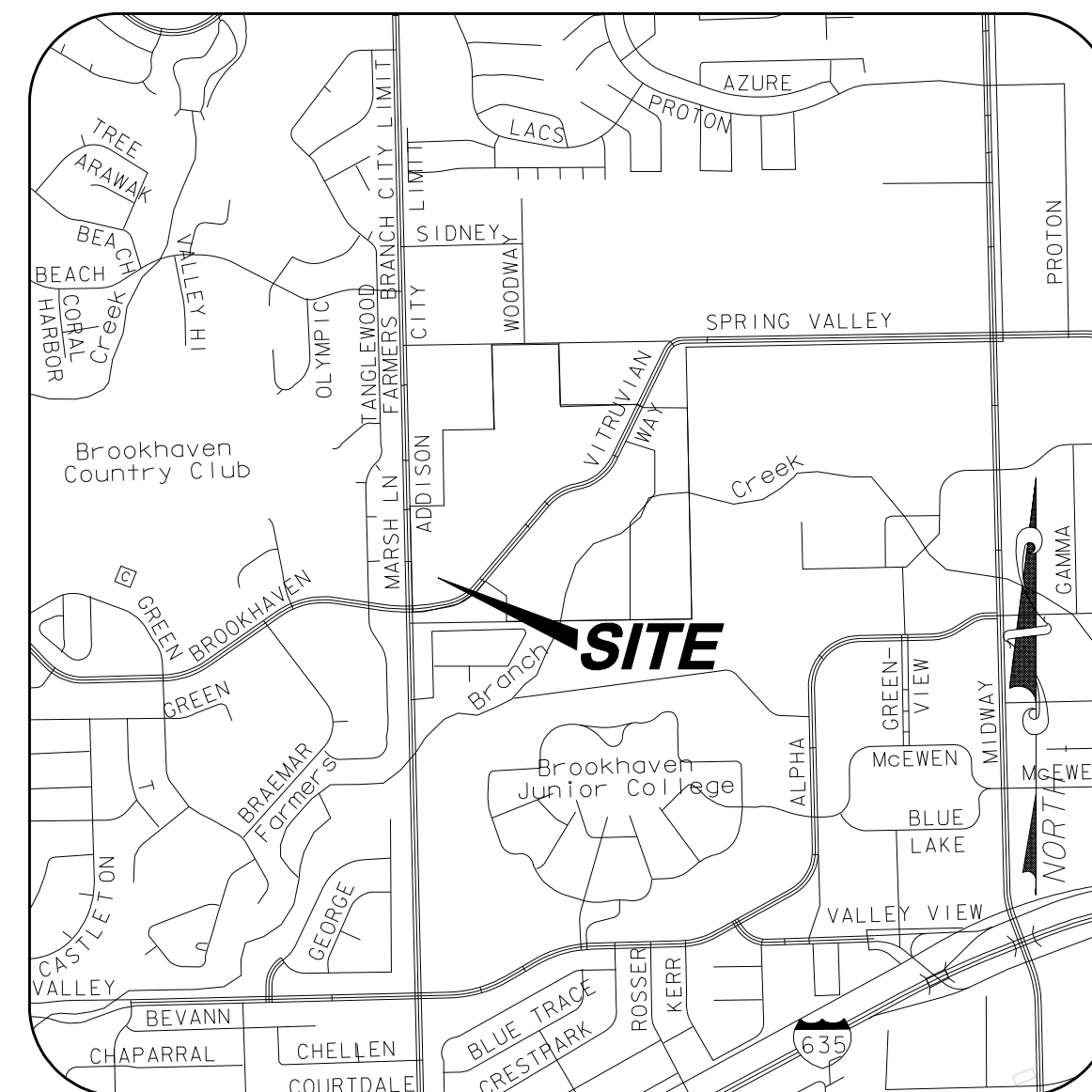

### VICINITY MAP

NOT TO SCALE  
(MAPSCO GRID 13 & 14)



#### SHEET INDEX

1	1	COVER SHEET
2	2	GENERAL CONSTRUCTION NOTES, LEGEND & ABBREVIATIONS
3	3	OVERALL LAYOUT & PROJECT CONTROL
4	4	EROSION & SEDIMENT CONTROL PLAN
5	5	EROSION & SEDIMENT CONTROL DETAILS
6	6	DEMOLITION PLAN
7	7	STREETSCAPE PLAN
8	8	STREETSCAPE PAVING NOTES & DETAILS
9	9	STREETSCAPE PAVING DETAILS
10	10	STREETSCAPE PAVING DETAILS
11	11	STREET LIGHT & CONDUIT PLAN
12	12	STREET LIGHT DETAILS
13	13	ELECTRICAL DETAILS - CONDUIT ED(1)-03
14	14	ELECTRICAL DETAILS - CONDUCTORS ED(2)-03
15	15	ELECTRICAL DETAILS - GROUND BOXES ED(3)-03
16	16	LANDSCAPE LEGEND & DETAILS
17	17	LANDSCAPE PLAN - VITRUVIAN WAY
18	18	LANDSCAPE PLAN - MARSH LANE
19	19	IRRIGATION PLAN - VITRUVIAN WAY
20	20	IRRIGATION PLAN - MARSH LANE
21	21	IRRIGATION DETAILS
22	22	IRRIGATION DETAILS

**CIVIL ENGINEER:**

ICON CONSULTING ENGINEERS, INC.  
2840 W. SOUTHLAKE BLVD., SUITE 110  
SOUTHLAKE, TEXAS 76092  
PH: (817) 552-6210

CONTACT: BRUCE F. DUNNE, P.E.

**SURVEYOR:**

KADLECK & ASSOCIATES,  
A DIVISION OF WESTWOOD  
2740 NORTH DALLAS PKWY., SUITE 280  
PLANO, TEXAS, 75093  
PH: (214) 473-4640  
CONTACT: LYNN KADLECK, R.P.L.S.

**LANDSCAPE ARCHITECT:**

STUDIO OUTSIDE  
824 EXPOSITION AVE., SUITE 5  
DALLAS, TEXAS, 75226  
PH: (214) 954-7160

CONTACT: BRAD GOODMAN, LEED, AP

**icon** Consulting Engineers, Inc.  
Civil Engineers- Designers- Planners  
ENGINEERING FIRM REGISTRATION NUMBER F-9007

**NOVEMBER 17, 2020 - AS-BUILT / RECORD DRAWINGS**



PROJECT NO. 5029-06