

NOTE:

The existing grades shown on this drawing were reproduced from a topographic survey originally performed by Riewe & Wisniewski, Inc., Consulting Engineers. It shall be the responsibility of the general contractor to verify the existing grades and referenced bench mark. Notify engineer at once of any discrepancies.

GENERAL NOTES:

1. SPOT ELEVATIONS AT CONCRETE DRIVEWAYS AND PARKING AREAS ARE GENERALLY AT THE BASE OF CURBS AND AT CENTER LINE OF DRIVES. OTHER SPOTS CAN BE SCALED FOR LOCATION.
2. ANY DISCREPANCIES BETWEEN ELEVATIONS SHOWN ON THIS DRAWING AND THOSE ACTUALLY ENCOUNTERED IN THE FIELD SHALL BE REPORTED TO THE ENGINEER OF RECORD.
3. REFER TO SHEET A-1 FOR CURB LOCATIONS, DIMENSIONS AND DETAIL.

SITE PREPARATION NOTES:

1. THE ENTIRE SITE SHALL BE STRIPPED OF ALL ORGANIC MATERIALS, VEGETATION, AND DELETERIOUS MATERIALS. STRIPPINGS, AS REQUIRED, MAY BE STOCKPILED FOR USE IN CONSTRUCTION OF LANDSCAPE BERMS. DISPOSE OF ALL EXCESS STRIPPINGS OFF THE SITE. TREES AND OTHER PLANTS, WHEN DIRECTED BY THE ARCHITECT, SHALL REMAIN UNDISTURBED.
2. PERFORM CUTTING AND FILLING OPERATIONS TO FINISH SUBGRADE AS DIRECTED BY THE GRADING AND DRAINAGE PLAN EXCEPT TO WITHIN 2'-10" OF FINISH FLOOR SLAB ELEVATION FOR ALL BUILDING PADS.
3. CONSTRUCT BUILDING PADS USING MINIMUM 2'-6" OF SELECT FILL HAVING A P.I. BETWEEN 3 AND 12 PLACED TO WITHIN 95% STANDARD PROCTOR DENSITY AT OR ABOVE OPTIMUM MOISTURE CONTENT.

| LEGEND | |
|-----------|--------------------------------------|
| 000 | EXISTING CONTOUR |
| +000.0 | NEW SPOT GRADE |
| +TC 000.0 | NEW TOP OF CURB OR TOP OF WALK GRADE |
| → | DRAINAGE FLOW LINE |
| — | NEW CONTOUR (BERMS) |

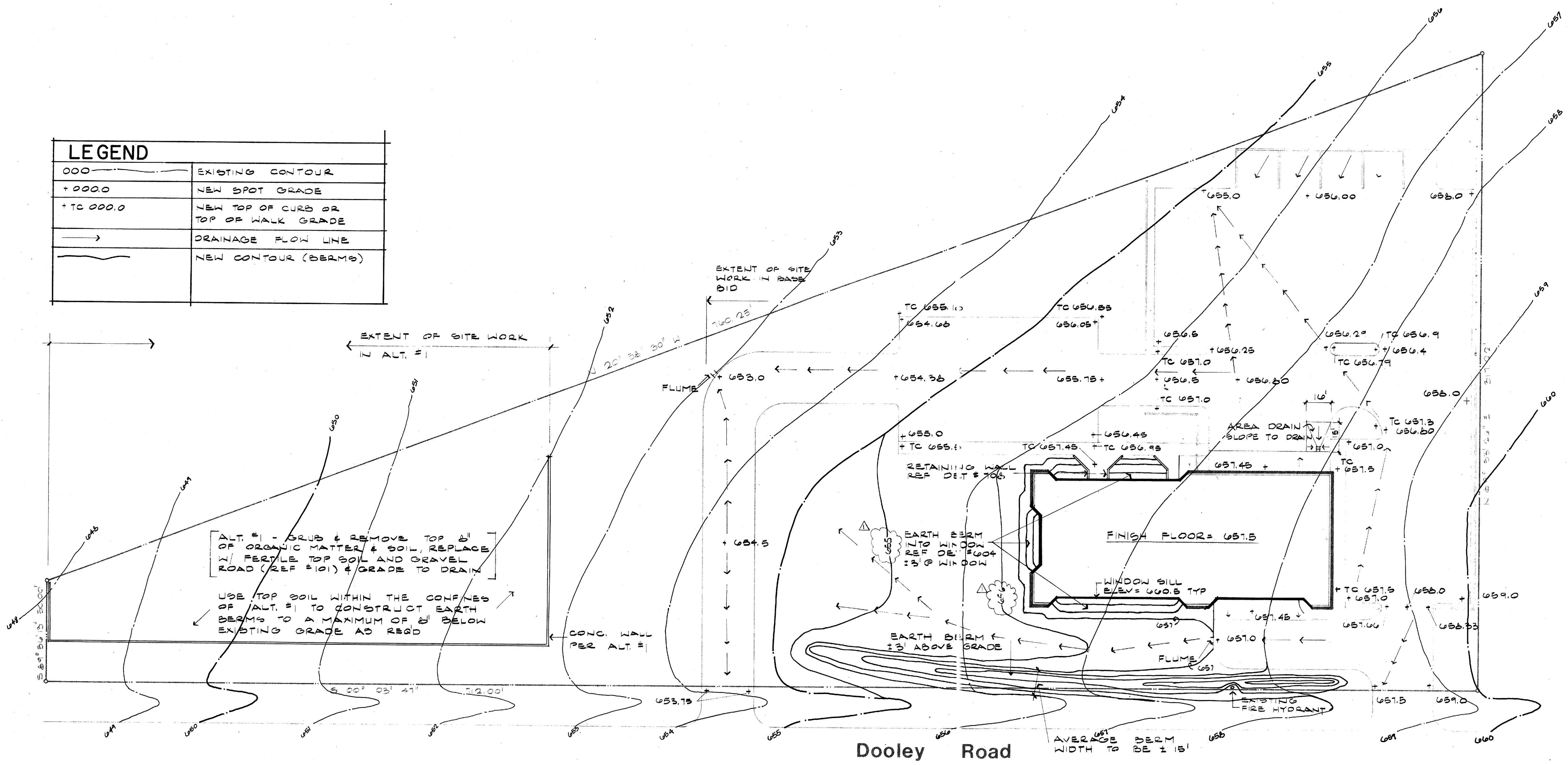

01 SITE GRADING PLAN
SC: 1" = 20'

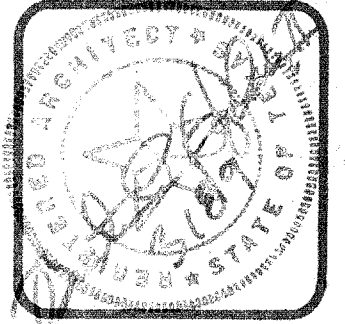
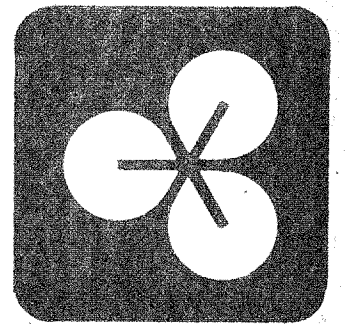
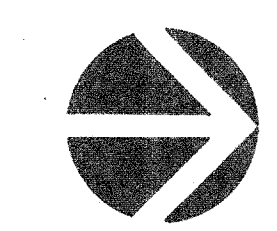

EDI CAPE HOPKINS CLEMENT, INC.
 PLANNING - ARCHITECTURE - INTERIOR DESIGN
 TWO NORTHPARK EAST, 120 · DALLAS · 214/750-1945
 AMERICAN INSTITUTE OF ARCHITECTS · AMER. SOC. CONSULTING PLANNERS

City of Addison
PUBLIC WORKS SERVICE CENTER
 Dooley Road
 Addison Texas

| | |
|------------|---------|
| ISSUE DATE | 6/12/80 |
| REVISIONS | 5/15/80 |

SHEET NUMBER
2